

DAVID Y. IGE
GOVERNOR



STATE OF HAWAII
DEPARTMENT OF TRANSPORTATION
869 PUNCHBOWL STREET
HONOLULU, HAWAII 96813-5097

JADE T. BUTAY
DIRECTOR

Deputy Directors
LYNN A. S. ARAKI-REGAN
DEREK J. CHOW
ROSS M. HIGASHI
EDWIN H. SNIFFEN

IN REPLY REFER TO:

Board of Land and
Natural Resources
State of Hawai'i
Honolulu, Hawai'i

ISSUANCE OF A REVOCABLE PERMIT FOR
CONSTRUCTION LAYDOWN SPACE
AIR SERVICE HAWAII, INC.
ELLISON ONIZUKA KONA INTERNATIONAL AIRPORT AT KEĀHOLE
TAX MAP KEY: (3) 7-3-43: PORTION OF 003

HAWAI'I

LEGAL REFERENCE:

Section 171-55, Hawai'i Revised Statutes (HRS).

APPLICANT:

Air Service Hawaii, Inc. (ASH), whose business address is 95 Nakolo Place, Honolulu, Hawai'i 96819.

LOCATION AND TAX MAP KEY:

Portion of Ellison Onizuka Kona International Airport at Keāhole (KOA), Kailua-Kona, Island of Hawai'i, identified by Tax Map Key: 3rd Division, 7-3-43: Portion of 003.

AREA:

Area/Space No. 006-123, containing an area of approximately 18,000 square feet of improved, unpaved land, as shown and delineated on the attached Exhibit A.

ZONING:

State Land Use District:	Urban & Conservation
County of Hawai'i:	Industrial (MG-1a) and Open

ITEM M-9

BLNR – ISSUANCE OF A REVOCABLE PERMIT FOR CONSTRUCTION LAYDOWN SPACE, AIR SERVICE HAWAII, INC.

Page 2

LAND TITLE STATUS:

Section 5(a) lands of the Hawai'i Admission Act: Ceded
DHHL 30% entitlement lands pursuant to Hawai'i Admission Act YES ___ NO X

CURRENT USE STATUS:

Land presently encumbered by Governor's Executive Order No. 3074, dated August 20, 1981, setting aside 4,204.10 acres designated as KOA under the control and management of the State of Hawai'i, Department of Transportation, Airports Division for Airport Purposes.

CHARACTER OF USE:

ASH's contractor, Nicholson, Inc., will use the space as a construction laydown area for ASH's hangar construction project under State Lease No. DOT-A-08-0002 at KOA.

COMMENCEMENT DATE:

Upon execution of the revocable permit.

MONTHLY RENTAL:

\$2,160.00 (based on a rate of \$1.44 per square foot per annum for improved, unpaved land as determined from the Department of Transportation, Airports Division schedule of rates and charges established by appraisal of Airports property statewide).

SECURITY DEPOSIT:

\$6,480.00, or three times the monthly rental in effect.

DCCA VERIFICATION:

Place of business registration confirmed:	YES <u>X</u>	NO _____
Registered business name confirmed:	YES <u>X</u>	NO _____
Good standing confirmed:	YES <u>X</u>	NO _____

CHAPTER 343, HRS - ENVIRONMENTAL ASSESSMENT:

The State of Hawaii, Department of Transportation, Airports Division (DOTA), has determined the subject land areas are covered by the Final Environmental Assessment (EA)/Finding of No Significant Impact (FONSI), Airfield, Terminal, and Facility Improvements for the Kona International Airport at Keahole, published by the Office of Environmental Quality Control (OEQC) in the March 23, 2013, issue of The

BLNR – ISSUANCE OF A REVOCABLE PERMIT FOR CONSTRUCTION LAYDOWN SPACE, AIR SERVICE HAWAII, INC.

Page 3

Environmental Notice. Accordingly, all relevant mitigation from the EA and best management practices will be implemented to address the minimum impacts of this action.

REMARKS:

In accordance with Section 171-55 HRS, relating to Permits, the Department of Transportation proposes to issue a month-to-month revocable permit to ASH for improved, paved land for their contractor, Nicholson, Inc., to use as a construction laydown area for ASH's hangar construction project under State Lease No. DOT-A-08-0002 at KOA.

RECOMMENDATION:

That the Board authorize the Department of Transportation to issue a month-to-month revocable permit to ASH, subject to: (1) terms and conditions herein outlined, which are by reference incorporated herein; and (2) such additional terms and conditions as may be prescribed by the Director of Transportation to best serve the interests of the State.

Respectfully submitted,

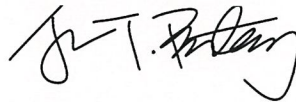

JADE T. BUTAY
Director of Transportation

APPROVED FOR SUBMITTAL:

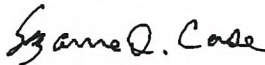

SUZANNE D. CASE
Chairperson and Member

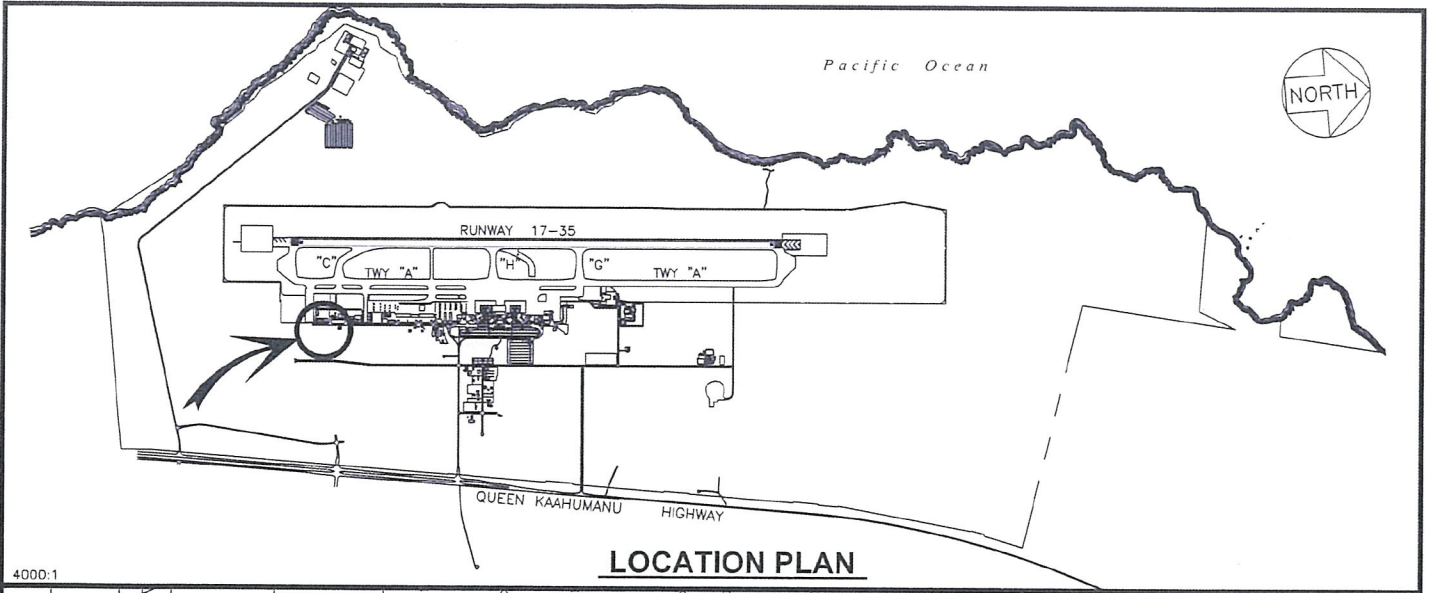

4000:1

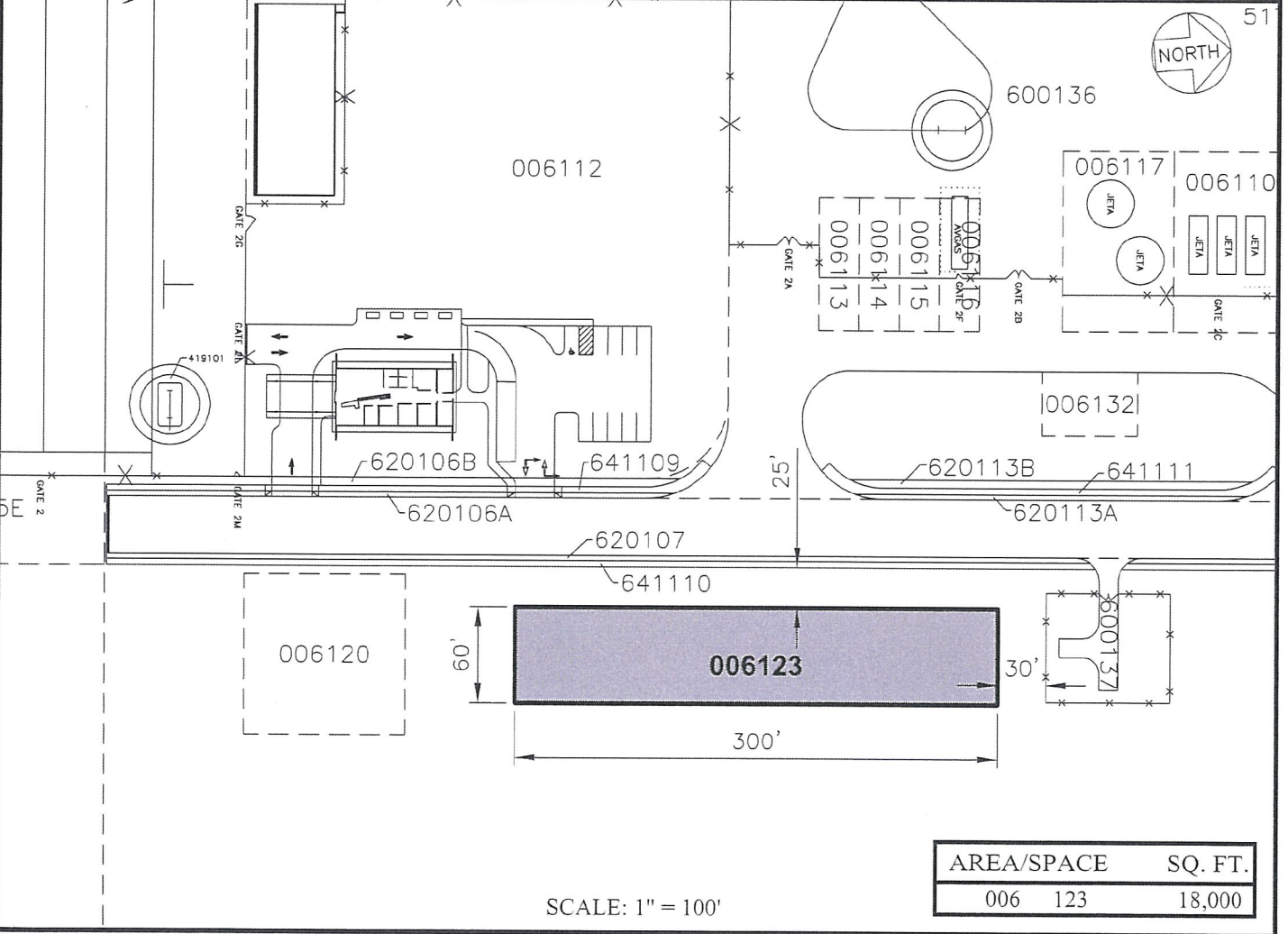

DATE : MARCH 2021

EXHIBIT: **A**



AIR SERVICE HAWAII, INC.

006123
PLAT 40

Adobe Sign Transaction Number: CBJCHBCAABAAr2s8NGgTpTIVFFGNq3oX56mqQ5v8ln4

N:\AIRPORTS\KOA_Kona\CAD\PM\koo_006123-01_draft.dwg

ELLISON ONIZUKA KONA INTERNATIONAL AIRPORT AT KEAHOLE