

DAVID Y. IGE
GOVERNOR

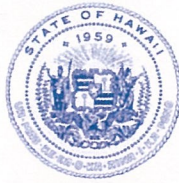

STATE OF HAWAII
DEPARTMENT OF TRANSPORTATION
869 PUNCHBOWL STREET
HONOLULU, HAWAII 96813-5097

JADE T. BUTAY
DIRECTOR

Deputy Director
LYNN A.S. ARAKI-REGAN
DEREK J. CHOW
ROSS M. HIGASHI
EDWIN H. SNIFFIN

IN REPLY REFER TO:

Board of Land and
Natural Resources
State of Hawai'i
Honolulu, Hawai'i

ISSUANCE OF A REVOCABLE PERMIT FOR OFFICE SPACES AND
EMPLOYEE BREAKROOMS FOR THE PURPOSE OF PROVIDING
24-HOUR SECURITY SERVICES
UNIVERSAL PROTECTION SERVICE, LP
DBA ALLIED UNIVERSAL SECURITY SERVICES
DANIEL K. INOUE INTERNATIONAL AIRPORT
TAX MAP KEYS: (1) 1-1-003: 057 AND (1) 1-1-003: 055 (PORTIONS)

O'AHU

APPLICANT:

Universal Protection Service, LP, dba Allied Universal Security Services, whose mailing address is 1003 Bishop Street, Suite 138, Honolulu, Hawai'i 96813.

LEGAL REFERENCE:

Section 171-55, Hawai'i Revised Statutes (HRS).

LOCATION:

Portion of Ewa Domestic Building, ground level and portion of Administration Building No. 336, fourth level, at Daniel K. Inouye International Airport, Island of Oahu, State of Hawai'i, identified by Tax Map Keys: 1st Division, 1-1-003: 057 (Portion) and 1-1-003: 055 (Portion).

AREA:

Building/Room No. 332-121A, containing an area of approximately 211 square feet,
Building/Room No. 332-121B, containing an area of approximately 235 square feet, and
Building/Room No. 332-121E, containing an area of approximately 71 square feet,
as shown and delineated on the attached map labeled Exhibit "A".
Building/Room No. 336-420, containing an area of approximately 225 square feet,
as shown and delineated on the attached map labeled Exhibit "B".

ITEM M-4

BLNR – ISSUANCE OF A REVOCABLE PERMIT FOR OFFICE SPACES AND
EMPLOYEE BREAKROOMS FOR THE PURPOSE OF PROVIDING 24-HOUR SECURITY
SERVICES, UNIVERSAL PROTECTION SERVICE, LP DBA ALLIED UNIVERSAL
SECURITY SERVICES

Page 2

ZONING:

State Land Use District: Urban
City and County of Honolulu LUO: Industrial (I-2)

LAND TITLE STATUS:

Non-Ceded - Section 5(a) lands of the Hawai'i Admission Act
DHHL 30% entitlement lands pursuant to Hawai'i Admission Act YES ___ NO X

CURRENT USE STATUS:

Land presently encumbered by Governor's Executive Order No. 3201, dated
June 8, 1983, setting aside 3,152.177 acres designated as Daniel K. Inouye International
Airport under the control and management of the State of Hawai'i, Department of
Transportation, Airports Division (DOTA) for Airport Purposes.

CHARACTER OF USE:

Allied Universal Security Service will use the spaces as employee breakrooms and
offices to provide 24-hour security services at the Daniel K. Inouye International Airport.

COMMENCEMENT DATE:

Upon execution of the revocable permit.

MONTHLY RENTAL:

\$1,887.84 (\$1,484.00, as determined from the DOTA schedule of rates and charges
established by appraisal of airports property statewide plus \$218.34 for utilities and
\$185.50 for air conditioning).

SECURITY DEPOSIT:

\$5,663.52, or three (3) times the monthly rental in effect.

DCCA VERIFICATION:

Place of business registration confirmed:	YES <u>X</u>	NO ___
Registered business name confirmed:	YES <u>X</u>	NO ___
Good standing confirmed:	YES <u>X</u>	NO ___

BLNR – ISSUANCE OF A REVOCABLE PERMIT FOR OFFICE SPACES AND
EMPLOYEE BREAKROOMS FOR THE PURPOSE OF PROVIDING 24-HOUR SECURITY
SERVICES, UNIVERSAL PROTECTION SERVICE, LP DBA ALLIED UNIVERSAL
SECURITY SERVICES

Page 3

CHAPTER 343, HRS - ENVIRONMENTAL ASSESSMENT:

The environmental impacts of the proposed action to the subject land area is covered by the Honolulu International Airport, Airport Modernization Program Environmental Assessment (EA), State Project No. AO1030-13. The EA is a joint State and Federal document dated, January 2013, and published in the February 8, 2013 issue of the OEQC Bulletin. Accordingly, the actions have been determined to have little or no impact upon the environment.

REMARKS:

In accordance with Section 171-55, HRS, relating to Permits, the Department of Transportation (DOT) proposes to issue a month-to-month revocable permit to Allied Universal Security Service for employee breakrooms and office spaces to provide 24-hour security services at the Daniel K. Inouye International Airport. DOT has no objections to Allied Universal Security Service's request.

RECOMMENDATION:

That the Board authorize the DOT to issue a month-to-month revocable permit to Allied Universal Security Service, subject to: (1) terms and conditions herein outlined, which are by reference incorporated herein; and (2) such additional terms and conditions as may be prescribed by the Director of Transportation to best serve the interests of the State.

Respectfully submitted,



JADE T. BUTAY
Director of Transportation

APPROVED FOR SUBMITTAL:

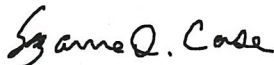

SUZANNE D. CASE
Chairperson and Member

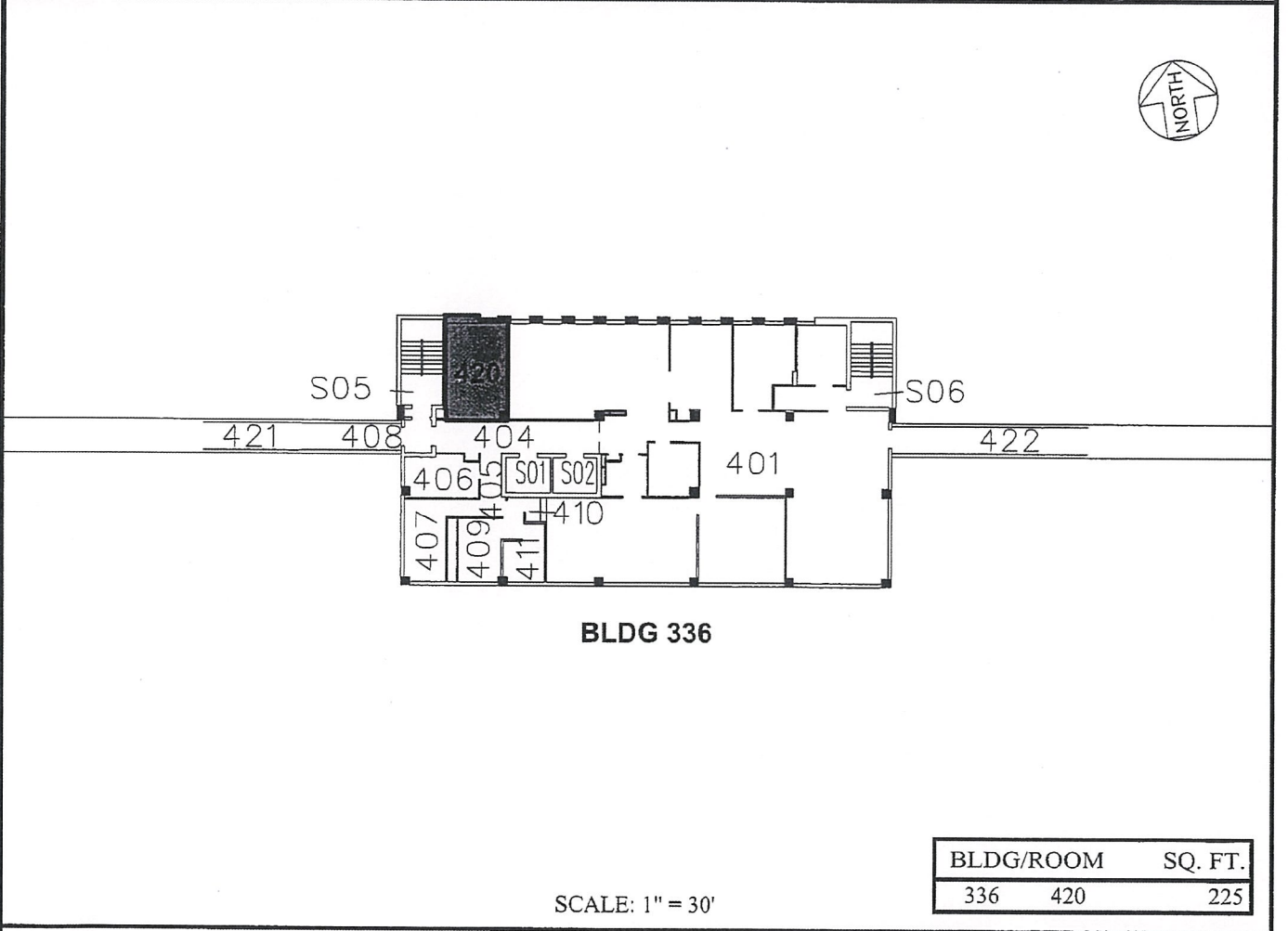
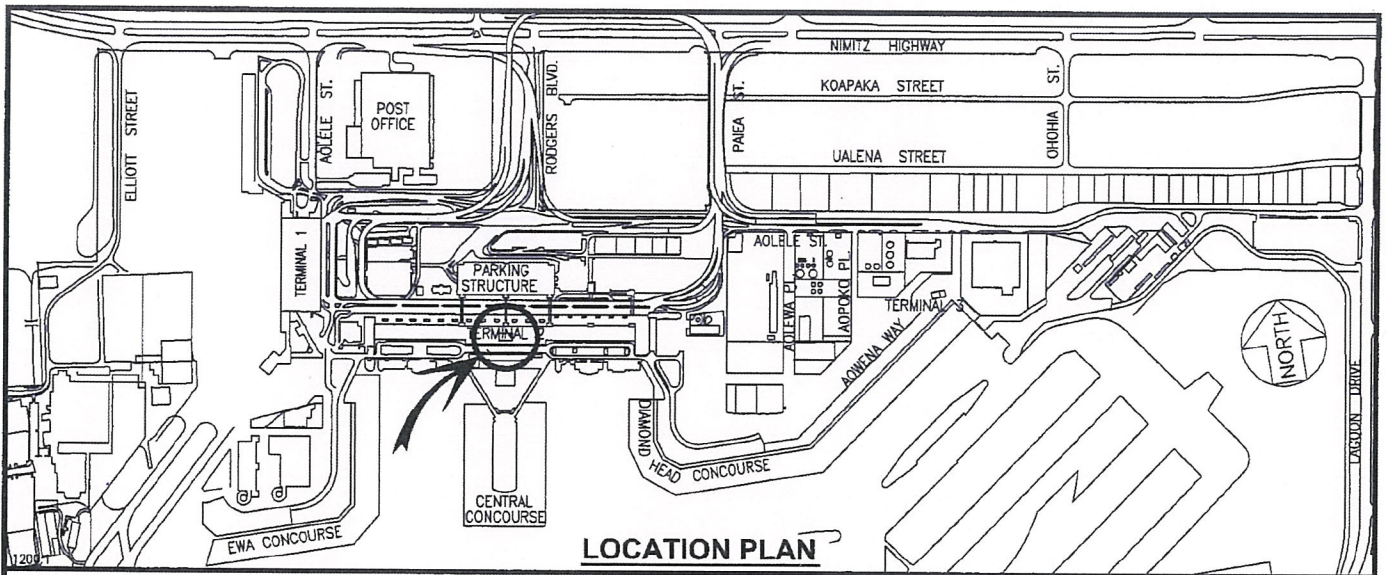

SCALE: 1" = 30'

BLDG/ROOM	SQ. FT.
336 420	225

RP-9122

DATE : JUNE 2021

EXHIBIT: **B**



Airports Division

UNIVERSAL PROTECTION
SERVICE, LP DBA ALLIED
UNIVERSAL SECURITY SERVICES

BUILDING 336
ADMINISTRATION BUILDING
FOURTH LEVEL

336420

PLAT A4

DANIEL K. INOUE INTERNATIONAL AIRPORT

N:\AIRPORTS\HNL_HONOLULU\CAD\PM\HNL_336420-02.DWG