

DAVID Y. IGE
GOVERNOR

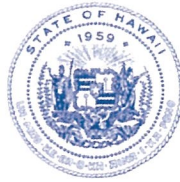

STATE OF HAWAII
DEPARTMENT OF TRANSPORTATION
869 PUNCHBOWL STREET
HONOLULU, HAWAII 96813-5097

JADE T. BUTAY
DIRECTOR

Deputy Directors
LYNN A.S. ARAKI-REGAN
DEREK J. CHOW
ROSS M. HIGASHI
EDWIN H. SNIFFEN

IN REPLY REFER TO:

Board of Land and
Natural Resources
State of Hawai'i
Honolulu, Hawai'i

ISSUANCE OF A REVOCABLE PERMIT FOR TICKET COUNTER
SPACE IN THE TERMINAL FOR AIRLINE CARRIER OPERATIONS
SOUTHERN AIRWAYS EXPRESS, LLC
LĀNA'I AIRPORT
TAX MAP KEY: (2) 4-9-02: PORTION OF 55

MAUI

APPLICANT:

Southern Airways Express, LLC, whose business address is 101 N. Riverside Drive,
Suite 211, Pompano Beach, Florida 33062.

LEGAL REFERENCE:

Section 171-55, Hawai'i Revised Statutes.

LOCATION AND TAX MAP KEY:

Portion of Lāna'i Airport (LNY), Lāna'i, County of Maui, identified by
Tax Map Key: 2nd Division, 4-9-02: Portion of 55.

AREAS:

Building/Room No. 302-104C, containing an area of approximately 176 square feet, as
shown and delineated on the attached Exhibit A.

ZONING:

State Land Use District:	Urban
County of Maui:	Airport

ITEM M-9

BLNR – ISSUANCE OF A REVOCABLE PERMIT FOR TICKET COUNTER SPACE
THE TERMINAL FOR AIRLINE CARRIER OPERATIONS, SOUTHERN AIRWAYS
EXPRESS, LLC

Page 2

LAND TITLE STATUS:

Section 5(a) lands of the Hawai'i Admission Act: Non-Ceded
DHHL 30% entitlement lands pursuant to Hawai'i Admission Act YES ___ NO X

CURRENT USE STATUS:

Land presently encumbered by Governor's Executive Order No. 4568, dated
November 30, 2018, setting aside 507.795 acres designated as Lāna'i Airport to be under
the control and management of the State of Hawai'i, Department of Transportation for
Airport Purposes.

CHARACTER OF USE:

Southern Airways Express, LLC will use the space for a ticket counter, as part of its
commercial airline carrier operations at Lāna'i Airport.

COMMENCEMENT DATE:

Upon complete execution of the revocable permit.

MONTHLY RENTAL:

\$464.64 (\$369.60, as determined from the Department of Transportation, Airports
Division schedule of rates and charges established by appraisal of Airports property
statewide, plus \$68.64 for utilities and \$26.40 for maintenance).

SECURITY DEPOSIT:

\$1,393.92, or three (3) times the monthly rental in effect.

DCCA VERIFICATION:

Place of business registration confirmed:	YES <u>X</u>	NO ___
Registered business name confirmed:	YES <u>X</u>	NO ___
Good standing confirmed:	YES <u>X</u>	NO ___

CHAPTER 343, HRS - ENVIRONMENTAL ASSESSMENT:

The State of Hawai'i, Department of Transportation, Airports Division (HDOT-A), has
determined that the subject areas are covered by the Lāna'i Airport Master Plan
Improvements Final Environmental Impact Statement (EIS), published by the Office of
Environmental Quality Control (OEQC) in the January 23, 1991, issue of the OEQC

BLNR – ISSUANCE OF A REVOCABLE PERMIT FOR TICKET COUNTER SPACE
THE TERMINAL FOR AIRLINE CARRIER OPERATIONS, SOUTHERN AIRWAYS
EXPRESS, LLC

Page 3

Bulletin and accepted by the Governor on May 7, 1991. Accordingly, all relevant mitigation from the EIS and best management practices will be implemented to address the minimum impacts of this action.

REMARKS:

In accordance with Section 171-55, HRS, relating to Permits, the Department of Transportation proposes to issue a month-to-month revocable permit to Southern Airways Express, LLC for ticket counter space, as part of its airline carrier operations at Lānaʻi Airport.

RECOMMENDATION:

That the Board authorize the Department of Transportation to issue a month-to-month revocable permit to Southern Airways Express, LLC, subject to: (1) terms and conditions herein outlined, which are by reference incorporated herein; and (2) such additional terms and conditions as may be prescribed by the Director of Transportation to best serve the interests of the State.

Respectfully submitted,



JADE T. BUTAY
Director of Transportation

APPROVED FOR SUBMITTAL:

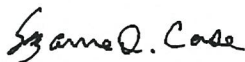

SUZANNE D. CASE
Chairperson and Member

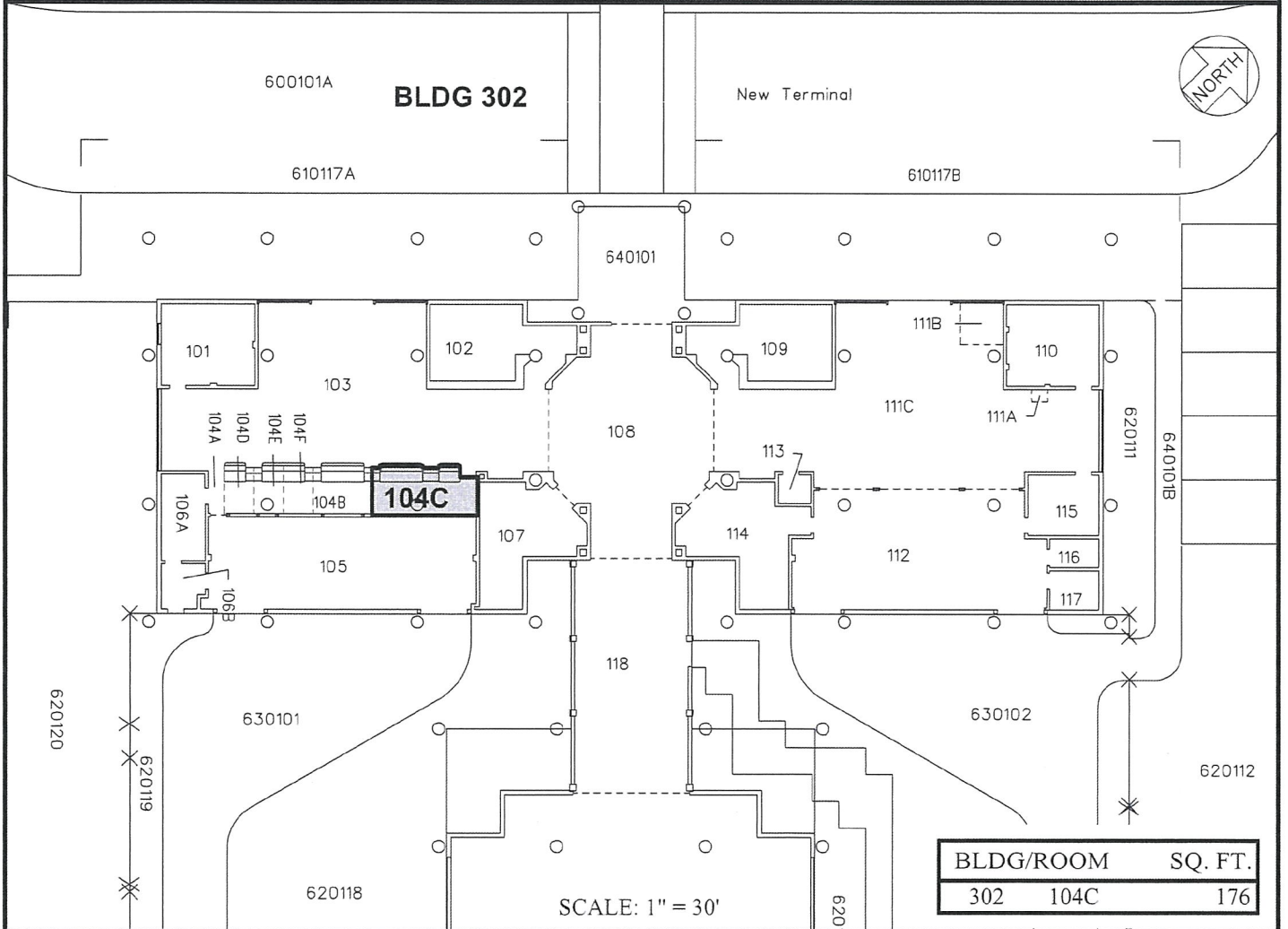
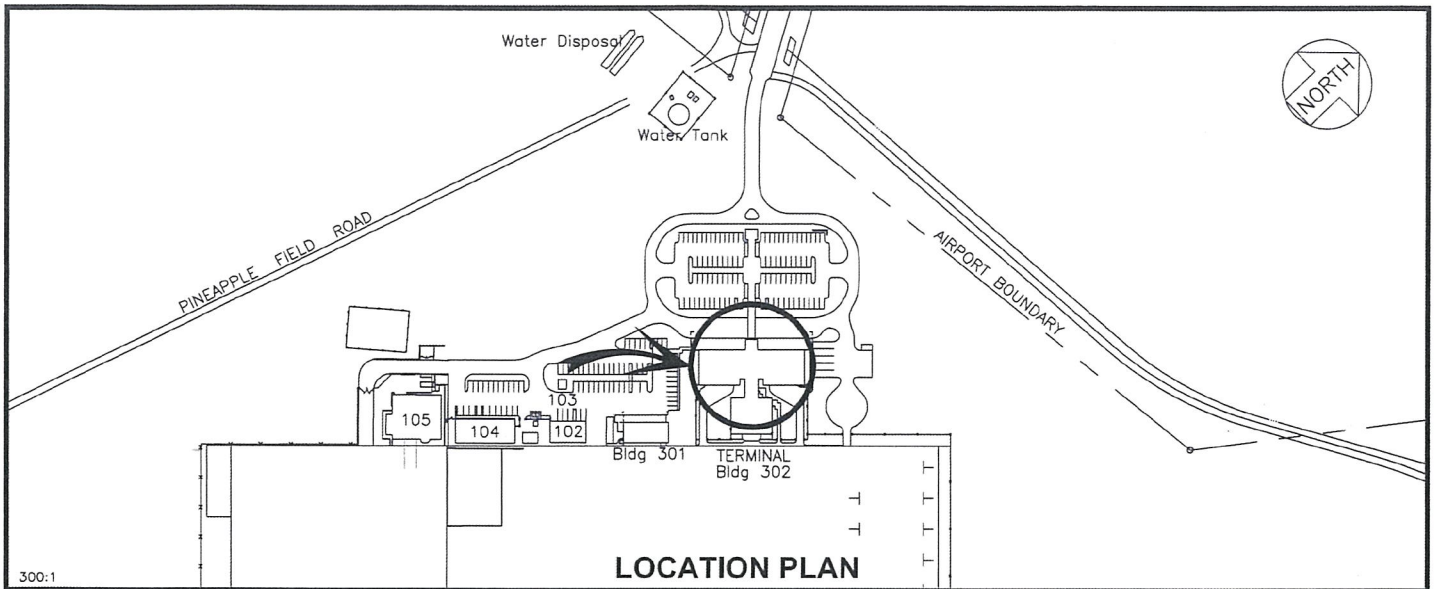

RP-9123 DATE : JUNE 2021 EXHIBIT: **A**

<p>DEPARTMENT OF TRANSPORTATION STATE OF HAWAII Airports Division</p>	<p>SOUTHERN AIRWAYS EXPRESS, LLC</p>	<p>BUILDING 302 NEW TERMINAL GROUND LEVEL</p>	<p>302104C PLAT A1, 45</p>
---	--	---	--------------------------------

LANAI AIRPORT

N:\AIRPORTS\LNY_Lana\CAD\PM\lny_302104C-01.dwg