

DAVID Y. IGE
GOVERNOR



STATE OF HAWAII
DEPARTMENT OF TRANSPORTATION
869 PUNCHBOWL STREET
HONOLULU, HAWAII 96813-5097

JADE T. BUTAY
DIRECTOR

Deputy Directors
LYNN A.S. ARAKI-REGAN
DEREK J. CHOW
ROSS M. HIGASHI
EDWIN H. SNIFFEN

IN REPLY REFER TO:

Board of Land and
Natural Resources
State of Hawai'i
Honolulu, Hawai'i

ISSUANCE OF A REVOCABLE PERMIT FOR AIRCRAFT PARKING
K & S HELICOPTERS, INC.
KAHULUI AIRPORT
TAX MAP KEY: (2) 3-8-01: PORTION OF 019

MAUI

REQUEST:

Issuance of a Revocable Permit for Aircraft Parking (Parking Permit) to K & S Helicopters, Inc., for two (2) aircraft tie-down spaces situated at Kahului Airport (OGG).

LEGAL REFERENCE:

Section 171-55, Hawai'i Revised Statutes (HRS).

APPLICANT:

K & S Helicopters, Inc. (K&S), whose mailing address is 73-341 U'u Street, Kailua-Kona, Hawai'i 96740.

LOCATION AND TAX MAP KEY:

Portion of Kahului Airport, Kahului, Island of Maui, identified by
Tax Map Key: 2nd Division, 3-8-01: Portion of 019.

AREAS:

Area/Space No. 404-105, containing an area of approximately 900 square feet, and
Area/Space No. 408-123, containing an area of approximately 900 square feet, as shown and
delineated on the attached Exhibit A.

ITEM M-4

BLNR- ISSUANCE OF A REVOCABLE PERMIT FOR AIRCRAFT PARKING, K & S
HELICOPTERS, INC.

Page 2

ZONING:

State Land Use District: Urban
County of Maui: Airport

LAND TITLE STATUS:

Section 5(a) lands of the Hawai'i Admission Act: Non-Ceded
DHHL 30% entitlement lands pursuant to Hawai'i Admission Act YES ___ NO X

CURRENT USE STATUS:

Land presently encumbered by Governor's Executive Order No. 2427, dated February 12, 1969, setting aside 1,268.938 acres designated as Kahului Airport to be under the control and management of the State of Hawai'i, Department of Transportation for public purposes.

CHARACTER OF USE:

Two (2) aircraft tie-downs (Bell Helicopter 429, N429JC and Textron Aviation 208B, N599MB).

COMMENCEMENT DATE:

Upon complete execution of the revocable permit.

MONTHLY RENTAL:

\$252.00 (\$126.00 per tie-down, as determined from the Department of Transportation, Airports Division schedule of rates and charges established by appraisal of Airports property statewide).

SECURITY DEPOSIT:

\$756.00, or three (3) times the monthly rental in effect.

DCCA VERIFICATION:

Place of business registration confirmed: YES X NO ___
Registered business name confirmed: YES X NO ___
Good standing confirmed: YES X NO ___

BLNR- ISSUANCE OF A REVOCABLE PERMIT FOR AIRCRAFT PARKING, K & S
HELICOPTERS, INC.

Page 2

CHAPTER 343, HRS - ENVIRONMENTAL ASSESSMENT:

The State of Hawai'i, Department of Transportation, Airports Division, has determined that the environmental impacts for the subject land use is covered by the Kahului Airport Improvements Final Environmental Impact Statement (EIS), published by the Office of Environmental Quality Control (OEQC) in the October 23, 1997, issue of The Environmental Notice. The EIS was accepted by the Governor on February 18, 1998. Accordingly, all relevant mitigation from the EIS and best management practices will be implemented to address the minimum impacts of this action.

REMARKS:

In accordance with Section 171-55, HRS, relating to Permits, the Department of Transportation proposes to issue a month-to-month Parking Permit to K&S for two (2) aircraft parking at OGG.

RECOMMENDATION:

That the Board authorize the Department of Transportation to issue a month-to-month Parking Permit to K&S, subject to: (1) terms and conditions herein outlined, which are by reference incorporated herein; and (2) such additional terms and conditions as may be prescribed by the Director of Transportation to best serve the interests of the State.

Respectfully submitted,



JADE T. BUTAY
Director of Transportation

APPROVED FOR SUBMITTAL:

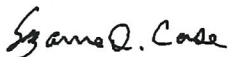

SUZANNE D. CASE
Chairperson and Member

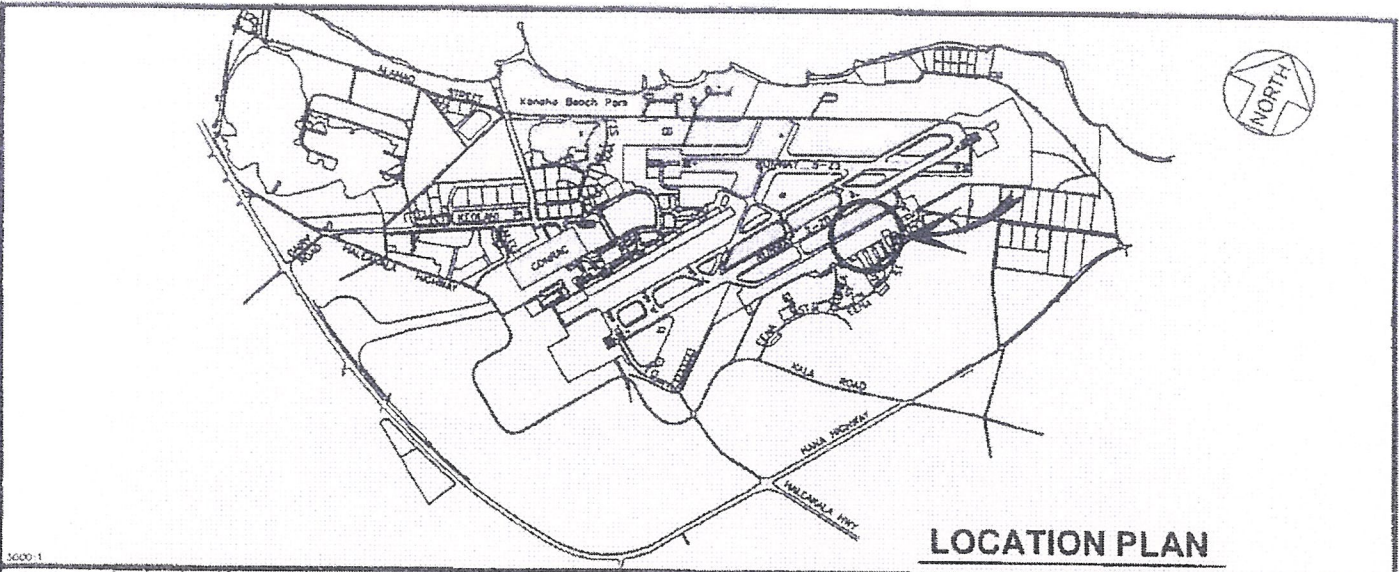

LOCATION PLAN

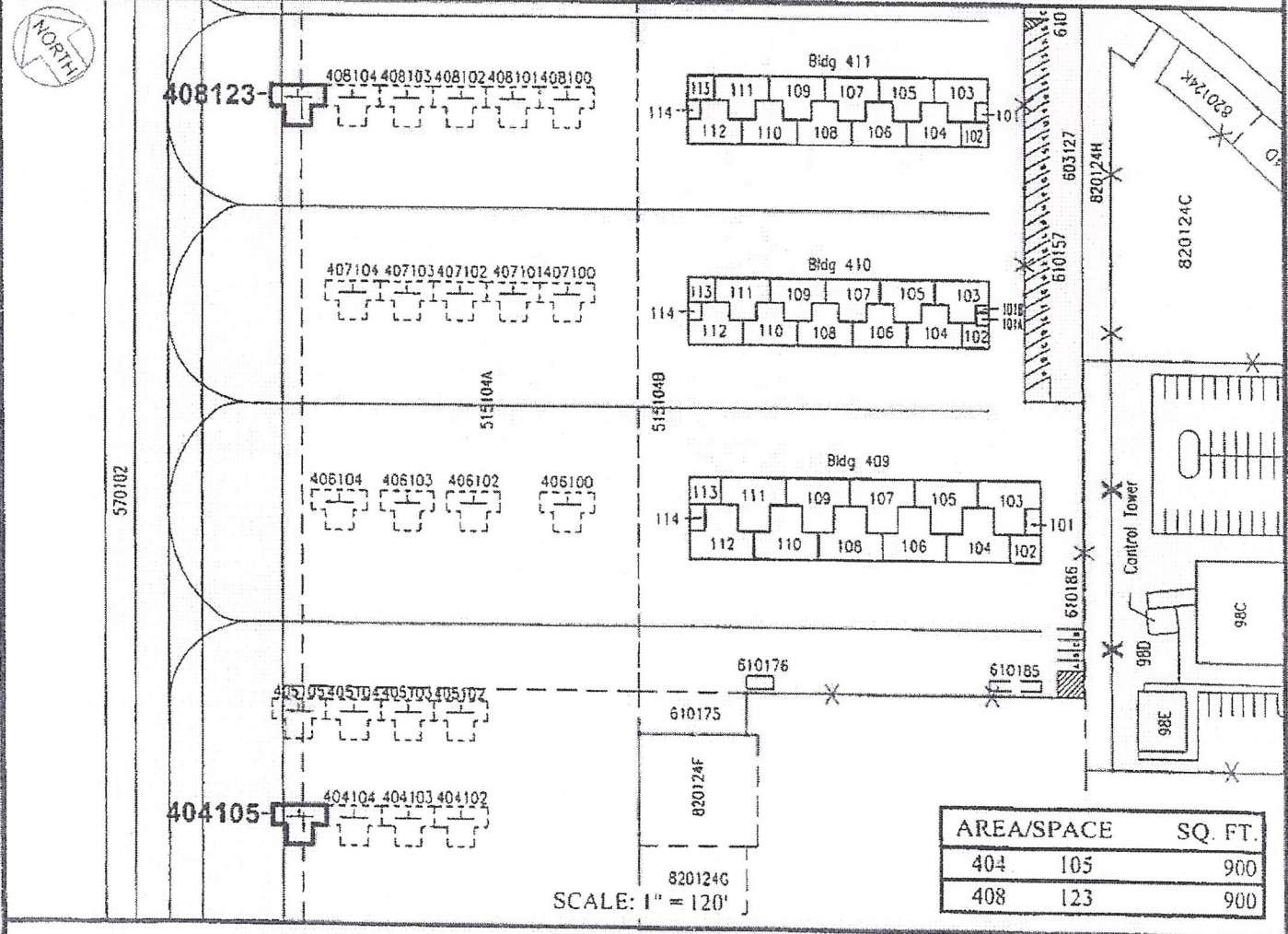

AREA/SPACE	SQ. FT.
404 105	900
408 123	900

SCALE: 1" = 120'

DATE : FEBRUARY 2021

EXHIBIT: **A**



Airports Division

K & S HELICOPTERS, INC.

TIE-DOWN

404105
408123

PLAT G1,26,F1,36

KAHULUI AIRPORT

N:\AIRPORTS\GCC_Kahului\CAD\PM\egg_404105_01.dwg