

DAVID Y. IGE  
GOVERNOR



STATE OF HAWAII  
DEPARTMENT OF TRANSPORTATION  
869 PUNCHBOWL STREET  
HONOLULU, HAWAII 96813-5097

JADE T. BUTAY  
DIRECTOR

Deputy Directors  
LYNN A.S. ARAKI-REGAN  
DEREK J. CHOW  
ROSS M. HIGASHI  
EDWIN H. SNIFFEN

IN REPLY REFER TO:

Board of Land and  
Natural Resources  
State of Hawai'i  
Honolulu, Hawai'i

ISSUANCE OF A REVOCABLE PERMIT FOR COMMUTER  
TERMINAL STORAGE SPACE  
SOUTHERN AIRWAYS EXPRESS, LLC  
KAHULUI AIRPORT  
TAX MAP KEY: (2) 3-8-01: PORTION OF 217

MAUI

APPLICANT:

Southern Airways Express, LLC (SAE), whose mailing address is 73-350 U'u Street,  
Kailua-Kona, Hawai'i 96740.

LEGAL REFERENCE:

Section 171-55, Hawai'i Revised Statutes (HRS).

LOCATION AND TAX MAP KEY:

Portion of Kahului Airport (OGG), Kahului, Island of Maui, identified by  
Tax Map Key: 2nd Division, 3-8-01: Portion of 217.

AREA:

Building/Room No. 225-106, containing an area of approximately 757 square feet, as  
shown and delineated on the attached Exhibit A.

ZONING:

State Land Use District: Urban  
County of Maui: Airport

**ITEM M-6**

BLNR – ISSUANCE OF A REVOCABLE PERMIT FOR COMMUTER TERMINAL STORAGE SPACE, SOUTHERN AIRWAYS EXPRESS, LLC

Page 2

LAND TITLE STATUS:

Section 5(a) lands of the Hawai'i Admission Act: Non-Ceded  
DHHL 30% entitlement lands pursuant to Hawai'i Admission Act YES \_\_\_ NO X

CURRENT USE STATUS:

Land presently encumbered by Governor's Executive Order No. 2427, dated February 12, 1969, setting aside 1,268.938 acres designated as Kahului Airport to be under the control and management of the State of Hawai'i, Department of Transportation for public purposes.

CHARACTER OF USE:

SAE will use the space for storage as part of its commercial airline carrier operation at OGG.

COMMENCEMENT DATE:

Upon complete execution of the revocable permit.

MONTHLY RENTAL:

\$2,212.96 (\$1,804.18, as determined from the Department of Transportation, Airports Division schedule of rates and charges established by appraisal of Airports property statewide, plus \$295.23 for utilities and \$113.55 for maintenance.

SECURITY DEPOSIT:

\$6,638.88, or three (3) times the monthly rental in effect.

DCCA VERIFICATION:

Place of business registration confirmed:	YES <u>X</u>	NO ___
Registered business name confirmed:	YES <u>X</u>	NO ___
Good standing confirmed:	YES <u>X</u>	NO ___

CHAPTER 343, HRS - ENVIRONMENTAL ASSESSMENT:

The State of Hawaii, Department of Transportation, Airports Division (DOTA), has determined that the subject land area and use is covered by the Kahului Airport Terminal Complex Expansion Negative Declaration, published by the Environmental Quality Commission (EQC) in the September 8, 1981, issue of the EQC Bulletin.

BLNR – ISSUANCE OF A REVOCABLE PERMIT FOR COMMUTER TERMINAL  
STORAGE SPACE, SOUTHERN AIRWAYS EXPRESS, LLC  
Page 3

Accordingly, all relevant mitigation from the Negative Declaration and best management practices will be implemented to address the minimum impacts of this action.

REMARKS:

In accordance with Section 171-55, HRS, relating to Permits, the Department of Transportation proposes to issue a month-to-month revocable permit to SAE for storage space, as part of its commercial airline carrier operation at OGG.

RECOMMENDATION:

That the Board authorize the Department of Transportation to issue a month-to-month revocable permit to SAE, subject to: (1) terms and conditions herein outlined, which are by reference incorporated herein; and (2) such additional terms and conditions as may be prescribed by the Director of Transportation to best serve the interests of the State.

Respectfully submitted,



JADE T. BUTAY  
Director of Transportation

APPROVED FOR SUBMITTAL:

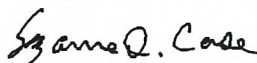

SUZANNE D. CASE  
Chairperson and Member



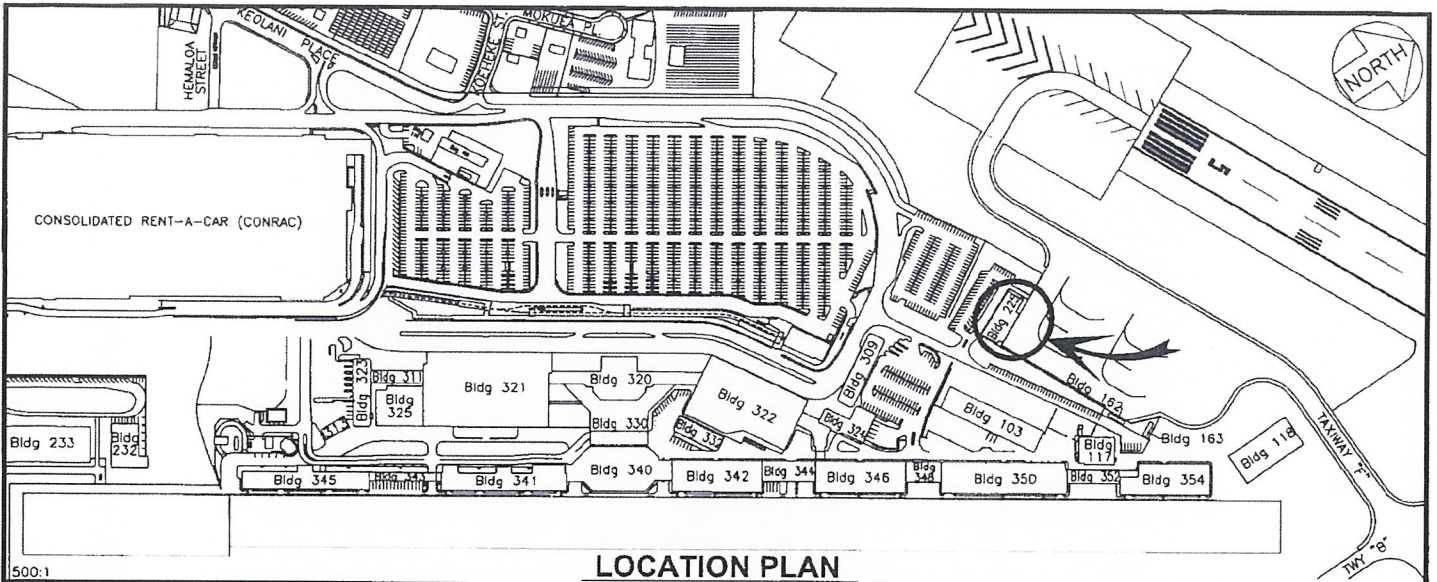

**LOCATION PLAN**

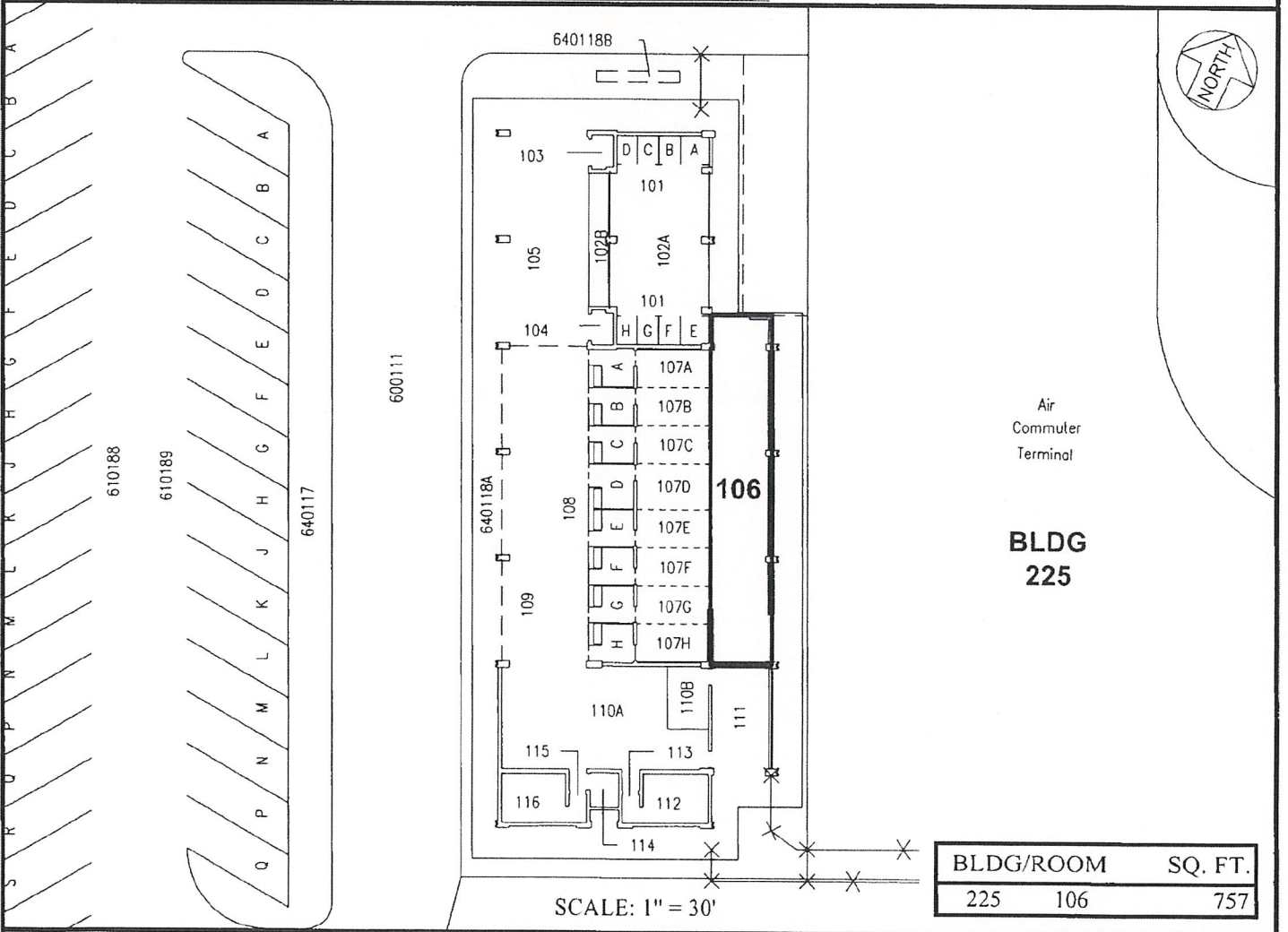

**BLDG 225**

Air  
Commuter  
Terminal

BLDG/ROOM	SQ. FT.
225 106	757

SCALE: 1" = 30'

DATE : JUNE 2021

EXHIBIT: **A**



**SOUTHERN AIRWAYS  
EXPRESS, LLC**

**BUILDING 225  
AIR COMMUTER TERMINAL  
GROUND LEVEL**

**225106  
PLAT B1, 35**

**KAHULUI AIRPORT**

N:\AIRPORTS\OGG\_Kahului\CAD\PM\ogg\_225106-01.dwg