

DAVID Y. IGE
GOVERNOR

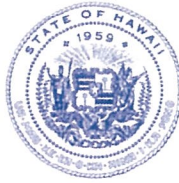

**STATE OF HAWAII
DEPARTMENT OF TRANSPORTATION
869 PUNCHBOWL STREET
HONOLULU, HAWAII 96813-5097**

JADE T. BUTAY
DIRECTOR

Deputy Directors
LYNN A.S. ARAKI-REGAN
DEREK J. CHOW
ROSS M. HIGASHI
EDWIN H. SNIFFEN

IN REPLY REFER TO:

Board of Land and
Natural Resources
State of Hawai'i
Honolulu, Hawai'i

ISSUANCE OF A REVOCABLE PERMIT FOR A T-HANGAR FOR
STORAGE AND MAINTENANCE OF AIRCRAFT AND OFFICE SPACE
DANIEL I. CHADBOURNE, JR.
KAHULUI AIRPORT
TAX MAP KEY: (2) 3-8-1: PORTION OF 195

MAUI

LEGAL REFERENCE:

Section 171-55, Hawai'i Revised Statutes (HRS).

APPLICANT:

Daniel I. Chadbourne, Jr., whose mailing address is 891 Holopuni Road, Kula, Hawai'i 96790.

LOCATION AND TAX MAP KEY:

Portion of Kahului Airport (OGG), Kahului, Island of Maui, identified by
Tax Map Key: 2nd Division, 3-8-1: Portion of 195.

AREAS:

Building/Room No. 409-111, containing an area of approximately 1,488 square feet, and
Building/Room No. 409-113, containing an area of approximately 504 square feet,
as shown and delineated on the attached Exhibit A.

ZONING:

State Land Use District:	Urban
County of Maui:	Airport

ITEM M-6

BLNR – ISSUANCE OF A REVOCABLE PERMIT FOR T-HANGAR FOR STORAGE AND
MAINTENANCE OF AIRCRAFT AND AN OFFICE, DANIEL I. CHADBOURNE, JR.
Page 2

LAND TITLE STATUS:

Section 5(a) lands of the Hawai'i Admission Act: Non-Ceded
DHHL 30% entitlement lands pursuant to Hawai'i Admission Act YES___ NO X

CURRENT USE STATUS:

Land presently encumbered by Governor's Executive Order No. 2427, dated
February 12, 1969, setting aside 1,268.938 acres designated as Kahului Airport to be
under the control and management of the State of Hawai'i, Department of Transportation
for public purposes.

CHARACTER OF USE:

Daniel I. Chadbourne, Jr. will use the spaces for storage and maintenance of aircraft
(1966 Piper PA-23-250, N69AJ) and an office.

COMMENCEMENT DATE:

Upon complete execution of the revocable permit.

MONTHLY RENTAL:

\$1,265.52 (\$1,146.00, as determined from the Department of Transportation, Airports
Division schedule of rates and charges established by appraisal of Airports property
statewide, plus \$119.52 for utilities).

SECURITY DEPOSIT:

\$3,796.56, or three (3) times the monthly rental in effect.

CHAPTER 343, HRS - ENVIRONMENTAL ASSESSMENT:

The State of Hawai'i, Department of Transportation, Airports Division, has determined that
the environmental impacts for the subject land use is covered by the Kahului Airport
Improvements Final Environmental Impact Statement (EIS), published by the Office of
Environmental Quality Control (OEQC) in the October 23, 1997, issue of The Environmental
Notice. The EIS was accepted by the Governor on February 18, 1998. Accordingly, all
relevant mitigation from the EIS and best management practices will be implemented to
address the minimum impacts of this action.

REMARKS:

In accordance with Section 171-55, HRS, relating to Permits, the Department of Transportation proposes to issue a month-to-month revocable permit to Daniel I. Chadbourne, Jr. for a T-hangar for the storage and maintenance of aircraft and an office.

RECOMMENDATION:

That the Board authorize the Department of Transportation to issue a month-to-month revocable permit to Daniel I. Chadbourne, Jr., subject to: (1) terms and conditions herein outlined, which are by reference incorporated herein; and (2) such additional terms and conditions as may be prescribed by the Director of Transportation to best serve the interests of the State.

Respectfully submitted,



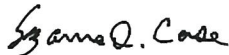

JADE T. BUTAY
Director of Transportation

APPROVED FOR SUBMITTAL:

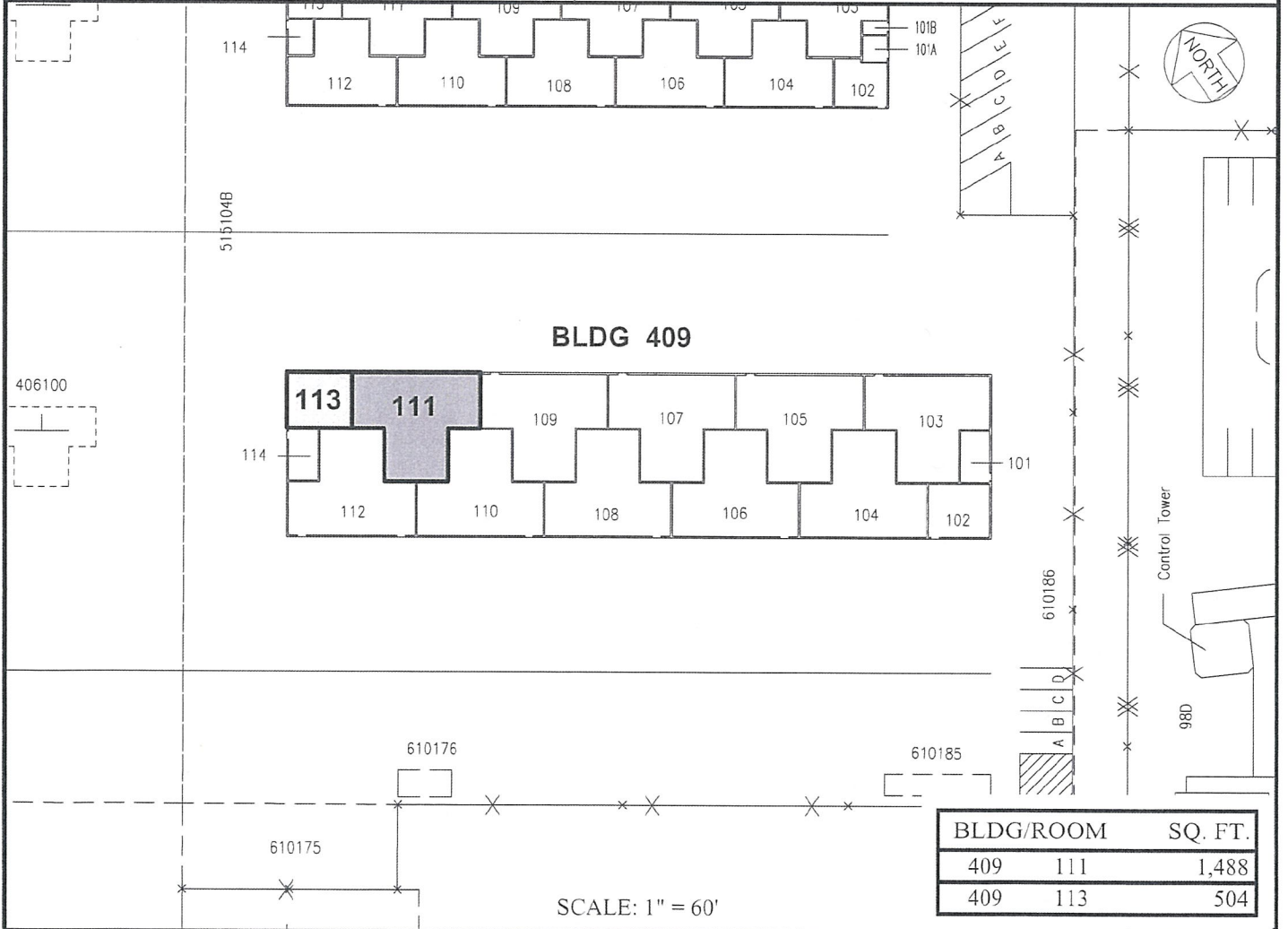
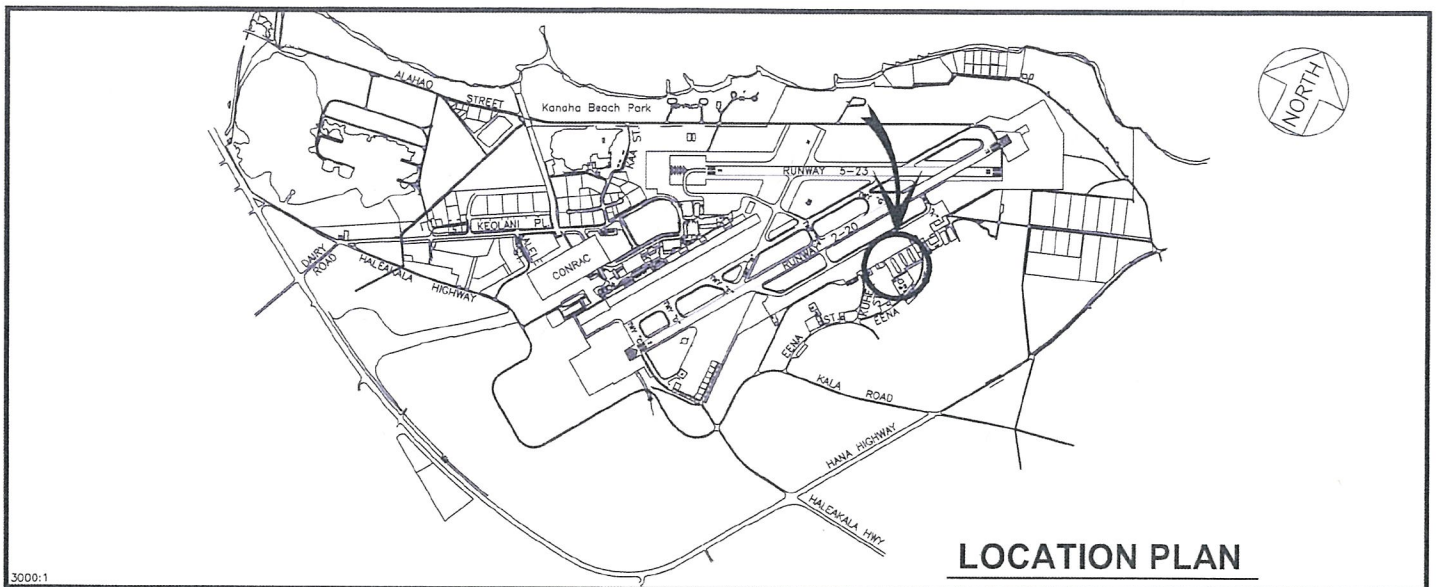

SUZANNE D. CASE
Chairperson and Member



DATE : MARCH 2021		EXHIBIT: A	
 Airports Division	DANIEL I. CHADBOURNE, JR.	BUILDING 409	409111
		T-HANGAR	409113
		GROUND LEVEL	PLAT F1, 36

KAHULUI AIRPORT

N:\AIRPORTS\OGG_Kahului\CAD\PM\OGG_409111-01.dwg

Signature: 

Email: LYNN.ARAKI-REGAN@HAWAII.GOV