

DAVID Y. IGE
GOVERNOR



STATE OF HAWAII
DEPARTMENT OF TRANSPORTATION
869 PUNCHBOWL STREET
HONOLULU, HAWAII 96813-5097

JADE BUTAY
DIRECTOR

Deputy Directors
LYNN A.S. ARAKI-REGAN
DEREK J. CHOW
ROSS M. HIGASHI
EDWIN H. SNIFFEN

Board of Land and
Natural Resources
State of Hawai'i
Honolulu, Hawai'i

ISSUANCE OF A REVOCABLE PERMIT FOR SHARED USE OF
BAGGAGE SYSTEM
SOUTHWEST AIRLINES CO.
LĪHU'E AIRPORT
TAX MAP KEY: (4) 3-5-01: PORTION OF 135

KAUA'I

LEGAL REFERENCE:

Section 171-55, Hawai'i Revised Statutes (HRS).

APPLICANT:

Southwest Airlines Co. (SWA), whose business address is 2702 Love Field Drive,
Dallas, Texas 75235-1611.

LOCATION AND TAX MAP KEY:

Portion of Līhu'e Airport (LIH), Līhu'e, Island of Kaua'i, identified by
Tax Map Key: 4th Division, 3-5-01: Portion of 135.

AREAS:

Area/Space No. 306-129, containing an area of approximately 1,457 square feet, and
Area/Space No. 306-130, containing an area of approximately 478 square feet as shown and
delineated on the attached Exhibit "A".

ZONING:

State Land Use District: Urban
County of Kaua'i: Industrial General/Special Treatment-Public Use (IG/ST-P)

ITEM M-5

BLNR – ISSUANCE OF A REVOCABLE PERMIT FOR SHARED USE OF
BAGGAGE SYSTEM, SOUTHWEST AIRLINES CO.

Page 2

LAND TITLE STATUS:

Section 5(a) lands of the Hawai'i Admission Act:

DHHL 30% entitlement lands pursuant to Hawai'i Admission Act

Non-Ceded

YES _ NO X

CURRENT USE STATUS:

Land presently encumbered by Governor's Executive Order No. 4614, dated October 28, 2019, setting aside 883.583 acres designated as Līhu'e Airport to be under the control and management of the State of Hawai'i, Department of Transportation for Airport Purposes.

CHARACTER OF USE:

Shared use of baggage system with three (3) other Commercial Airline Carriers at LIH.

COMMENCEMENT DATE:

Upon execution of the revocable permit.

MONTHLY RENTAL:

\$2,973.45 (1/4 of the total area, as determined from the Airports Division Signatory Carrier Rates and Charges Hawai'i Airports System, effective July 1, 2021).

SECURITY DEPOSIT:

\$8,920.35, or three (3) times the monthly rental in effect.

DCCA VERIFICATION:

Place of business registration confirmed:	YES <u>X</u>	NO _____
Registered business name confirmed:	YES <u>X</u>	NO _____
Good standing confirmed:	YES <u>X</u>	NO _____

CHAPTER 343, HRS - ENVIRONMENTAL ASSESSMENT:

The State of Hawai'i, Department of Transportation, Airports Division, has determined that the environmental impacts of the proposed tenant use for the subject land use is covered by the Līhu'e Airport Master Plan Environmental Impact Statement, published by the Environmental Quality Commission (EQC) in the August 8, 1976 and August 23, 1976, issues of EQC Bulletin and accepted by the Governor on April 26, 1977. Accordingly, all relevant mitigation from the EIS and best management practices will be implemented to address the minimum impacts of this action.

BLNR – ISSUANCE OF A REVOCABLE PERMIT FOR SHARED USE OF
BAGGAGE SYSTEM, SOUTHWEST AIRLINES CO.

Page 3

REMARKS:

In accordance with Section 171-55, HRS, relating to Permits, the Department of Transportation proposes to issue a month-to-month revocable permit to SWA for shared use with three (3) other Commercial Airline Carriers, of the baggage system as part of its Signatory Airline Carrier Operation at LIH.

RECOMMENDATION:

That the Board authorize the Department of Transportation to issue a month-to-month revocable permit to SWA, subject to: (1) terms and conditions herein outlined, which are by reference incorporated herein; and (2) such additional terms and conditions as may be prescribed by the Director of Transportation to best serve the interests of the State.

Respectfully submitted,



JADE T. BUTAY
Director of Transportation

APPROVED FOR SUBMITTAL:

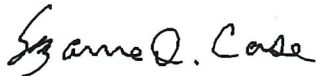

SUZANNE D. CASE
Chairperson and Member

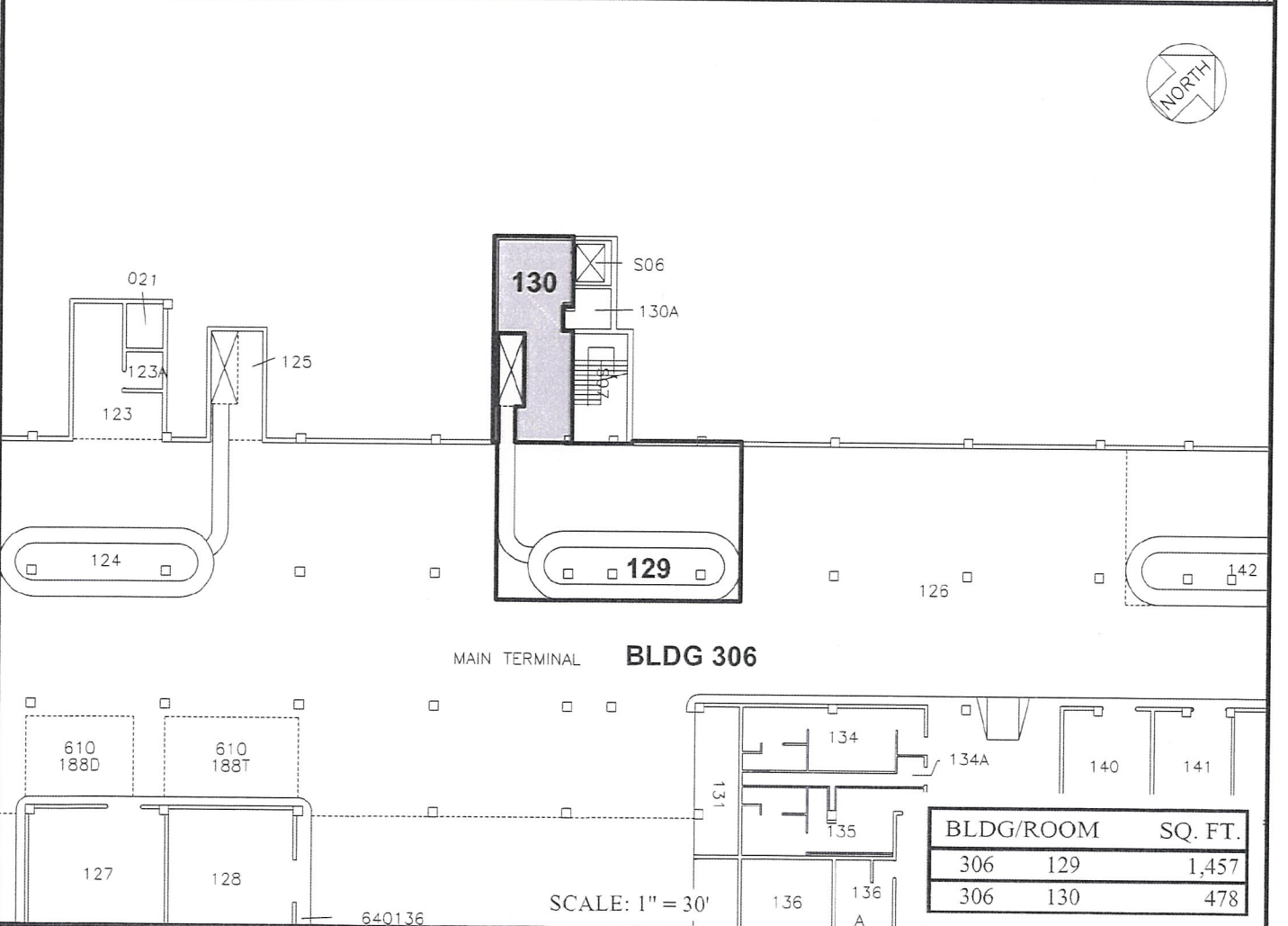
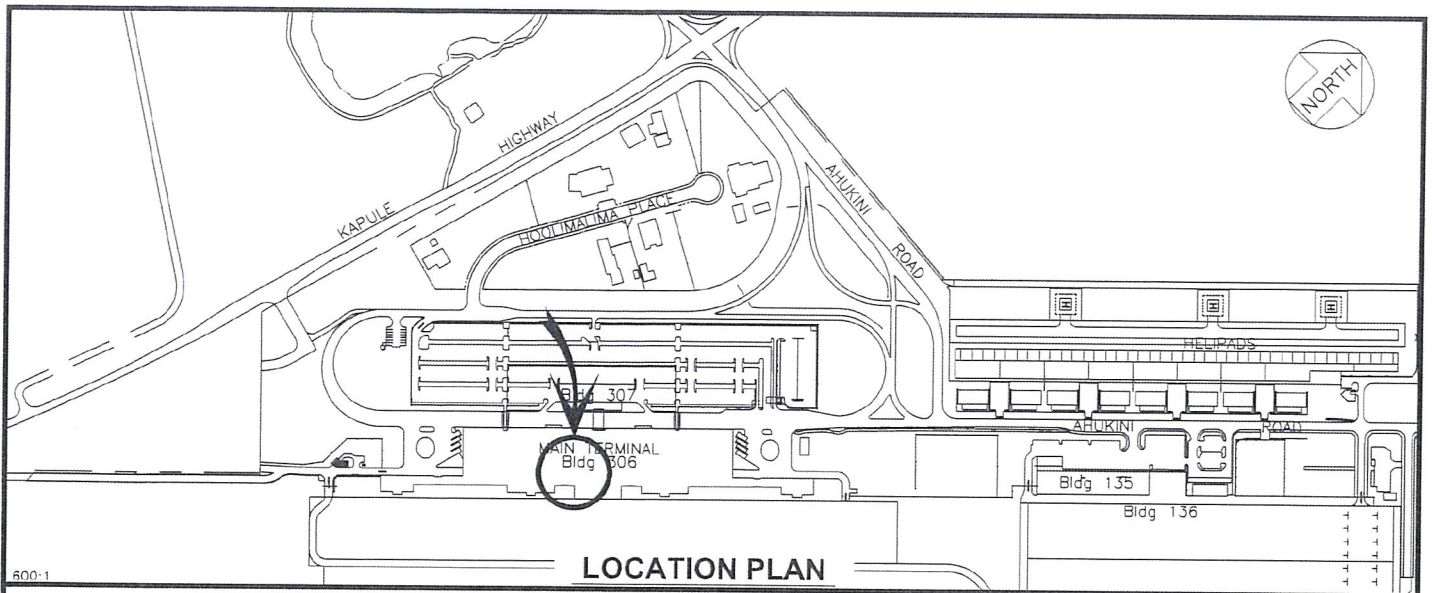

DATE : JUNE 2021

EXHIBIT: **A**



SOUTHWEST AIRLINES CO.

BUILDING 306
MAIN TERMINAL
GROUND LEVEL

306129
306130
PLAT C1, 45

LIHUE AIRPORT

N:\AIRPORTS\LIH_Lihue\CAD\PM\lih_306129A-130B-01.dwg

APPLICATION FOR REVOCABLE PERMIT

LIHUE AIRPORT

R.P. No. 9144

Application is hereby made to the Department of Transportation and occupy the following described premises at the above-named Airport in accordance with the terms and conditions set forth by the Department

the Department, for permission to use the premises for the purposes incidental thereto in

1. **Applicant's Name and Address:**

SOUTHWEST AIRLINES CO.
2702 Love Field Drive
Dallas, Texas 75235

2. **Premises as shown on attached exhibit A:**

Building/Room No. 306-129, consisting of an area of approximately 1,457 square feet
Building/Room No. 306-130, consisting of an area of approximately 478 square feet

Rate
PSFPY

\$73.76

\$73.76

3. **Purposes:** Shared Baggage System

4. **Fees:**

Monthly Rental: \$ 2,973.45

TOTAL MONTHLY FEE

\$2,973.45

5. **Security Deposit:** \$ 8,920.35, or three (3) times the monthly rent in effect.

6. **Holdover Tenancy:** \$ 99.12

I have examined the premises and have read and accept the terms and conditions of the Revocable Permit of the Department. I agree that I will not occupy the premises until I have (1) been notified by the Department, (2) paid one full month's rental in advance, (3) furnished the Department with the required security deposit, insurance policies and tax clearances from the State and County Tax Offices (from the Internal Revenue Service if the revocable permit calls for an annual rent of \$25,000.00 or more), and (4) signed the Revocable Permit. I understand that if I fail to obtain all of the requirements stated hereinabove, the Revocable Permit will be cancelled. **A \$25.00 administrative fee is required from the Applicant to cover the processing of the permit.**

Signature: [Signature]

Home No.: 2147924105

Print Name: Stephen F. Sisneros

Work No.: _____

Title: Managing Director-Airport Affairs

Cellular No.: _____

Date Signed: 7/19/01

E-Mail: _____

RECOMMEND APPROVAL:

APPROVED:

For [Signature]
CRAIG DAVIS
Kauai District Airport Manager

Date: 08/04/21

ROSS M. HIGASHI
Deputy Director-Airports

Date: _____