

DAVID Y. IGE
GOVERNOR



JADE T. BUTAY
DIRECTOR

Deputy Directors
DEREK J. CHOW
ROSS M. HIGASHI
EDWIN H. SNIFFEN

STATE OF HAWAII
DEPARTMENT OF TRANSPORTATION
869 PUNCHBOWL STREET
HONOLULU, HAWAII 96813-5097

IN REPLY REFER TO:

Board of Land and
Natural Resources
State of Hawai'i
Honolulu, Hawai'i

ISSUANCE OF A REVOCABLE PERMIT FOR AN OFFICE AND
BREAKROOM SPACE FOR ADMINISTRATION PURPOSES
UNITED STATES OF AMERICA, DEPARTMENT OF HOMELAND SECURITY,
TRANSPORTATION SECURITY ADMINISTRATION
ELLISON ONIZUKA KONA INTERNATIONAL AIRPORT AT KEĀHOLE
TAX MAP KEY: (3) 7-3-43: PORTION OF 003 HAWAII

LEGAL REFERENCE:

Section 171-55, Hawai'i Revised Statutes.

APPLICANT:

United States of America, General Services Administration for and on behalf of the U.S.
Department of Homeland Security, Transportation Security Administration (TSA), whose
mailing address is 200 West Parkway Drive, Suite 300, Egg Harbor Township, New
Jersey 08234.

LOCATION AND TAX MAP KEY:

Portion of Building No. 354, Security Checkpoint, Ground Level of Ellison Onizuka
Kona International Airport at Keāhole (KOA), Kailua-Kona, Island of Hawai'i,
identified by Tax Map Key: 3rd Division, 7-3-43: Portion of 003.

AREA:

Bldg/Room No. 354-102, containing an area of approximately 1,000 square feet,
as shown and delineated on the attached Exhibit A.

ZONING:

State Land Use District:
County of Hawai'i:

Urban & Conservation
Industrial (MG-1a) and Open

ITEM M-8

BLNR – ISSUANCE OF A REVOCABLE PERMIT FOR AN OFFICE AND BREAKROOM SPACE FOR ADMINISTRATION PURPOSES, UNITED STATES OF AMERICA, DEPARTMENT OF HOMELAND SECURITY, TRANSPORTATION SECURITY ADMINISTRATION

Page 2

LAND TITLE STATUS:

Section 5(a) lands of the Hawai'i Admission Act: Ceded
DHHL 30% entitlement lands pursuant to Hawai'i Admission Act YES ___ NO X

CURRENT USE STATUS:

Land presently encumbered by Governor's Executive Order No. 3074, dated August 20, 1981, setting aside 4,204.10 acres designated as KOA under the control and management of the State of Hawai'i, Department of Transportation, Airports Division for Airport Purposes.

CHARACTER OF USE:

TSA will use the office and breakroom space for administration purposes.

COMMENCEMENT DATE:

Upon complete execution of the revocable permit.

MONTHLY RENTAL:

\$2,540.00 (\$1,750.00, as determined from the DOTA schedule of rates and charges established by appraisal of Airports property statewide, plus \$250.00 for air conditioning, \$390.00 for utilities and \$150.00 for maintenance).

CHAPTER 343, HRS - ENVIRONMENTAL ASSESSMENT:

The State of Hawai'i, Department of Transportation, Airports Division (HDOT-A), has determined that the environmental impacts of the subject land area and use is covered by the Kona International Airport at Keāhole Final Environmental Assessment (FEA), published by the Office of Environmental Quality Control (OEQC) in the March 23, 2013, issue of The Environmental Notice. Accordingly, all relevant mitigation from the FEA and best management practices will be implemented to address the minimum impacts of this action.

REMARKS:

In accordance with Section 171-55, HRS, relating to Permits, the Department of Transportation proposes to issue a month-to-month revocable permit to TSA, for the use of an office and breakroom space for administration purposes at Ellison Onizuka Kona International Airport at Keāhole.

BLNR – ISSUANCE OF A REVOCABLE PERMIT FOR AN OFFICE AND BREAKROOM SPACE FOR ADMINISTRATION PURPOSES, UNITED STATES OF AMERICA, DEPARTMENT OF HOMELAND SECURITY, TRANSPORTATION SECURITY ADMINISTRATION

Page 3

RECOMMENDATION:

That the Board authorize the Department of Transportation to issue a month-to-month revocable permit to TSA, subject to: (1) terms and conditions herein outlined, which are by reference incorporated herein; and (2) such additional terms and conditions as may be prescribed by the Director of Transportation to best serve the interests of the State.

Respectfully submitted,



JADE T. BUTAY
Director of Transportation

APPROVED FOR SUBMITTAL:

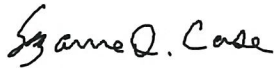

SUZANNE D. CASE
Chairperson and Member

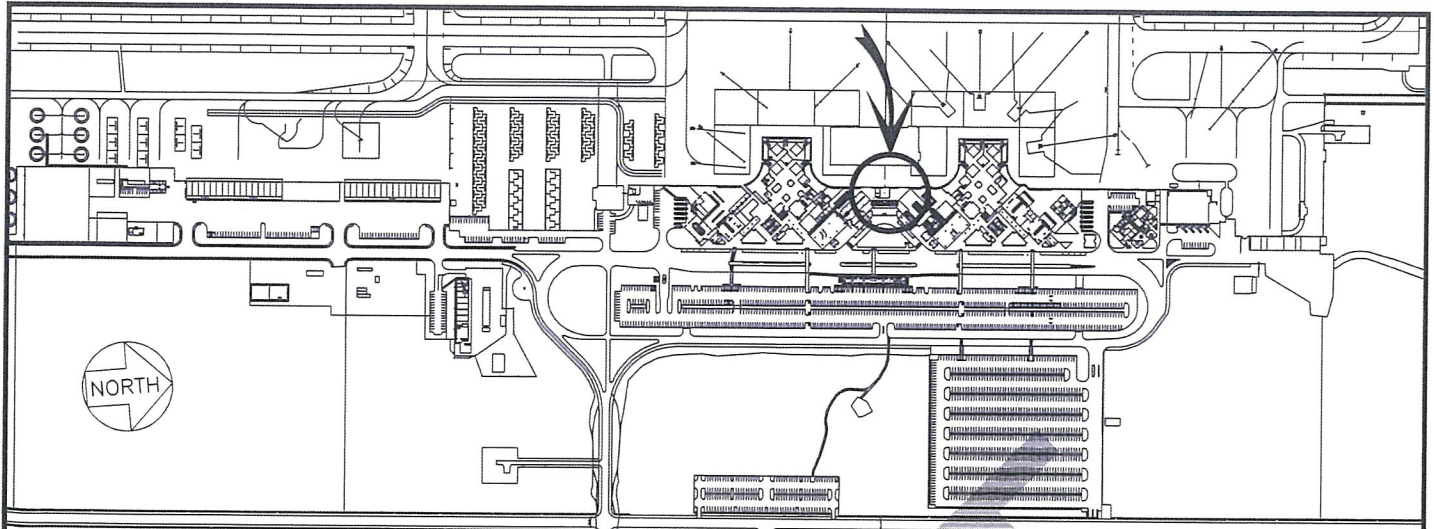

LOCATION PLAN

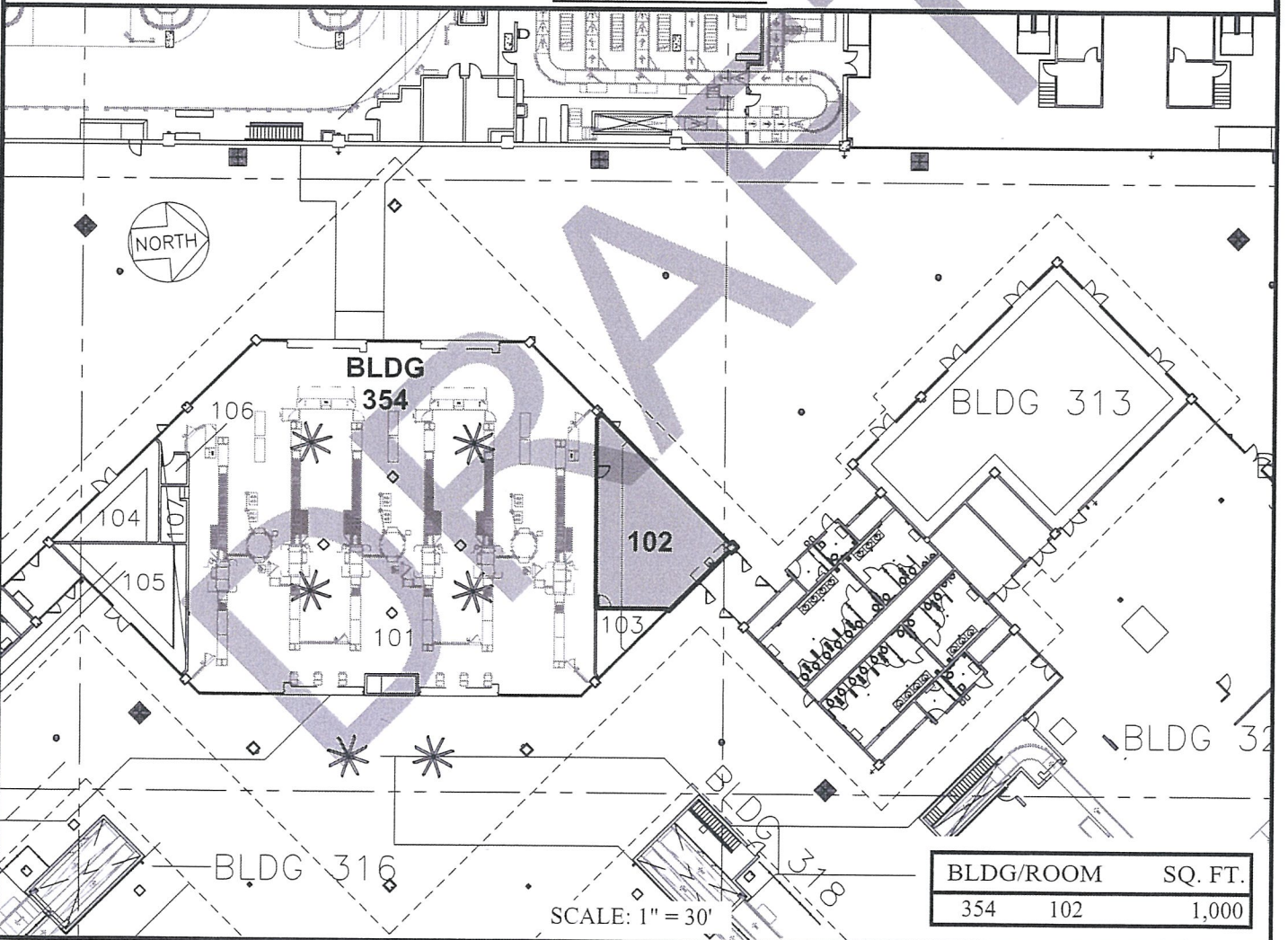

BLDG/ROOM	SQ. FT.
354 102	1,000

DATE : JUNE 2021

EXHIBIT: **A**



US GENERAL SERVICES
ADMIN/TSA

BUILDING 354
SECURITY CHECKPOINT
GROUND LEVEL

354102
PLAT D1, 38

ELLISON ONIZUKA KONA INTERNATIONAL AIRPORT AT KEAHOLE

N:\AIRPORTS\KOA_Kono\CAD\PM\koo_354102-02_draft.dwg