

DAVID Y. IGE
GOVERNOR



JADE T. BUTAY
DIRECTOR

Deputy Directors
DEREK J. CHOW
ROSS M. HIGASHI
EDWIN H. SNIFFIN

IN REPLY REFER TO:

**STATE OF HAWAII
DEPARTMENT OF TRANSPORTATION
869 PUNCHBOWL STREET
HONOLULU, HAWAII 96813-5097**

Board of Land and
Natural Resources
State of Hawai'i
Honolulu, Hawai'i

ISSUANCE OF A REVOCABLE PERMIT FOR AN OFFICE FOR GROUND
SUPPORT AS PART OF ITS AIRLINE OPERATIONS
SOUTHWEST AIRLINES CO.
DANIEL K. INOUE INTERNATIONAL AIRPORT
TAX MAP KEY: (1) 1-1-003: 050 (PORTION)

O'AHU

APPLICANT:

Southwest Airlines Co. (Southwest Airlines), whose business address is 2702 Love Field Drive, Dallas, Texas 75235.

LEGAL REFERENCE:

Section 171-55, Hawai'i Revised Statutes.

LOCATION AND TAX MAP KEY:

Portion of Building 350, Central Concourse, Ground Level at Daniel K. Inouye International Airport (Airport), Island of O'ahu, State of Hawai'i, identified by Tax Map Key: 1st Division, 1-1-003: 050 (Portion).

AREA:

Bldg/Room No. 350-136B, containing an area of approximately 2,605 square feet, as shown and delineated on the attached map labeled Exhibit "A".

ZONING:

State Land Use District: Urban
City and County of Honolulu LUO: Industrial (I-2)

ITEM M-2

LAND TITLE STATUS:

Non-Ceded - Section 5(a) lands of the Hawai'i Admission Act
DHHL 30% entitlement lands pursuant to Hawai'i Admission Act YES ___ NO X

CURRENT USE STATUS:

Land presently encumbered by Governor's Executive Order No. 3201, dated June 8, 1983, setting aside 3,152.177 acres designated as the Airport under the control and management of the State of Hawai'i, Department of Transportation, Airports Division (DOTA) for Airport Purposes.

CHARACTER OF USE:

Southwest Airlines will use the space for an office for ground support as part of its airline operations at the Airport.

COMMENCEMENT DATE:

Upon execution of the revocable permit.

MONTHLY RENTAL:

\$17,512.11 (based on a rate of \$80.67 per square foot, per annum, as determined from the Airports Division Signatory Rates and Charges, Hawai'i Airports System).

SECURITY DEPOSIT:

\$52,536.33, or three (3) times the monthly rental in effect.

DCCA VERIFICATION:

Place of business registration confirmed:	YES <u>X</u>	NO ___
Registered business name confirmed:	YES <u>X</u>	NO ___
Good standing confirmed:	YES <u>X</u>	NO ___

CHAPTER 343, HRS - ENVIRONMENTAL ASSESSMENT:

The environmental impacts of the proposed action to the subject land area are covered by the Honolulu International airport Master Plan Update and Noise Compatibility Program Environmental Assessment (EA), State Project No. AO1011-033. The EA is a joint State and Federal document, dated September 1989 and published in the October 23, 1989 issue of the OEQC Bulletin. Accordingly, relevant mitigation from the EA and DOTA environmental best management practice will address minimal impacts from this action.

REMARKS:

In accordance with Section 171-55 HRS, relating to Permits, the Department of Transportation proposes to issue a month-to-month revocable permit to Southwest Airlines, for an office for ground support for their signatory airline operations at the Airport. Southwest Airlines is a signatory airline carrier with airline operations located mainly within the Overseas Terminal.

RECOMMENDATION:

That the Board authorize the Department of Transportation to issue a month-to-month revocable permit to Southwest Airlines, subject to: (1) terms and conditions herein outlined, which are by reference incorporated herein; and (2) such additional terms and conditions as may be prescribed by the Director of Transportation to best serve the interests of the State.

Respectfully submitted,



JADE T. BUTAY
Director of Transportation

APPROVED FOR SUBMITTAL:

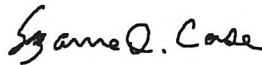

SUZANNE D. CASE
Chairperson and Member

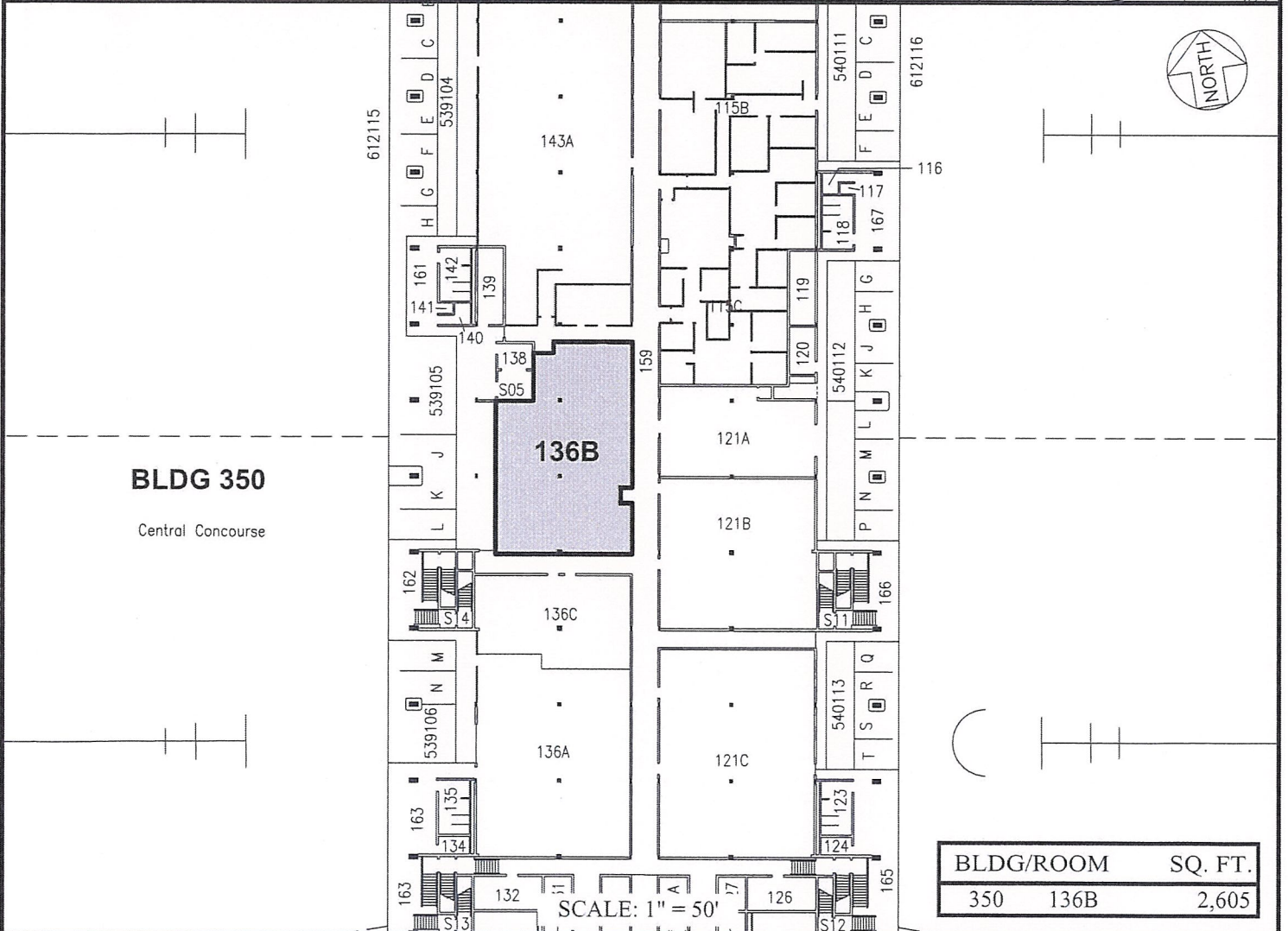
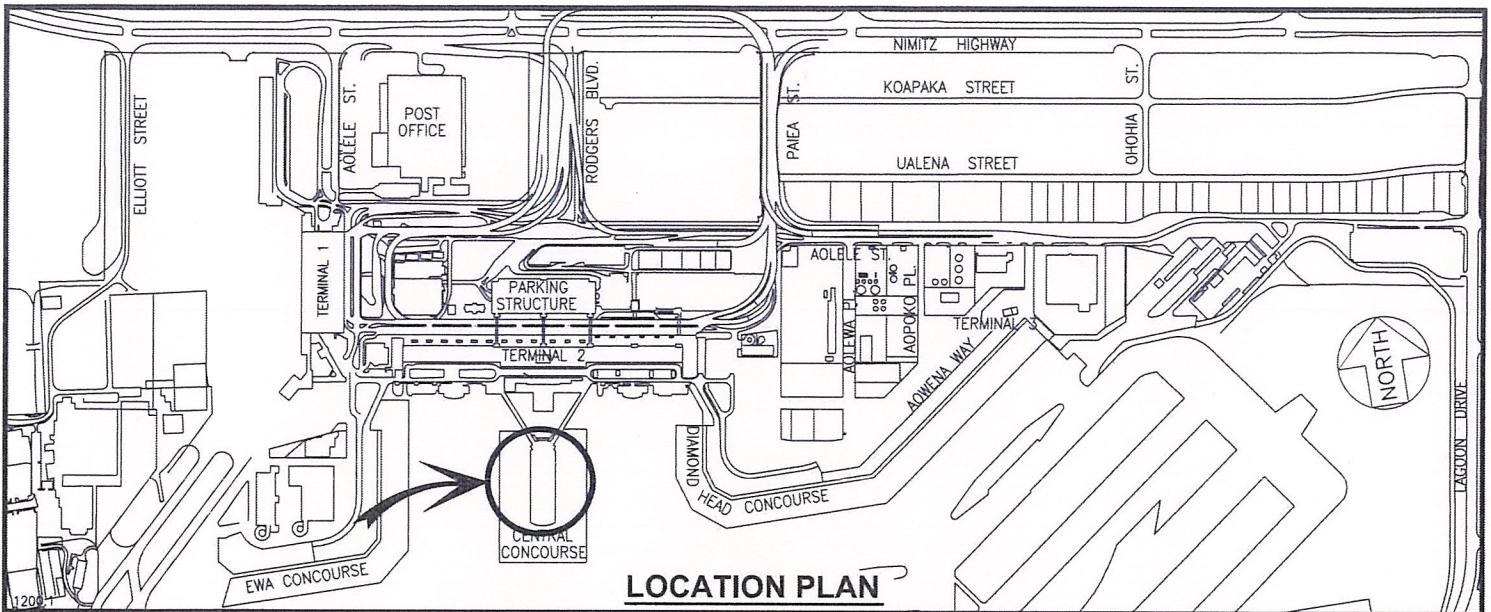

RP-9151

DATE : AUGUST 2021

EXHIBIT: **A**



SOUTHWEST AIRLINES CO.

BUILDING 350
CENTRAL CONCOURSE
GROUND LEVEL

350136B
PLAT B1, 25

DANIEL K. INOUE INTERNATIONAL AIRPORT

N:\AIRPORTS\HNL_HONOLULU\CAD\PM\HNL_350136B-01.DWG