

DAVID Y. IGE
GOVERNOR



STATE OF HAWAII
DEPARTMENT OF TRANSPORTATION
869 PUNCHBOWL STREET
HONOLULU, HAWAII 96813-5097

JADE T. BUTAY
DIRECTOR

Deputy Directors
DEREK J. CHOW
ROSS M. HIGASHI
EDWIN H. SNIFFIN

IN REPLY REFER TO:

Board of Land and
Natural Resources
State of Hawai'i
Honolulu, Hawai'i

ISSUANCE OF A REVOCABLE PERMIT FOR AN OFFICE SPACE FOR THE
STORAGE OF A MAIN DATA FRAME THAT PROVIDES NETWORK
CONNECTIVITY TO THE OVERSEAS TERMINAL
UNITED STATES OF AMERICA, DEPARTMENT OF HOMELAND SECURITY,
TRANSPORTATION SECURITY ADMINISTRATION
DANIEL K. INOUE INTERNATIONAL AIRPORT
TAX MAP KEY: (1) 1-1-003: 001 (PORTION) O'AHU

APPLICANT:

United States of America, Department of Homeland Security, Transportation Security
Administration (TSA), whose business address is 200 West Parkway Drive, Suite 300,
Egg Harbor Township, New Jersey 08234.

LEGAL REFERENCE:

Section 171-55, Hawai'i Revised Statutes.

LOCATION AND TAX MAP KEY:

Portion of Building 336, Administration Building, Fourth Level, Daniel K. Inouye
International Airport (Airport), Island of O'ahu, State of Hawai'i, identified by Tax Map
Key: 1st Division, 1-1-003: 001 (Portion).

AREA:

Building/Room No. 336-402, consisting of an area of approximately 124 square feet as
shown and delineated on the attached map labeled Exhibit "A".

ITEM M-3

BLNR – ISSUANCE OF A REVOCABLE PERMIT TO THE UNITED STATES OF AMERICA, DEPARTMENT OF HOMELAND SECURITY, TRANSPORTATION SECURITY ADMINISTRATION FOR OFFICE SPACE FOR THE STORAGE OF A MAIN DATA FRAME THAT PROVIDES NETWORK CONNECTIVITY TO THE OVERSEAS TERMINAL

Page 2

ZONING:

State Land Use District: Urban
City and County of Honolulu LUO: Industrial (I-2)

LAND TITLE STATUS:

Non-Ceded - Section 5(a) lands of the Hawai'i Admission Act
DHHL 30% entitlement lands pursuant to Hawai'i Admission Act YES ___ NO X

CURRENT USE STATUS:

Land presently encumbered by Governor's Executive Order No. 3201, dated June 8, 1983, setting aside 3,152.177 acres designated as the Airport under the control and management of the State of Hawai'i, Department of Transportation, Airports Division (DOTA) for Airport Purposes.

CHARACTER OF USE:

TSA will use the office space for the storage of a Main Data Frame that provides TSA Network Connectivity for all TSA activities in the Overseas Terminal.

COMMENCEMENT DATE:

Upon execution of the revocable permit.

MONTHLY RENTAL:

\$297.60 (based on a rate of \$24.00 per square foot, per annum, as determined from the DOTA schedule of rates and charges established by appraisal of Airport property statewide and electric and A/C charges of \$49.60).

CHAPTER 343, HRS - ENVIRONMENTAL ASSESSMENT:

The environmental impacts of the proposed action to the subject land area is covered by the Honolulu International airport Master Plan Update and Noise Compatibility Program Environmental Assessment (EA), State Project No. AO1011-033. The EA is a joint State and Federal document, dated September 1989 and published in the October 23, 1989 issue of the OEQC Bulletin. Accordingly, relevant mitigation from the EA and DOTA environmental best management practice will address minimal impacts from this action.

BLNR – ISSUANCE OF A REVOCABLE PERMIT TO THE UNITED STATES OF AMERICA, DEPARTMENT OF HOMELAND SECURITY, TRANSPORTATION SECURITY ADMINISTRATION FOR OFFICE SPACE FOR THE STORAGE OF A MAIN DATA FRAME THAT PROVIDES NETWORK CONNECTIVITY TO THE OVERSEAS TERMINAL

Page 3

REMARKS:

In accordance with Section 171-55 HRS, relating to Permits, the Department of Transportation proposes to issue a month-to-month revocable permit to TSA, for the use of an office space for the storage of a Main Data Frame that provides network connectivity to the Overseas Terminal.

RECOMMENDATION:

That the Board authorize the Department of Transportation to issue a month-to-month revocable permit to TSA, subject to: (1) terms and conditions herein outlined, which are by reference incorporated herein; and (2) such additional terms and conditions as may be prescribed by the Director of Transportation to best serve the interests of the State.

Respectfully submitted,



JADE T. BUTAY
Director of Transportation

APPROVED FOR SUBMITTAL:

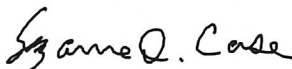

SUZANNE D. CASE
Chairperson and Member

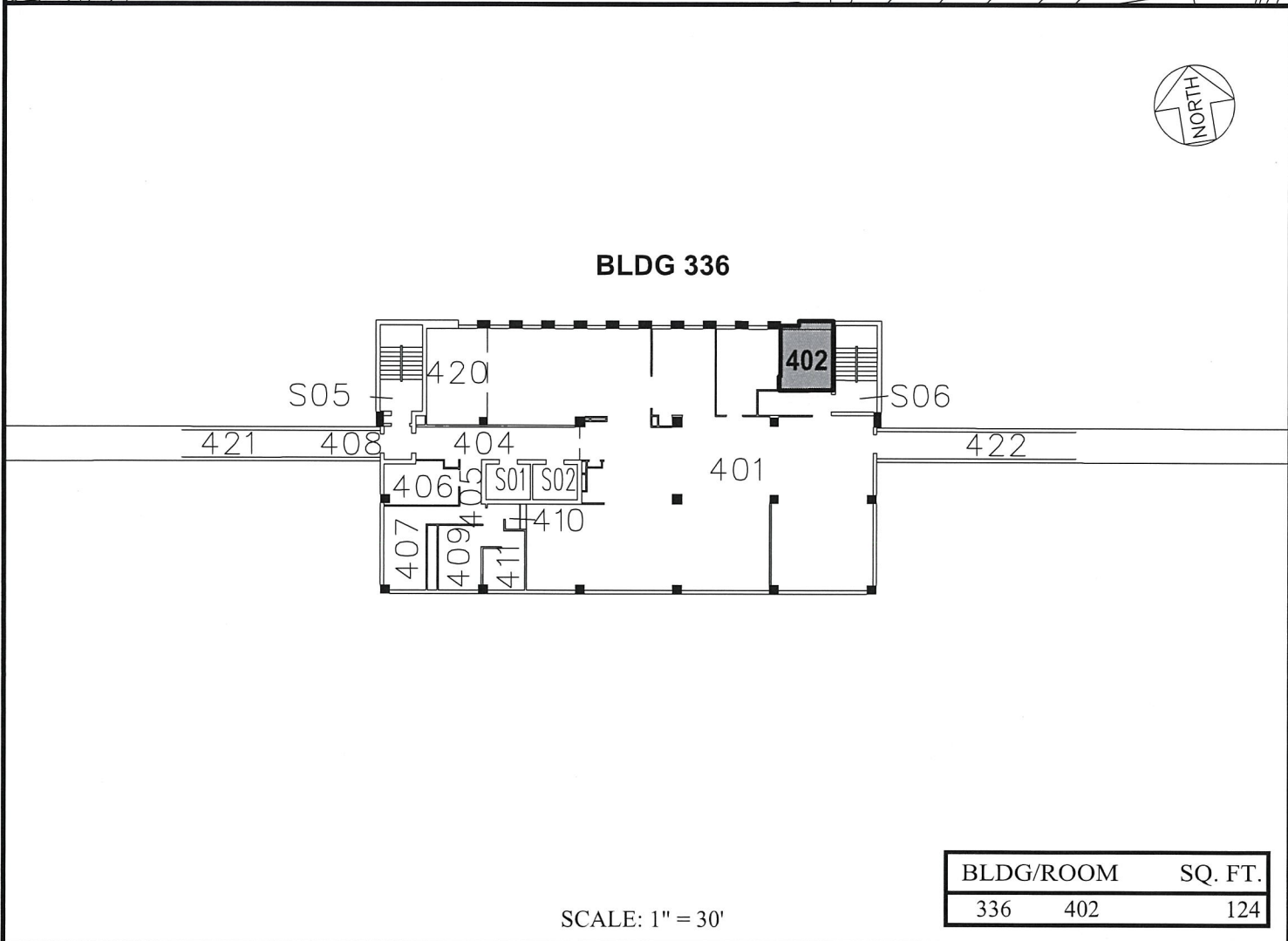
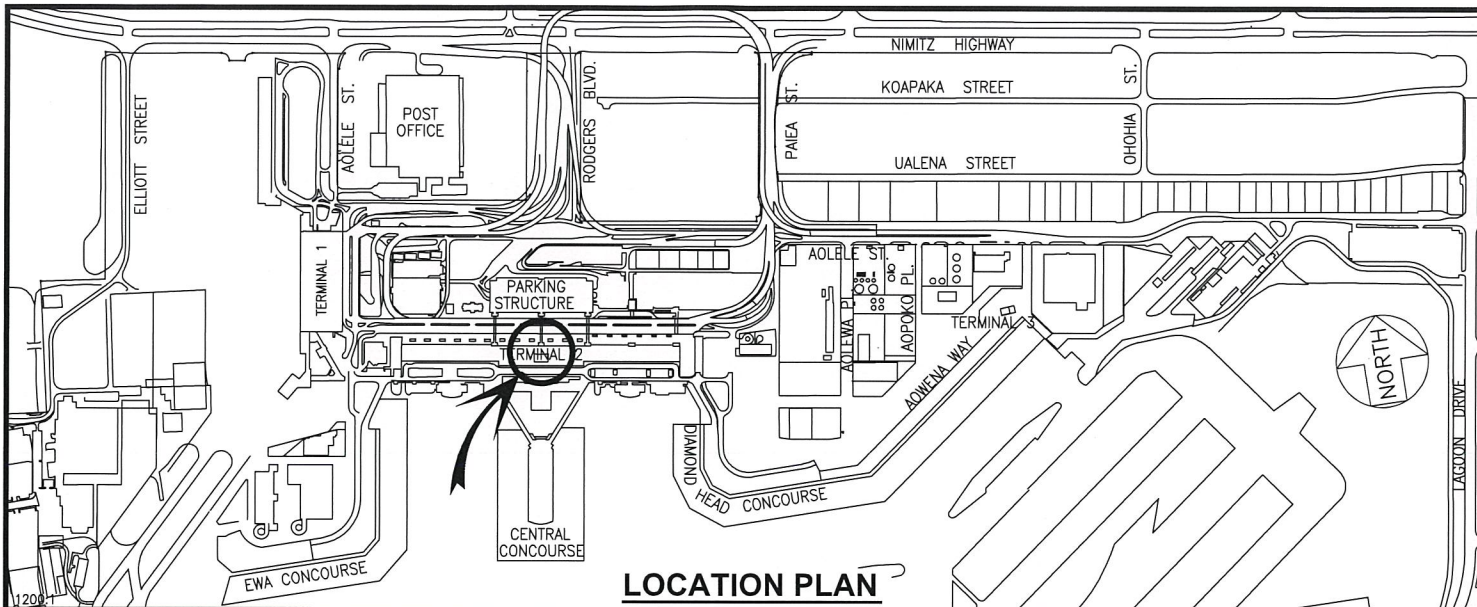

BLDG/ROOM	SQ. FT.
336 402	124

SCALE: 1" = 30'

RP-9127	DATE : JUNE 2021	EXHIBIT: A
 Airports Division	US GENERAL SERVICES ADMINISTRATION ON BEHALF OF TRANSPORTATION SECURITY ADMINISTRATION	BUILDING 336 ADMINISTRATION BUILDING FOURTH LEVEL
		336402 PLAT A4

DANIEL K. INOUE INTERNATIONAL AIRPORT