

DAVID Y. IGE  
GOVERNOR



STATE OF HAWAII  
DEPARTMENT OF TRANSPORTATION  
869 PUNCHBOWL STREET  
HONOLULU, HAWAII 96813-5097

JADE T. BUTAY  
DIRECTOR

Deputy Directors  
DEREK J. CHOW  
ROSS M. HIGASHI  
EDWIN H. SNIFFEN

IN REPLY REFER TO:

Board of Land and  
Natural Resources  
State of Hawai'i  
Honolulu, Hawai'i

ISSUANCE OF A REVOCABLE PERMIT FOR A CONSTRUCTION STAGING  
AREA FOR EQUIPMENT, MATERIALS AND SUPPLIES AND FOR THE STORAGE  
OF A CONSTRUCTION WASTE BIN  
NAN, INC.  
DANIEL K. INOUYE INTERNATIONAL AIRPORT  
TAX MAP KEY: (1) 1-1-003: 001 (PORTION)

O'AHU

LEGAL REFERENCE:

Section 171-55, Hawai'i Revised Statutes ("HRS").

APPLICANT:

Nan, Inc., whose mailing address is 636 Laumaka Street, Honolulu, Hawai'i 96819.

LOCATION:

A portion of Ewa Service Court, Parking Facilities, Ground Level at Daniel K. Inouye International Airport, Island of O'ahu, State of Hawai'i, identified by Tax Map Key: 1<sup>st</sup> Division, 1-1-003: 001 (Portion).

AREA:

Area/Space No. 611-102A, containing an area of approximately 873 square feet,  
Area/Space No. 611-102B, containing an area of approximately 880 square feet,  
Area/Space No. 611-102C, containing an area of approximately 880 square feet,  
Area/Space No. 611-102D, containing an area of approximately 880 square feet, and  
Area/Space No. 611-102E, containing an area of approximately 880 square feet,  
as shown and delineated on the attached Exhibit A.

**ITEM M-3**

BLNR- ISSUANCE OF A REVOCABLE PERMIT FOR A CONSTRUCTION STAGING AREA FOR EQUIPMENT, MATERIALS AND SUPPLIES AND FOR THE STORAGE OF A CONSTRUCTION WASTE BIN, NAN, INC.

Page 2

ZONING:

State Land Use District: Urban  
City and County of Honolulu LUO: Industrial (I-2)

LAND TITLE STATUS:

Section 5(b) lands of the Hawai'i Admission Act: Ceded  
DHHL 30% entitlement lands pursuant to Hawai'i Admission Act YES \_\_\_ NO X

CURRENT USE STATUS:

Land presently encumbered by Governor's Executive Order No. 3201, dated June 8, 1983, setting aside 3,152.177 acres designated as Daniel K. Inouye International Airport under the control and management of the State of Hawai'i, Department of Transportation, Airports Division ("DOTA") for Airport Purposes.

CHARACTER OF USE:

Nan, Inc. will use the spaces for a construction staging area for equipment, materials and supplies and for the storage of a construction waste bin, as specifically stated under Contract No. 69120, State Project No. AO1045-14, OST ACM Abatement, PH 1 – Air Conditioning Modifications Project, Daniel K. Inouye International Airport, Honolulu, Hawai'i.

COMMENCEMENT DATE:

To be determined by the Director of Transportation at a later date.

MONTHLY RENTAL:

\$25.00 (as stated in Contract No. 69120, State Project No. AO1045-14, OST ACM Abatement, PH 1 – Air Conditioning Modifications Project, Daniel K. Inouye International Airport).

SECURITY DEPOSIT:

\$75.00 or three (3) times the monthly rental in effect.

DCCA VERIFICATION:

Place of business registration confirmed: YES X NO \_\_\_  
Registered business name confirmed: YES X NO \_\_\_  
Good standing confirmed: YES X NO \_\_\_

BLNR- ISSUANCE OF A REVOCABLE PERMIT FOR A CONSTRUCTION STAGING AREA FOR EQUIPMENT, MATERIALS AND SUPPLIES AND FOR THE STORAGE OF A CONSTRUCTION WASTE BIN, NAN, INC.

Page 3

CHAPTER 343, HRS - ENVIRONMENTAL ASSESSMENT:

The environmental impacts of the proposed action to the subject land area are covered by the Honolulu International Airport, Airport Modernization Program Environmental Assessment (EA), State Project No. AO1030-13. The EA is a joint State and Federal document dated, January 2013, and published in the February 8, 2013 issue of the OEQC Bulletin. Accordingly, the actions have been determined to have little or no impact upon the environment.

REMARKS:

In accordance with Section 171-55, HRS, relating to Permits, the DOTA proposes to issue a permit to Nan, Inc. for the use of the spaces for a construction staging area for equipment, materials and supplies and for the storage of a construction waste bin, as specifically stated in Contract No. 69120, State Project No. AO1045-14, OST ACM Abatement, PH 1 – Air Conditioning Modifications Project, Daniel K. Inouye International Airport, Section 1.04, Provisions for Field Office/Storage Space: “Pending the availability of space on airport property, the State will issue Revocable Permit(s) to the Contractor for the use of the space, assessed at a monthly fee of \$25 for each Revocable Permit issued. The space(s) may be used for a field office and/or storing of materials and equipment, vehicle parking...”

RECOMMENDATION:

That the Board authorize the Department of Transportation to issue a month-to-month revocable permit to Nan, Inc., subject to: (1) terms and conditions herein outlined, which are by reference incorporated herein; and (2) such additional terms and conditions as may be prescribed by the Director of Transportation to best serve the interests of the State.

Respectfully submitted,



JADE T. BUTAY  
Director of Transportation

APPROVED FOR SUBMITTAL:

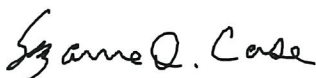

SUZANNE D. CASE  
Chairperson and Member



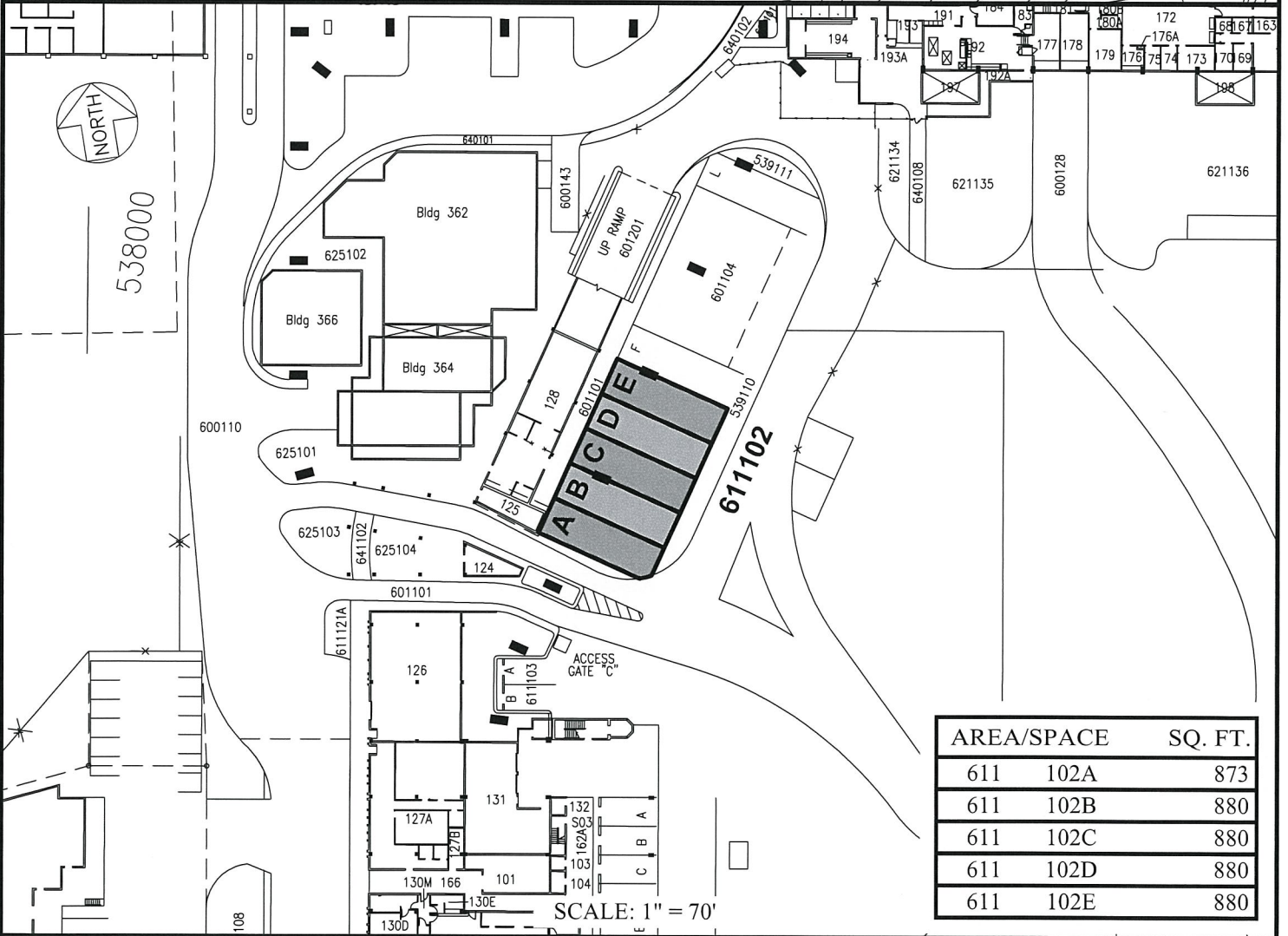
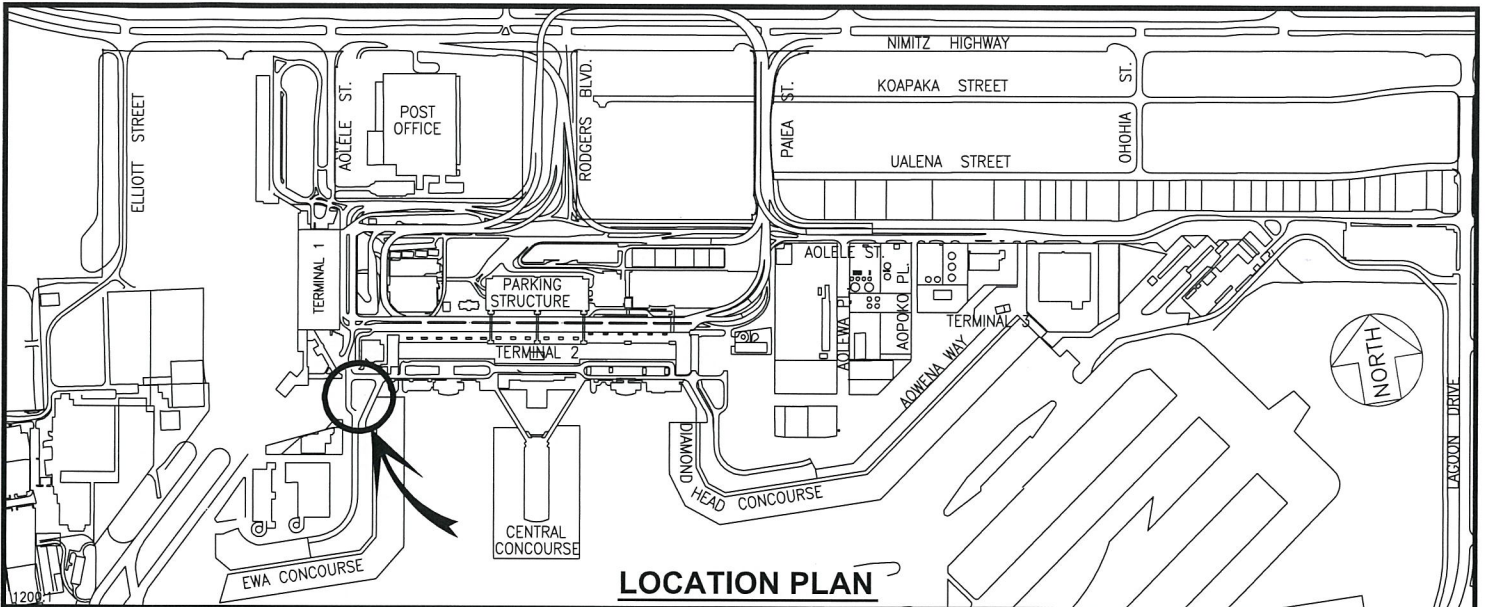

AREA/SPACE	SQ. FT.
611 102A	873
611 102B	880
611 102C	880
611 102D	880
611 102E	880

SCALE: 1" = 70'

RP-9155 DATE : SEPTEMBER 2021 EXHIBIT: **A**



NAN, INC.

PARKING FACILITIES  
EWA CONCOURSE AREA  
GROUND LEVEL

611102A-E  
PLAT E1