

DAVID Y. IGE
GOVERNOR

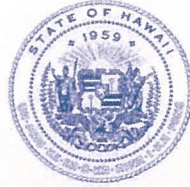

JADE T. BUTAY
DIRECTOR

Deputy Directors
DEREK J. CHOW
ROSS M. HIGASHI
EDWIN H. SNIFFEN

IN REPLY REFER TO:

STATE OF HAWAII
DEPARTMENT OF TRANSPORTATION
869 PUNCHBOWL STREET
HONOLULU, HAWAII 96813-5097

Board of Land and
Natural Resources
State of Hawai'i
Honolulu, Hawai'i

ISSUANCE OF A REVOCABLE PERMIT TO STAGE FUELING
VEHICLES FOR AIRCRAFT FUELING OPERATIONS
FSM GROUP, LLC
DANIEL K. INOUE INTERNATIONAL AIRPORT
TAX MAP KEY: (1) 1-1-003: 001 (PORTION)

O'AHU

APPLICANT:

FSM Group, LLC, a Nevada limited liability company, whose mailing address is
201 E. Pine Street, Suite 210, Orlando, Florida 32801.

LEGAL REFERENCE:

Section 171-55, Hawai'i Revised Statutes (HRS), as amended.

LOCATION AND TAX MAP KEY:

A portion of the Daniel K. Inouye International Airport (Airport), Island of O'ahu, State
of Hawai'i, identified by Tax Map Key: 1st Division, 1-1-003: 001 (Portion).

AREA:

Area/Space No. 001-122D, consisting of approximately 6,225 square feet of improved,
paved land, as shown, and delineated on the attached map labeled Exhibit A.

ZONING:

State Land Use District: Urban
City and County of Honolulu: I-2 (Industrial)

ITEM M-1

BLNR – ISSUANCE OF A REVOCABLE PERMIT TO STAGE FUELING VEHICLES FOR AIRCRAFT FUELING OPERATIONS, FSM GROUP, LLC

Page 2

LAND TITLE STATUS:

Section 5(b) lands (ceded) of the Hawai'i Admission Act.

DHHL 30% entitlement lands pursuant to the Hawai'i Admission Act YES NO

CURRENT USE STATUS:

Land presently encumbered by Governor's Executive Order No. 3201, dated June 8, 1983, setting aside a portion of the Airport under the control and management of the Department of Transportation, Airports Division (DOTA), State of Hawai'i, for Airport Purposes.

CHARACTER OF USE:

To Stage Fueling Vehicles (8 Hydrant Trucks and 2 Tanker Trucks), that will service Signatory and Non-Signatory Airline Operations.

COMMENCEMENT DATE:

To be determined by the Director of Transportation at a later date.

MONTHLY RENTAL:

\$3,216.25 (as determined from the DOTA schedule of rates and charges established by appraisal of Airports property statewide).

SECURITY DEPOSIT:

Three (3) times the monthly annual rental in effect.

DCCA VERIFICATION:

Place of business registration confirmed:	YES <input checked="" type="checkbox"/>	NO <input type="checkbox"/>
Registered business name confirmed:	YES <input checked="" type="checkbox"/>	NO <input type="checkbox"/>
Good standing confirmed:	YES <input checked="" type="checkbox"/>	NO <input type="checkbox"/>

CHAPTER 343, HRS - ENVIRONMENTAL ASSESSMENT:

The environmental impacts of the proposed action to the subject land area is covered by the Honolulu International Airport Master Plan Update and Noise Compatibility Program Environmental Assessment (EA), State Project No. AO1011-03. The EA is a

BLNR – ISSUANCE OF A REVOCABLE PERMIT TO STAGE FUELING VEHICLES FOR AIRCRAFT FUELING OPERATIONS, FSM GROUP, LLC

Page 3

joint State and Federal document dated September 1989, and published in the October 23, 1989 issue of the OEQC Bulletin. Accordingly, relevant mitigation from the EA and DOTA environmental best management practice will address minimal impacts from this action.

REMARKS:

In accordance with Section 171-55 HRS, relating to Permits, the DOTA proposes to issue a month-to-month revocable permit to the FSM Group, LLC, to stage fueling vehicles, that provide aircraft fuel to Signatory and Non-Signatory Airlines at the Airport.

RECOMMENDATION:

That the Board authorize the Department of Transportation to issue a month-to-month revocable permit to the FSM Group, LLC, subject to: (1) terms and conditions herein outlined, which are by reference incorporated herein; and (2) such additional terms and conditions as may be prescribed by the Director of Transportation to best serve the interests of the State.

Respectfully submitted,



JADE T. BUTAY
Director of Transportation

APPROVED FOR SUBMITTAL:

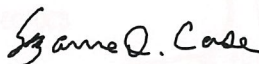

SUZANNE D. CASE
Chairperson and Member

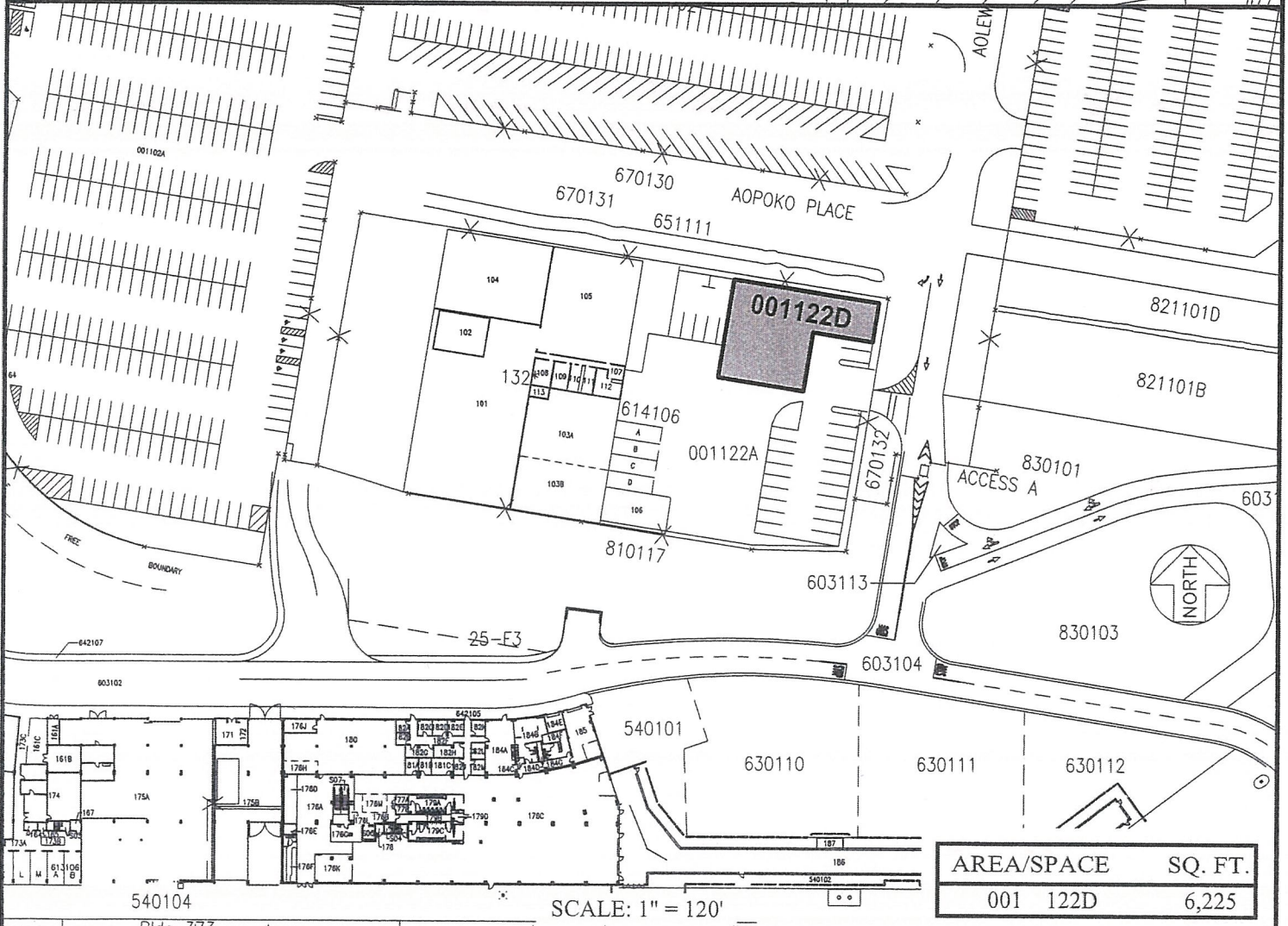
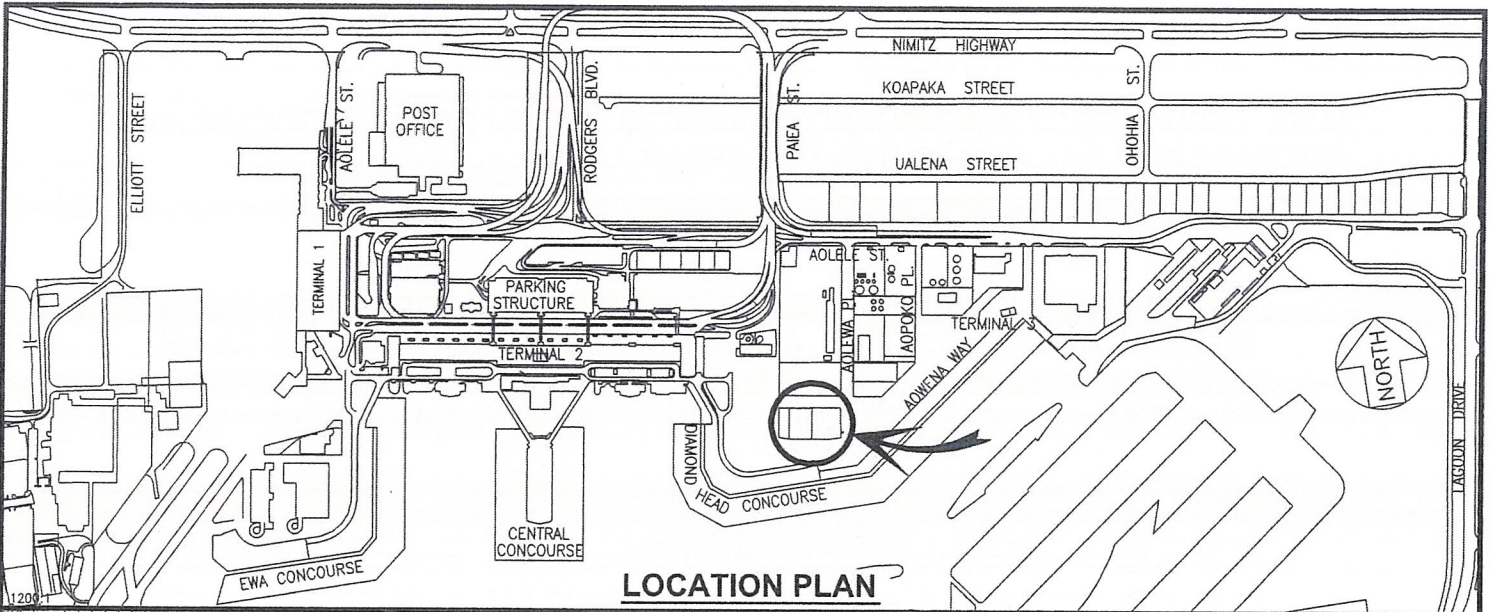

DATE : OCTOBER 2021

EXHIBIT: **A**



Airports Division

FSM GROUP

LOTS
DIAMOND HEAD SERVICE

001122D

PLAT M1