

State of Hawaii
DEPARTMENT OF LAND AND NATURAL RESOURCES
Division of Boating and Ocean Recreation
Honolulu, Hawaii 96819

January 14, 2022

Chairperson and Members
Board of Land and Natural Resources
State of Hawaii
Honolulu, Hawaii

Land Board Members:

SUBJECT: Approval of Keehi Small Boat Harbor Paving and Drainage
Improvements project; Honolulu, Oahu, Hawaii;

Declare Construction Project Exempt from the Preparation of an
Environmental Assessment,

and

Delegate Authority to Chairperson to Approve, Procure and Award
Construction Contract and Enter Into Any Supplemental Agreements
or Other Agreements Necessary to Implement the Construction
Project

REQUEST:

The Division of Boating and Ocean Recreation (“DOBOR”) is proposing drainage and paving improvements at Keehi Small Boat Harbor, Honolulu, Oahu, Hawaii. The proposed project includes raising the finish grade elevation of the Ewa side of the harbor, which has been subsiding over the years resulting in flooding of the Ewa side of the harbor at high tides. The project will also include construction of retaining walls along the perimeter of the existing Ewa-side parking lot to hold back tidal inundation, connection to existing drain sumps, asphalt paving, curbing, and striping. Draft construction plans for the proposed project are attached as **Exhibit A**.

DOBOR is requesting that the Board of Land and Natural Resources (“Board”) declare the project exempt from the requirements of Chapter 343, Hawaii Revised Statutes, and Title 11, Chapter 200.1, Hawaii Administrative Rules.

DOBOR also requests the Board to authorize the Chairperson to procure, award, and enter into consultant and construction contracts and supplemental agreements for consultant and construction contracts, and to enter into and execute any other documents or agreements, including, but not limited to, rights of entry or other permit applications, related to implementation of the project, if necessary and appropriate.

DISCUSSION:

Item J-2

DOBOR has set aside funds for this project from its Boating Special Fund. The project had initially been designed to be completed in two (2) phases to keep each phase within the BSF ceiling limit set by the legislature. Since DOBOR's BSF ceiling has been increased, DOBOR is now proposing to combine the 2-phase project into one project. DOBOR needs to procure the services of a consultant to obtain all necessary permits, prepare plans, specifications, and bidding documents and provide services during bidding and construction.

Funding for this project is authorized under Act 88, Session Laws of Hawaii 2021, Item H-7 and other appropriations approved by the legislature for which funds have not lapsed.

All necessary permits and agency approvals will be obtained prior to starting construction.

The implementation of this project will comply with Budget Execution Policies issued by the Governor through the Department of Budget and Finance.

All procurements will be made in accordance with State Procurement Code, Hawaii Revised Statutes (HRS) Chapter 103D.

HRS CHAPTER 343 - ENVIRONMENTAL ASSESSMENT:

The project will comply with applicable provisions of HRS Chapter 343, and Title 11, Chapter 200.1, Hawaii Administrative Rules (HAR), regarding environmental assessments and impact statements. DOBOR is proposing that the project be declared exempt from the applicable provisions of HRS Chapter 343 and HAR Chapter 200.1 under the Exemption List for the Department of Land and Natural Resources, concurred on by the Environmental Council on November 10, 2020 as follows:

General Exemption Type 2, Part 1, Item 6:

"Minor upgrades or replacement of existing utilities and drainage systems. Drainage improvements will generally consist of the installation of culverts, pipes, and construction of gutters or other similar infrastructure where minor flooding occurs.", and

General Exemption Type 2, Part 1, Item 18:

"Replacement or reconstruction of existing roadways, roadway shoulders, road structures and signage, parking areas, walkways, bikeways, multi-use pathways, driveways, and boat launch ramps."

DOBOR requests that the Board declare the project exempt from the preparation of an EA under the above exemption.

RECOMMENDATION:

1. That the Board declare the project exempt from the preparation of an Environmental Assessment.
2. That the Board delegate authority to the Chairperson to procure, award, and enter into consultant and construction contracts and, if necessary, supplemental

consultant and construction agreements, in accordance with HRS Chapter 103D and to enter into and execute any other documents or agreements necessary to implement the project, subject to available funding, release of funds by the Governor, and review and approval as to form by the Department of the Attorney General.

Respectfully Submitted,



EDWARD R. UNDERWOOD, Administrator
Division of Boating & Ocean Recreation

APPROVED FOR SUBMITTAL:

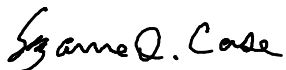

SUZANNE D. CASE, Chairperson
Board of Land and Natural Resources

Attachment:

- A. Construction Plans: Keehi Small Boat Harbor Paving Improvements
Phases 2 and 3

GENERAL NOTES:

1. ALL APPLICABLE CONSTRUCTION WORK SHALL BE PERFORMED IN ACCORDANCE WITH THE HAWAII STANDARD SPECIFICATIONS FOR ROAD AND BRIDGE CONSTRUCTION, 2005, AS AMENDED.
2. THE CONTRACTOR SHALL BE RESPONSIBLE FOR CONFORMANCE WITH THE APPLICABLE PROVISIONS CONTAINED IN THE "WATER SYSTEM STANDARDS" STATE OF HAWAII 2002, AS AMENDED.
3. THE CONTRACTOR SHALL COORDINATE AND SCHEDULE ALL WORK WITH THE DLNR DIVISION OF BOATING AND OCEAN RECREATION SO AS NOT TO DISRUPT THE OPERATIONS OF THE EXISTING FACILITIES.
4. THE CONTRACTOR SHALL PROTECT ALL EXISTING UTILITIES WHETHER SHOWN ON THE DRAWINGS, KNOWN OR UNKNOWN, AND THE DLNR DIVISION OF BOATING AND OCEAN RECREATION SHALL CONTACT THE DLNR DIVISION OF BOATING AND OCEAN RECREATION AND APPROPRIATE RESPONSIBLE UTILITY AUTHORITY, DAMAGE TO THE UTILITIES AS A RESULT OF HIS CONSTRUCTION ACTIVITIES SHALL BE REPAIRED BY THE CONTRACTOR AT NO ADDITIONAL COST TO THE STATE.
5. EXISTING UTILITIES THAT ARE TO REMAIN IN USE, WHETHER OR NOT SHOWN ON THE DRAWINGS, SHALL BE PROTECTED AT ALL TIMES DURING CONSTRUCTION. DAMAGES TO SUCH EXISTING UTILITIES SHALL BE REPAIRED AND PAID FOR BY THE CONTRACTOR.
6. UNLESS RELOCATION IS CALLED FOR, EXISTING UTILITIES SHALL REMAIN IN SERVICE AND IN PLACE. IF RELOCATION OF EXISTING UTILITIES IS REQUIRED BY THE CONTRACTOR, INTERRUPTION OF SERVICE SHALL BE KEPT TO A MINIMUM AND SHALL BE DONE AT THE CONTRACTOR'S EXPENSE. THE CONTRACTOR SHALL MAINTAIN ALL UTILITIES AT ALL TIMES.
7. THE CONTRACTOR'S ACCESS TO AND MOVEMENT WITHIN THE AREAS OF WORK SHALL BE COORDINATED WITH THE DLNR DIVISION OF BOATING AND OCEAN RECREATION.
8. THE CONTRACTOR WILL BE REQUIRED TO ARRANGE HIS WORK SO AS TO MINIMIZE INTERFERENCE WITH PUBLIC, LOCAL TRAFFIC AND WORKING OPERATIONS OF THE BUSINESSES WITHIN THE AREA.
9. DO NOT STORE MATERIALS OR EQUIPMENT, OR OPERATE OR PARK EQUIPMENT NEAR OR UNDER THE BRANCHES OF EXISTING PLANTS AND TREES THAT ARE TO REMAIN, EXCEPT AS REQUIRED FOR CONSTRUCTION IN THOSE AREAS. THE CONTRACTOR SHALL PROTECT ALL EXISTING TREES TO REMAIN.
10. THE CONTRACTOR SHALL BE RESPONSIBLE FOR DAMAGE RESULTING FROM HIS OPERATIONS AND REPAIR OR REPLACE SUCH DAMAGE AT CONTRACTOR'S EXPENSE. REPAIR DAMAGE IN A MANNER SATISFACTORY TO THE ENGINEER.
11. SAFETY BARRIERS AND APPROPRIATE WARNING SIGNS AND DEVICES SHALL BE PROVIDED AT ALL TIMES FOR THE SAFETY OF PEDESTRIANS AND/OR VEHICLES. THE CONTRACTOR SHALL PROVIDE SAFE ACCESS TO AND FROM ALL DRIVEWAYS AND ROADWAYS.
12. VERIFY AND CHECK ALL DIMENSIONS AND DETAILS PRIOR TO THE START OF CONSTRUCTION. MISMATCHES SHALL BE BROUGHT TO THE ATTENTION OF THE ENGINEER.
13. CONTRACTOR WILL FOLLOW APPLICABLE RULES AND REGULATIONS REGARDING NOISE, DUST CONTROL, VEHICULAR EQUIPMENT AND PROJECT RELATED ACTIONS.
14. EXPOSED AREAS SHALL BE BACKFILLED WITH A MINIMUM OF 6 INCHES OF TOPSOIL AND GRASSED. EXPOSED AREAS SHALL BE DEFINED AS THOSE AREAS WHERE DISTURBANCE OCCURS DUE TO DEMOLITION, EXCAVATION, OR CONSTRUCTION AND WHERE NO STRUCTURES OR PAVEMENTS ARE TO BE CONSTRUCTED.
15. THE CONTRACTOR SHALL PROTECT EXISTING STRUCTURES. ALL DAMAGES SHALL BE REPAIRED OR REPLACED AT NO COST AND TO THE SATISFACTION OF THE ENGINEER. REPORT TO ACCORDANCE WITH THE CONSTRUCTION SHALL BE CONSIDERED INCIDENTAL TO THE NEW WORK.
16. CONTRACTOR SHALL ALLOW CONSTRUCTION TOLERANCE IN ORDER TO MEET THE MINIMUM AND MAXIMUM REQUIREMENTS AS INDICATED IN THE CONSTRUCTION DRAWINGS AND SPECIFICATIONS.
17. IN THE EVENT ANY ARTIFACTS OR HUMAN REMAINS ARE UNCOVERED DURING CONSTRUCTION OPERATIONS, THE CONTRACTOR SHALL IMMEDIATELY SUSPEND WORK AND NOTIFY THE HAWAII POLICE DEPARTMENT, AND THE STATE DEPT. OF LAND AND NATURAL RESOURCES--HISTORIC PRESERVATION DIVISION (608-933-7653).
18. PROVIDE SAFEGUARDS AND EXERCISE CAUTION AGAINST INJURY OR DEFACEMENT OF EXISTING SITE IMPROVEMENTS. VEHICLES SHALL NOT PASS OVER WALKWAYS AND CURBS, UNLESS PROTECTION HAS BEEN PROVIDED.

19. THE CONTRACTOR SHALL BE FULLY RESPONSIBLE FOR HIS CONSTRUCTION METHODS, AND FOR JOBSITE SAFETY REQUIREMENTS AND PRECAUTIONS.
20. THE BOATING FACILITY SHALL BE IN USE AND REMAIN OPEN DURING THE CONSTRUCTION PERIOD. THE CONTRACTOR SHALL INSTALL ADEQUATE TEMPORARY BARRICADES AND WARNING SIGNS TO PROTECT THE PUBLIC DURING THE CONSTRUCTION PERIOD.
21. WHERE EXISTING VALVE BOXES, MANHOLES, CLEANOUTS, MONITORING WELL COVERS, AND ANY OTHER UTILITY BOXES ARE ENCOUNTERED, THE CONTRACTOR IS REQUIRED TO RAISE THEM TO FINISH GRADE TO THE SATISFACTION OF THE ENGINEER.
22. THE LOCATION OF EXISTING UTILITIES KNOWN TO EXIST BY THE ENGINEER ARE APPROXIMATE AND NOTED ON THE PLANS. THE CONTRACTOR SHALL VERIFY THE LOCATION AND DEPTH OF ALL EXISTING UTILITIES AND EXERCISE PROPER CARE WHEN EXCAVATING UTILITIES ARE SHOWN ON THE PLANS. THE CONTRACTOR SHALL EXPOSE THE EXISTING LINES AND VERIFY THE LOCATION AND DEPTH BEFORE EXCAVATION AND PLACEMENT OF THE NEW LINES.
23. THE CONTRACTOR SHALL BE RESPONSIBLE FOR CONFORMANCE WITH THE APPLICABLE PROVISIONS OF THE WATER QUALITY AND WATER POLLUTION CONTROL STANDARDS CONTAINED IN HAWAII ADMINISTRATIVE RULES, CHAPTER 11-54, "WATER QUALITY STANDARDS" AND CHAPTER 11-55 "WATER POLLUTION CONTROL," AS WELL AS CHAPTER 14 OF THE REVISED ORDINANCES OF HONOLULU, AS AMENDED. BEST MANAGEMENT PRACTICES SHALL BE EMPLOYED AT ALL TIMES DURING CONSTRUCTION.
24. THE CONTRACTOR SHALL, AT THEIR OWN EXPENSE, KEEP THE PROJECT AND SURROUNDING AREAS FREE FROM DUST, NUISANCE, RUBBISH, AND NOISE. THE WORK SHALL BE IN CONFORMANCE WITH THE AIR AND NOISE CONTROL STANDARDS AND REGULATIONS OF THE STATE DEPARTMENT OF HEALTH.
25. THE CONTRACTOR SHALL RESTORE TO THEIR ORIGINAL CONDITION ALL IMPROVEMENTS DAMAGED AS A RESULT OF THEIR ACTIVITIES. THESE REQUIREMENTS INCLUDE: CURBS, SIDEWALKS, WALLS, SIGNS, LANDSCAPING, STRUCTURES, UTILITIES, SIDEWALKS, WALLS, FENCES, ETC. UNLESS PROVIDED FOR SPECIFICALLY IN THE PROPOSAL, DEMOLITION AND RESTORATION ACTIVITIES SHALL BE CONSIDERED INCIDENTAL AND INCLUDED IN THE AMOUNT PAID FOR INSTALLATION OF THE WATERLINE.
26. THE CONTRACTOR AGREES THAT THEY SHALL ASSUME SOLE RESPONSIBILITY FOR THE JOB SITE CONDITIONS DURING CONSTRUCTION, INCLUDING THE SAFETY OF ALL PERSONS AND PROPERTY; AND THAT THESE REQUIREMENTS APPLY TO ALL CONTRACTORS AND SUBCONTRACTORS. THE CONTRACTOR SHALL DEFEND, INDEMNIFY, AND HOLD THE OWNER AND ENGINEER HARMLESS FROM ANY AND ALL LIABILITY, REAL OR ALLEGED, IN CONNECTION WITH THE PERFORMANCE OF WORK ON THIS PROJECT, EXCEPT FOR LIABILITY ARISING FROM THE SOLE NEGLIGENCE OF THE OWNER OR ENGINEER.

HEALTH, SAFETY AND CONVENIENCE:

1. THE CONTRACTOR SHALL OBSERVE AND COMPLY WITH ALL FEDERAL, STATE AND LOCAL LAWS, ORDINANCES, RULES AND REGULATIONS OF PUBLIC HEALTH AND SAFETY AND ENVIRONMENTAL QUALITY.
2. THE CONTRACTOR, AT HIS OWN EXPENSE, SHALL KEEP THE PROJECT AND ITS SURROUNDING AREAS FREE FROM DUST, NUISANCE, THE WORK AND EXCAVATION SHALL BE IN CONFORMANCE WITH THE AIR AND NOISE STANDARDS AND REGULATIONS OF THE STATE DEPARTMENT OF HEALTH. THE COUNTY SHALL REQUIRE SUPPLEMENTARY MEASURES AS NECESSARY.

TRAFFIC NOTES:

1. THE CONTRACTOR SHALL PROVIDE TRAFFIC CONTROL ALONG ROADWAY AREAS DURING ALL PHASES OF CONSTRUCTION.
2. THE CONTRACTOR SHALL PROVIDE, INSTALL AND MAINTAIN ALL NECESSARY SIGNS AND OTHER PROTECTIVE FACILITIES, WHICH SHALL CONFORM WITH THE "HAWAII ADMINISTRATION RULES GOVERNING THE USE OF TRAFFIC CONTROL DEVICES AT WORK SITES ON OR ADJACENT

TO STREETS AND HIGHWAYS" AS ADOPTED BY THE DIRECTOR OF TRANSPORTATION, AND THE CURRENT U.S. FEDERAL HIGHWAY ADMINISTRATION'S "MANUAL ON UNIFORM TRAFFIC CONTROL DEVICES FOR STREETS AND HIGHWAYS, PART VI--TRAFFIC CONTROLS FOR STREETS AND HIGHWAY CONSTRUCTION AND MAINTENANCE OPERATIONS.

3. ALL CONSTRUCTION WARNING SIGNS SHALL BE PROMPTLY REMOVED OR COVERED WHENEVER THE MESSAGE IS NOT APPLICABLE OR NOT IN USE. THE BACKS OF ALL SIGNS USED FOR TRAFFIC CONTROL SHALL BE PROMPTLY REMOVED OR COVERED TO PRECLUDE THE DISPLAY OF INAPPLICABLE SIGN MESSAGES (I.E. WHEN SIGNS HAVE MESSAGES ON BOTH FACES).

4. THE CONTRACTOR SHALL PROVIDE FLAGMEN OR OFF-DUTY POLICE OFFICERS TO CONTROL THE FLOW OF TRAFFIC, AS REQUIRED.

5. THE CONTRACTOR SHALL REPAIR OR REPLACE ALL TRAFFIC SIGNS, POSTS AND PAVEMENT MARKINGS DISTURBED BY HIS ACTIVITIES.

6. THE CONTRACTOR SHALL BE RESPONSIBLE FOR ANY DAMAGES TO EXISTING STREET LIGHTING AND DAMAGES SHALL BE REPAIRED BY THE CONTRACTOR.

BMP NOTES:

1. LIMIT THE POINTS OF ENTRANCE/EXIT TO THE CONSTRUCTION SITE.
2. LIMIT SPEED OF VEHICLES TO CONTROL DUST.
3. PROPERLY GRADE EACH CONSTRUCTION ENTRANCE/EXIT TO PREVENT RUNOFF FROM LEAVING THE CONSTRUCTION SITE. SEE BMP PLAN ON SHEET C-4 FOR DETAILS.
4. CONSTRUCTION INGRESS/EGRESS SHALL BE CONSTRUCTED WITH AGGREGATE SUITABLE TO LAST THROUGH THE DURATION OF CONSTRUCTION. SEE DETAIL ON SHEET C-2. THE USE OF ASPHALT CONCRETE (AC) GRINDINGS FOR STABILIZED CONSTRUCTION ACCESS/ROADWAY IS NOT ALLOWED.
5. USE OF AGGREGATE OR CONSTRUCTED/MANUFACTURED STEEL PLATES WITH RIBS OR THE ALTERNATE WASH RACK DESIGN FOR ENTRANCE / EXIT MAY BE ALLOWED. SEE SHEET C-4 FOR DETAIL.
6. IF AGGREGATE IS SELECTED, PLACE CRUSHED AGGREGATE OVER GEOTEXTILE FABRIC TO AT LEAST 300 MM (12 IN) DEPTH.
7. CRUSHED AGGREGATE GREATER THAN 75 MM (3 INCHES) AND SMALLER THAN 150 MM (6 INCHES) SHALL BE USED.
8. DESIGNATE COMBINATION OR SINGLE PURPOSE ENTRANCES AND EXITS TO THE CONSTRUCTION SITE.
9. REQUIRE ALL EMPLOYEES, SUBCONTRACTORS, AND SUPPLIERS TO UTILIZE THE STABILIZED CONSTRUCTION ACCESS.
10. INSPECT MONTHLY AND AFTER EACH RAINFALL.
11. REMOVE ALL SEDIMENT DEPOSITED ON PAVED ROADWAYS WITHIN 24 HOURS.
12. REMOVE GRAVEL AND FILTER FABRIC AT COMPLETION OF CONSTRUCTION.

PROJECT NO.	DATE	REVISED	DATE	REVISED
STATE OF HAWAII				
DEPARTMENT OF LAND AND NATURAL RESOURCES				
DIVISION OF BOATING AND OCEAN RECREATION				
KEEP SMALL BOAT HARBOR PAVING IMPROVEMENTS, PHASE 2				
CONSTRUCTION NOTES				
DESIGNED	WD	SUBMITTED		
DRAWN	WD	DATE		
CHECKED	FM	SCALE		
DRAWING NO.				G-1

GRADING NOTES:

1. ALL GRADING WORK SHALL BE DONE IN ACCORDANCE WITH CHAPTER 16, AS AMENDED, OF THE REVISED ORDINANCES OF HONOLULU, 1990, AS AMENDED.
2. NO CONTRACTOR SHALL PERFORM ANY GRADING OPERATION SO AS TO CAUSE FALLING ROCKS, SOIL OR DEBRIS IN ANY FORM TO FALL, SLIDE OR OTHERWISE BECOME A HAZARD TO THE PUBLIC OR TO ADJACENT WATERCOURSES. SHOULD SUCH VIOLATIONS OCCUR, THE CONTRACTOR MAY BE CITED AND THE CONTRACTOR SHALL IMMEDIATELY MAKE ALL REMEDIAL ACTIONS NECESSARY.
3. THE CONTRACTOR, AT HIS OWN EXPENSE, SHALL KEEP THE PROJECT AREA AND SURROUNDING AREA FREE FROM DUST NUISANCE. THE WORK SHALL BE IN CONFORMANCE WITH THE AIR POLLUTION CONTROL STANDARDS CONTAINED IN THE HAWAII ADMINISTRATIVE RULES, TITLE 11, CHAPTER 60.1, "AIR POLLUTION CONTROL".
4. THE UNDERGROUND PIPES, CABLES OR DUCTLINES KNOWN TO EXIST BY THE ENGINEER FROM HIS SEARCH OF RECORDS ARE INDICATED ON THE PLANS. THE CONTRACTOR SHALL VERIFY THE LOCATIONS AND DEPTHS OF THE FACILITIES AND EXERCISE PROPER CARE IN EXCAVATING IN THE AREA WHEREVER CONNECTIONS OF NEW UTILITIES ARE MADE TO EXISTING UTILITIES. THE CONTRACTOR SHALL MARK THE EXISTING LINES AT THE PROPOSED CONNECTIONS TO VERIFY THEIR LOCATIONS AND DEPTHS PRIOR TO EXCAVATION FOR THE NEW LINES.
5. ADEQUATE PROVISIONS SHALL BE MADE TO PREVENT SURFACE WATERS FROM BEING RUN OFF THE PROJECT AREA. THE CONTRACTOR SHALL BE MADE TO PREVENT SEDIMENT-LADEN RUNOFF FROM LEAVING THE SITE.
6. ALL SLOPES AND EXPOSED AREAS SHALL BE SOOLED OR PLANTED AS SOON AS FINAL GRADES HAVE BEEN ESTABLISHED. PLANTING SHALL NOT BE DELAYED UNTIL ALL GRADING WORK HAS BEEN COMPLETED. GRADING TO FINAL GRADE SHALL BE CONTINUOUS, AND ANY AREA WITHIN WHICH WORK HAS BEEN INTERRUPTED OR DELAYED SHALL BE PLANTED.
7. FILLS ON SLOPES STEEPER THAN 5:1 SHALL BE KEYED.
8. THE CITY SHALL BE INFORMED OF THE LOCATION OF THE BORROW/DISPOSAL SITE FOR THE PROJECT WHEN THE APPLICATION FOR A GRADING PERMIT IS MADE. THE BORROW/DISPOSAL SITE MUST ALSO FULFILL THE REQUIREMENTS OF THE GRADING ORDINANCE.
9. NO GRADING WORK SHALL BE DONE ON SATURDAYS, SUNDAYS AND HOLIDAYS AT ANY TIME WITHOUT PRIOR NOTICE TO THE DIRECTOR, D.P.P.. PROVIDED SUCH GRADING WORK IS ALSO IN CONFORMANCE WITH THE REVISIONS TO THE HAWAII ADMINISTRATIVE RULES, TITLE 11, CHAPTER 46, "COMMUNITY NOISE CONTROL".
10. THE LIMITS OF THE AREA TO BE GRADED SHALL BE FLAGGED BEFORE THE COMMENCEMENT OF THE GRADING WORK.
11. THE GENERAL CONTRACTOR/DEVELOPER/OWNER OF THE PROJECT SHALL BE RESPONSIBLE FOR ALL GRADING OPERATIONS TO BE PERFORMED IN CONFORMANCE WITH APPLICABLE PROVISIONS OF THE HAWAII ADMINISTRATIVE RULES, TITLE 11, CHAPTER 54, "WATER QUALITY STANDARDS," AND TITLE 11, CHAPTER 55, "WATER POLLUTION CONTROL," AS WELL AS CHAPTER 14 OF THE REVISED ORDINANCES OF HONOLULU, AS AMENDED, BEING IN CONSTRUCTION. THE CONTRACTOR SHALL BE EMPLOYED AT ALL TIMES DURING CONSTRUCTION.
- THE GENERAL CONTRACTOR/DEVELOPER/OWNER OF THE PROJECT SHALL OBTAIN NATIONAL POLLUTANT DISCHARGE ELIMINATION SYSTEM (NPDES) PERMIT COVERAGE(S) FOR THE FOLLOWING:
1. STORM WATER DISCHARGES ASSOCIATED WITH CONSTRUCTION
 2. DISCHARGES OF HYDROTESTING EFFLUENT, Dewatering EFFLUENT, AND WELL DRILLING EFFLUENT TO STATE WATERS.
- IN ACCORDANCE WITH STATE LAW, ALL DISCHARGES RELATED TO PROJECT CONSTRUCTION OR OPERATIONS ARE REQUIRED TO COMPLY WITH STATE WATER QUALITY STANDARDS (HAWAII ADMINISTRATIVE RULES, CHAPTER 11-54). BEST MANAGEMENT PRACTICES SHALL BE USED TO MINIMIZE OR PREVENT THE DISCHARGE OF SEDIMENT, DEBRIS, AND OTHER POLLUTANTS TO STATE WATERS. COPIES OF THE NPDES PERMIT FROM THE DEPARTMENT OF LAND AND NATURAL RESOURCES (<http://health.hawaii.gov/owb>). THE OWNER/DEVELOPER/CONTRACTOR IS RESPONSIBLE FOR OBTAINING OTHER FEDERAL, STATE, OR LOCAL AUTHORIZATIONS AS REQUIRED BY LAW.
12. WHERE APPLICABLE AND FEASIBLE THE MEASURES TO CONTROL EROSION AND OTHER POLLUTANTS SHALL BE IN PLACE BEFORE ANY

EARTH MOVING PHASE OF THE GRADING IS INITIATED.

13. TEMPORARY EROSION CONTROLS SHALL NOT BE REMOVED BEFORE PERMANENT EROSION CONTROLS ARE IN-PLACE AND ESTABLISHED.
14. TEMPORARY EROSION CONTROL PROCEDURES SHALL BE SUBMITTED FOR APPROVAL PRIOR TO APPLICATION FOR GRADING PERMIT.
15. IF THE GRADING WORK INVOLVES CONTAMINATED SOIL, THE CONTRACTOR SHALL BE IN FULL COMPLIANCE WITH APPLICABLE STATE AND FEDERAL REQUIREMENTS.
16. BUILDING PERMIT FOR RETAINING WALLS SHALL BE OBTAINED PRIOR TO COMMENCEMENT OF GRADING WORK ON SITE.
17. FOR NON-CITY PROJECTS, THE CONTRACTOR SHALL NOTIFY THE CIVIL ENGINEERING BRANCH, D.P.P., AT 788-8084 TO ARRANGE FOR INSPECTIONAL SERVICES AND SUBMIT TWO (2) SETS OF APPROVED CONSTRUCTION PLANS SEVEN (7) DAYS PRIOR TO COMMENCEMENT OF CONSTRUCTION WORK. FOR CITY PROJECTS, THE CONTRACTOR SHALL PROVIDE INSPECTIONAL SERVICES WITH THE RESPONSIBLE CITY AGENCY.
18. PURSUANT TO CHAPTER 6E, HRS, IN THE EVENT ANY ARTIFACTS OR HUMAN REMAINS ARE UNCOVERED DURING CONSTRUCTION OPERATIONS, THE CONTRACTOR SHALL IMMEDIATELY STOP WORK AND NOTIFY THE HONOLULU POLICE DEPARTMENT, THE STATE DEPARTMENT OF LAND AND NATURAL RESOURCES-HISTORIC PRESERVATION DIVISION (682-8015). IN ADDITION, FOR NON-CITY PROJECTS, THE CONTRACTOR SHALL INFORM THE CIVIL ENGINEERING BRANCH, D.P.P. (788-8084); AND FOR CITY PROJECTS, NOTIFY THE RESPONSIBLE CITY AGENCY.
19. FOR ALL PROJECTS, WHICH WILL DISTURB ONE (1) ACRE OR MORE OF LAND, THE CONTRACTOR SHALL NOT START CONSTRUCTION UNTIL A NOTICE OF GENERAL PERMIT COVERAGE (NGPC) IS RECEIVED FROM THE DEPARTMENT OF HEALTH, STATE OF HAWAII, AND HAS SATISFIED ANY OTHER APPLICABLE REQUIREMENTS OF THE NPDES PERMIT PROGRAM. ALSO, FOR NON-CITY AND OTHER NON-GOVERNMENTAL PROJECTS, THE CONTRACTOR SHALL OBTAIN A WRITTEN COPY OF THE NGPC TO THE PERMITTING AND INSPECTION SECTION, CIVIL ENGINEERING BRANCH, D.P.P., AT LEAST SEVEN (7) CALENDAR DAYS BEFORE THE START OF THE CONSTRUCTION, FOR CITY OR OTHER GOVERNMENTAL PROJECTS, THE CONTRACTOR SHOULD PROVIDE A WRITTEN COPY OF THE NGPC TO THE CIVIL ENGINEERING CITY DEPARTMENT OR GOVERNMENTAL AGENCY PER THEIR REQUIREMENTS.
20. ALL GRADING AND CONSTRUCTION WORK SHALL IMPLEMENT MEASURES TO ENSURE THAT THE DISCHARGE OF POLLUTANTS FROM THE CONSTRUCTION SITE WILL BE REDUCED TO THE MAXIMUM EXTENT POSSIBLE. THE CONTRACTOR SHALL BE RESPONSIBLE FOR PREVENTING EXCESSIVE DISCHARGE OF WATER QUALITY STANDARDS.
21. NON-COMPLIANCE TO ANY OF THE ABOVE REQUIREMENTS SHALL MEAN IMMEDIATE SUSPENSION OF ALL WORK, AND REMEDIAL WORK SHALL BE COMPLETED BEFORE THE PROJECT IS RE-OPENED. THE VIOLATOR FURTHERMORE, VIOLATORS SHALL BE SUBJECT TO ADMINISTRATIVE, CIVIL AND/OR CRIMINAL PENALTIES.
22. FOR BENCHMARK, SEE SHEET NO. 8 OF 13 SHEETS.
23. THE CONTRACTOR SHALL INFORM THE CITY AND COUNTY OF HONOLULU, CIVIL ENGINEERING BRANCH, OF THE LOCATION OF THE DISPOSAL AND/OR BORROW SITE(S) REQUIRED FOR THIS PROJECT WHEN AN APPLICATION FOR A GRADING PERMIT IS MADE. THE DISPOSAL AND/OR BORROW SITE(S) MUST ALSO FULFILL THE REQUIREMENTS OF THE GRADING ORDINANCE. NO DISPOSED MATERIAL SHALL BE PLACED WITHIN A FEDERAL EMERGENCY MANAGEMENT AGENCY SPECIAL FLOOD HAZARD AREA.
24. FILLS SHALL BE COMPACTED TO A MINIMUM 90 PERCENT (%) RELATIVE COMPACTION PER ASTM D-1557 TEST. FILLS WITHIN 3 FEET OF FINISHED PAVEMENT, GRADES SHALL BE COMPACTED TO A MINIMUM 95% RELATIVE COMPACTION.
25. THE CONTRACTOR SHALL REMOVE ALL VEGETATION, CONSTRUCTION DEBRIS, AND OTHER DELETERIOUS MATERIAL PRIOR TO FILLING OR BACKFILLING.
26. IF SOFT OR YIELDING AREAS ARE ENCOUNTERED IN FILL/BACKFILL LOCATIONS, THEY ARE TO BE OVER EXCAVATED TO EXPOSE FIRM AND/OR DENSE MATERIALS. THE EXCAVATION SHOULD THEN BE BACKFILLED WITH WELL-COMPACTED FILLS.
27. GENERAL FILL MATERIALS SHALL CONSIST OF EXCAVATED ON-SITE OR IMPORTED FILL MATERIALS, SUCH AS CLAY LUMPS AND ROCK FRAGMENTS GREATER THAN 3 INCHES IN MAXIMUM DIMENSION. IMPORTED FILL/BACKFILL MATERIALS SHALL CONSIST OF CRUSHED CORAL AND BASALT. THEY SHALL BE WELL-GRADED FROM COURSE TO FINE, WITH PARTICLES NO GREATER THAN 3 INCHES IN MAXIMUM DIMENSION. FILL MATERIALS SHALL BE PLACED IN LAYERS NOT EXCEEDING THE NO. 100 SIEVE, AND SHOULD HAVE AGRV VALUE OF 20 OR MORE AND A SWELL

VALUE OF 1% OR LESS (ASTM D-1583).

28. FILL/BACKFILL AREAS SHALL BE SCARIFIED TO A MINIMUM OF 8" AFTER CLEARING AND GRUBBING AND/OR GRADING. SOIL SHALL BE MOISTURE CONDITIONED TO ABOVE THE OPTIMUM MOISTURE CONTENT, AND COMPACTED TO A MINIMUM OF 90% RELATIVE COMPACTION (ASTM D-1557).
29. THE CONTRACTOR SHALL REMOVE ALL SILT AND DEBRIS DEPOSITED IN DRAINAGE FACILITIES, ROADWAYS AND OTHER AREAS RESULTING FROM HIS WORK. THE COSTS INCURRED FOR ANY NECESSARY REMEDIAL ACTION BY THE DPW SHALL BE PAYABLE BY THE CONTRACTOR.
- BMP/EROSION CONTROL NOTES:**
1. THE CONTRACTOR SHALL INSTALL SILT FENCES, COMPOST FILTER SOIL, DRAIN INLET PROTECTION, AND OTHER ITEMS SHOWN ON THIS EROSION CONTROL PLAN PRIOR TO CONSTRUCTION.
 2. ALL BEST MANAGEMENT PRACTICES (BMP'S) SHALL NOT BE REMOVED UNTIL ALL PERMANENT EROSION CONTROLS ARE IN PLACE AND ESTABLISHED.
 3. THE CONTRACTOR SHALL EMPLOY WATER SPRAYING AS NECESSARY TO PROVIDE ADEQUATE DUST CONTROL.
 4. THE CONTRACTOR SHALL KEEP EXISTING ROADWAYS FREE FROM SILT.
 5. ALL CONTROL MEASURES SHALL BE INSPECTED AT LEAST ONCE EACH WEEK AND WITHIN 24 HOURS FOLLOWING ANY RAINFALL EVENT OF 1/2" OR GREATER.
 6. ALL MEASURES SHALL BE MAINTAINED IN GOOD WORKING ORDER. IF REPAIRS ARE NECESSARY, IT SHALL BE INITIATED WITHIN 24 HOURS AFTER THE INSPECTION.
 7. COMPOST FILTER SOCK SHALL BE INSPECTED FOR DEPTH OF SEDIMENT, TEARS, TO VERIFY THAT THE FABRIC IS SECURELY ATTACHED TO THE STAKES OR CONCRETE SLAB AND TO VERIFY THAT THE STAKES ARE FIRM IN THE GROUND.
 8. THE CONTRACTOR SHALL SUBMIT A MAINTENANCE REPORT TO THE ENGINEER PROMPTLY AFTER EACH WEEKLY INSPECTION.
 9. THE CONTRACTOR SHALL SELECT A MINIMUM OF THREE PERSONNEL WHO SHALL BE RESPONSIBLE FOR INSPECTIONS, MAINTENANCE AND REPAIR ACTIVITIES AND FILLING OUT THE INSPECTION AND MAINTENANCE REPORT.
 10. PERSONNEL SELECTED FOR THE INSPECTION AND MAINTENANCE RESPONSIBILITIES SHALL RECEIVE TRAINING FROM THE CONTRACTOR. THEY SHALL BE TRAINED IN ALL THE INSPECTION AND MAINTENANCE PRACTICES NECESSARY FOR KEEPING THE EROSION AND SEDIMENT CONTROLS USED ON SITE IN GOOD WORKING ORDER.
 11. TEMPORARY EROSION CONTROLS SHALL NOT BE REMOVED BEFORE PERMANENT EROSION CONTROLS ARE IN-PLACE AND ESTABLISHED.
 12. THE CONTRACTOR SHALL PROVIDE CONSTRUCTION ENTRANCE FOR EACH INGRESS/EGRESS.
 13. THE CONTRACTOR SHALL COMPLETE ALL BACKFILLING WORK USING WATER AND MULCHING TO PREVENT DUST, EROSION AND SEDIMENTATION.
 14. EXPOSED AREAS SHALL BE MULCHED IMMEDIATELY AFTER GRADING FOR TEMPORARY EROSION CONTROL.

APPROVED: _____

DATE: _____

CHIEF, ENGINEERING BRANCH
DEPARTMENT OF PLANNING AND PERMITTING
CITY AND COUNTY OF HONOLULU

PROJECT NO.	DATE	APPROVED
STATE OF HAWAII		
DEPARTMENT OF LAND AND NATURAL RESOURCES		
DIVISION OF BOATING AND OCEAN RECREATION		
KEEP SMALL BOAT HARBOR PAVING IMPROVEMENTS, PHASE 2		
EROSION AND GRADING NOTES		
DESIGNED BY	WD	SUBMITTED
DRAWN BY	WD	DATE
CHECKED BY	FM	SCALE
DRAWING NO. C-1		

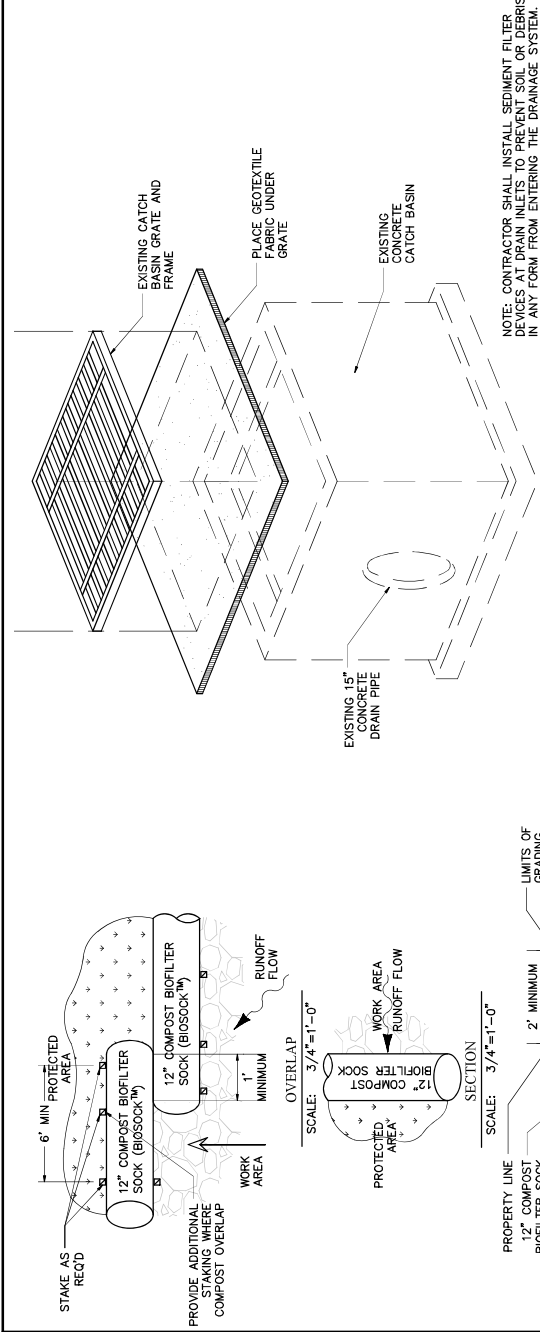

2 DRAIN INLET PROTECTION DETAIL
SCALE: NOT TO SCALE

NOTE:
1) COMPOST SHALL NOT CONTAIN BIOSOLIDS.
2) COMPOST SHALL BE CONSISTENT WITH EPA GUIDELINES.

1 COMPOSITE FILTER SOCK DETAIL
SCALE: AS SHOWN

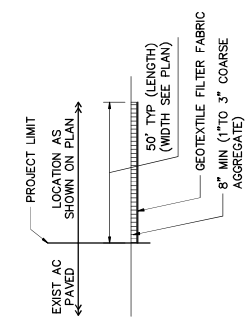

SECTION A-A
SCALE: NOT TO SCALE

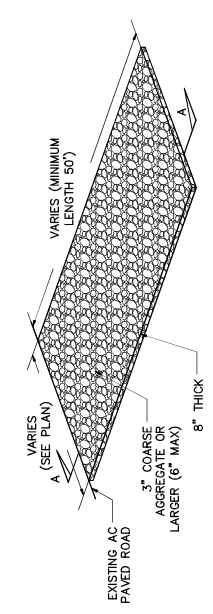

3 CONSTRUCTION INGRESS/EGRESS DETAILS
SCALE: NOT TO SCALE

NOTE: SEE SHEET C-4 FOR DIMENSIONS

APPROVED: _____ DATE: _____

CHIEF ENGINEERING BRANCH
DEPARTMENT OF PLANNING AND PERMITTING
CITY AND COUNTY OF HONOLULU

NO.	DATE	DESCRIPTION	BY	DATE	APPROVED
1		DESIGNED	WD		
2		DRAWN	WD		
3		CHECKED	FM		

STATE OF HAWAII
DEPARTMENT OF LAND AND NATURAL RESOURCES
DIVISION OF BOATING AND OCEAN RECREATION
KEEP SMALL BOAT HARBOR PAVING
IMPROVEMENTS, PHASE 2

EROSION AND GRADING DETAILS

DESIGNED: WD
DRAWN: WD
CHECKED: FM

DATE: _____
SCALE: _____

DRAWING NO. C-2

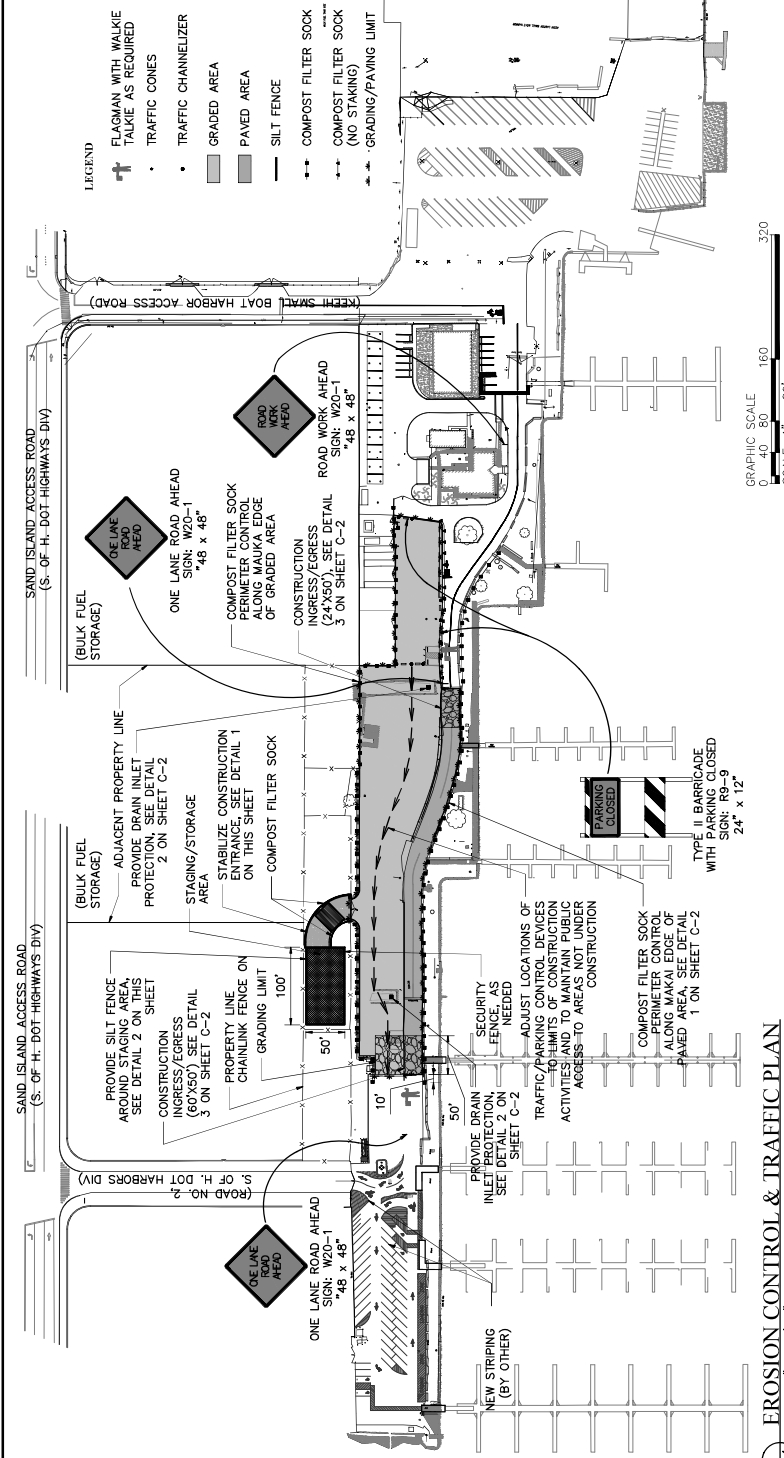

1 EROSION CONTROL & TRAFFIC PLAN
SCALE: 1" = 80'-0"

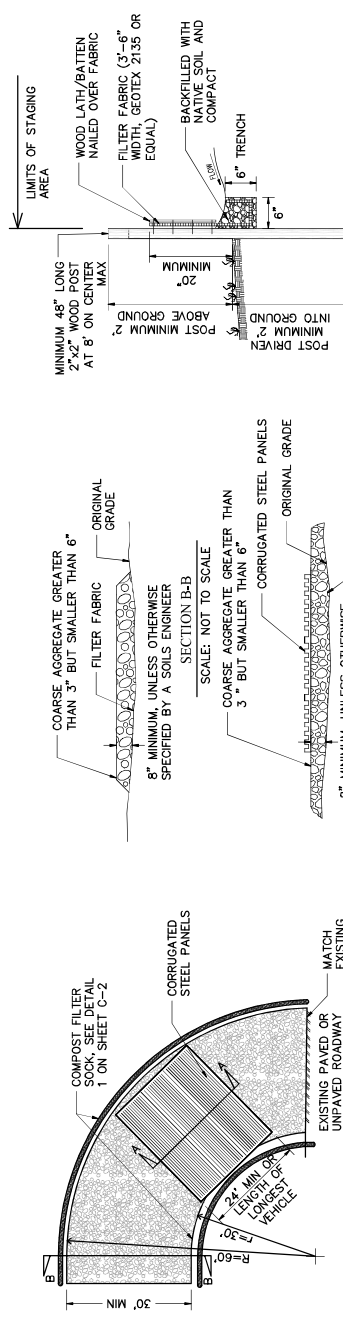

1 STABILIZED CONSTRUCTION ENTRANCE WITH WASH RACK
SCALE: 1" = 15' - 0"

2 SILT FENCE DETAIL
SCALE: NOT TO SCALE

APPROVED: _____ DATE: _____

CHIEF ENGINEERING BRANCH
DEPARTMENT OF PLANNING AND PERMITTING
CITY AND COUNTY OF HONOLULU

NO.	DESCRIPTION	DATE	APPROVED
DESIGNED	WD		
DRAWN	WD		
CHECKED	FM		

STATE OF HAWAII
DEPARTMENT OF LAND AND NATURAL RESOURCES
DIVISION OF BOATING AND OCEAN RECREATION
KEEP SMALL BOAT HARBOR PAVING
IMPROVEMENTS, PHASE 2

EROSION CONTROL & TRAFFIC PLAN

DESIGNED: WD
DATE: _____
DRAWN: WD
DATE: _____
CHECKED: FM
DATE: _____

SCALE: _____

DRAWING NO. C-4

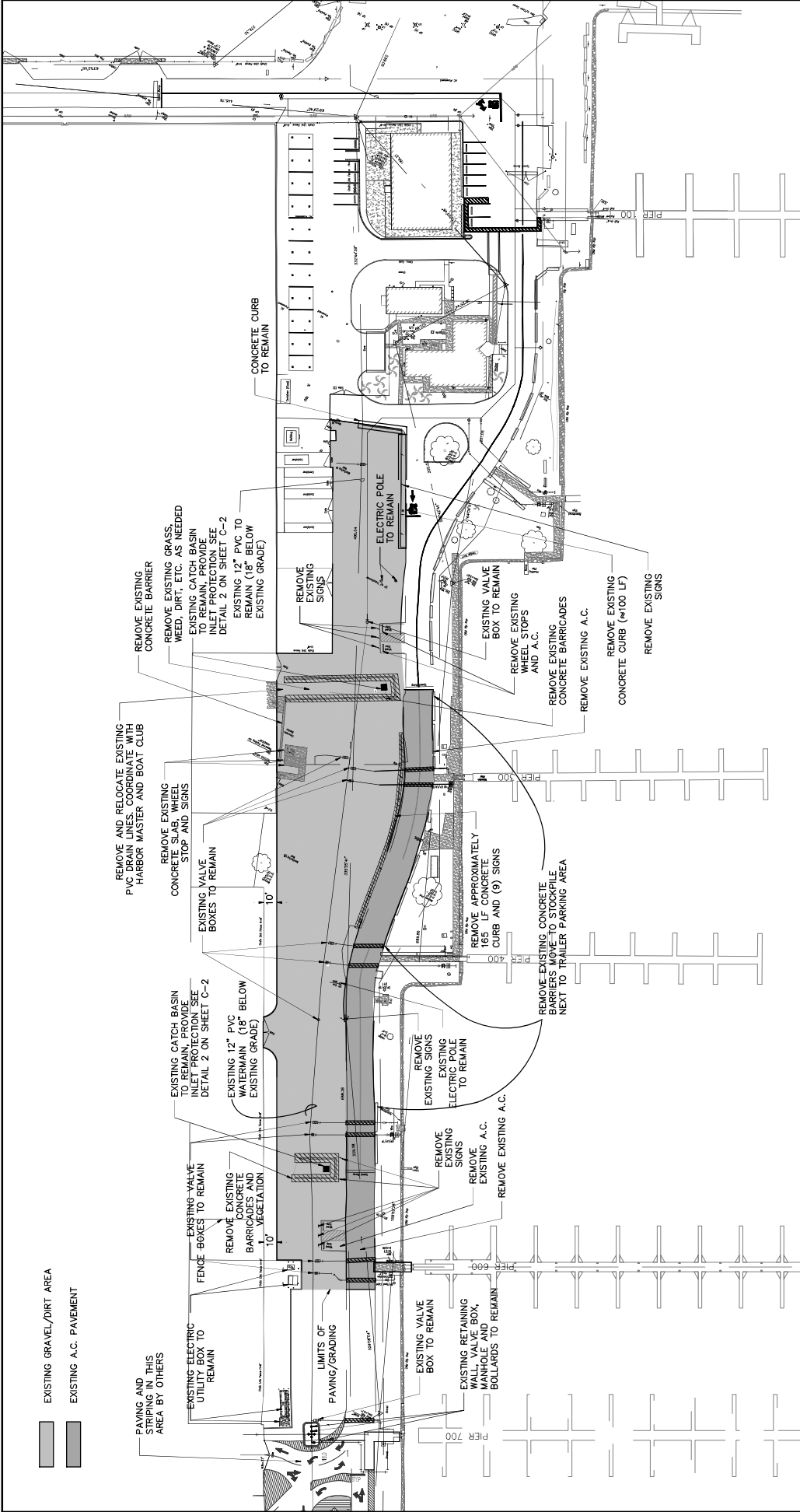

- EXISTING GRAVEL/DIRT AREA
- EXISTING A.C. PAVEMENT

- NOTES:
1. ALL REMOVED ASPHALT, CONCRETE, AND OTHER DEBRIS SHALL BE HAULED OFFSITE AND DISPOSED AT AN APPROPRIATE DISPOSAL SITE.
 2. THE LOCATION OF ALL EXISTING UTILITIES SHOWN ARE APPROXIMATE. THE LOCATION OF ALL UTILITIES, WHETHER SHOWN ON THE PLAN OR NOT, SHALL BE VERIFIED BY FIELD SURVEY PRIOR TO CONSTRUCTION.
 3. ALL EXISTING WATER, SEWER, ELECTRIC, AND OTHER UTILITY MANHOLES, HANDHOLES, VALVE BOXES, ETC. SHALL BE RAISED AND/OR MODIFIED AS NECESSARY TO MATCH FINISH GRADE OF NEW A.C. SEE SHEET C-7.

EXISTING CONDITIONS AND DEMOLITION PLAN
SCALE: 1" = 40'-0"

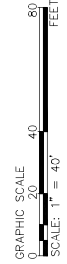

REVISION	DATE	DESCRIPTION	DESIGNED	CHECKED	APPROVED
1	01/15/2020	ISSUED FOR PERMIT	WD	WD	WD
2	02/10/2020	REVISED FOR FIELD SURVEY	WD	WD	WD
3	03/05/2020	REVISED FOR UTILITY LOCATIONS	WD	WD	WD
4	03/20/2020	REVISED FOR PAVING STRIPES	WD	WD	WD
5	04/10/2020	REVISED FOR FINAL DEMOLITION PLAN	WD	WD	WD

STATE OF MAINE	CITY OF BANGOR
DEPARTMENT OF LAND AND NATURAL RESOURCES	DIVISION OF BOATING AND OCEAN RECREATION
KEEPEE SMALL BOAT HARBOR PAVING IMPROVEMENTS, PHASE 2	
EXISTING CONDITIONS AND DEMOLITION PLAN	
DESIGNED: WD	SUBMITTED:
DRAWN: WD	DATE:
CHECKED: FM	SCALE:
DRAWING NO. C-5	

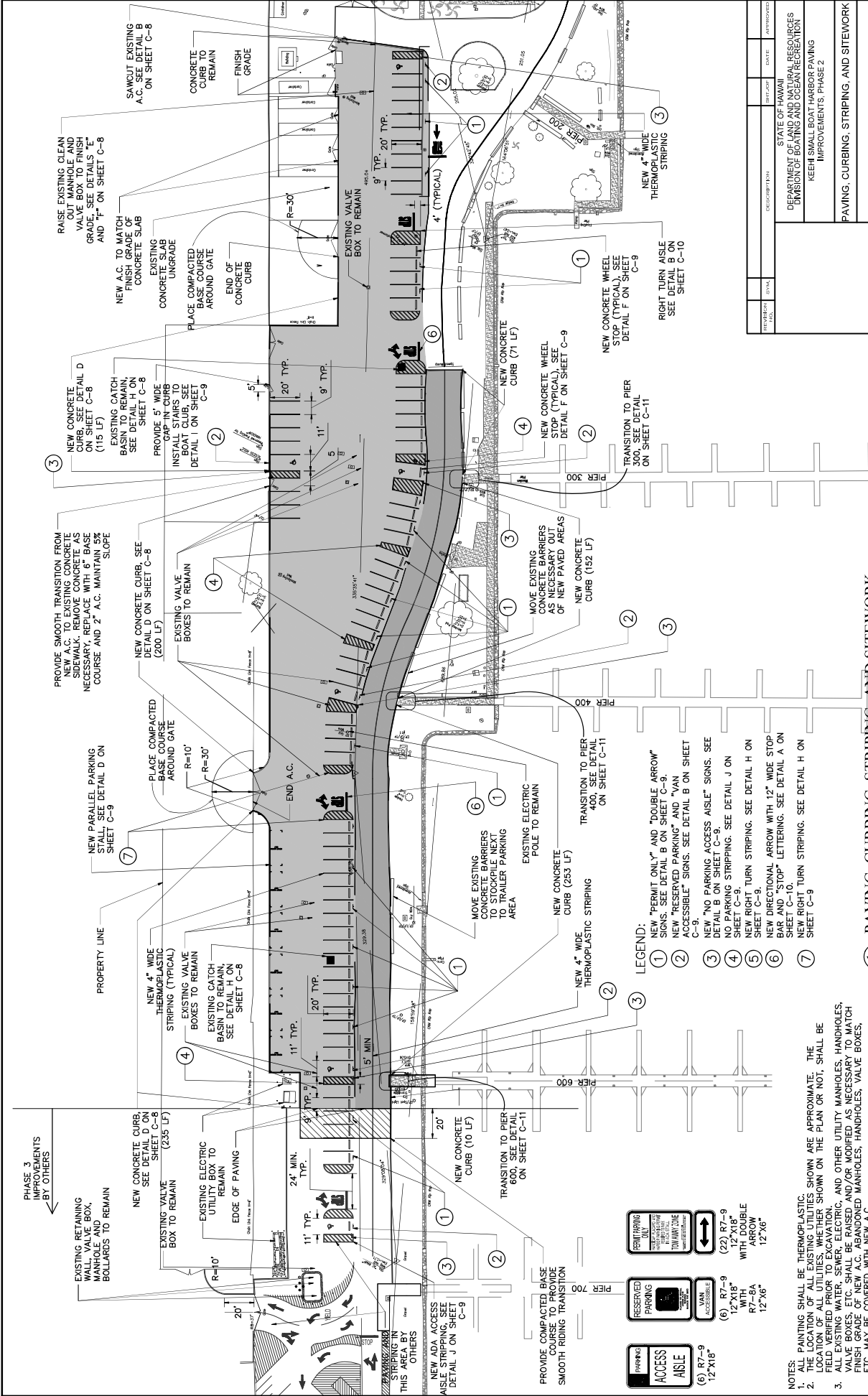

1 PAVING, CURBING, STRIPING, AND SITEWORK
C-7 SCALE: 1" = 30'-0"

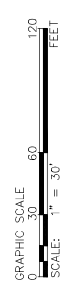

NOTES:
1. ALL PAINTING SHALL BE THERMOPLASTIC.
2. THE LOCATION OF ALL EXISTING UTILITIES SHOWN ARE APPROXIMATE. THE LOCATION OF ALL UTILITIES, WHETHER SHOWN ON THE PLAN OR NOT, SHALL BE FIELD VERIFIED PRIOR TO EXCAVATION.
3. ALL EXISTING WATER, SEWER, ELECTRIC, AND OTHER UTILITY MANHOLES, HANDHOLES, ETC. MAY BE COVERED WITH NEW A.C. ABANDONED MANHOLES, HANDHOLES, VALVE BOXES, ETC. MAY BE COVERED WITH NEW A.C.

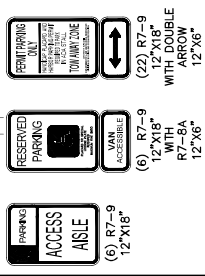

- LEGEND:
- 1 NEW "PERMIT ONLY" AND "DOUBLE ARROW" SIGNS. SEE DETAIL B ON SHEET C-9.
 - 2 NEW "RESERVED PARKING" AND "VAN ACCESSIBLE" SIGNS. SEE DETAIL B ON SHEET C-9.
 - 3 NEW "NO PARKING ACCESS AISLE" SIGNS. SEE DETAIL B ON SHEET C-9.
 - 4 NO PARKING STRIPING. SEE DETAIL J ON SHEET C-9.
 - 5 NEW RIGHT TURN STRIPING. SEE DETAIL H ON SHEET C-9.
 - 6 NEW DIRECTIONAL ARROW WITH 12" WIDE STOP SIGN. SEE DETAIL A ON SHEET C-11.
 - 7 NEW RIGHT TURN STRIPING. SEE DETAIL H ON SHEET C-9.

PROJECT NO.	DATE	APPROVED
STATE OF HAWAII		
DEPARTMENT OF LAND AND NATURAL RESOURCES		
DIVISION OF BOATING AND OCEAN RECREATION		
KEEP SMALL BOAT HARBOR PAVING IMPROVEMENTS, PHASE 2		
PAVING, CURBING, STRIPING, AND SITEWORK		
DESIGNED BY	DATE	SUBMITTED
DRAWN BY	DATE	DATE
CHECKED BY	DATE	SCALE
DRIVING INC.		

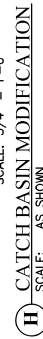
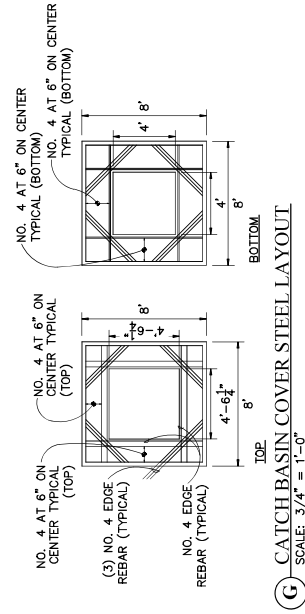
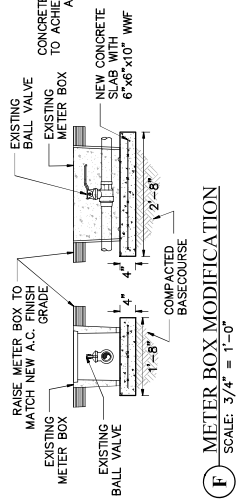
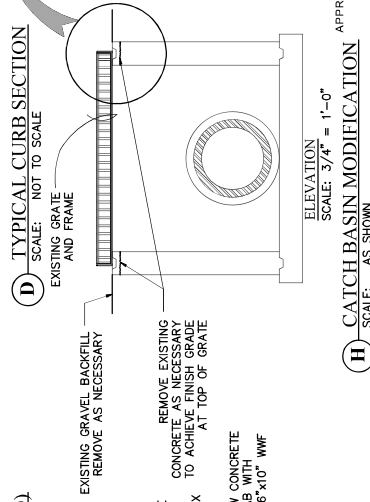
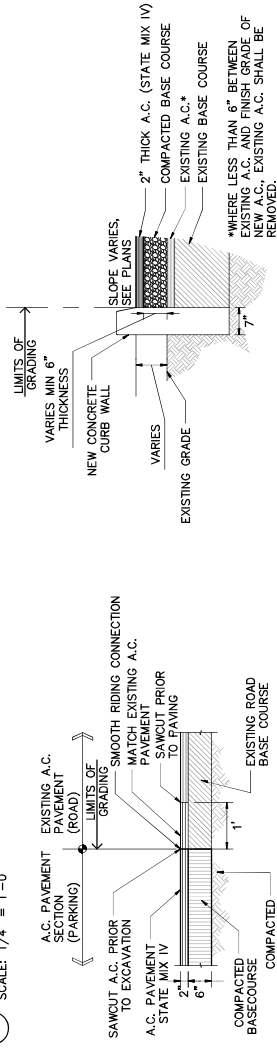
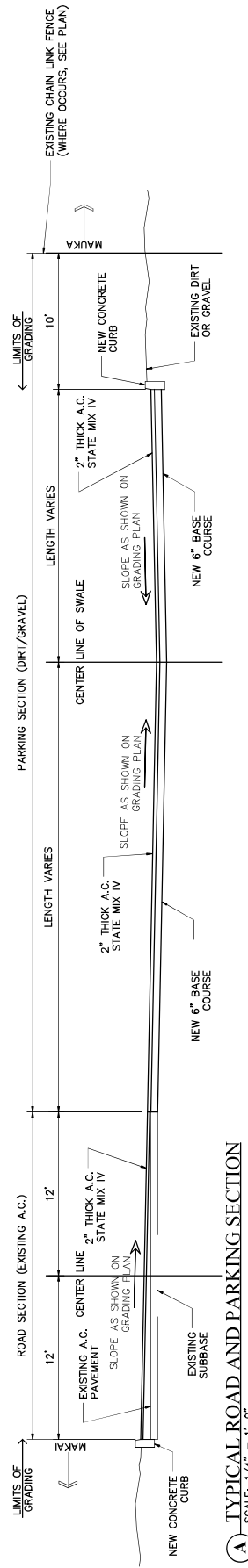

NOTES:

1. CONTRACTOR SHALL MATCH HEIGHT OF ADJACENT CURB.
2. PROVIDE CONTRACTION JOINT AT 5' INTERVALS.
3. PROVIDE EXPANSION JOINT AT 20' INTERVALS.
4. STEEL SHALL NOT BE USED AS CHAIRS FOR REBARS.

NOTE:

1. REPLACE ALL POLYMER CONCRETE COVERS WITH CAST IRON COVERS.
2. METER BOXES SHALL BE REMOVED BEFORE PLACEMENT OF 4" THICK CONCRETE SLAB.
3. ALL CONCRETE SHALL BE REMOVED FROM EXISTING PIPE, VALVE, AND HANDLE PRIOR TO PLACEMENT OF METER BOX.

**CHIEF
CIVIL ENGINEERING BRANCH
DEPARTMENT OF PLANNING AND PERMITTING
CITY AND COUNTY OF HONOLULU**

PROJECT NO.	DATE	DESCRIPTION	SHEET NO.	TOTAL SHEETS	APPROVED
STATE OF HAWAII DEPARTMENT OF LAND AND NATURAL RESOURCES DIVISION OF BOATING AND OCEAN RECREATION KEEH SMALL BOAT HARBOR PAVING IMPROVEMENTS, PHASE 2					
DETAILS AND SECTIONS 1					
DESIGNED: WD	SUBMITTED:				
DRAWN: WD	DATE:				
CHECKED: FM	SCALE:				
100% WORK WAS COMPLETED BY THE DATE OF THIS PROJECT ALL FEES PAID IN ADVANCE			DRAWING NO.		
PER: MICHAEL TAYLOR PER DATE: 12/20/2016			C-8		

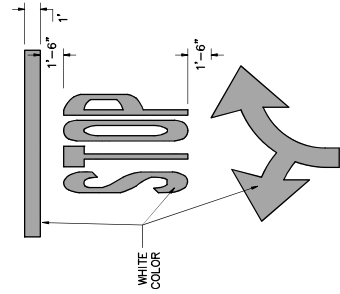

STOP AND ARROW LAYOUT
SCALE: 1/2" = 1'-0"

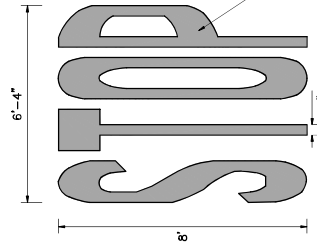

STOP DIMENSION
SCALE: 1/2" = 1'-0"

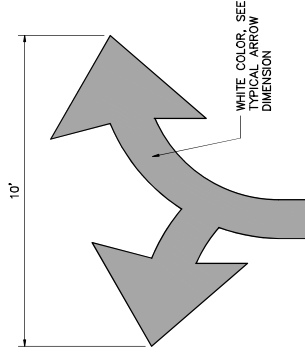

RIGHT/LEFT ARROW LAYOUT
SCALE: 1/2" = 1'-0"

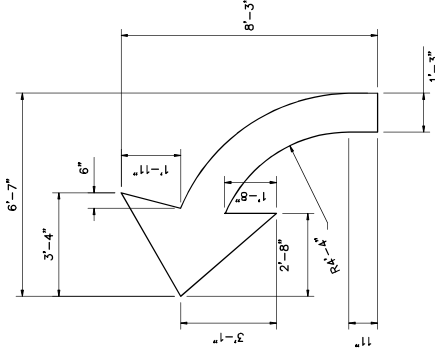

RIGHT/LEFT ARROW DIMENSION
SCALE: 1/2" = 1'-0"

A MISCELLANEOUS PAVEMENT LETTERING AND ARROWS
SCALE: AS SHOWN

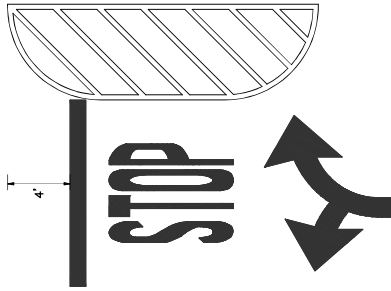

B TYPICAL RIGHT TURN LAYOUT
SCALE: 1/4" = 1'-0"

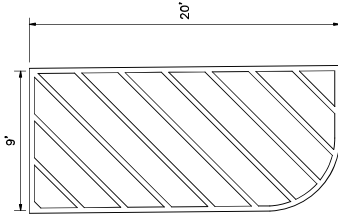

C RIGHT TURN AISLE DETAIL
SCALE: 1/4" = 1'-0"

NOTES:
1. ALL STRIPING, ARROWS, AND LETTERS SHALL
BE THERMOPLASTIC.

REVISION	DATE	BY	APPROVED
1	01/11/2011	STATE OF KANSAS	STATE OF KANSAS
2	01/11/2011	DEPARTMENT OF LAND AND NATURAL RESOURCES	DEPARTMENT OF LAND AND NATURAL RESOURCES
3	01/11/2011	DIVISION OF BOATING AND OCEAN RECREATION	DIVISION OF BOATING AND OCEAN RECREATION
4	01/11/2011	KEEP SMALL BOAT HARBOR PAVING	KEEP SMALL BOAT HARBOR PAVING
5	01/11/2011	IMPROVEMENTS, PHASE 2	IMPROVEMENTS, PHASE 2
6	01/11/2011	DETAILS AND SECTIONS 3	DETAILS AND SECTIONS 3
7	01/11/2011	DESIGNED	DESIGNED
8	01/11/2011	DRAWN	DRAWN
9	01/11/2011	CHECKED	CHECKED
10	01/11/2011	DATE	DATE
11	01/11/2011	SCALE	SCALE
12	01/11/2011	DRAWING NO.	DRAWING NO.
13	01/11/2011	C-10	C-10

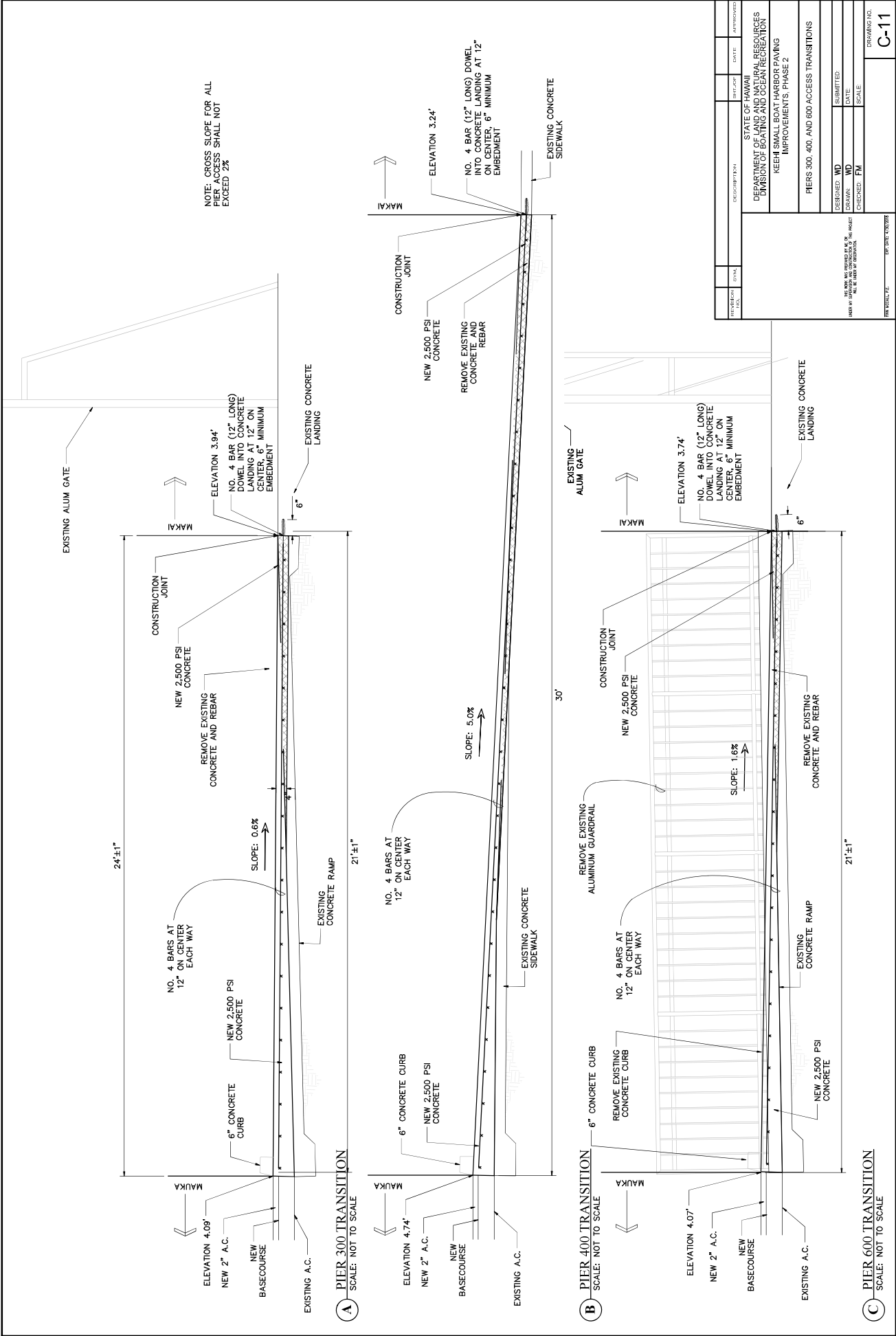

REVISION	DATE	BY	APPROVED
1			
2			
3			
4			
5			
6			
7			
8			
9			
10			
11			
12			
13			
14			
15			
16			
17			
18			
19			
20			
21			
22			
23			
24			
25			
26			
27			
28			
29			
30			
31			
32			
33			
34			
35			
36			
37			
38			
39			
40			
41			
42			
43			
44			
45			
46			
47			
48			
49			
50			
51			
52			
53			
54			
55			
56			
57			
58			
59			
60			
61			
62			
63			
64			
65			
66			
67			
68			
69			
70			
71			
72			
73			
74			
75			
76			
77			
78			
79			
80			
81			
82			
83			
84			
85			
86			
87			
88			
89			
90			
91			
92			
93			
94			
95			
96			
97			
98			
99			
100			

STATE OF MAINE	DATE	APPROVED
DEPARTMENT OF LAND AND NATURAL RESOURCES		
DIVISION OF BOATING AND OCEAN RECREATION		
KEECH SMALL BOAT HARBOR PAVING		
IMPROVEMENTS, PHASE 2		
PIERS 300, 400, AND 600 ACCESS TRANSITIONS		
DESIGNED: WD	SUBMITTED:	
DRAWN: WD	DATE:	
CHECKED: FM	SCALE:	
DRAWING NO.		
C-11		

STATE OF HAWAII
DEPARTMENT OF LAND AND NATURAL RESOURCES
DIVISION OF BOATING AND OCEAN RECREATION

JOB NO. OA17-04

KEEHI SMALL BOAT HARBOR PARKING IMPROVEMENTS, PHASE 3

HONOLULU, OAHU, HAWAII

TMK: 1-2-025:024



PROJECT LOCATION

SCALE: NOT TO SCALE

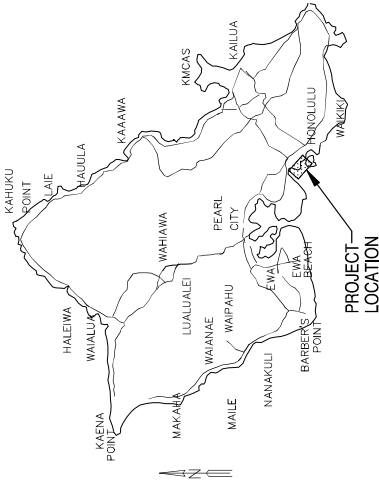

ISLAND OF OAHU

SCALE: NOT TO SCALE

INDEX

SHEET NO.	DESCRIPTION	DRAWING NO.
1	TITLE SHEET	T-1
2	CONSTRUCTION NOTES	C-1
3	EXISTING SITE AND DEMOLITION PLAN	C-2
4	BMP PLAN AND NOTES	C-3
5	GRADING AND PAVING PLAN, CROSS SECTIONS	C-4
6	STRIPING AND SIGNAGE PLAN	C-5
7	DETAILS - 1	C-6
8	DETAILS - 2	C-7
9	DETAILS - 3	C-8
10	DETAILS - 4	C-9

APPROVED:

DATE: XX-XX-XX

EDWARD R. UNDERWOOD
ADMINISTRATOR
DIVISION OF BOATING AT OCEAN RECREATION
DEPARTMENT OF LAND AND NATURAL RESOURCES

DRAWING NO.

T-1

JOB NO. OA17-04

SHEET NO. 1 OF 10 SHEETS

GENERAL NOTES:

1. ALL APPLICABLE CONSTRUCTION WORK SHALL BE PERFORMED IN ACCORDANCE WITH THE LATEST EDITIONS OF THE STANDARD SPECIFICATIONS FOR ROAD AND BRIDGE CONSTRUCTION, 2005, AS AMENDED.
2. THE CONTRACTOR SHALL BE RESPONSIBLE FOR PERFORMANCE WITH THE APPLICABLE PROVISIONS CONTAINED IN THE "WATER SYSTEM STANDARDS" STATE OF HAWAII 2002.
3. THE CONTRACTOR SHALL COORDINATE AND SCHEDULE ALL WORK WITH THE DRAIN DIVISION OF BOATING AND OCEAN RECREATION SO AS NOT TO DISRUPT THE OPERATIONS OF THE EXISTING FACILITIES.
4. THE CONTRACTOR SHALL PROTECT ALL EXISTING UTILITIES WHETHER SHOWN ON THE CONTRACT PLAN OR NOT, BEFORE DISRUPTING SERVICE OF ANY UTILITY. THE CONTRACTOR SHALL CONTACT THE DRAIN DIVISION OF BOATING AND OCEAN RECREATION TO OBTAIN THE NECESSARY PERMITS AND AUTHORITY TO EXISTING UTILITIES. THE CONTRACTOR SHALL BE RESPONSIBLE FOR THE PROTECTION OF THE UTILITIES AS A RESULT OF HIS CONSTRUCTION ACTIVITIES SHALL BE REPAIRED BY THE CONTRACTOR AT NO ADDITIONAL COST TO THE STATE.
5. EXISTING UTILITIES THAT ARE TO REMAIN IN USE, WHETHER OR NOT SHOWN ON THE DRAWINGS, SHALL BE PROTECTED AT ALL TIMES. THE CONTRACTOR SHALL BE RESPONSIBLE FOR PROTECTING EXISTING UTILITIES SHALL BE REPAIRED AND PAID FOR BY THE CONTRACTOR.
6. UNLESS OTHERWISE CALLED FOR, EXISTING UTILITIES SHALL REMAIN IN SERVICE AND IN PLACE. THE LOCATION OF EXISTING UTILITIES IS REQUIRED BY THE CONTRACTOR. INTERRUPTION OF SERVICE SHALL BE KEPT TO A MINIMUM AND SHALL BE DONE AT THE CONTRACTOR'S EXPENSE. THE CONTRACTOR SHALL BE RESPONSIBLE FOR PROTECTING EXISTING UTILITIES. THE CONTRACTOR SHALL MAINTAIN FACILITIES AT ALL TIMES.
7. THE CONTRACTOR'S ACCESS TO AND MOVEMENT WITHIN THE AREAS OF CONSTRUCTION SHALL BE COORDINATED WITH THE DRAIN DIVISION OF BOATING AND OCEAN RECREATION.
8. THE CONTRACTOR WILL BE REQUIRED TO INSURE HIS WORK SO AS TO MINIMIZE INTERFERENCE WITH PUBLIC, LOCAL, TRAFFIC AND WORKING OPERATIONS OF THE BUSINESSES WITHIN THE AREA.
9. DO NOT STORE MATERIALS OR EQUIPMENT OR OPERATE OR PARK EQUIPMENT NEAR OR UNDER THE BRANCHES OF EXISTING PLANTS AND TREES THAT ARE TO REMAIN, EXCEPT AS REQUIRED FOR THE CONSTRUCTION OF THE PROJECT. THE CONTRACTOR SHALL PROTECT ALL EXISTING TREES TO REMAIN.
10. THE CONTRACTOR SHALL BE RESPONSIBLE FOR DAMAGE RESULTING FROM CONSTRUCTION ACTIVITIES. THE CONTRACTOR SHALL BE RESPONSIBLE FOR THE REPAIR OF DAMAGE TO THE CONTRACTOR'S EXPENSE. REPAIR DAMAGE IN A MANNER SATISFACTORY TO THE ENGINEER.
11. SAFETY BARRIERS AND APPROPRIATE WARNING SIGNS AND DEVICES SHALL BE PROVIDED AT ALL TIMES FOR THE SAFETY OF PEDESTRIANS AND/OR VEHICLES. THE CONTRACTOR SHALL PROVIDE SAFE ACCESS TO AND FROM ALL DRIVEWAYS AND ROADWAYS.
12. VERIFY AND CHECK ALL DIMENSIONS AND DETAILS PRIOR TO THE START OF CONSTRUCTION. DISCREPANCIES SHALL BE BROUGHT TO THE ATTENTION OF THE ENGINEER.
13. CONTRACTOR WILL FOLLOW APPLICABLE RULES AND REGULATIONS GOVERNING THE CONSTRUCTION OF THE PROJECT AND THE PROTECTION OF PROJECT RELATED ACTIONS.
14. EXPOSED AREAS SHALL BE BACKFILLED WITH A MINIMUM OF 6 INCHES OF COMPACTED FILL. EXPOSED AREAS SHALL BE DEFINED AS THOSE AREAS WHERE DISTURBANCE OCCURS DUE TO DEMOLITION, REMOVAL OR TRENCING AND WHERE NO STRUCTURES OR PAVEMENTS ARE TO BE CONSTRUCTED.
15. THE CONTRACTOR SHALL PROTECT EXISTING STRUCTURES. ALL EXISTING STRUCTURES SHALL BE PROTECTED AND MAINTAINED TO THE MAXIMUM EXTENT POSSIBLE. THE CONTRACTOR SHALL BE RESPONSIBLE FOR THE REPAIR OF DAMAGE TO EXISTING STRUCTURES. CONSTRUCTION SHALL BE CONSIDERED INCIDENTAL TO THE NEW WORK.
16. CONTRACTOR SHALL ALLOW CONSTRUCTION TOLERANCE IN ORDER TO MEET THE MINIMUM AND MAXIMUM REQUIREMENTS AS INDICATED IN THE CONSTRUCTION DRAWINGS AND SPECIFICATIONS.
17. IN THE EVENT ANY ARTIFACTS OR HUMAN REMAINS ARE UNCOVERED DURING CONSTRUCTION OPERATIONS, THE CONTRACTOR SHALL IMMEDIATELY SUSPEND WORK AND NOTIFY THE HAWAII POLICE DEPARTMENT AND THE HISTORIC PRESERVATION DIVISION (808-933-7653).
18. PROVIDE SAFEBARRIERS AND EXERCISE CAUTION AGAINST INJURY OR DAMAGE TO EXISTING FACILITIES. THE CONTRACTOR SHALL NOT PASS OVER WALKWAYS AND CURBS, UNLESS PROTECTION HAS BEEN PROVIDED.

19. THE CONTRACTOR SHALL BE FULLY RESPONSIBLE FOR HIS CONSTRUCTION METHODS, AND FOR JOBSITE SAFETY REQUIREMENTS AND PRECAUTIONS.
20. THE BOATING FACILITY SHALL BE IN USE AND REMAIN OPEN DURING CONSTRUCTION. THE CONTRACTOR SHALL BE RESPONSIBLE FOR PROVIDING ADEQUATE TEMPORARY BARRIERS AND WARNING SIGNS TO PROTECT THE PUBLIC DURING THE CONSTRUCTION PERIOD.
21. WHERE EXISTING VALVE BOXES, MANHOLES, CLEANOUTS, MONITORING WELLS COVERS, AND ANY OTHER UTILITY BOXES ARE ENCOUNTERED, THE CONTRACTOR IS REQUIRED TO RAISE THEM TO FINISH GRADE TO THE SATISFACTION OF THE ENGINEER.
22. THE LOCATION OF EXISTING UTILITIES KNOWN TO EXIST BY THE ENGINEER ARE APPROXIMATE AND NOTED ON THE PLANS. THE CONTRACTOR SHALL BE RESPONSIBLE FOR VERIFYING THE LOCATION OF EXISTING UTILITIES AND EXERCISE PROPER CARE WHEN EXCAVATING THE AREA. WHEREVER CONNECTIONS OF NEW UTILITIES TO EXISTING UTILITIES ARE ENCOUNTERED, THE CONTRACTOR SHALL BE RESPONSIBLE FOR EXPOSURE OF THE EXISTING LINES AND VERIFY THE LOCATION AND DEPTH BEFORE EXCAVATION AND PLACEMENT OF THE NEW LINES.
23. THE CONTRACTOR SHALL BE RESPONSIBLE FOR CONFORMANCE WITH THE APPLICABLE PROVISIONS OF THE WATER QUALITY AND WATER POLLUTION CONTROL STANDARDS CONTAINED IN HAWAII ADMINISTRATIVE RULES, CHAPTER 11-55, "WATER POLLUTION CONTROL STANDARDS" AND CHAPTER 11-55, "WATER POLLUTION CONTROL" AS WELL AS CHAPTER 14 OF THE REVISED ORDINANCES OF HONOLULU, AS AMENDED. BEST MANAGEMENT PRACTICES SHALL BE EMPLOYED AT ALL TIMES DURING CONSTRUCTION.
24. THE CONTRACTOR SHALL, AT THEIR OWN EXPENSE, KEEP THE PROJECT AREA SHOWING SHALL BE MAINTAINED AND MAINTAINED. THE CONTRACTOR SHALL BE RESPONSIBLE FOR THE PROTECTION OF THE WATER POLLUTION CONTROL STANDARDS AND REGULATIONS OF THE STATE DEPARTMENT OF HEALTH.
25. THE CONTRACTOR SHALL RESTORE TO THEIR ORIGINAL CONDITION ALL IMPROVEMENTS DAMAGED AS A RESULT OF THEIR ACTIVITIES. THE CONTRACTOR SHALL BE RESPONSIBLE FOR THE REPAIR OF DAMAGE TO EXISTING STRUCTURES, UTILITIES, SIDEWALKS, WALLS, FENCES, ETC. UNLESS PROVIDED FOR SPECIFICALLY IN THE PROPOSAL. DEMOLITION AND RESTORATION ACTIVITIES SHALL BE CONSIDERED INCIDENTAL TO THE PROJECT. THE CONTRACTOR SHALL BE RESPONSIBLE FOR THE INSTALLATION OF THE WATERLINE.
26. THE CONTRACTOR AGREES THAT THEY SHALL ASSUME SOLE RESPONSIBILITY FOR THE JOB SITE CONDITIONS DURING CONSTRUCTION. THE CONTRACTOR SHALL BE RESPONSIBLE FOR THE SAFETY OF ALL PERSONS AND PROPERTY; AND THAT THESE REQUIREMENTS SHALL APPLY CONTINUOUSLY AND NOT BE LIMITED TO THE CONSTRUCTION PERIOD. THE CONTRACTOR SHALL DEFEND, INDEMNIFY, AND HOLD THE OWNER AND ENGINEER HARMLESS FROM ANY AND ALL LIABILITY, REAL OR ALLEGED, IN CONNECTION WITH THE PROJECT. THE CONTRACTOR SHALL BE RESPONSIBLE FOR LIABILITY ARISING FROM THE SOLE NEGLIGENCE OF THE OWNER OR ENGINEER.

HEALTH, SAFETY AND CONVENIENCE:

1. THE CONTRACTOR SHALL OBSERVE AND COMPLY WITH ALL FEDERAL, STATE, AND LOCAL LAWS, ORDINANCES, AND REGULATIONS OF PUBLIC HEALTH AND SAFETY AND ENVIRONMENTAL QUALITY.
2. THE CONTRACTOR, AT HIS OWN EXPENSE, SHALL KEEP THE PROJECT AREA AND ITS SURROUNDING AREAS FREE FROM DUST AND NOISE. THE WORK SHALL BE DONE IN CONFORMANCE WITH THE AIR POLLUTION STANDARDS AND REGULATIONS OF THE STATE DEPARTMENT OF HEALTH. THE CONTRACTOR SHALL REQUIRE SUPPLEMENTARY MEASURES AS NECESSARY.
3. THE CONTRACTOR SHALL PROVIDE, INSTALL, AND MAINTAIN ALL NECESSARY SIGNS, LIGHTS, FLARES, BARRICADES, MARKERS, CONES, AND OTHER PROTECTIVE FACILITIES AND SHALL TAKE ALL NECESSARY PRECAUTIONS FOR THE PROTECTION, CONVENIENCE, AND SAFETY OF THE PUBLIC. THE CONTRACTOR SHALL BE RESPONSIBLE FOR THE PROTECTION OF OPERATIONS SO AS TO CAUSE FALLING ROCKS, SOIL OR DEBRIS IN ANY FORM TO FALL, SLIDE, OR FLOW ONTO ADJOINING PROPERTIES, OR TO CAUSE DAMAGE TO EXISTING STRUCTURES OR UTILITIES. THE CONTRACTOR SHALL BE RESPONSIBLE FOR ANY REMEDIAL ACTION BY THE ENGINEER. THE COSTS INCURRED FOR ANY REMEDIAL ACTION BY THE ENGINEER SHALL BE PAYABLE BY THE CONTRACTOR.

TRAFFIC NOTES:

1. THE CONTRACTOR SHALL PROVIDE TRAFFIC CONTROL ALONG ROADWAY AREAS DURING ALL PHASES OF CONSTRUCTION.
2. THE CONTRACTOR SHALL PROVIDE, INSTALL AND MAINTAIN ALL NECESSARY SIGNS AND OTHER PROTECTIVE FACILITIES, WHICH SHALL BE IN CONFORMANCE WITH THE STANDARD SPECIFICATIONS FOR ROAD AND BRIDGE CONSTRUCTION, 2005, AS AMENDED. THE CONTRACTOR SHALL BE RESPONSIBLE FOR THE PROTECTION AND USE OF TRAFFIC CONTROL DEVICES AT WORK SITES ON OR ADJACENT TO THE PROJECT.

- TO STREETS AND HIGHWAYS" AS ADOPTED BY THE DIRECTOR OF TRANSPORTATION, AND THE CURRENT U.S. FEDERAL HIGHWAY ADMINISTRATION'S "MANUAL ON UNIFORM TRAFFIC CONTROL DEVICES" AND THE HAWAIIAN DEPARTMENT OF TRANSPORTATION'S "STREETS AND HIGHWAY CONSTRUCTION AND MAINTENANCE OPERATIONS."
3. ALL CONSTRUCTION WARNING SIGNS SHALL BE PROMPTLY REMOVED OR COVERED WHENEVER THE MESSAGE IS NOT APPLICABLE OR NOT IN USE. THE BACKS OF ALL SIGNS USED FOR TRAFFIC CONTROL SHALL BE APPROPRIATELY COVERED TO PRECLUDE THE DISPLAY OF THE SIGN MESSAGES (I.E. WHEN SIGNS HAVE MESSAGES ON BOTH FACES).
4. THE CONTRACTOR SHALL PROVIDE FLASHING OR OFF-DUTY POLICE OFFICERS TO CONTROL THE FLOW OF TRAFFIC, AS REQUIRED.
5. THE CONTRACTOR SHALL REPLACE OR REPAIR ALL TRAFFIC SIGNS, POSTS AND PAVEMENT MARKINGS DISTURBED BY HIS ACTIVITIES.
6. THE CONTRACTOR SHALL BE RESPONSIBLE FOR ANY DAMAGES TO EXISTING STREET LIGHTING AND DAMAGES SHALL BE REPAIRED BY THE CONTRACTOR.

REVISION NO.	SYN.	DESCRIPTION	SHT./OF	DATE	APPROVED
STATE OF HAWAII DEPARTMENT OF LAND AND NATURAL RESOURCES ENGINEERING DIVISION					
KEEH SMALL BOAT HARBOR PAVING IMPROVEMENTS, PHASE 3					
CONSTRUCTION NOTES					
DESIGNED: MO/A			SUBMITTED: JUL. 29, 2017		
DRAWN: JL			DATE: JUL. 29, 2017		
CHECKED: PM			SCALE: AS SHOWN		
APPROVED:			DRAWING NO. C-1		
CHIEF ENGINEER			DATE		
SHEET NO. 2			OF 10 SHEETS		



License Expiration Date: 06-30-18
The State of Hawaii
Professional Engineer
No. 7633-C

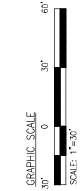

EXISTING SITE AND DEMOLITION PLAN
SCALE 1"=30'

REVISION NO.	SYN.	DESCRIPTION	DATE	APPROVED
		STATE OF HAWAII, DEPARTMENT OF PROFESSIONAL ENGINEERING DIVISION		
		KEEL, SMALL BOAT, HARBOR PAVING IMPROVEMENTS, PHASE 3		
		EXISTING SITE AND DEMOLITION PLAN		
		DESIGNED: M2/JL	SUBMITTED: JUL. 29, 2017	
		DRAWN: J.L.	DATE: JUL. 29, 2017	
		CHECKED: PM	SCALE: AS SHOWN	
		APPROVED:	DRAWING NO.	
			C-2	
		CHIEF ENGINEER	DATE	
		Signature	Date	

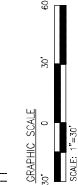
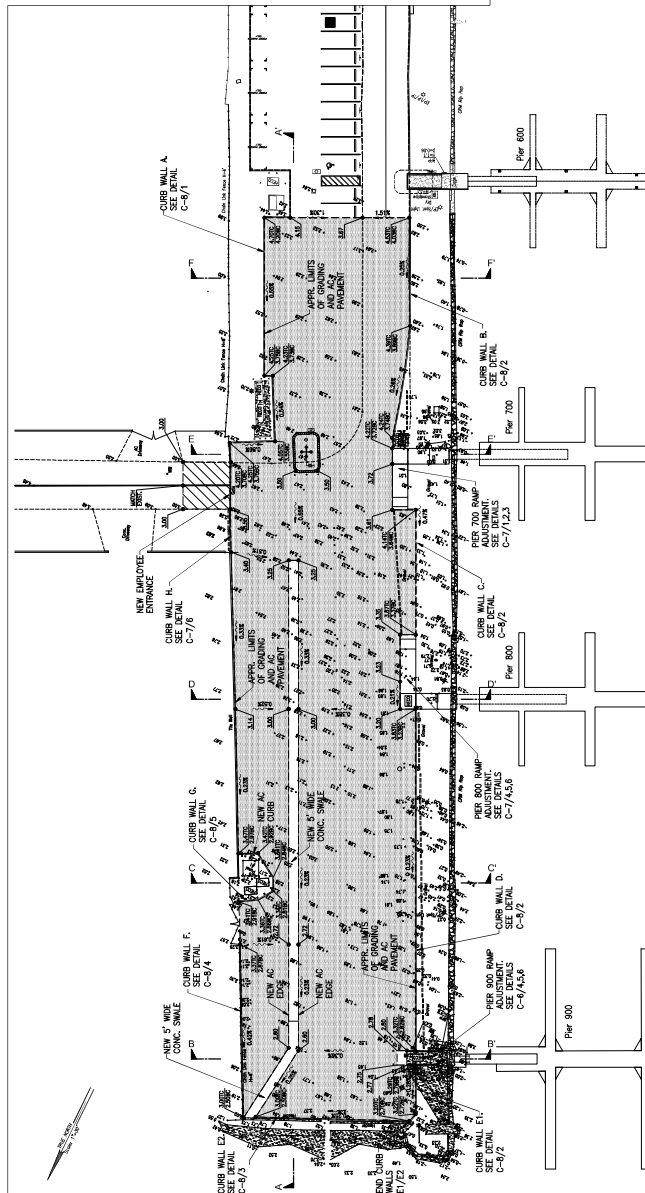
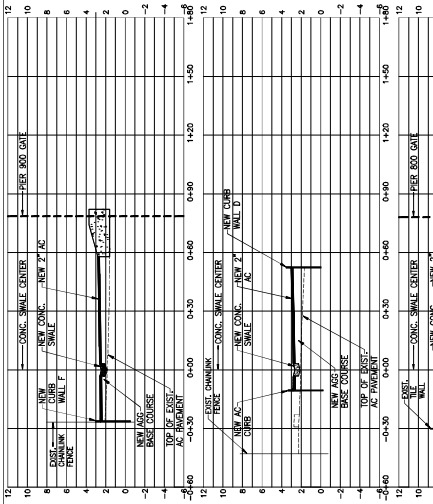
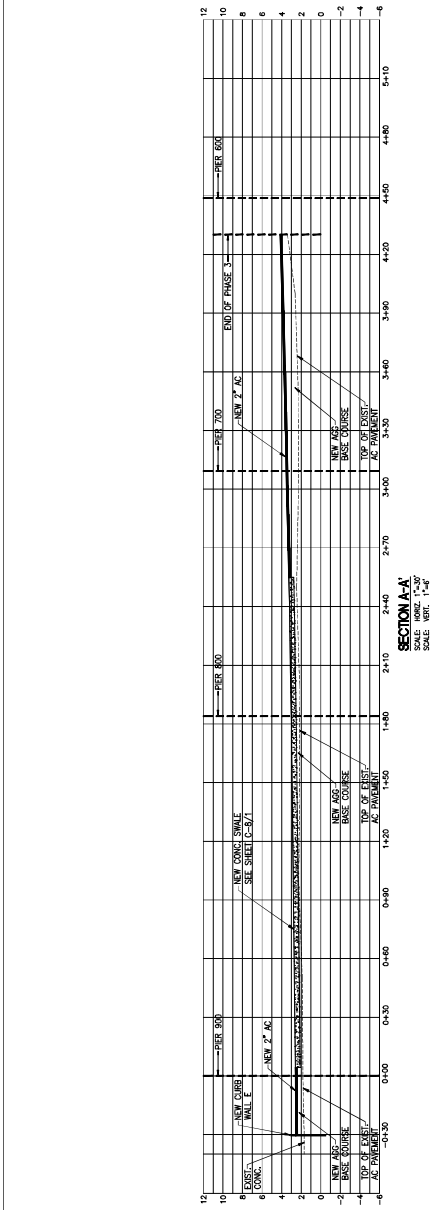
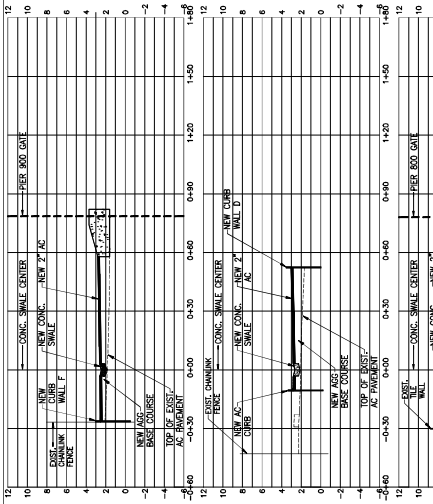
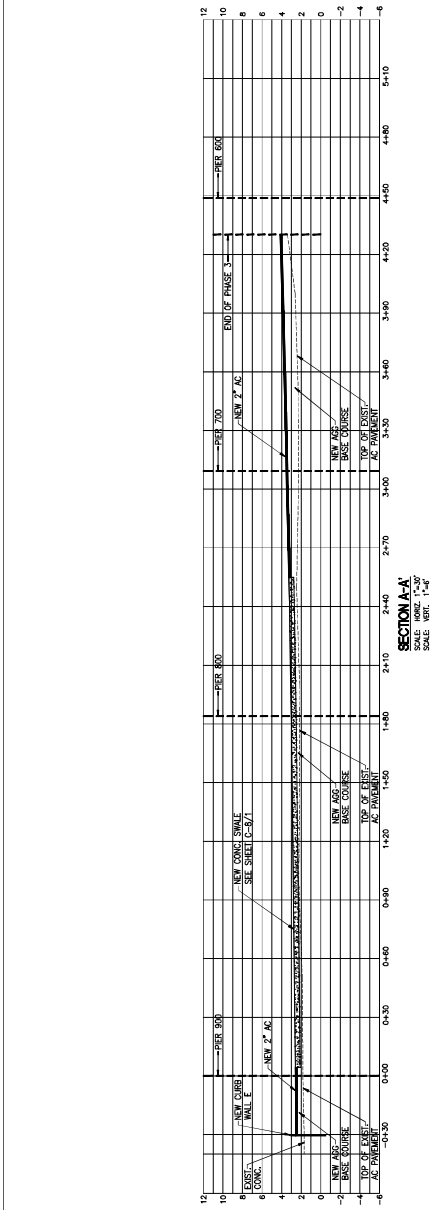
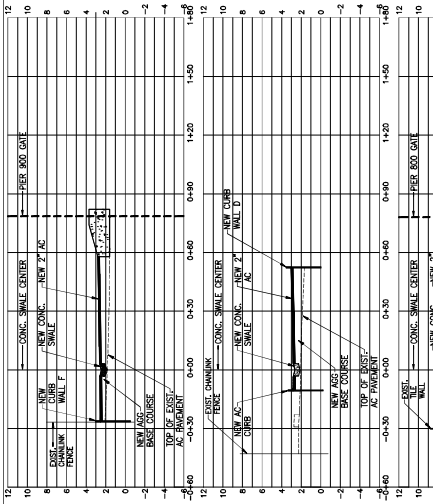
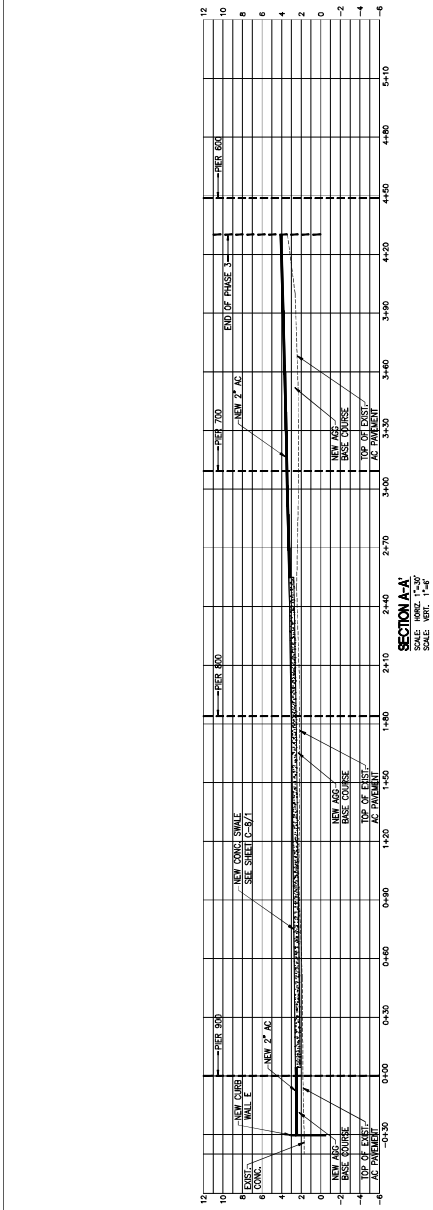

LEGEND

1.25
3.56

EXIST. SPOT ELEVATION
AC FINISH GRADE
NEW 2" AC OVER
AGG BASE COURSE
NEW 2" AC OVERLAY

INVESTOR NO.	S/N	DESCRIPTION	DATE / YR	DATE	APPROVED
<div style="text-align: center;">  <p>STATE OF HAWAII DEPARTMENT OF LAND AND NATURAL RESOURCES</p> <p>KEEL SMALL BOAT HARBOR PAVING IMPROVEMENTS, PHASE 3</p> <p>GRADING AND PAVING PLAN, CROSS SECTIONS</p> </div>					
			SUBMITTED:	JUL 29, 2017	C - 4 DRAWING NO.
			DRAWN BY:	JUL 29, 2017	
			CHECKED BY:	DATE:	
			APPROVED:	SIGNATURE:	
			DESIGNED:	NO./YR.	CHIEF ENGINEER
			DRAWN:	NO./YR.	
			CHECKED:	PW	
			APPROVED:	DATE:	

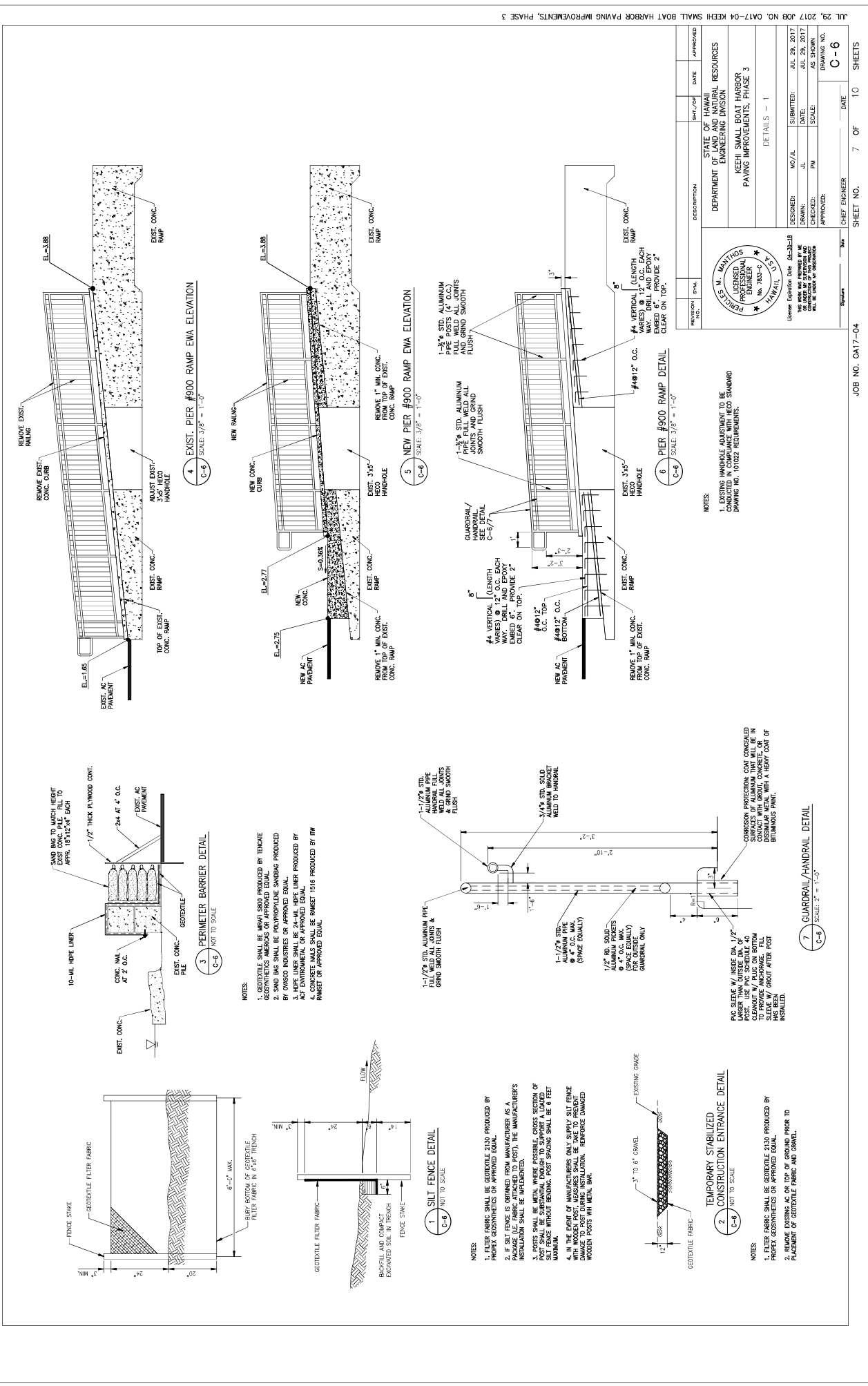

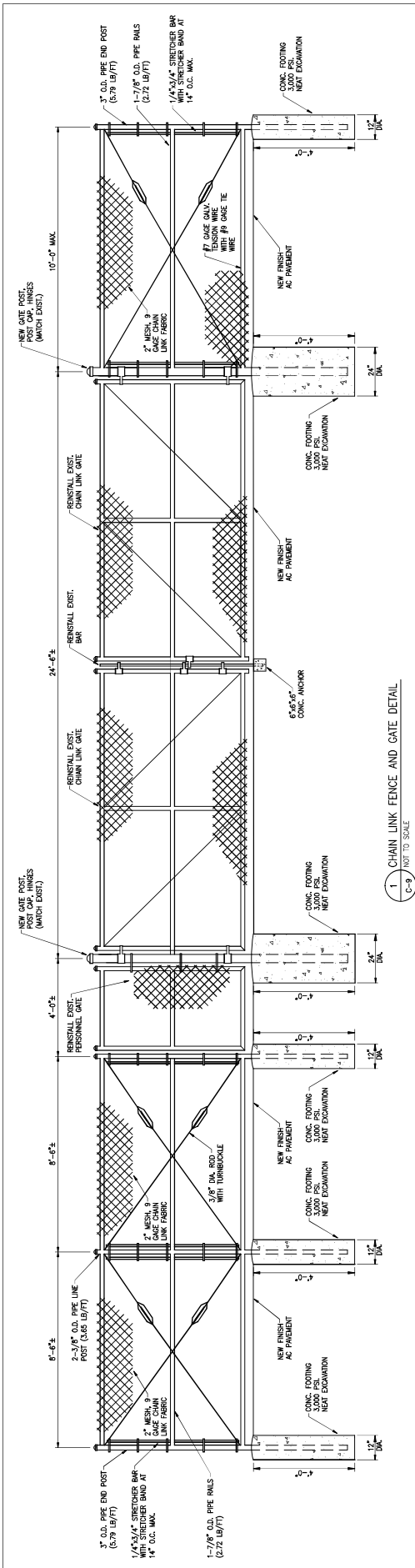

1 CHAIN LINK FENCE AND GATE DETAIL
C-9 NOT TO SCALE

REVISION	SYMBOL	DESCRIPTION	SHT./OF	DATE	APPROVED
<div> <p>Eric S. Mantinos LICENSED PROFESSIONAL ENGINEER No. 7833-C HAWAII</p> </div>					
<div> <p>STATE OF HAWAII DEPARTMENT OF LAND AND NATURAL RESOURCES ENGINEERING DIVISION KEEHI SMALL BOAT HARBOR PAVING IMPROVEMENTS, PHASE 3</p> <p>DETAILS - 4</p> </div>					
<div> <p>DESIGNED: MO/AL DRAWN: JL CHECKED: PM APPROVED:</p> <p>SUBMITTED: JUL 29, 2017 DATE: JUL 29, 2017 SCALE: AS SHOWN DRAWING NO. C-9</p> </div>					
<div> <p>License Expiration Date: 06-30-18 The Seal and Signature of the Engineer are required on all drawings and specifications submitted for review and approval by the Department of Land and Natural Resources.</p> <p>CHIEF ENGINEER DATE</p> </div>					