

DAVID Y. IGE
GOVERNOR



STATE OF HAWAII
DEPARTMENT OF TRANSPORTATION
869 PUNCHBOWL STREET
HONOLULU, HAWAII 96813-5097

JADE T. BUTAY
DIRECTOR

Deputy Directors
DEREK J. CHOW
ROSS M. HIGASHI
EDWIN H. SNIFFEN

IN REPLY REFER TO:

HWY-RL 3.97050

November 10, 2021

VIA ESIGN: suzanne.case@hawaii.gov

TO: SUZANNE D. CASE, CHAIRPERSON
DEPARTMENT OF LAND AND NATURAL RESOURCES

FROM: JADE T. BUTAY 
DIRECTOR OF TRANSPORTATION

SUBJECT: INTERSTATE ROUTE H-1
ADDITION AND MODIFICATION OF FREEWAY ACCESS
KAPOLEI INTERCHANGE COMPLEX PHASE 3
FEDERAL AID PROJECT NO. NH-H1-1(271)
AT HONOULIULI, EWA, OAHU, HAWAII
TAX MAP KEY NOS. (1) 9-1-015:079 AND (1) 9-1-015:078

Enclosed for your approval is the Land Board submittal for the subject project. Please place the submittal on your next Land Board agenda and inform Mr. Jaime Yamashiro, of our Highways Division, Right-of-Way Branch, Land Acquisition Section at (808) 692-7331 or jaime.k.yamashiro@hawaii.gov

Enclosure



STATE OF HAWAII
DEPARTMENT OF TRANSPORTATION
869 PUNCHBOWL STREET
HONOLULU, HAWAII 96813-5097

IN REPLY REFER TO:

November 10, 2021

Suzanne D. Case, Chairperson
c/o Board of Land and Natural Resources
1151 Punchbowl Street, Room 130
Honolulu, Hawaii 96813

Dear Chair Case and Board Members:

Subject: Request for Acquisition of Lands to the Department of Transportation, Highways Division, for Highway Purposes, Relating to Interstate Route H-1, Addition and Modification of Freeway Access, Kapolei Interchange Complex Phase 3, Federal Aid Project No. NH-H1-1(271), Sta. 178 + 05.40 to Sta. 202 + 74.69, at Honouliuli, Ewa, Island of Oahu, State of Hawaii, Tax Map Key Nos. (1) 9-1-015:079 and (1) 9-1-015:078

OAHU

APPLICANT:

State of Hawaii, Department of Transportation, Highways Division.

LEGAL REFERENCE:

Sections 107-10, 171-30, and Chapter 264, Hawaii Revised Statutes, as amended.

LOCATION:

Lands relating to Interstate Route H-1, Addition and Modification of Freeway Access, Kapolei Interchange Complex Phase 3, Federal Aid Project No. NH-H1-1(271), Sta. 178 + 05.40 to Sta. 202 + 74.69, at Honouliuli, Ewa, Island of Oahu, State of Hawaii, as shown and described on the enclosed map labeled as Exhibit A.

AREA:

Parcels:

Parcel 1 = 222,402 square feet (5.106 acres)
Parcel 2 (Rev. 1) = 74,157 square feet (1.702 acres)

Tax Map Key Nos.:

(1) 9-1-015:079
(1) 9-1-015:078

ITEM M-10

ZONING:

Tax Map Key No. (1) 9-1-015:079	Medium Density Apartment Mixed Use and General Preservation
Tax Map Key No. (1) 9-1-015:078	Community Business Mixed Use

CURRENT USE STATUS:

Tax Map Key No. (1) 9-1-015:079	Vacant and encumbered by encumbrances that will not be affected by the project
Tax Map Key No. (1) 9-1-015:078	Vacant and encumbered by encumbrances that will not be affected by the project

Current ownership is as follows:

<u>Parcels:</u>	<u>Tax Map Key Nos.:</u>
Parcel 1 Fee owner = Kapolei Infrastructure LLC	(1) 9-1-015:079
Parcel 2 (Rev. 1) Fee owner = MK Kapolei Commons LLC	(1) 9-1-015:078

COMPENSATION:

The subject lands will be donated and compensation will not be required.

CHAPTER 343 – ENVIRONMENTAL ASSESSMENT:

A Chapter 343, Hawaii Revised Statutes Final Environmental Assessment and Finding of No Significant Impact for the proposed action was published by the State of Hawaii, Office of Environmental Quality Control on December 23, 2006. An exemption notice was also published by the State of Hawaii, Office of Environmental Quality Control on April 23, 2021.

REMARKS:

The proposed project phase includes extending Harbor Access Road and connecting to the new freeway off ramp and on ramp and improving Kalaeloa Boulevard.

Suzanne D. Case, Chairperson
November 10, 2021
Page 3

RECOMMENDATION:

That the Board:

- A. Authorize the acquisition of the subject lands subject to an appropriate conveyance document, as reviewed and approved by the Department of the Attorney General and by the Department of Transportation.
- B. Authorize the acquisition even in the event of a change in the ownership of those parcels described herein and on the enclosed map labeled Exhibit A, under the terms and conditions cited above which are by this reference incorporated herein.

Sincerely,



JADE T. BUTAY
Director of Transportation

APPROVED FOR SUBMITTAL:

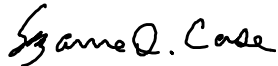

SUZANNE D. CASE, Chairperson

Enclosure

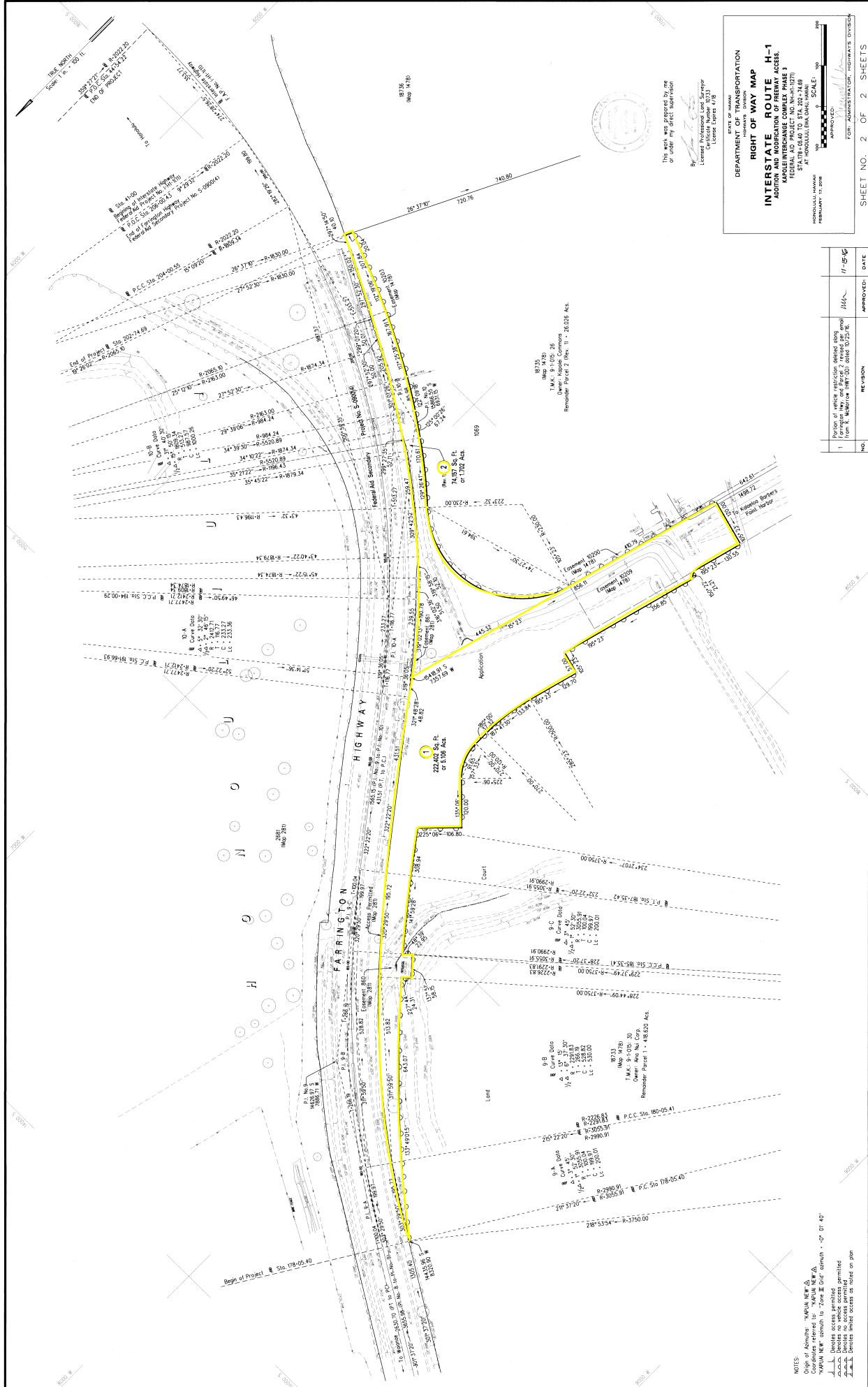

This work was prepared by me or under my direct supervision
 Licensee: [Name], License Number: 9233
 License: Professional Land Surveyor
 License: Surveyor License
 License: Surveyor License

DEPARTMENT OF TRANSPORTATION
 RIGHT OF WAY MAP
 INTERSTATE ROUTE H-1
 ADDITION AND MODIFICATION OF HIGHWAY ACCESS
 KAPOLI INTERCHANGE COMPLEX PHASE 3
 STA 174+00 TO STA 202+74.89
 AT HONOLULU (HAWAII)

HONOLULU, HAWAII
 FEBRUARY 11, 2018

SHEET NO. 2 OF 2 SHEETS
 P. H. 831

NO.	REVISION	APPROVED	DATE
1	Person of vehicle restriction deleted 1000 Furnish way and burial of needed per email from H. [Name] dated 02/25/18	[Signature]	11-05-18

NOTES:
 1. Origin of Alignment - "Kapoli New Road"
 2. "Kapoli New Road" alignment to "Zone II" of alignment - 0' 01' 40"
 3. Denotes access permitted
 4. Denotes no access permitted
 5. Denotes limited access as noted on plan

TAX MAP KEY: 9-1-02, 026 and 030
 200 N. 100 E. 1
 Drawing: 200 N. 100 E. 1

EXHIBIT A