

DAVID Y. IGE
GOVERNOR



STATE OF HAWAII
DEPARTMENT OF TRANSPORTATION
869 PUNCHBOWL STREET
HONOLULU, HAWAII 96813-5097

JADE T. BUTAY
DIRECTOR

Deputy Directors
ROSS M. HIGASHI
EDUARDO P. MANGLALLAN
PATRICK H. MCCAIN
EDWIN H. SNIFFEN

IN REPLY REFER TO:

Board of Land and
Natural Resources
State of Hawai'i
Honolulu, Hawai'i

ISSUANCE OF A REVOCABLE PERMIT FOR AIRCRAFT MAINTENANCE
OFFICE AND EQUIPMENT PARKING AREAS
OMNI AIR INTERNATIONAL, LLC
DANIEL K. INOUE INTERNATIONAL AIRPORT
TAX MAP KEY: (1) 1-1-003: 085 (PORTION) and (1) 1-1-003: 001 (PORTION)

O'AHU

APPLICANT:

Omni Air International, LLC (Omni Air), whose business address is 3303 N. Sheridan Road, Hangar 19, Tulsa, Oklahoma 74115.

LEGAL REFERENCE:

Section 171-55, Hawai'i Revised Statutes.

LOCATION AND TAX MAP KEY:

Portion of Building 373, Diamond Head Concourse, Ground Level at Daniel K. Inouye International Airport (Airport), Island of O'ahu, State of Hawai'i, identified by Tax Map Keys: 1st Division, 1-1-003: 085 (Portion) and (1) 1-1-003: 001 (Portion).

AREA:

Bldg/Room No. 152-108, containing an area of approximately 546 square feet,
Bldg/Room No. 152-112, containing an area of approximately 301 square feet,
Bldg/Room No. 152-113, containing an area of approximately 646 square feet,
Bldg/Room No. 152-114, containing an area of approximately 750 square feet,
Bldg/Room No. 152-116, containing an area of approximately 1,884 square feet, and
4 Vehicle Parking Space Nos. 611-116U, 611-116V, 611-116W, and 611-116X,
as shown and delineated on the attached Exhibit A.

Area/Space No. 641-129, containing an area of approximately 96 square feet,
as shown and delineated on the attached Exhibit B.

BLNR – ISSUANCE OF A REVOCABLE PERMIT FOR AIRCRAFT MAINTENANCE
OFFICE SPACE AND EQUIPMENT PARKING AREAS
OMNI AIR INTERNATIONAL, LLC
Page 2

ZONING:

State Land Use District: Urban
City and County of Honolulu LUO: Industrial (I-2)

LAND TITLE STATUS:

Non-Ceded - Section 5(a) lands of the Hawai'i Admission Act
DHHL 30% entitlement lands pursuant to Hawai'i Admission Act YES ___ NO X

CURRENT USE STATUS:

Land presently encumbered by Governor's Executive Order No. 3201, dated June 8, 1983, setting aside 3,152.177 acres designated as the Airport under the control and management of the State of Hawai'i, Department of Transportation, Airports Division (DOTA) for Airport Purposes.

CHARACTER OF USE:

Omni Air International, LLC will use the spaces for aircraft maintenance office spaces and equipment parking areas at the Airport.

COMMENCEMENT DATE:

Upon execution of the revocable permit.

MONTHLY RENTAL:

\$5,591.30 (as determined from the DOTA schedule of rates and charges, established by appraisal of Airports property statewide).

SECURITY DEPOSIT:

\$16,773.90, or three (3) times the monthly rental in effect.

DCCA VERIFICATION:

| | | |
|---|--------------|--------|
| Place of business registration confirmed: | YES <u>X</u> | NO ___ |
| Registered business name confirmed: | YES <u>X</u> | NO ___ |
| Good standing confirmed: | YES <u>X</u> | NO ___ |

CHAPTER 343, HRS - ENVIRONMENTAL ASSESSMENT:

The environmental impacts of the proposed action to the subject land area are covered by the Honolulu International airport Master Plan Update and Noise Compatibility Program Environmental Assessment (EA), State Project No. AO1011-033. The EA is a joint State and Federal document, dated September 1989 and published in the October 23, 1989 issue of the OEQC Bulletin. Accordingly, relevant mitigation from the EA and DOTA environmental best management practice will address minimal impacts from this action.

REMARKS:

In accordance with Section 171-55 HRS, relating to Permits, the Department of Transportation proposes to issue a month-to-month revocable permit to Omni Air International, LLC for an aircraft maintenance office space and equipment parking areas at the Airport.

RECOMMENDATION:

That the Board authorize the Department of Transportation to issue a month-to-month revocable permit to Omni Air International, LLC, subject to: (1) terms and conditions herein outlined, which are by reference incorporated herein; and (2) such additional terms and conditions as may be prescribed by the Director of Transportation to best serve the interests of the State.

Respectfully submitted,



JADE T. BUTAY
Director of Transportation

APPROVED FOR SUBMITTAL:

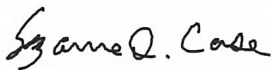

SUZANNE D. CASE
Chairperson and Member

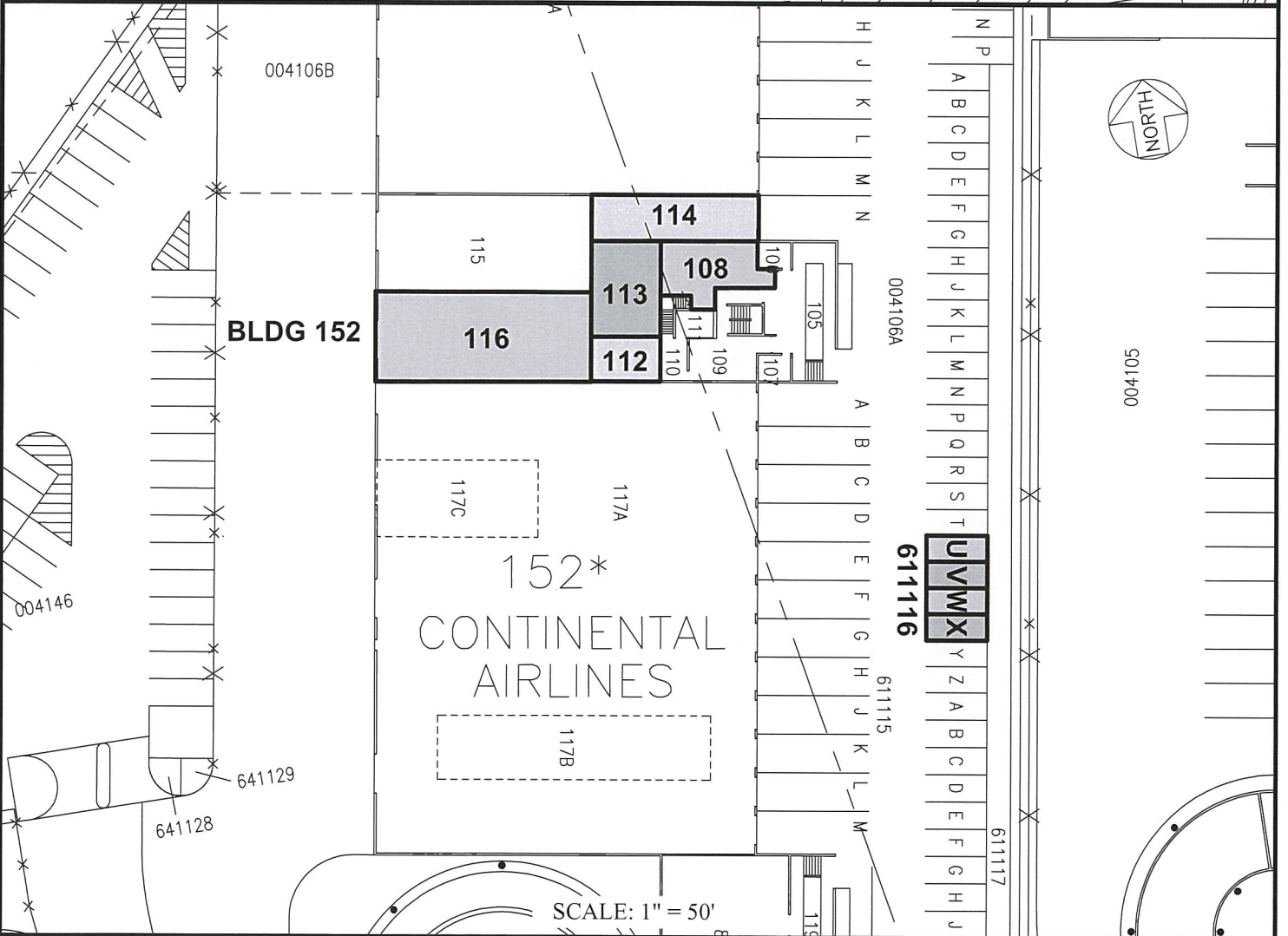
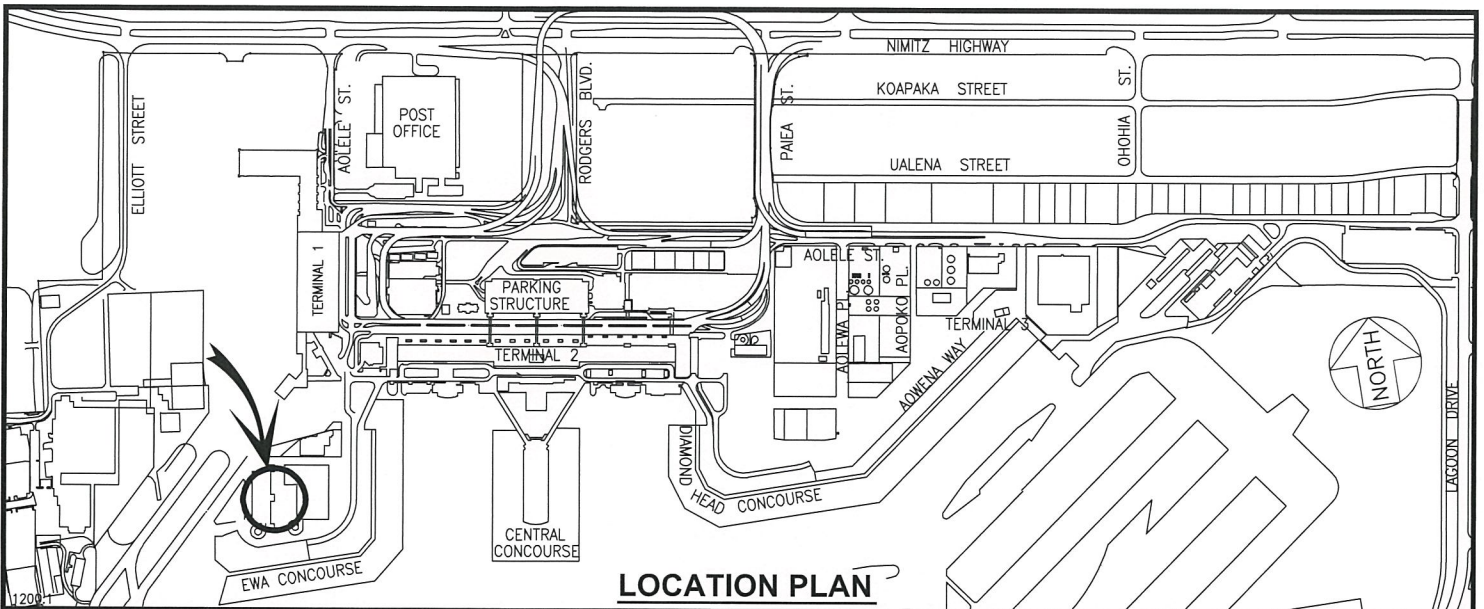

RP-9178

DATE : DECEMBER 2021

EXHIBIT: **A**



OMNI AIR
INTERNATIONAL, LLC

BUILDING 152
CONTINENTAL CARGO BLDG
GROUND LEVEL

152108/116
152112-114
611116U-X
PLAT F1

dodge Sign Transaction Number: CB\CHBCAABAAe79likG\15S-W2hfZeloxVhrSeNwJ4Fq

N:\AIRPORTS\HNL_HONOLULU\CAD\PM\HNL_152108-01.DWG

DANIEL K. INOUE INTERNATIONAL AIRPORT

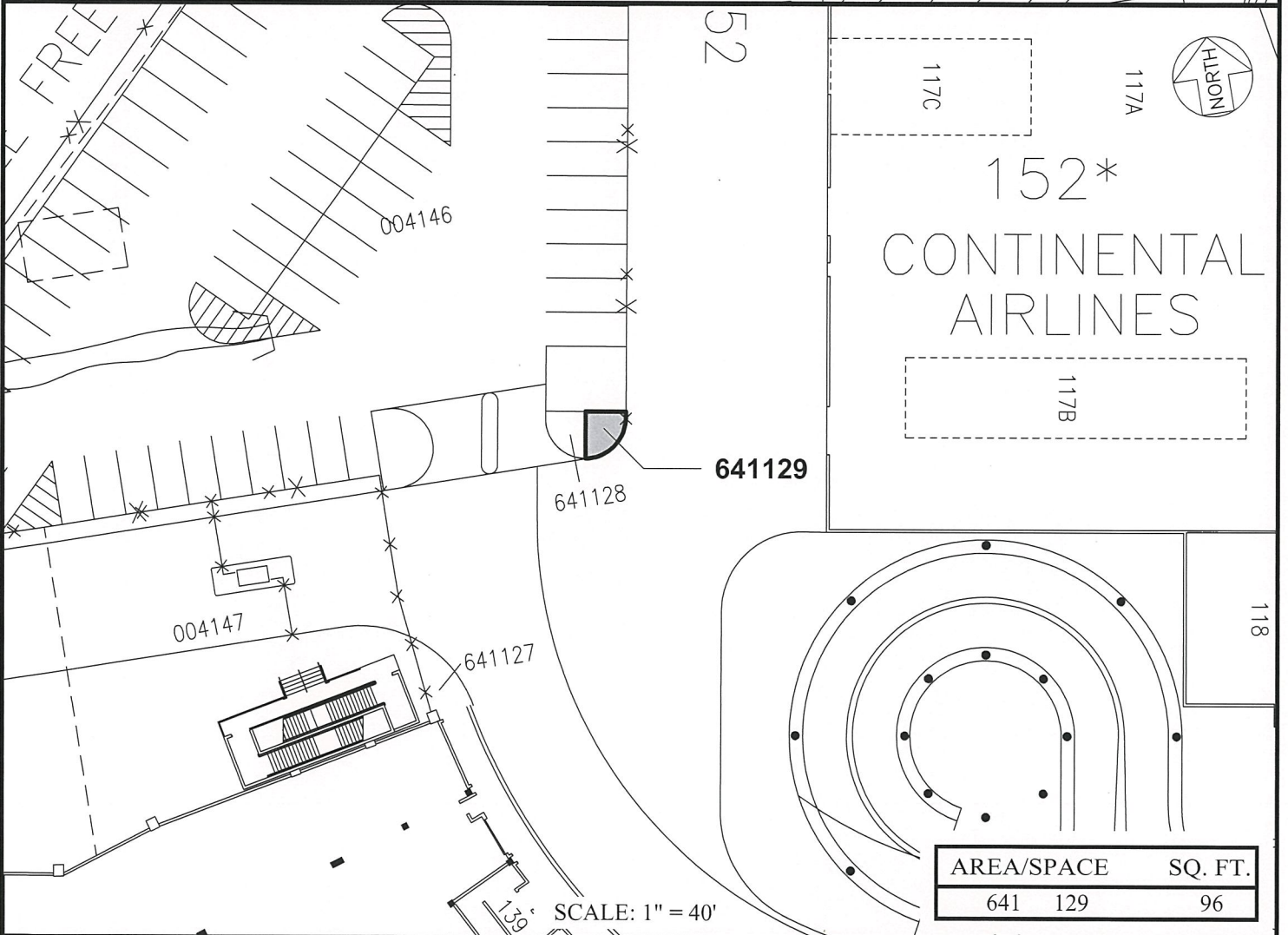
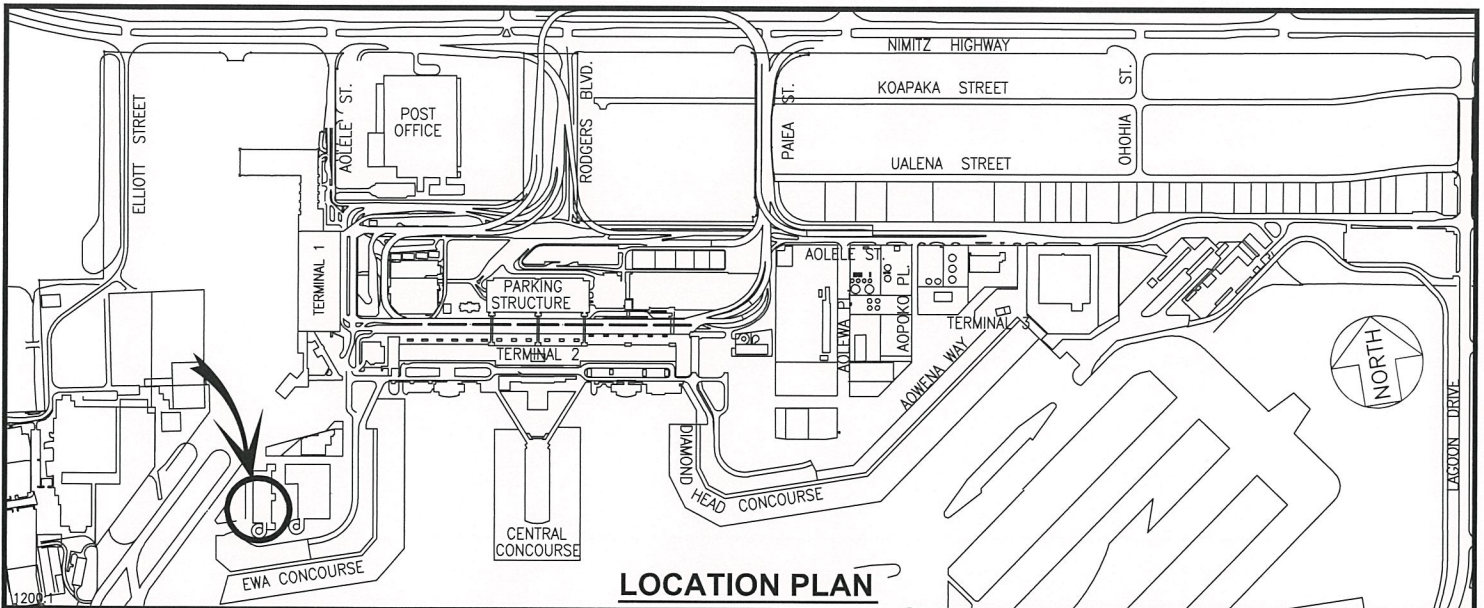

RP-9178

DATE : DECEMBER 2021

EXHIBIT: **B**



OMNI AIR
INTERNATIONAL, LLC

AIRLINE CARGO
BUILDING AREA
GROUND LEVEL

641129

PLAT F1

DANIEL K. INOUE INTERNATIONAL AIRPORT

N:\AIRPORTS\HNL_HONOLULU\CAD\PM\HNL_641129-01.DWG