

DAVID Y. IGE
GOVERNOR



STATE OF HAWAII
DEPARTMENT OF TRANSPORTATION
869 PUNCHBOWL STREET
HONOLULU, HAWAII 96813-5097

JADE T. BUTAY
DIRECTOR

Deputy Directors
ROSS M. HIGASHI
EDUARDO P. MANGLALLAN
PATRICK H. MCCAIN
EDWIN H. SNIFFEN

IN REPLY REFER TO:

FEBRUARY 25, 2022

Board of Land and
Natural Resources
State of Hawai'i
Honolulu, Hawai'i

ISSUANCE OF A REVOCABLE PERMIT FOR SPACE IN THE COMMUTER
TERMINAL TO PLACE A DESK AND TWO VEHICLE PARKING STALLS
FOR FIXED-WING AIR TOUR OPERATIONS
ALOHA HELICOPTER TOURS LLC DBA ALII AIR TOURS AND CHARTERS
LĪHU'E AIRPORT KAUA'I
TAX MAP KEY: (4) 3-5-001:147 (PORTION)

APPLICANT:

Aloha Helicopter Tours LLC dba Alii Air Tours and Charters (AHT), whose mailing address is 2798 Upena Street, Līhu'e, Hawai'i 96766.

LEGAL REFERENCE:

Section 171-55, Hawai'i Revised Statutes (HRS).

LOCATION AND TAX MAP KEY:

Portion of Līhu'e Airport, Līhu'e, Island of Kaua'i, identified by
Tax Map Key: 4th Division, 3-5-001:147 (Portion).

AREA:

Building/Room No. 136-101D, containing an area of approximately 134 square feet;
Area/Space No. 611-102F, containing an area of approximately 187 square feet; and
Area/Space No. 611-102G, containing an area of approximately 187 square feet,
as shown and delineated on the attached Exhibit A.

ZONING:

State Land Use District: Urban
County of Kaua'i Industrial General/Special Treatment-Public Use (IG/ST-P)

ITEM M-10

BLNR – ISSUANCE OF A REVOCABLE PERMIT FOR SPACE IN THE COMMUTER
TERMINAL TO PLACE A DESK AND TWO VEHICLE PARKING STALLS
FOR FIXED-WING AIR TOUR OPERATIONS
ALOHA HELICOPTER TOURS LLC DBA ALII AIR TOURS AND CHARTERS
Page 2

LAND TITLE STATUS:

Section 5(a) lands of the Hawai‘i Admission Act: Non-Ceded
DHHL 30% entitlement lands pursuant to Hawai‘i Admission Act YES ___ NO X

CURRENT USE STATUS:

Land presently encumbered by Governor’s Executive Order No. 4614, dated October 28,
2019, setting aside 883.583 acres designated as Lihu‘e Airport to be under the control and
management of the State of Hawai‘i, Department of Transportation for Airport Purposes.

CHARACTER OF USE:

AHT will use the space in the Commuter Terminal to place a desk and the two (2) vehicle
parking spaces as part of their Fixed-Wing Air Tour Operations at Lihu‘e Airport.

No Helicopter Tour Operations will be allowed from the Commuter Terminal.

COMMENCEMENT DATE:

Upon execution of the revocable permit.

MONTHLY RENTAL:

\$405.69 (\$223.33 for Commuter Terminal space and \$110.00 for two (2) uncovered,
paved vehicle parking spaces, as determined from the Department of Transportation,
Airports Division schedule of rates and charges established by appraisal of Airports
property statewide plus \$52.26 for utilities and \$20.10 for maintenance).

SECURITY DEPOSIT:

\$1,217.07, or three (3) times the monthly rental in effect.

DCCA VERIFICATION:

Place of business registration confirmed: YES X NO ___
Registered business name confirmed: YES X NO ___
Good standing confirmed: YES X NO ___

BLNR – ISSUANCE OF A REVOCABLE PERMIT FOR SPACE IN THE COMMUTER
TERMINAL TO PLACE A DESK AND TWO VEHICLE PARKING STALLS
FOR FIXED-WING AIR TOUR OPERATIONS
ALOHA HELICOPTER TOURS LLC DBA ALII AIR TOURS AND CHARTERS
Page 3

CHAPTER 343, HRS - ENVIRONMENTAL ASSESSMENT:

The State of Hawai'i, Department of Transportation, Airports Division, has determined that the environmental impacts of the proposed tenant use for the subject land is covered by the Līhu'e Airport Master Plan Environmental Impact Statement (EIS), published by the Environmental Quality Commission (EQC) in the August 8, 1976 and August 23, 1976, issues of EQC Bulletin and accepted by the Governor on April 26, 1977. Accordingly, all relevant mitigation from the EIS and best management practices will be implemented to address the minimum impacts of this action.

REMARKS:

In accordance with Section 171-55, HRS, relating to Permits, the Department of Transportation proposes to issue a month-to-month revocable permit to AHT for space in the Commuter Terminal to place a desk and two (2) vehicle parking stalls as part of their Fixed-Wing Air Tour Operations at Līhu'e Airport.

RECOMMENDATION:

That the Board authorizes the Department of Transportation to issue a month-to-month Parking Permit to AHT, subject to: (1) terms and conditions herein outlined, which are by reference incorporated herein; (2) such additional terms and conditions as may be prescribed by the Director of Transportation to best serve the interests of the State.

Respectfully submitted,



JADE T. BUTAY
Director of Transportation

APPROVED FOR SUBMITTAL:

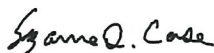

SUZANNE D. CASE
Chairperson and Member

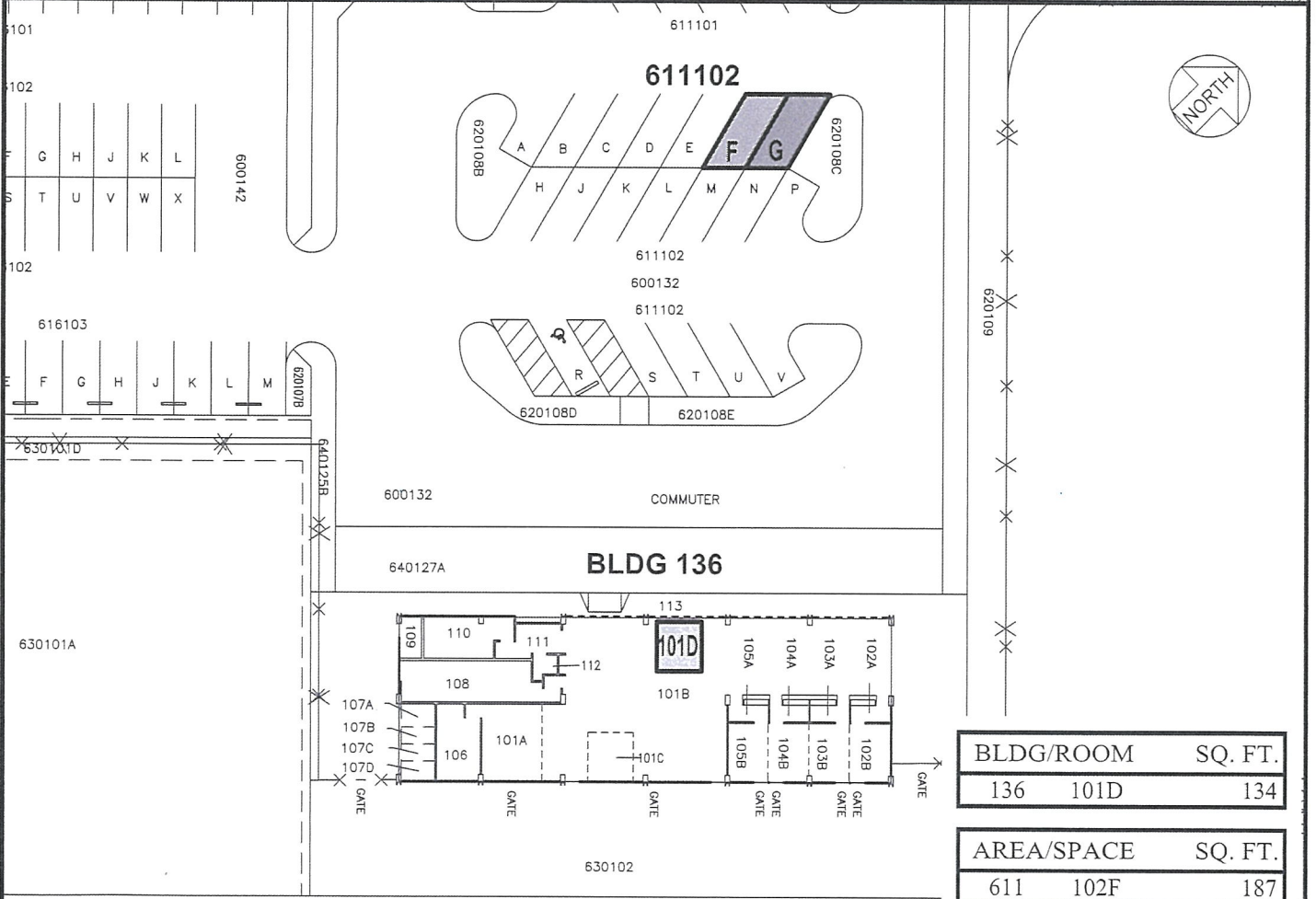
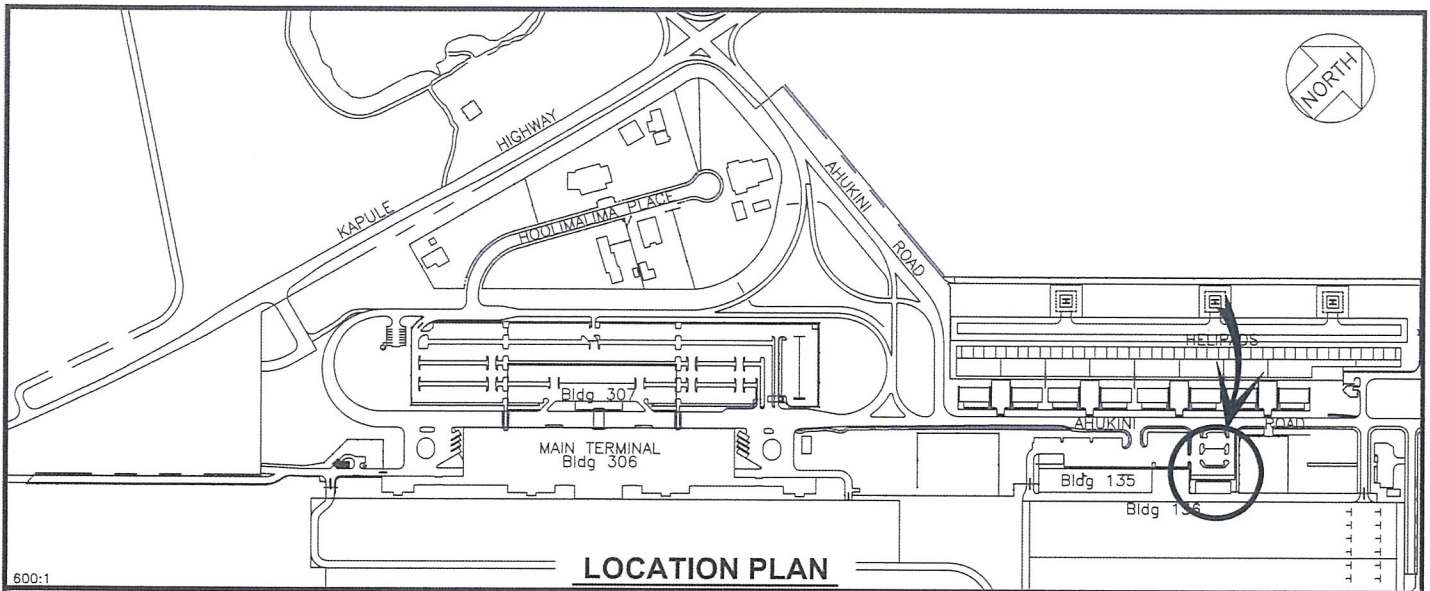

BLDG/ROOM	SQ. FT.
136 101D	134
AREA/SPACE	SQ. FT.
611 102F	187
611 102G	187

DATE : DECEMBER 2021 EXHIBIT: **A**



ALOHA HELICOPTER TOURS LLC
DBA
ALII AIR TOURS AND CHARTERS

BUILDING 136 &
PARKING AREA 611102
GROUND LEVEL

136101D
611102F
611102G
PLAT A1, 35

LIHUE AIRPORT

N:\AIRPORTS\LIH_Lihue\CAD\PM\lih_136101D-01.dwg