

DAVID Y. IGE  
GOVERNOR



STATE OF HAWAII  
DEPARTMENT OF TRANSPORTATION  
869 PUNCHBOWL STREET  
HONOLULU, HAWAII 96813-5097

JADE. T. BUTAY  
DIRECTOR

Deputy Directors  
ROSS M. HIGASHI  
EDUARDO P MANGALLAN  
PATRICK H. MCCAIN  
EDWIN H. SNIFFEN

IN REPLY REFER TO:

Board of Land and  
Natural Resources  
State of Hawai'i  
Honolulu, Hawai'i

ISSUANCE OF A REVOCABLE PERMIT FOR  
PARKING TO CONDUCT RENTAL CAR OPERATIONS  
SOUTHERN AIRWAYS EXPRESS, LLC  
LĀNA'I AIRPORT  
TAX MAP KEY: (2) 4-9-02: PORTION OF 41

MAUI

LEGAL REFERENCE:

Section 171-55, Hawai'i Revised Statutes (HRS).

APPLICANT:

Southern Airways Express, LLC, whose business address is 2875 South Ocean Boulevard, Suite 256, Palm Beach, Florida 33480.

LOCATION AND TAX MAP KEY:

Portion of Lāna'i Airport (LNY), Lāna'i, County of Maui, identified by Tax Map Key: 2<sup>nd</sup> Division, 4-9-02: Portion of 41.

AREA:

Area/Space No. 610-101A, containing an area of approximately 153 square feet; and Area/Space No. 610-101B, containing an area of approximately 153 square feet, as shown and delineated on the attached Exhibit A.

ZONING:

State Land Use District: Urban  
County of Maui: Airport

**ITEM M-15**

BLNR – ISSUANCE OF A REVOCABLE PERMIT FOR PARKING TO CONDUCT RENTAL CAR OPERATIONS, SOUTHERN AIRWAYS EXPRESS, LLC  
PAGE 2

LAND TITLE STATUS:

Section 5(a) lands of the Hawai'i Admissions Act: Non-Ceded  
DHHL 30% entitlement lands pursuant to the Hawai'i State Constitution: No

CURRENT USE STATUS:

The Department of Transportation (DOT) has determined that the minimal impacts of this action is exempt, pursuant to Hawai'i Administrative Rules, Section 11-200.1-16 (b); the impacts of leasing space for an existing paved parking stall is de minimis.

CHARACTER OF USE:

Southern Airways Express, LLC will use the parking spaces to conduct rental car operations.

COMMENCEMENT DATE:

Upon execution of the document.

RENTAL:

\$ 82.00 plus ten percent (10%) of gross receipts payable monthly.

SECURITY DEPOSIT:

\$ 246.00, or three (3) times the monthly rental in effect.

DCCA VERIFICATION:

Place of business registration confirmed:	YES <u>X</u>	NO _____
Registered business name confirmed:	YES <u>X</u>	NO _____
Good standing confirmed:	YES <u>X</u>	NO _____

CHAPTER 343, HRS – ENVIRONMENTAL ASSESSMENT:

The Department of Transportation (DOT) has determined that the minimal impact of this action is exempt, pursuant to Hawai'i Administrative Rules, Section 11-200.1-16 (b); the impacts of leasing space for an existing paved parking stall is de minimis.

BLNR – ISSUANCE OF A REVOCABLE PERMIT FOR PARKING TO CONDUCT  
RENTAL CAR OPERATIONS, SOUTHERN AIRWAYS EXPRESS, LLC  
PAGE 3

REMARKS:

In accordance with Section 171-55, HRS, relating to Permits, the Department of Transportation proposes to issue a month-to-month revocable permit to Southern Airways Express, LLC for parking of rental car vehicles at Lāna‘i Airport.

RECOMMENDATION:

That the Board authorize the Department of Transportation to issue a month-to-month revocable permit to Southern Airways Express, LLC, subject to: (1) terms and conditions herein outlined, which are by reference incorporated herein; and (2) such additional terms and conditions as may be prescribed by the Director of Transportation to best serve the interests of the State.

Respectfully submitted,



JADE T. BUTAY  
Director of Transportation

APPROVAL FOR SUBMITTAL:

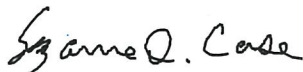

SUZANNE D. CASE  
Chairperson and Member

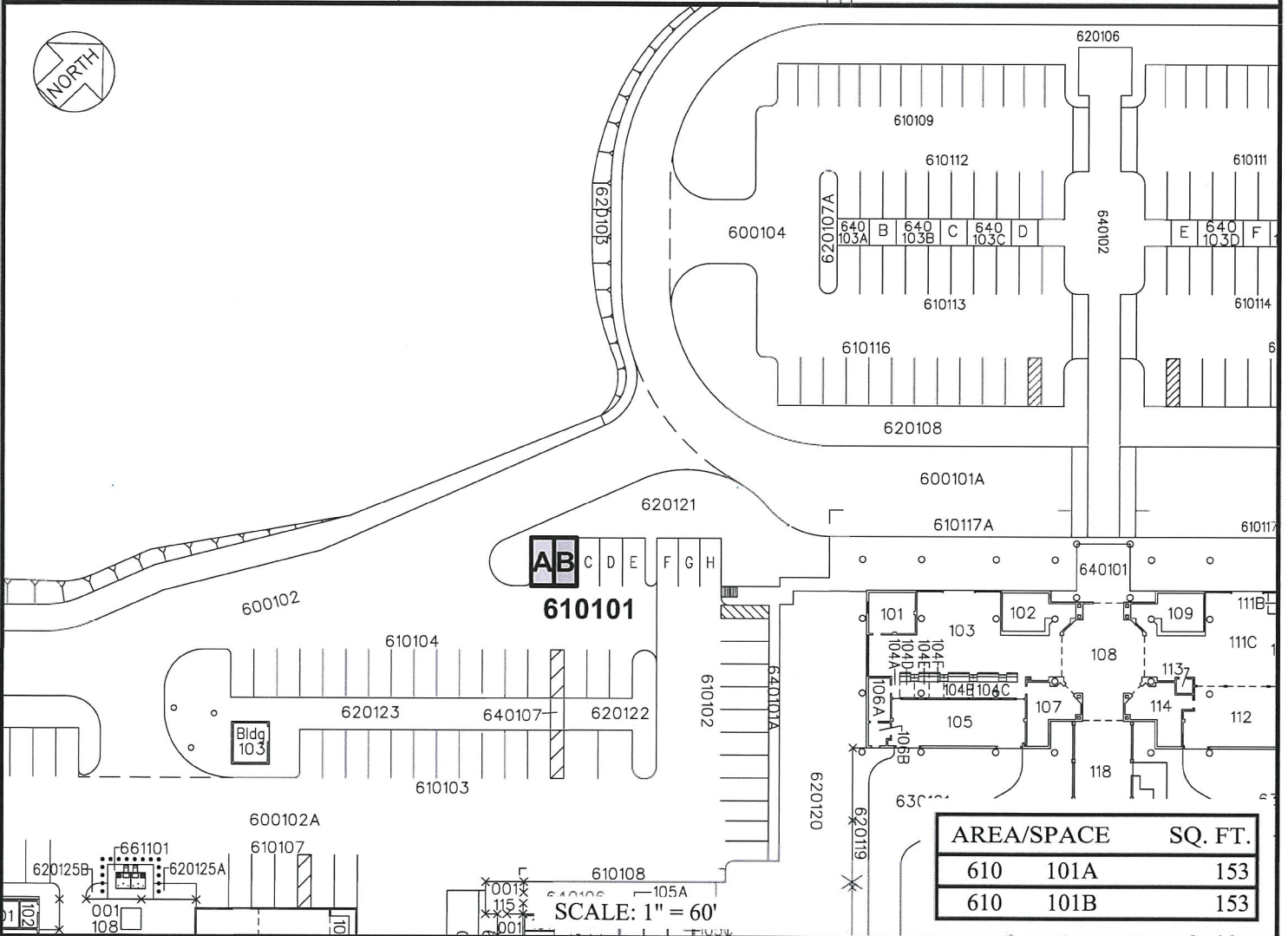
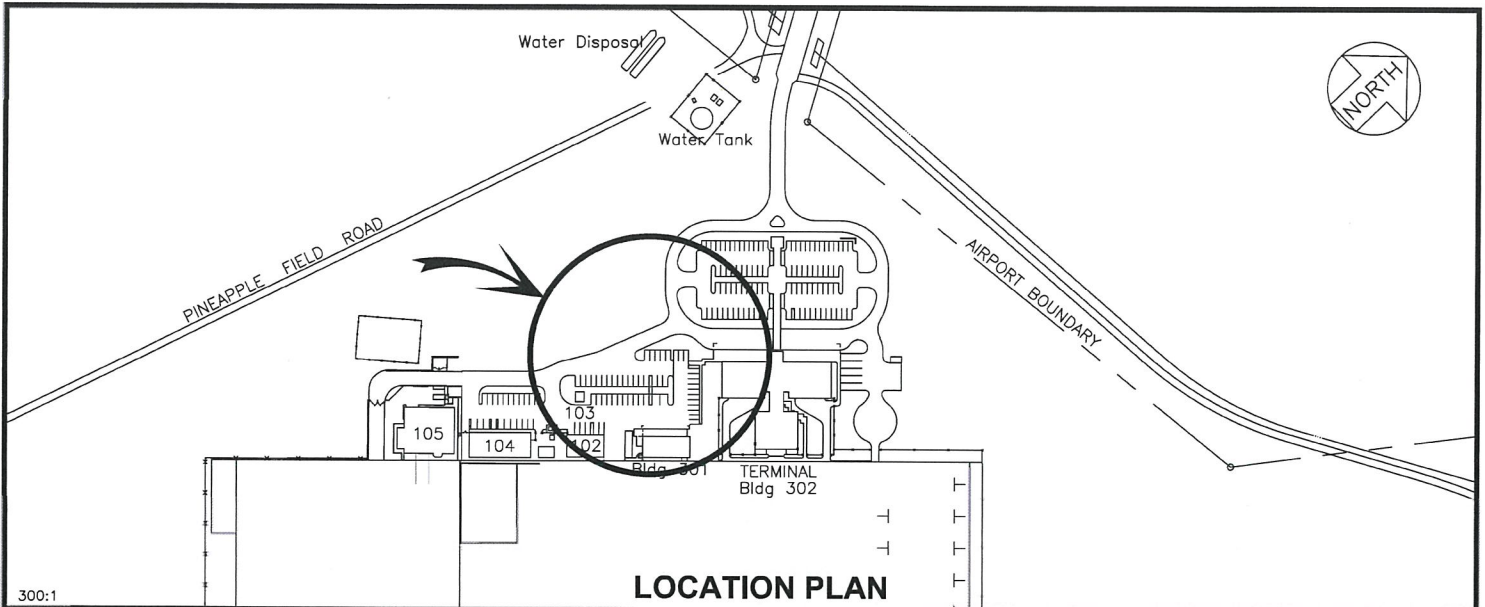

DATE : JANUARY 2022

EXHIBIT: **A**



**SOUTHERN AIRWAYS  
EXPRESS, LLC**

**PARKING**

**610101A  
610101B**