

DAVID Y. IGE  
GOVERNOR



STATE OF HAWAII  
DEPARTMENT OF TRANSPORTATION  
869 PUNCHBOWL STREET  
HONOLULU, HAWAII 96813-5097

JADE. T. BUTAY  
DIRECTOR

Deputy Directors  
ROSS M. HIGASHI  
EDUARDO P MANGLALLAN  
PATRICK H. MCCAIN  
EDWIN H. SNIFFEN

IN REPLY REFER TO:

Board of Land and  
Natural Resources  
State of Hawai'i  
Honolulu, Hawai'i

ISSUANCE OF A REVOCABLE PERMIT FOR A CONCESSION  
TO CONDUCT MOBILE WIRELESS ROUTER AND SIM CARD RENTALS  
JCL INTERNATIONAL CONSULTANTS, INC.  
DANIEL K. INOUE INTERNATIONAL AIRPORT  
TAX MAP KEY: (1) 1-1-003:195 (PORTION)

O'AHU

LEGAL REFERENCE:

Section 171-55, Hawai'i Revised Statutes (HRS).

APPLICANT:

JCL International Consultants, Inc. (JCL) whose business address is 2222 Kalakaua Avenue, #700, Honolulu, Hawai'i 96815.

LOCATION AND TAX MAP KEY:

Daniel K. Inouye International Airport  
Tax Map Key: 1<sup>st</sup> Division, (1) 1-1-003: 195 (Portion)

AREA:

Area/Space Nos. 352-105A and 352-105B, containing an area of approximately 55 and 29 square feet respectively as shown and delineated on the attached Exhibit A.

ZONING:

State Land Use District:	Urban
County of Hawai'i:	Industrial (I-2)

LAND TITLE STATUS:

Section 5(a) lands of the Hawai'i Admissions Act: Non-Ceded  
DHHL 30% entitlement lands pursuant to the Hawai'i State Constitution: No

CURRENT USE STATUS:

Land presently encumbered by Governor's Executive Order No. 3201, dated June 8, 1983, setting aside 3,152,177 acres designated as Daniel K. Inouye International Airport under the control and management of the State of Hawai'i, Department of Transportation Airports Division (DOTA) for Airports Purposes.

CHARACTER OF USE:

JCL will use the space to operate a concession to conduct mobile wireless router and sim card rentals to international travelers' that provide accessibility to mobile cellular coverage and the internet.

COMMENCEMENT DATE:

Upon execution of the document.

MONTHLY RENTAL:

Concession Fee to consist of the greater amount of \$798.00 or fifteen percent (15%) of the monthly gross receipts.

SECURITY DEPOSIT:

\$ 2,394.00, or three (3) times the monthly rental in effect.

DCCA VERIFICATION:

Place of business registration confirmed:	YES <u>X</u>	NO _____
Registered business name confirmed:	YES <u>X</u>	NO _____
Good standing confirmed:	YES <u>X</u>	NO _____

CHAPTER 343, HRS – ENVIRONMENTAL ASSESSMENT:

The State of Hawai'i, Department of Transportation, Airports Division (HDOT-A), has determined that the impacts of this action are de minimis and exempt, pursuant to Department of Transportation, Comprehensive Exemption List, Type 8, Part 1, 8(g), concurred to by the Environmental Advisory Council on February 1, 2022.

BLNR – ISSUANCE OF A REVOCABLE PERMIT FOR MOBILE WIRELESS ROUTER  
AND SIM CARD RENTALS, JCL INTERNATIONAL CONSULTANTS, INC.  
PAGE 3

REMARKS:

The issuance of a revocable permit to JCL to operate a concession to offer mobile wireless router and sim card rentals that provide international travelers' accessibility to mobile cellular coverage and the internet.

RECOMMENDATION:

That the Board authorize the Department of Transportation to issue a month-to-month revocable permit to JCL, subject to: (1) terms and conditions herein outlined, which are by reference incorporated herein; and (2) such additional terms and conditions as may be prescribed by the Director of Transportation to best serve the interests of the State.

Respectfully submitted,



JADE T. BUTAY  
Director of Transportation

APPROVAL FOR SUBMITTAL:

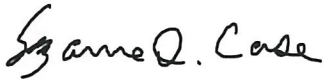

SUZANNE D. CASE  
Chairperson and Member

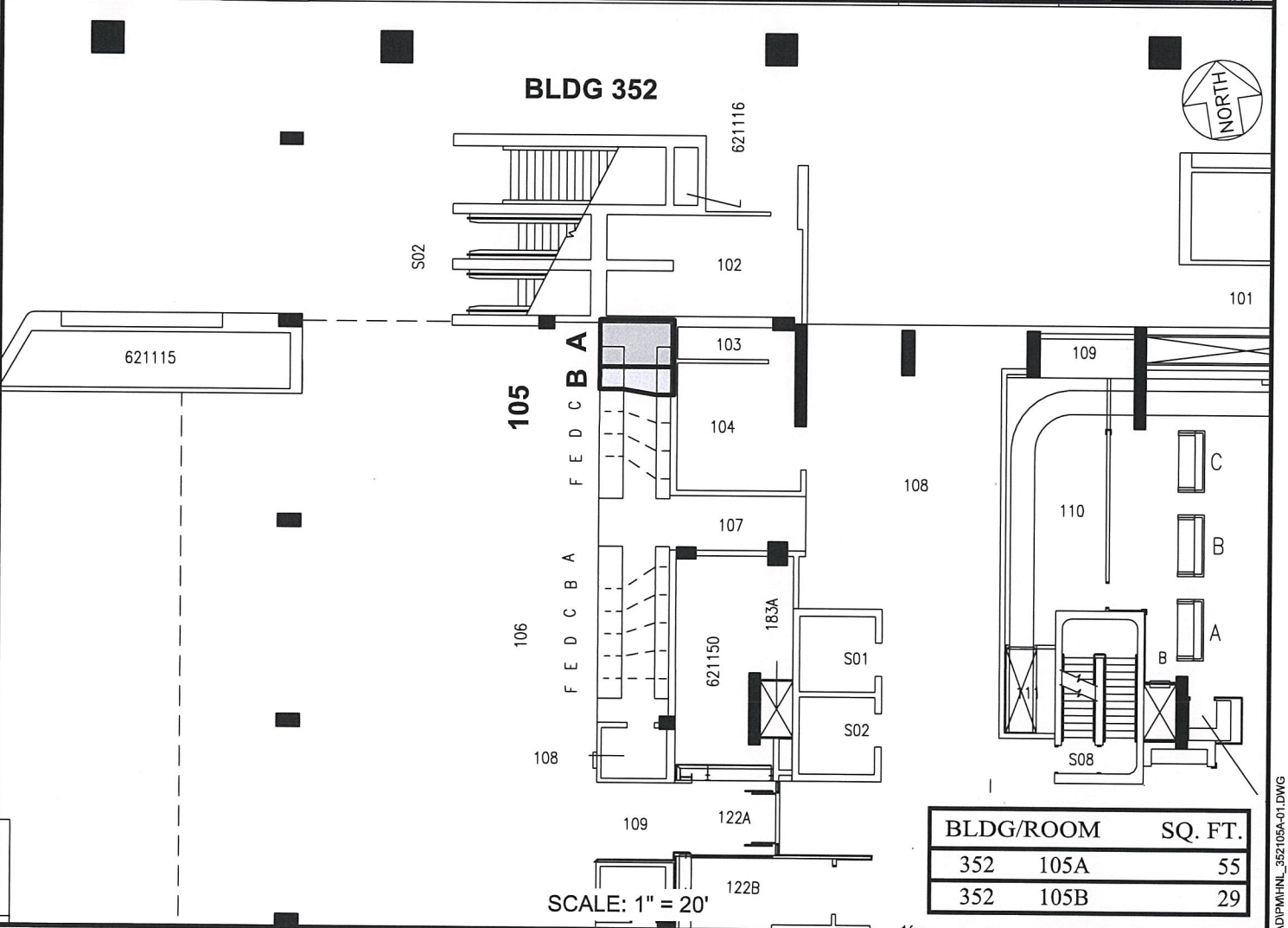
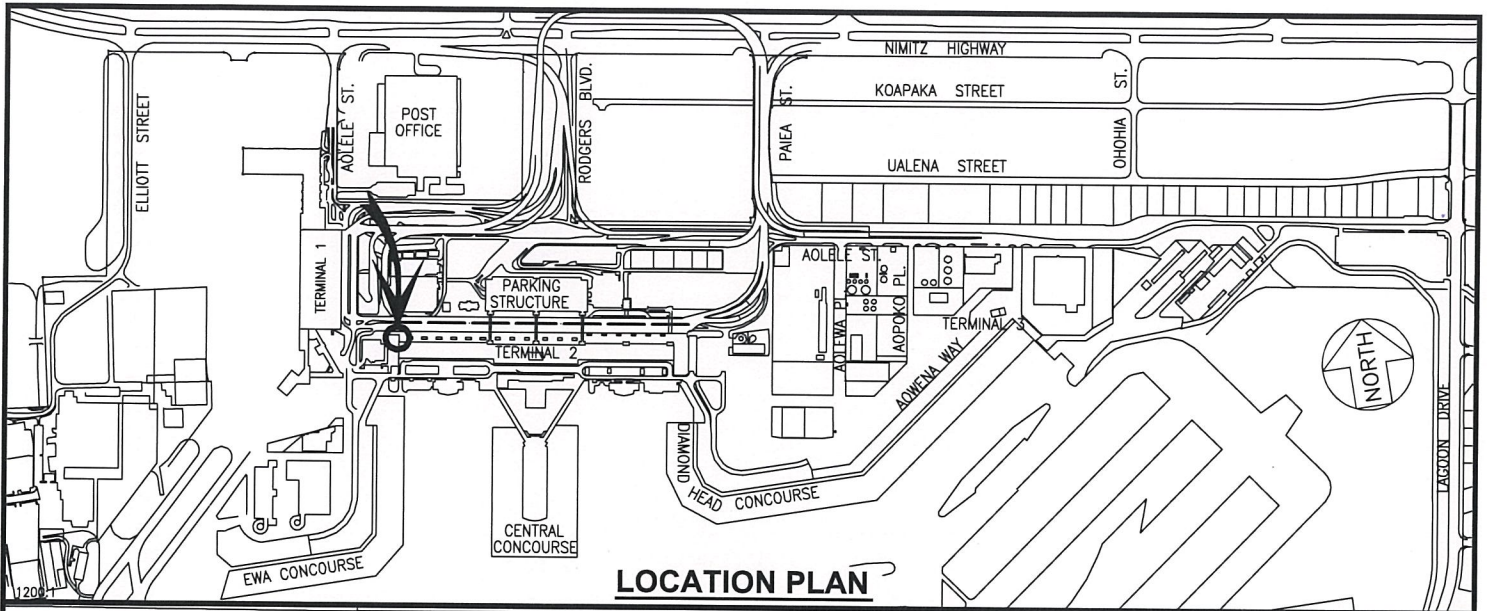

DATE : MARCH 2022

EXHIBIT: **A**



JCL INTERNATIONAL CONSULTANTS, INC.

BUILDING 352  
GROUND LEVEL

352105A-B  
PLAT B1