



**STATE OF HAWAII**  
**DEPARTMENT OF TRANSPORTATION**  
869 PUNCHBOWL STREET  
HONOLULU, HAWAII 96813-5097

Board of Land and  
Natural Resources  
State of Hawai'i  
Honolulu, Hawai'i

ISSUANCE OF A REVOCABLE PERMIT FOR AIRCRAFT PARKING  
BENJAMIN P. SAND  
LĪHU'E AIRPORT  
TAX MAP KEY: (4) 3-5-001: 008 (PORTION)

KAUA'I

REQUEST:

Issuance of a Revocable Permit for Aircraft Parking (Parking Permit) to Benjamin P. Sand for two (2) aircraft tie-down spaces, situated at Līhu'e Airport.

LEGAL REFERENCE:

Section 171-55, Hawai'i Revised Statutes (HRS).

APPLICANT:

Benjamin P. Sand (Mr. Sand), whose mailing address is P. O. Box 411, Koloa, Hawai'i 96756-0411.

LOCATION AND TAX MAP KEY:

Portions of Līhu'e Airport (LIH), Līhu'e, Island of Kaua'i, identified by Tax Map Key: 4<sup>th</sup> Division, 3-5-001: 008 (Portion).

AREA:

Area/Space No. 415-101, containing an area of approximately 990 square feet; and Area/Space No. 415-104, containing an area of approximately 990 square feet, as shown and delineated on the attached Exhibit A.

ZONING:

State Land Use District: Urban  
County of Kaua'i Industrial General/Special Treatment-Public Use (IG/ST-P)

**ITEM M-6**

LAND TITLE STATUS:

Section 5(a) lands of the Hawai'i Admission Act: Non-Ceded  
DHHL 30% entitlement lands pursuant to Hawai'i Admission Act YES \_\_\_ NO X

CURRENT USE STATUS:

Land presently encumbered by Governor's Executive Order No. 4614, dated October 28, 2019, setting aside 883.583 acres designated as Līhu'e Airport to be under the control and management of the State of Hawai'i, Department of Transportation for Airport Purposes.

CHARACTER OF USE:

Two (2) aircraft tie-down spaces (1980 Beech BE-77, Tail No. N-991AB and 1977 Beech BE-77, Tail No. N-992MB).

COMMENCEMENT DATE:

Upon execution of the revocable permit.

MONTHLY RENTAL:

\$252.00 (\$126.00 per tie-down, as determined from the Department of Transportation, Airports Division schedule of rates and charges established by appraisal of Airports property statewide).

SECURITY DEPOSIT:

\$756.00, or three (3) times the monthly rental in effect.

CHAPTER 343, HRS - ENVIRONMENTAL ASSESSMENT:

The State of Hawai'i, Department of Transportation, Airports Division (DOTA), has determined that the environmental impacts of the proposed disposition for the subject land use is covered by the Līhu'e Airport Ahukini Road Realignment and General Aviation Subdivision Final Environmental Assessment (FEA), published by the Office of Environmental Quality Control (OEQC) in the April 23, 1997, issue of The Environmental Notice. Accordingly, all relevant mitigation from the FEA and best management practices will be implemented to address the minimum impacts of this action.

BLNR – ISSUANCE OF A REVOCABLE PERMIT FOR AIRCRAFT PARKING  
BENJAMIN P. SAND

Page 3

REMARKS:

In accordance with Section 171-55, HRS, relating to Permits, the Department of Transportation proposes to issue a month-to-month Parking Permit to Mr. Sand for two (2) aircraft parking spaces at Līhu‘e Airport.

RECOMMENDATION:

That the Board authorizes the Department of Transportation to issue a month-to-month Parking Permit to Mr. Sand subject to: (1) terms and conditions herein outlined, which are by reference incorporated herein; (2) such additional terms and conditions as may be prescribed by the Director of Transportation to best serve the interests of the State.

Respectfully submitted,



JADE T. BUTAY  
Director of Transportation

APPROVED FOR SUBMITTAL:

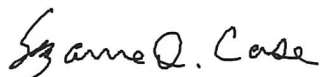

SUZANNE D. CASE  
Chairperson and Member

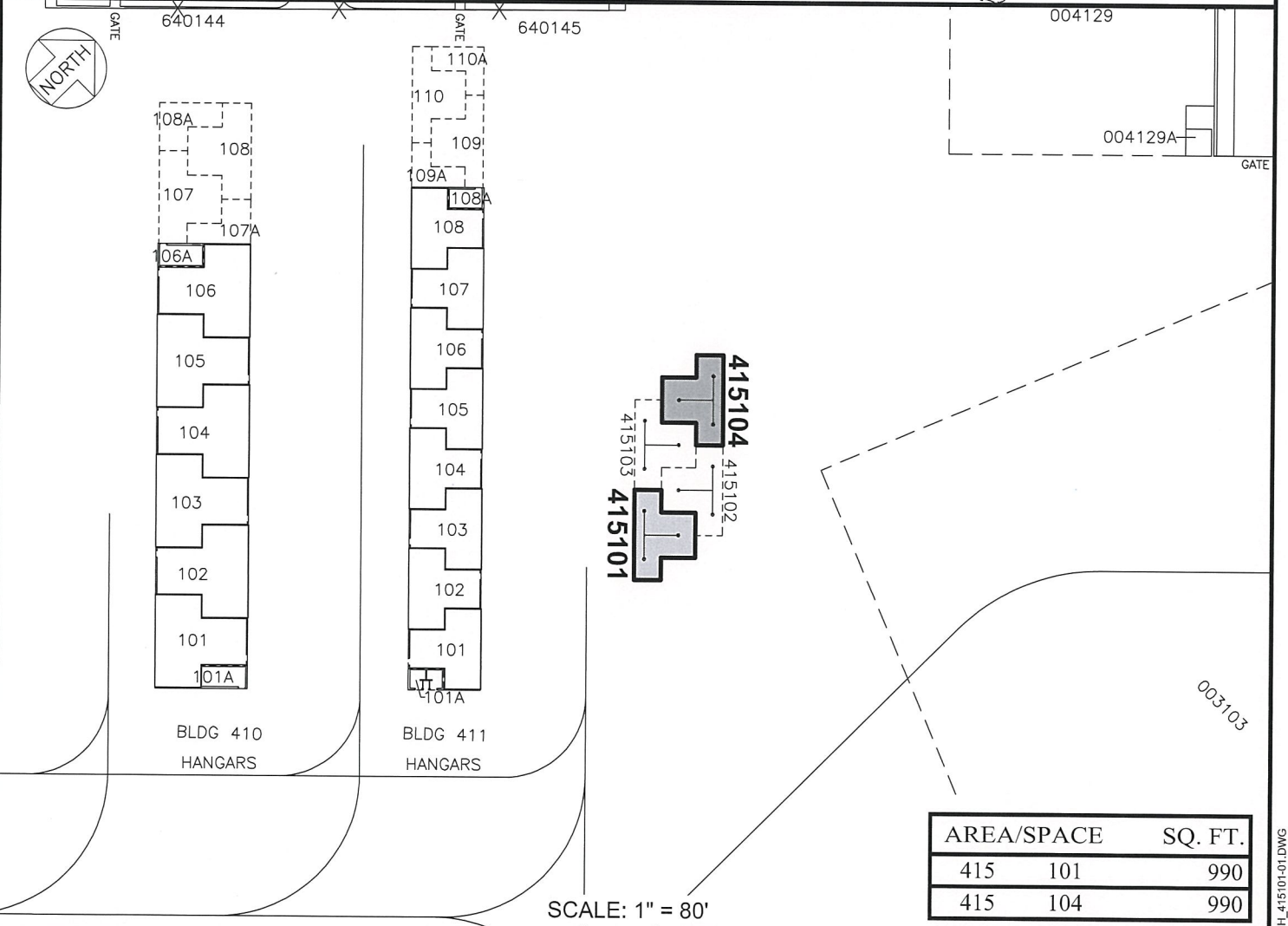
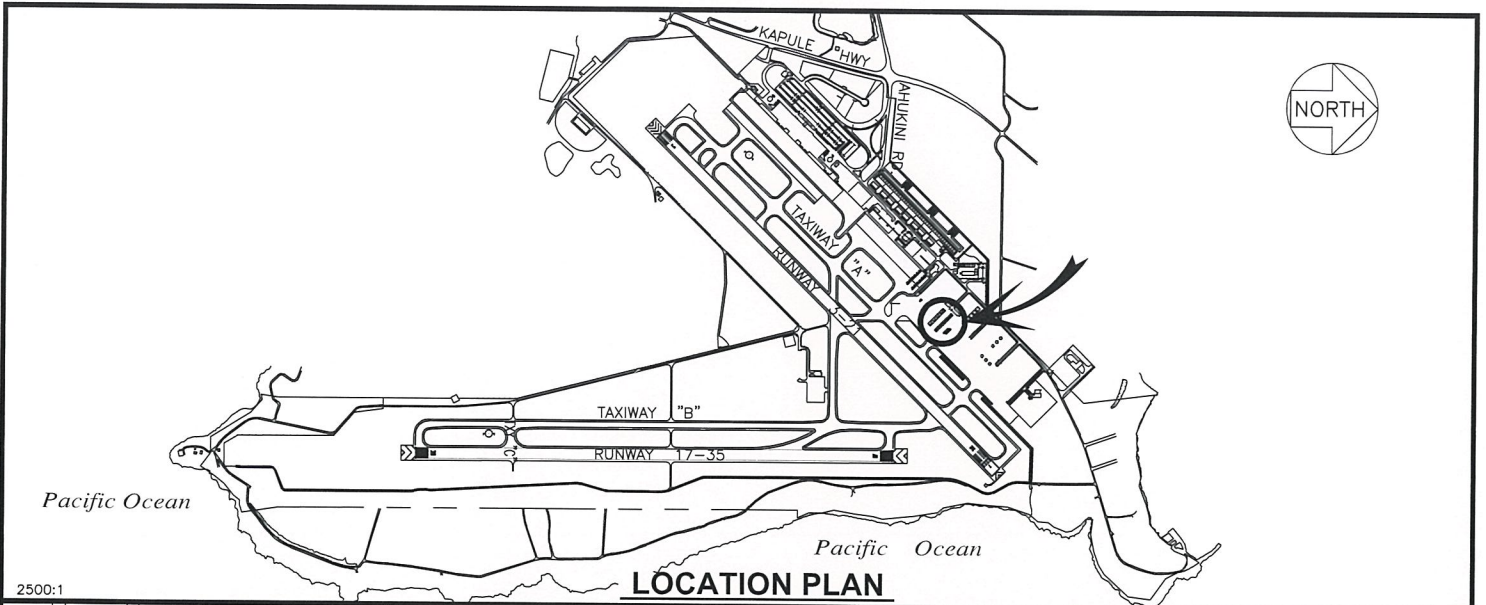

PP-22-K002	DATE : MARCH 2022	EXHIBIT: <b>A</b>
Airports Division	BENJAMIN P. SAND	TIE-DOWNS
		415101 415104 PLAT E1, 35