

DAVID Y. IGE
GOVERNOR



STATE OF HAWAII
DEPARTMENT OF TRANSPORTATION
869 PUNCHBOWL STREET
HONOLULU, HAWAII 96813-5097

JADE T. BUTAY
DIRECTOR

Deputy Directors
ROSS M. HIGASHI
EDUARDO P. MANGALLAN
PATRICK H. MCCAIN
EDWIN H. SNIFFEN

IN REPLY REFER TO:

Board of Land and
Natural Resources
State of Hawai'i
Honolulu, Hawai'i

ISSUANCE OF A REVOCABLE PERMIT FOR INSTALLATION OF ADS-B RADIO
EQUIPMENT AND AN ANTENNA TO SUPPORT THE OPERATION OF THE U.S.
FEDERAL AVIATION ADMINISTRATION AIR TRAFFIC CONTROL TOWER
L3HARRIS TECHNOLOGIES, INC.
ELLISON ONIZUKA KONA INTERNATIONAL AIRPORT AT KEĀHOLE
TAX MAP KEY: (3) 7-3-43: PORTION OF 032 HAWAI'I

LEGAL REFERENCE:

Section 171-55, Hawai'i Revised Statutes (HRS).

APPLICANT:

L3Harris Technologies, Inc. (L3Harris), a Delaware corporation, authorized to do
business in the State of Hawai'i, whose mailing address is 2235 Monroe Street, 5th Floor,
Herndon, Virginia 20171.

LOCATION AND TAX MAP KEY:

Portion of Ellison Onizuka Kona International Airport at Keāhole (KOA), Kailua-Kona,
Island of Hawai'i, identified by Tax Map Key: 3rd Division, 7-3-43: Portion of 032.

AREA:

Area/Space No. 002-149, containing an area of approximately 238 square feet of
improved, unpaved land, as shown and delineated on the attached Exhibit A.

ZONING:

State Land Use District:	Urban & Conservation
County of Hawai'i:	Industrial (MG-1a) and Open

ITEM M-8

BLNR – ISSUANCE OF A REVOCABLE PERMIT FOR INSTALLATION OF ADS-B
RADIO EQUIPMENT AND AN ANTENNA TO SUPPORT THE OPERATION OF THE U.S.
FEDERAL AVIATION ADMINISTRATION AIR TRAFFIC CONTROL TOWER
L3HARRIS TECHNOLOGIES, INC.

Page 2

LAND TITLE STATUS:

Section 5(a) lands of the Hawai'i Admission Act: Ceded
DHHL 30% entitlement lands pursuant to Hawai'i Admission Act YES ___ NO X

CURRENT USE STATUS:

Land presently encumbered by Governor's Executive Order No. 3074, dated August 20, 1981, setting aside 4,204.10 acres designated as Ellison Onizuka Kona International Airport at Keāhole to be under the control and management of the State of Hawai'i, Department of Transportation, Airports Division for Airport Purposes.

CHARACTER OF USE:

L3Harris will use the space for the installation of ADS-B radio equipment and an antenna to support the operation of the U.S. Federal Aviation Administration Air Traffic Control Tower at KOA.

COMMENCEMENT DATE:

Upon execution of the revocable permit.

MONTHLY RENTAL:

\$28.56 (based on a rate of \$1.44 for improved, unpaved land, as determined from the Airports Division Schedule of Rates and Charges for Airport properties statewide).

SECURITY DEPOSIT:

\$85.68, or three (3) times the monthly rental in effect.

DCCA VERIFICATION:

Place of business registration confirmed:	YES <u>X</u>	NO _____
Registered business name confirmed:	YES <u>X</u>	NO _____
Good standing confirmed:	YES <u>X</u>	NO _____

BLNR – ISSUANCE OF A REVOCABLE PERMIT FOR INSTALLATION OF ADS-B
RADIO EQUIPMENT AND AN ANTENNA TO SUPPORT THE OPERATION OF THE U.S.
FEDERAL AVIATION ADMINISTRATION AIR TRAFFIC CONTROL TOWER
L3HARRIS TECHNOLOGIES, INC.

Page 3

CHAPTER 343, HRS - ENVIRONMENTAL ASSESSMENT:

The State of Hawai'i, Department of Transportation, Airports Division (DOTA), has determined that the subject land area is covered by the Kona International Airport at Keāhole Master Plan Update Final Environmental Assessment (EA) and Finding of No Significant Impact (FONSI), dated November 2000, and published by the Office of Environmental Quality Control (OEQC) in the January 8, 2001, issue of The Environmental Notice. Accordingly, all relevant mitigation from the EA and best management practices will be implemented to address the minimum impacts of this action.

REMARKS:

In accordance with Section 171-55, HRS, relating to Permits, the Department of Transportation proposes to issue a month-to-month revocable permit to L3Harris for the installation of ADS-B radio equipment and an antenna to support the operation of the U.S. Federal Aviation Administration at KOA.

RECOMMENDATION:

That the Board authorize the Department of Transportation to issue a month-to-month revocable permit to L3Harris, subject to: (1) terms and conditions herein outlined, which are by reference incorporated herein; and (2) such additional terms and conditions as may be prescribed by the Director of Transportation to best serve the interests of the State.

Respectfully submitted,



JADE T. BUTAY
Director of Transportation

APPROVED FOR SUBMITTAL:

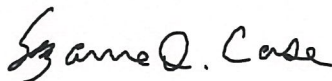

SUZANNE D. CASE
Chairperson and Member

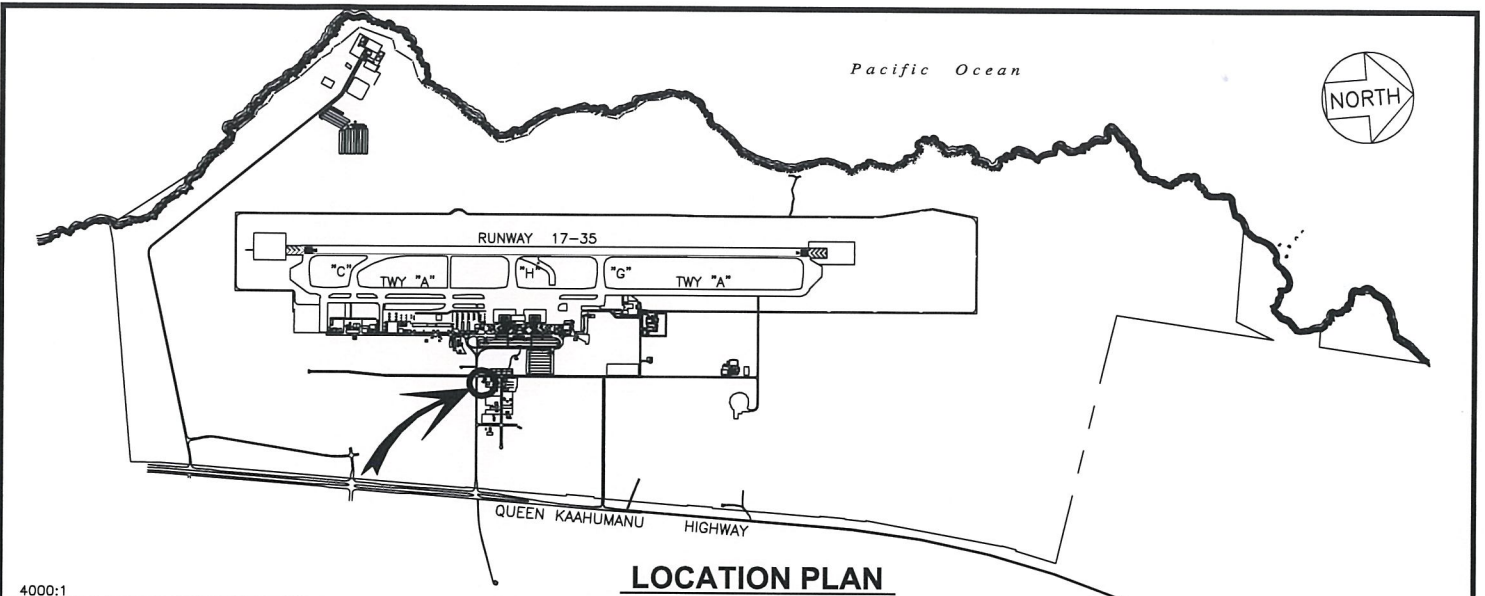

4000:1

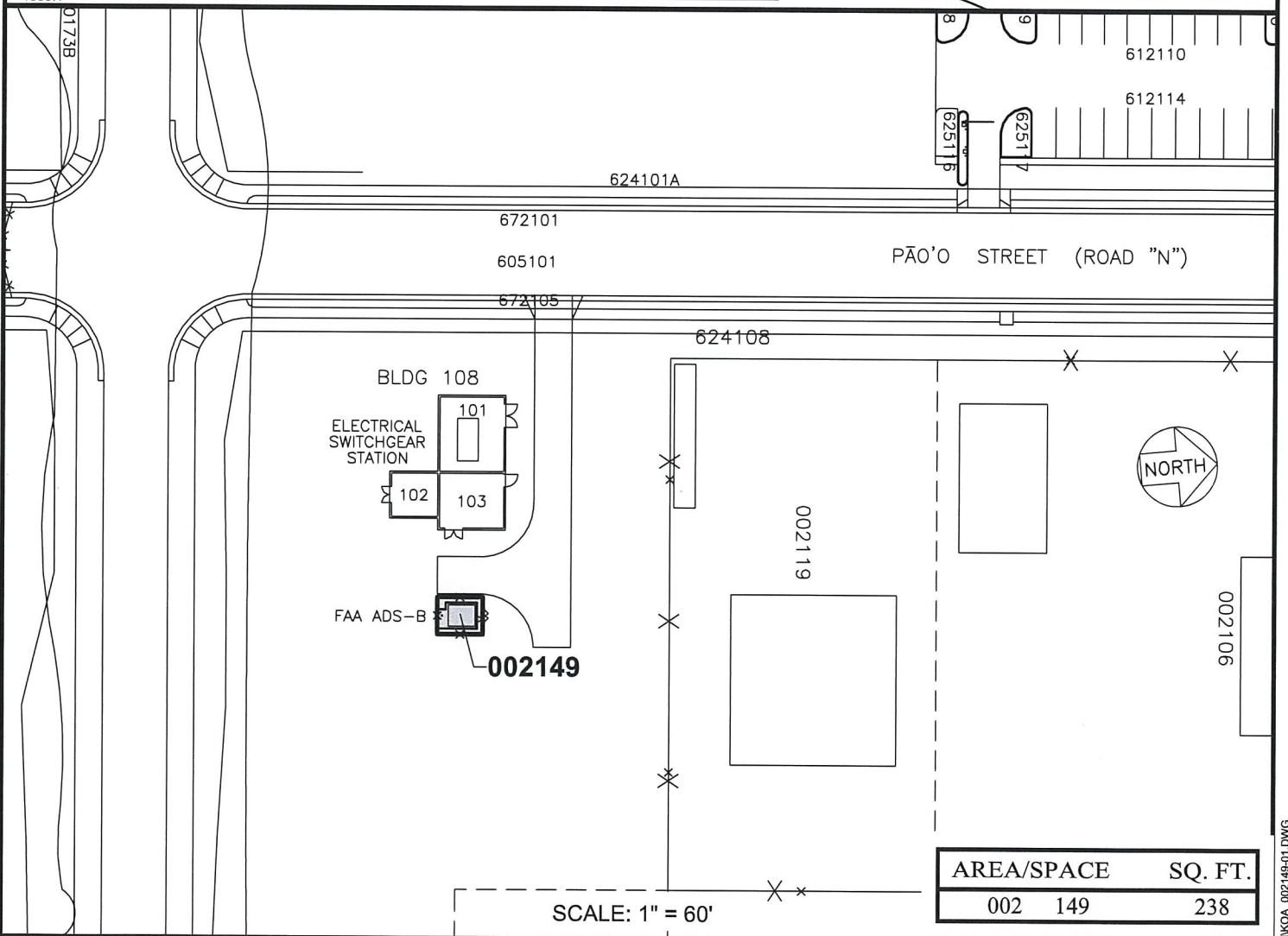

RP-9217

DATE : MARCH 2022

EXHIBIT: **A**



L3HARRIS
TECHNOLOGIES, INC.

BLDG 108 AREA

002149
PLAT 59

Adobe Sign Transaction Number: CB1CHBCAABA6M6QLucLUdhPrBelfuQ5aCokBo351D6

N:\AIRPORTS\KOA_KONA\CAD\PI\KOA_002149-01.DWG

ELLISON ONIZUKA KONA INTERNATIONAL AIRPORT AT KEAHOLE