

DAVID Y. IGE
GOVERNOR



STATE OF HAWAII
DEPARTMENT OF TRANSPORTATION
869 PUNCHBOWL STREET
HONOLULU, HAWAII 96813-5097

JADE T. BUTAY
DIRECTOR

Deputy Directors
ROSS M. HIGASHI
EDUARDO P. MANGLALLAN
EDWIN H. SNIFFEN

IN REPLY REFER TO:

Board of Land and
Natural Resources
State of Hawai'i
Honolulu, Hawai'i

ISSUANCE OF A REVOCABLE PERMIT FOR OFFICE SPACE
FEDERAL EXPRESS CORPORATION
MOLOKA'I AIRPORT
TAX MAP KEY: (2) 5-2-04: PORTION OF 106

MAUI

LEGAL REFERENCE:

Section 171-55, Hawai'i Revised Statutes (HRS).

APPLICANT:

Federal Express Corporation (FEDEX) whose business address is 3680 Hacks Cross Road, Building H, 3rd Floor, Memphis, Tennessee 38125.

LOCATION AND TAX MAP KEY:

Portion of Moloka'i Airport (MKK), Hoolehua, Island of Moloka'i, County of Maui, identified by Tax Map Key: 2nd Division, 5-2-04: Portion of 106.

AREA:

Building/Room No. 301-140, containing an area of approximately 132 square feet, as shown and delineated on the attached Exhibit A.

ZONING:

State Land Use District: Agricultural
County of Maui: Interim Zoning Provisions of the Maui County Zoning Code

ITEM M-11

LAND TITLE STATUS:

Section 5(a) lands of the Hawai'i Admission Act: Ceded
DHHL 30% entitlement lands pursuant to Hawai'i Admission Act YES___ NO X

CURRENT USE STATUS:

Land presently encumbered by Governor's Executive Order No. 1611, dated February 1, 1954, setting aside 10.321 acres designated as Moloka'i Airport to be under the control and management of the State of Hawai'i, Department of Transportation for Public Purposes.

CHARACTER OF USE:

FEDEX will use the space for an office in the terminal as part of its freight delivery operation at MKK.

COMMENCEMENT DATE:

Upon complete execution of the revocable permit.

MONTHLY RENTAL:

\$281.38 (\$210.10 as determined from the Department of Transportation, Airports Division schedule of rates and charges established by appraisal of Airports property statewide plus \$51.48 for utilities and \$19.80 for maintenance).

SECURITY DEPOSIT:

\$844.14, or three (3) times the monthly rental in effect.

DCCA VERIFICATION:

Place of business registration confirmed:	YES <u>X</u>	NO ___
Registered business name confirmed:	YES <u>X</u>	NO ___
Good standing confirmed:	YES <u>X</u>	NO ___

CHAPTER 343, HRS - ENVIRONMENTAL ASSESSMENT:

The State of Hawai'i, Department of Transportation, Airports Division (HDOT-A), has determined that the subject area is covered by the Moloka'i Airport Improvements Environmental Assessment (EA), published by the Environmental Quality Commission (EQC) in the December 23, 1981 issue of the EQC Bulletin. Accordingly, all relevant mitigation from the EA and best management practices will be implemented to address the minimum impacts of this action.

BLNR – ISSUANCE OF A REVOCABLE PERMIT FOR OFFICE SPACE
FEDERAL EXPRESS CORPORATION

Page 3

REMARKS:

In accordance with Section 171-55, HRS, relating to Permits, the Department of Transportation proposes to issue a month-to-month revocable permit to FEDEX for office space in the terminal, as part of its freight delivery operation at MKK.

RECOMMENDATION:

That the Board authorize the Department of Transportation to issue a month-to-month revocable permit to FEDEX, subject to: (1) terms and conditions herein outlined, which are by reference incorporated herein; and (2) such additional terms and conditions as may be prescribed by the Director of Transportation to best serve the interests of the State.

Respectfully submitted,



JADE T. BUTAY
Director of Transportation

APPROVED FOR SUBMITTAL:

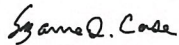

SUZANNE D. CASE
Chairperson and Member

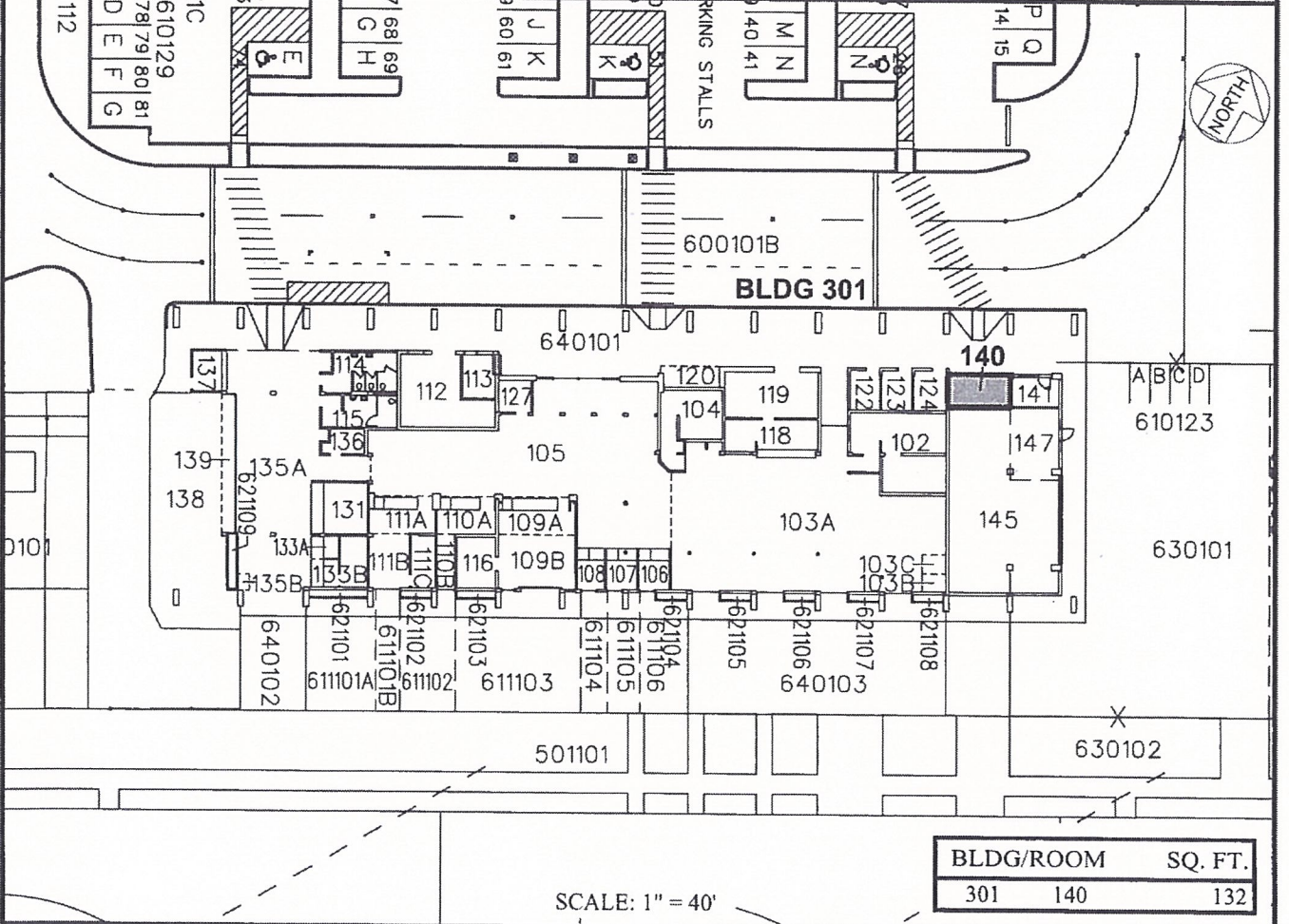
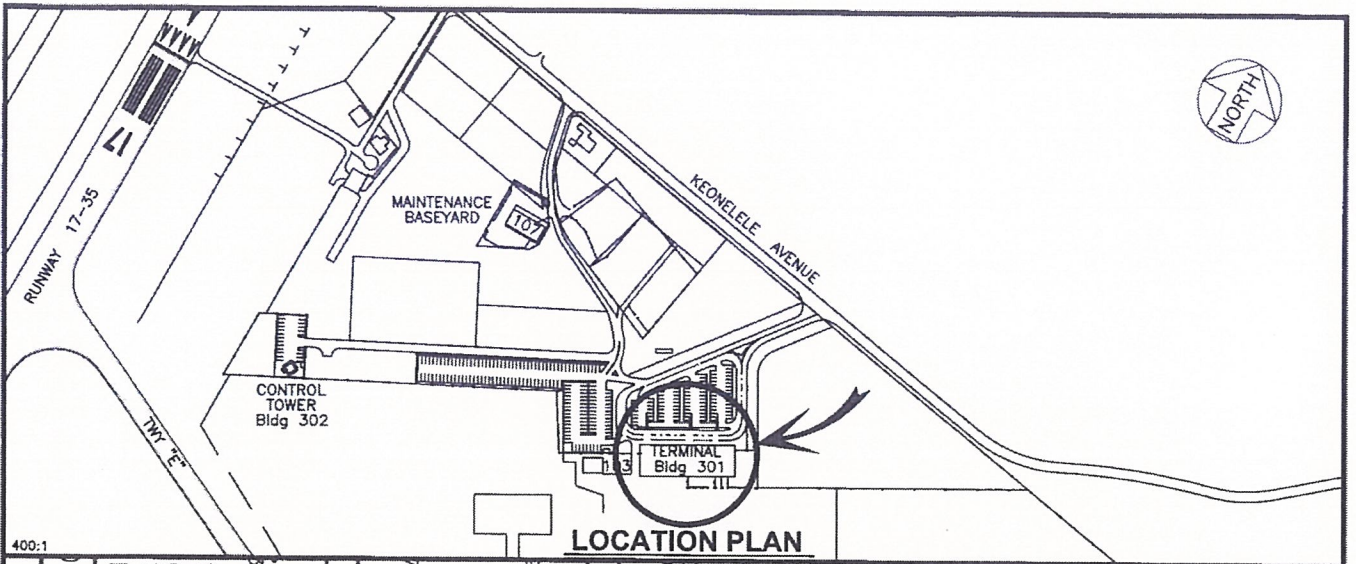

BLDG/ROOM	SQ. FT.
301 140	132

SCALE: 1" = 40'

DATE : SEPTEMBER 2021

EXHIBIT: **A**

<p>Airports Division</p>	<p>FEDERAL EXPRESS CORPORATION</p>	<p>BUILDING 301</p>	<p>301140</p>
		<p>TERMINAL BUILDING</p>	<p>PLAT A1,33</p>
		<p>GROUND LEVEL</p>	

MOLOKAI AIRPORT

N:\AIRPORTS\MKK_Molokai\CAD\PM\mkk_301140-01.dwg