



**STATE OF HAWAII**  
**DEPARTMENT OF TRANSPORTATION**  
869 PUNCHBOWL STREET  
HONOLULU, HAWAII 96813-5097

JADE T. BUTAY  
DIRECTOR

Deputy Directors  
ROSS M. HIGASHI  
EDUARDO P. MANGLALLAN  
EDWIN H. SNIFFEN

IN REPLY REFER TO:

Board of Land and  
Natural Resources  
State of Hawai'i  
Honolulu, Hawai'i

ISSUANCE OF A REVOCABLE PERMIT FOR ADMINISTRATIVE OFFICES AND  
PILOT TRAINING FACILITIES  
KAMAKA AIR LLC  
DANIEL K. INOUE INTERNATIONAL AIRPORT  
TAX MAP KEY: (1) 1-1-072: 018 (PORTION)

O'AHU

APPLICANT:

Kamaka Air LLC, whose business address is 144 Palekona Street, Honolulu, Hawai'i 96819.

LEGAL REFERENCE:

Section 171-55, Hawai'i Revised Statutes.

LOCATION AND TAX MAP KEY:

90 Nakolo Place, Honolulu, Hawai'i, identified as Building No. 206 at Daniel K. Inouye International Airport, Island of Oahu, State of Hawai'i, identified by Tax Map Key: 1<sup>st</sup> Division, 1-1-072: 018 (portion).

AREA:

Building/Room No. 206-116, containing an area of approximately 1,441 square feet, and Building/Room No. 206-119E, containing an area of approximately 613 square feet, as shown and delineated on the attached map labeled Exhibit "A".

ZONING:

State Land Use District: Urban  
City and County of Honolulu LUO: Industrial (I-2)

**ITEM M-3**

LAND TITLE STATUS:

Non-Ceded - Section 5(b) lands of the Hawai'i Admission Act  
DHHL 30% entitlement lands pursuant to Hawai'i Admission Act YES \_\_\_ NO X

CURRENT USE STATUS:

Land presently encumbered by Governor's Executive Order No. 3201, dated June 8, 1983, setting aside 3,152.177 acres designated as Daniel K. Inouye International Airport under the control and management of the State of Hawai'i, Department of Transportation, Airports Division (DOTA) for Airport Purposes.

CHARACTER OF USE:

Kamaka Air LLC will use the spaces for administrative offices and pilot training facilities at Daniel K. Inouye International Airport.

COMMENCEMENT DATE:

Upon execution of the revocable permit.

MONTHLY RENTAL:

\$2,362.10 (\$1,027.00, as determined from the DOTA schedule of rates and charges established by appraisal of Airports property statewide plus \$513.50 for air conditioning, \$308.10 for utilities and \$513.50 for maintenance).

SECURITY DEPOSIT:

\$7,086.30, or three (3) times the monthly rental in effect.

DCCA VERIFICATION:

Place of business registration confirmed:	YES <u>X</u>	NO ___
Registered business name confirmed:	YES <u>X</u>	NO ___
Good standing confirmed:	YES <u>X</u>	NO ___

CHAPTER 343, HRS - ENVIRONMENTAL ASSESSMENT:

The environmental impacts of the proposed action to the subject land area is covered by the Honolulu International Airport Master Plan Update and Noise Compatibility Program Environmental Assessment (EA), State Project No. AO1011-03. The EA is a joint State and Federal document, dated September 1989 and published in the October 23, 1989, issue of the OEQC Bulletin. Accordingly, relevant mitigation from the EA and DOT-A environmental best management practice will address minimal impacts from this action

BLNR – ISSUANCE OF A REVOCABLE PERMIT FOR ADMINISTRATIVE OFFICES AND  
PILOT TRAINING FACILITIES, KAMAKA AIR LLC

Page 3

REMARKS:

In accordance with Section 171-55 HRS, relating to Permits, the Department of Transportation proposes to issue a month-to-month revocable permit to Kamaka Air LLC for administrative offices and pilot training facilities at Daniel K. Inouye International Airport.

RECOMMENDATION:

That the Board authorize the Department of Transportation to issue a month-to-month revocable permit to Kamaka Air LLC, subject to: (1) terms and conditions herein outlined, which are by reference incorporated herein; and (2) such additional terms and conditions as may be prescribed by the Director of Transportation to best serve the interests of the State.

Respectfully submitted,

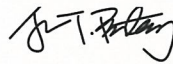

JADE T. BUTAY  
Director of Transportation

APPROVED FOR SUBMITTAL:

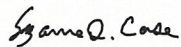

SUZANNE D. CASE  
Chairperson and Member

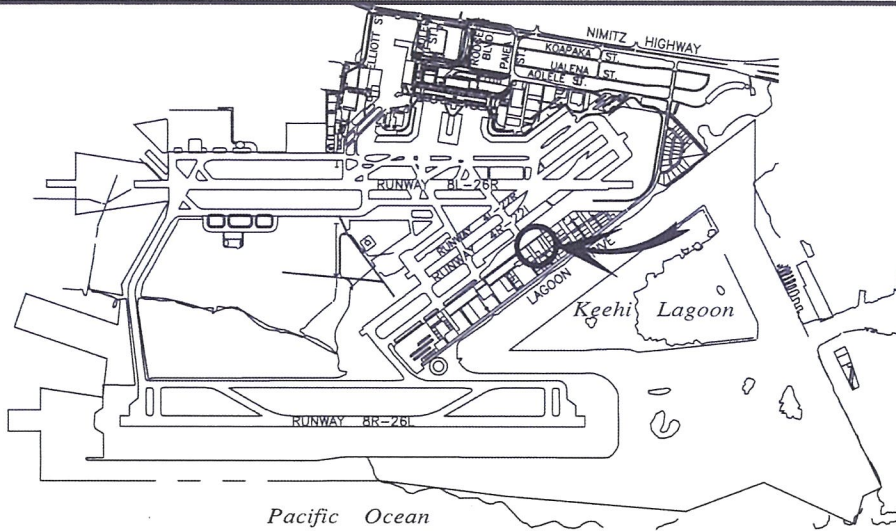

5000:1

**LOCATION PLAN**

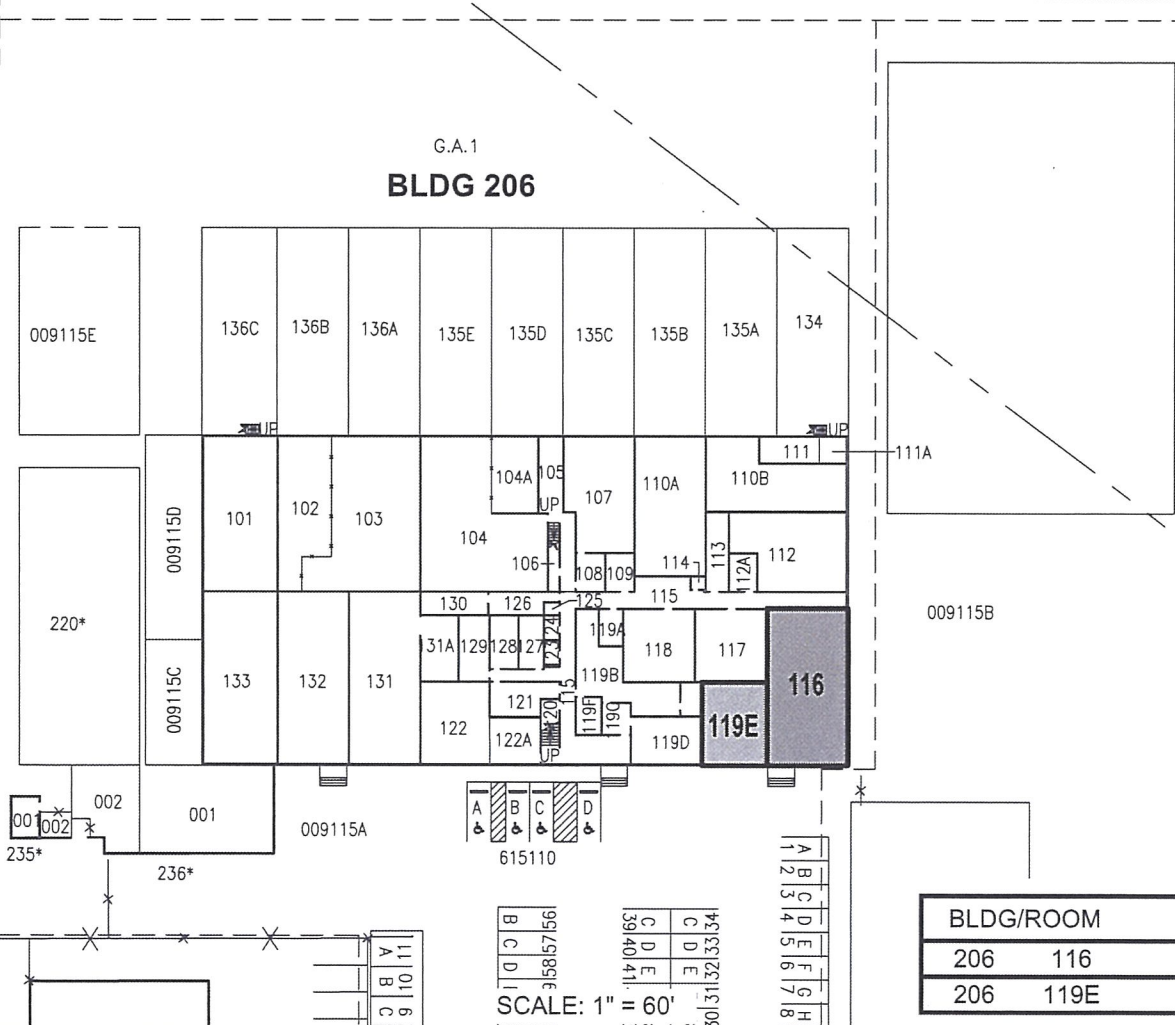

G.A.1  
**BLDG 206**

BLDG/ROOM	SQ. FT.
206 116	1,441
206 119E	613

SCALE: 1" = 60'

RP-9256

DATE : MAY 2022

EXHIBIT: **A**



Airports Division

KAMAKA AIR LLC

**BUILDING 206  
OLD AIR SERVICE BLDG  
GROUND LEVEL**

206116  
206119E  
**PLAT 36**

**DANIEL K. INOUE INTERNATIONAL AIRPORT**