

DAVID Y. IGE  
GOVERNOR



STATE OF HAWAII  
DEPARTMENT OF TRANSPORTATION  
869 PUNCHBOWL STREET  
HONOLULU, HAWAII 96813-5097

JADE T. BUTAY  
DIRECTOR  
  
Deputy Directors  
ROSS M. HIGASHI  
EDUARDO P. MANGLALLAN  
EDWIN H. SNIFFEN

IN REPLY REFER TO:

Board of Land and  
Natural Resources  
State of Hawai'i  
Honolulu, Hawai'i

ISSUANCE OF A REVOCABLE PERMIT FOR A T-HANGAR FOR  
THE STORAGE AND MAINTENANCE OF AN AIRCRAFT  
AI VU  
DANIEL K. INOUE INTERNATIONAL AIRPORT  
TAX MAP KEY: (1) 1-1-76: PORTION OF 22

O'AHU

REQUEST:

Issuance of a revocable permit for a T-hangar for the storage and maintenance of an aircraft to Ai Vu, situated at Daniel K. Inouye International Airport.

LEGAL REFERENCE:

Section 171-55, Hawai'i Revised Statutes (HRS).

APPLICANT:

Ai Vu, whose mailing address is 98-835 Ainanui Loop, Aiea, Hawai'i 96701.

LOCATION AND TAX MAP KEY:

A portion of Daniel K. Inouye International Airport, Island of Oahu, State of Hawai'i, identified by Tax Map Key: 1<sup>st</sup> Division, 1-1-76: portion of 22.

AREA:

Small Plane Hangar Unit No. 422-110, containing an area of approximately 1,247 square feet, as shown and delineated on the attached map labeled Exhibit "A".

ZONING:

State Land Use District: Urban  
City and County of Honolulu LUO: Industrial (I-2)

**ITEM M-8**

BLNR – ISSUANCE OF A REVOCABLE PERMIT FOR A T-HANGAR FOR THE STORAGE AND MAINTENANCE OF AIRCRAFT, AI VU

Page 2

LAND TITLE STATUS:

Non-Ceded - Section 5(a) lands of the Hawai'i Admission Act  
DHHL 30% entitlement lands pursuant to Hawai'i Admission Act YES \_\_\_ NO X

CURRENT USE STATUS:

Land presently encumbered by Governor's Executive Order No. 3201, dated June 8, 1983, setting aside 3,152.177 acres designated as Daniel K. Inouye International Airport under the control and management of the State of Hawai'i, Department of Transportation, Airports Division (DOTA) for Airport Purposes.

CHARACTER OF USE:

T-Hangar for storage and maintenance of an aircraft  
(2003 R44 Robinson, Tail No. N-808JT).

COMMENCEMENT DATE:

To be determined by the Director of Transportation at a later date.

MONTHLY RENTAL:

\$772.00 (\$717.00, as determined from the DOTA schedule of rates and charges, commercial rate for T-hangar, established by appraisal of Airports property statewide plus \$55.00 for electricity).

SECURITY DEPOSIT:

\$2,316.00, or three (3) times the monthly rental in effect.

CHAPTER 343, HRS - ENVIRONMENTAL ASSESSMENT:

The environmental impacts of the proposed action to the subject land area is covered by the Honolulu International Airport Master Plan Update and Noise Compatibility Program Environmental Assessment (EA), State Project No. AO1011-033. The EA is a joint State and Federal document, dated September 1989 and published in the October 23, 1989 issue of the OEQC Bulletin. Accordingly, relevant mitigation from the EA and DOTA environmental best management practice will address minimal impacts from this action.

BLNR – ISSUANCE OF A REVOCABLE PERMIT FOR A T-HANGAR FOR THE  
STORAGE AND MAINTENANCE OF AIRCRAFT, AI VU

Page 3

REMARKS:

Issuance of a revocable permit for a T-Hangar for the storage and maintenance of an aircraft to Ai Vu, situated at Daniel K. Inouye International Airport. complies with Chapter 343, Hawai'i Revised Statutes, as amended, relating to Environmental Impact Statements, and is in accordance with Section 171-55, HRS, relating to Permits.

RECOMMENDATION:

That the Board authorize the Department of Transportation to issue a month-to-month revocable permit to Ai Vu, subject to: (1) terms and conditions herein outlined, which are by reference incorporated herein; and (2) such additional terms and conditions as may be prescribed by the Director of Transportation to best serve the interests of the State.

Respectfully submitted,

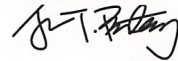

JADE T. BUTAY  
Director of Transportation

APPROVED FOR SUBMITTAL:

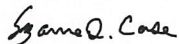

SUZANNE D. CASE  
Chairperson and Member

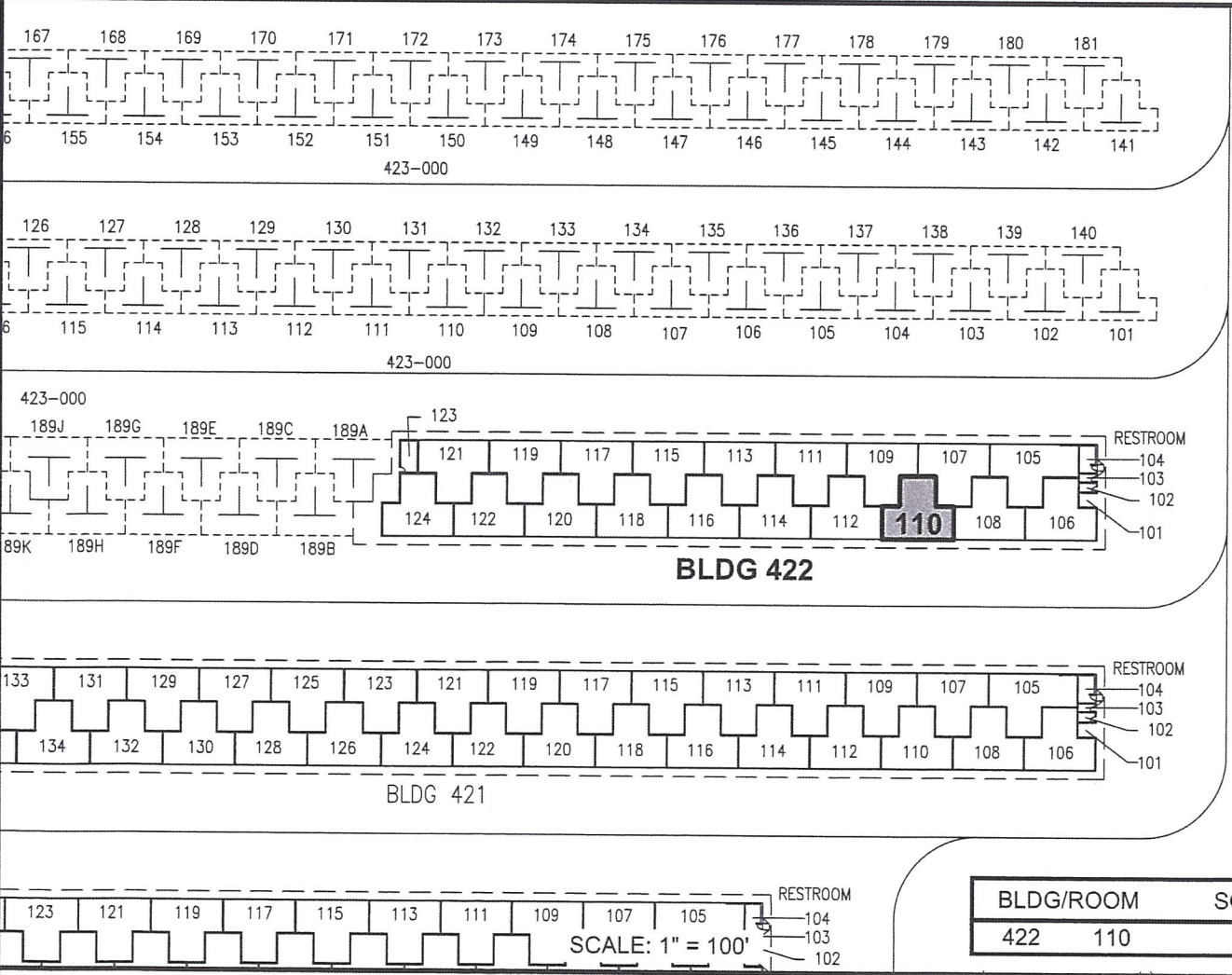
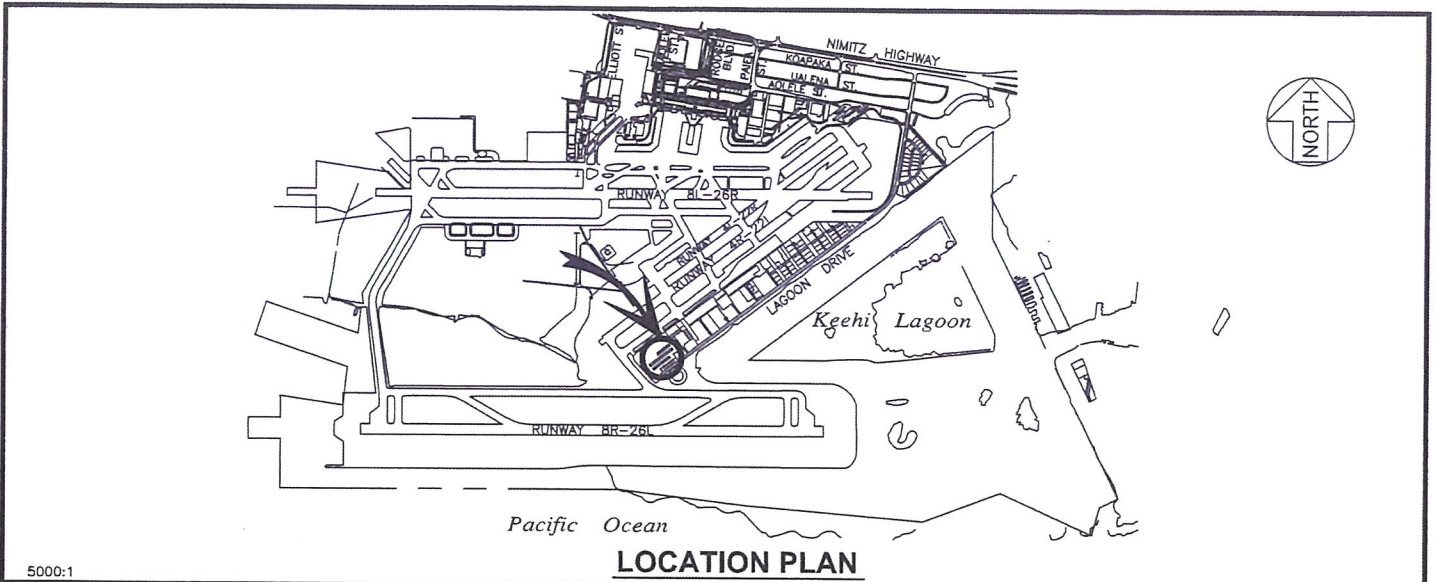

BLDG/ROOM	SQ. FT.
422 110	1,247

RP-9244	DATE : APRIL 2022	EXHIBIT: <b>A</b>
 Airports Division	VU, AI	T-HANGAR
		422110 PLAT 45

**DANIEL K. INOUE INTERNATIONAL AIRPORT**

Adobe Acrobat Sign Transaction Number: CBJCHBCAABAuhY5tw29-9TOhaa60IF1TWS2PYLpacfq

N:\AIRPORT\SHNL\_HONOLULU\CAD\PM\HNL\_422110-01.DWG