

DAVID Y. IGE  
GOVERNOR



STATE OF HAWAII  
DEPARTMENT OF TRANSPORTATION  
869 PUNCHBOWL STREET  
HONOLULU, HAWAII 96813-5097

JADE T. BUTAY  
DIRECTOR

Deputy Directors  
ROSS M. HIGASHI  
EDUARDO P. MANGLALLAN  
PATRICK H. MCCAIN  
EDWIN H. SNIFFEN

IN REPLY REFER TO:

Board of Land and  
Natural Resources  
State of Hawai'i  
Honolulu, Hawai'i

ISSUANCE OF A REVOCABLE PERMIT FOR VEHICLE PARKING  
FEDERAL EXPRESS CORPORATION  
ELLISON ONIZUKA KONA INTERNATIONAL AIRPORT AT KEĀHOLE  
TAX MAP KEY: (3) 7-3-43: PORTION OF 003

HAWAI'I

REQUEST:

Issuance of a Revocable Permit for Vehicle Parking (Parking Permit) to Federal Express Corporation for three (3) vehicle parking spaces, situated at Ellison Onizuka Kona International Airport at Keāhole.

LEGAL REFERENCE:

Section 171-55, Hawai'i Revised Statutes (HRS).

APPLICANT:

Federal Express Corporation (FedEx), whose business address is 73-220 U'u Street, Kailua-Kona, Hawai'i 96740.

LOCATION AND TAX MAP KEY:

Portion of Ellison Onizuka Kona International Airport at Keāhole (KOA), Kailua-Kona, Island of Hawai'i, identified by Tax Map Key: 3rd Division, 7-3-43: Portion of 003.

AREA:

Area/Space No. 610-154F, containing an area of approximately 513 square feet, as shown and delineated on the attached Exhibit A.

**ITEM M-9**

BLNR – ISSUANCE OF A REVOCABLE PERMIT FOR VEHICLE PARKING  
FEDERAL EXPRESS CORPORATION

Page 2

ZONING:

State Land Use District: Urban & Conservation  
County of Hawai'i: Industrial (MG-1a) and Open

LAND TITLE STATUS:

Section 5(a) lands of the Hawai'i Admission Act: Ceded  
DHHL 30% entitlement lands pursuant to Hawai'i Admission Act YES\_\_\_ NO X

CURRENT USE STATUS:

Land presently encumbered by Governor's Executive Order No. 3074, dated August 20, 1981, setting aside 4,204.10 acres designated as KOA under the control and management of the State of Hawai'i, Department of Transportation, Airports Division for Airport Purposes.

CHARACTER OF USE:

FedEx will use the three (3) vehicle parking spaces as part of their cargo operations at KOA.

COMMENCEMENT DATE:

Upon execution of the parking permit.

MONTHLY RENTAL:

\$165.00 (\$55.00 per stall as determined from the Department of Transportation, Airports Division schedule of rates and charges established by appraisal of Airports property statewide).

SECURITY DEPOSIT:

\$495.00, or three (3) times the monthly rental in effect.

CHAPTER 343, HRS - ENVIRONMENTAL ASSESSMENT:

The State of Hawaii, Department of Transportation, Airports Division, has determined that the subject land area and use is covered by the Keahole Airport General Aviation and Maintenance Baseyard Facilities Negative Declaration, published by the Environmental Quality Commission (EQC) in the December 23, 1980, issue of the EQC Bulletin. Accordingly, all relevant mitigation from the Negative Declaration and best management practices will be implemented to address the minimum impacts of this action.

BLNR – ISSUANCE OF A REVOCABLE PERMIT FOR VEHICLE PARKING  
FEDERAL EXPRESS CORPORATION

Page 3

REMARKS:

In accordance with Section 171-55, HRS, relating to Permits, the Department of Transportation proposes to issue a month-to-month Parking Permit to FedEx for three (3) vehicle parking spaces as part of their cargo operations at KOA.

RECOMMENDATION:

That the Board authorize the Department of Transportation to issue a month-to-month Parking Permit to FedEx, subject to: (1) terms and conditions herein outlined, which are by reference incorporated herein; and (2) such additional terms and conditions as may be prescribed by the Director of Transportation to best serve the interests of the State.

Respectfully submitted,



JADE T. BUTAY  
Director of Transportation

APPROVED FOR SUBMITTAL:

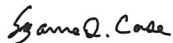

SUZANNE D. CASE  
Chairperson and Member

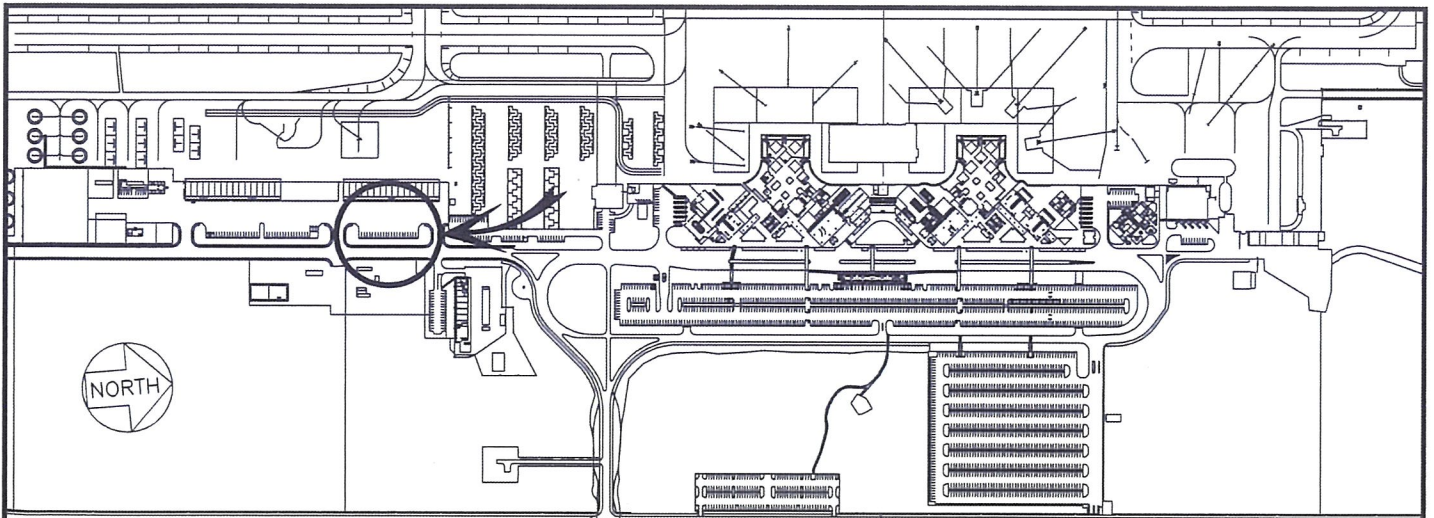

**LOCATION PLAN**

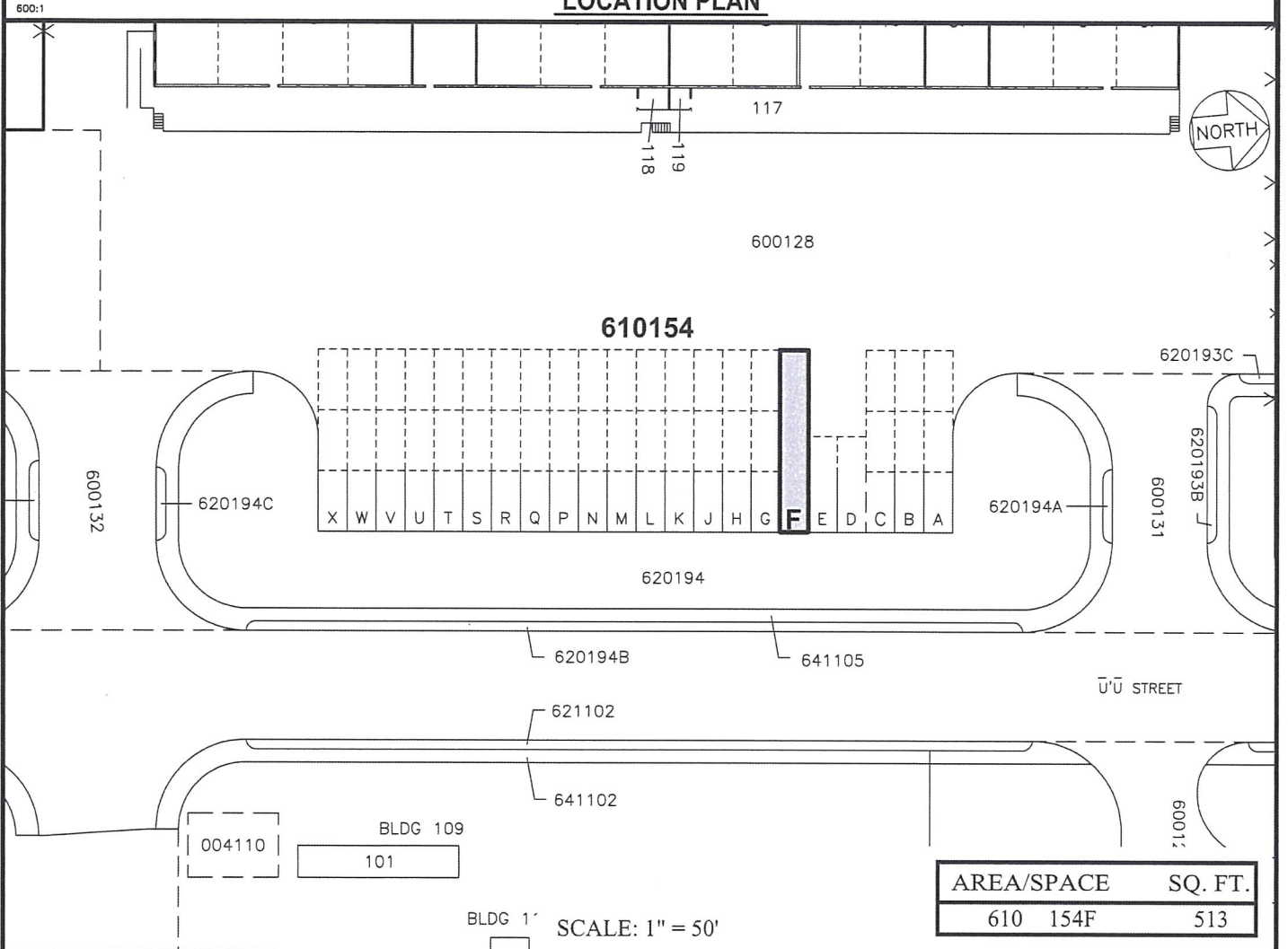

PP-22-N012

DATE : APRIL 2022

EXHIBIT: **A**

	<p>FEDERAL EXPRESS CORPORATION</p>	<p>PARKING STALL</p>	<p>610154F PLAT C1, 39</p>
--	------------------------------------	----------------------	--------------------------------

**ELLISON ONIZUKA KONA INTERNATIONAL AIRPORT AT KEAHOLE**

N:\AIRPORTS\KOA\_Kona\CAD\PM\koa\_610154f-01.dwg