

STATE OF HAWAII
DEPARTMENT OF LAND AND NATURAL RESOURCES
Land Division
Honolulu, Hawaii 96813

June 24, 2022

Department of Land and Natural Resources
State of Hawaii
Honolulu, Hawaii

Ref No: EO 3461

Oahu

Issuance of Right-of-Entry Permit to the City and County of Honolulu for Homeless Outreach and Navigation for Unsheltered Persons Program Purposes ("HONU") on Land Set Aside the Department of Land and Natural Resources, Land Division, under Governor's Executive Order No. 3461; Kahauiki, Honolulu, Oahu, Tax Map Key: (1) 1-1-006:003.

APPLICANT:

City and County of Honolulu, Department of Community Services ("City").

LEGAL REFERENCE:

Section 171-55, Hawaii Revised Statutes ("HRS"), as amended.

LOCATION:

Government lands situated at Kahauiki, Honolulu, Oahu, Tax Map Key: (1) 1-1-006:003, as shown on the attached map labeled **Exhibit A**.

AREA:

58,800 square feet, more or less.

ZONING:

State Land Use District: Urban
City and County of Honolulu LUO: F-1

TRUST LAND STATUS:

Section 5(e) lands of the Hawaii Admission Act
DHHL 30% entitlement lands pursuant to the Hawaii State Constitution: No

CURRENT USE STATUS:

Encumbered by Governor's Executive Order No. 3461 to the Department of Land and Natural Resources, Land Division for storage area and maintenance yard purposes.

PROPOSED PURPOSE:

For Homeless Outreach and Navigation for Unsheltered Persons Program Purposes.

CHAPTER 343 ENVIRONMENTAL ASSESSMENT:

In accordance with Hawaii Administrative Rules ("HAR") § 11-200.1-15 and -16 and the Exemption List for the Department of Land and Natural Resources reviewed and concurred on by the Environmental Council on November 10, 2020, the subject request is exempt from the preparation of an environmental assessment pursuant to General Exemption Type 1, Part 1, that states, "Operations, repairs or maintenance of existing structures, facilities, equipment, or topographical features, involving negligible or no expansion or change of use beyond that previously existing," Item 44, that states the "Permits, licenses, registrations, and rights-of-entry issued by the Department that are routine in nature, involving negligible impacts beyond that previously existing". The subject request is a de minimis action that will probably have minimal or no significant effect on the environmental and should be declared exempt from the preparation of an environmental assessment and the requirements of § 11-200.1-17, HAR, as a de minimis action.

APPLICANT REQUIREMENTS:

None.

REMARKS:

The subject parcel was formerly used as an open storage area for various divisions of the department. In the summer of 2019, there was an effort for the State to establish homeless housing site projects, known as Kauhale, at various locations including the subject parcel. Discussions were conducted among various State and City agencies as well as non-profit entities and the homeless community. The department was amenable to transferring the parcel to another government agency to oversee the utilization of the subject parcel for any housing/homeless programs.

By its letter dated June 2, 2022 (**Exhibit B**), the City requested the issuance of a right-of-entry permit covering the period from July 1, 2022 to September 30, 2022 for the purpose of setting up a HONU site at the location.

The HONU program was established pursuant to the Governor's Proclamation dated December 14, 2018, as supplemented by other proclamations, the last of which is dated February 14, 2020. In recent years, the City rotated HONU programs among several locations on Oahu. In the following paragraphs, the City describes various components of

the HONU program:

HONU is a mobile facility that has the capacity to serve between 60-100 individuals at one location. The HONU is operated by the City & County of Honolulu Department of Community Services in partnership with the Honolulu Police Department. The goal of the program is to provide 24/7 short-term shelter services, and navigation to connect homeless individuals and families to longer-term shelter and other housing options. HONU also provides a critical tool for law enforcement officers to divert homeless individuals from citation and arrest and provide the option of short-term shelter and services.

Each HONU site includes beds and hygiene facilities, as well as the access to one meal per day. HONU also provides a space for social service partner organizations to provide on-site services, including assistance with identification, housing navigation, as well as legal and medical services.

In a study commissioned by the Governor's Coordinator on Homelessness, researcher Heather Henderson found that since opening December 14, 2019 through June 2021 when her report was released, the HONU has assisted more than 1,600 persons from being unsheltered, with 900 of them either reuniting with family or transitioning to shelter or treatment facilities.

This information is a point-in-time count of the effectiveness and impacts a HONU could provide in any given community on Oahu.

The goal of the City is to site an additional HONU starting in July in this vacant parcel during the period of July 1, 2022 to September 30, 2022 to continue to provide transitional space for unsheltered persons experiencing homelessness, while at the same time opening up the City parks to families and keiki to recreate during the summer prior to the start of the new school year.

HONU is one of a number of diversion programs initiated by the Honolulu Police Department to strengthen services for homeless individuals. The efforts of the Honolulu Police Department and other Hawaii law enforcement agencies to partner with homeless services was recently highlighted in a U.S. Interagency Council on Homeless and Council of State Governments joint policy brief on Strengthening Partnerships Between Law Enforcement and Homeless Services Systems.

Once HONU is completed in the September 2022 timeframe, the City and community will then look to resume HONU activities in appropriately sited park parcels. The City will assess the suitability of this site as to whether a more permanent "Kauhale" type communal managed mini home project could feasibly be situated at a later date on this property.

The Governor's Coordinator on Homelessness supports the request. The City has not had a lease, permit, easement or other disposition of State lands terminated within the past five

years due to non-compliance with such terms and conditions.

There are no other pertinent issues and concerns. Staff recommends the Board approve the request as listed in the Recommendation section.

RECOMMENDATION: That the Board:

1. Declare that, after considering the potential effects of the proposed disposition as provided by Chapter 343, HRS, and Chapter 11-200.1-15 and -16, HAR, this project will probably have minimal or no significant effect on the environment and is therefore exempt from the preparation of an environmental assessment as a de minimis action.
2. Authorize the issuance of a right-of-entry permit to the City and County of Honolulu covering the subject area for the Homeless Outreach and Navigation for Unsheltered Persons Program Purposes under the terms and conditions cited above, which are by this reference incorporated herein and further subject to the following:
 - A. The standard terms and conditions of the most current right-of-entry permit form, as may be amended from time to time; and
 - B. Such other terms and conditions as may be prescribed by the Chairperson to best serve the interests of the State.

Respectfully Submitted,

Barry Cheung

Barry Cheung
District Land Agent

APPROVED FOR SUBMITTAL:

Suzanne D. Case

Suzanne D. Case, Chairperson

KCM

RT

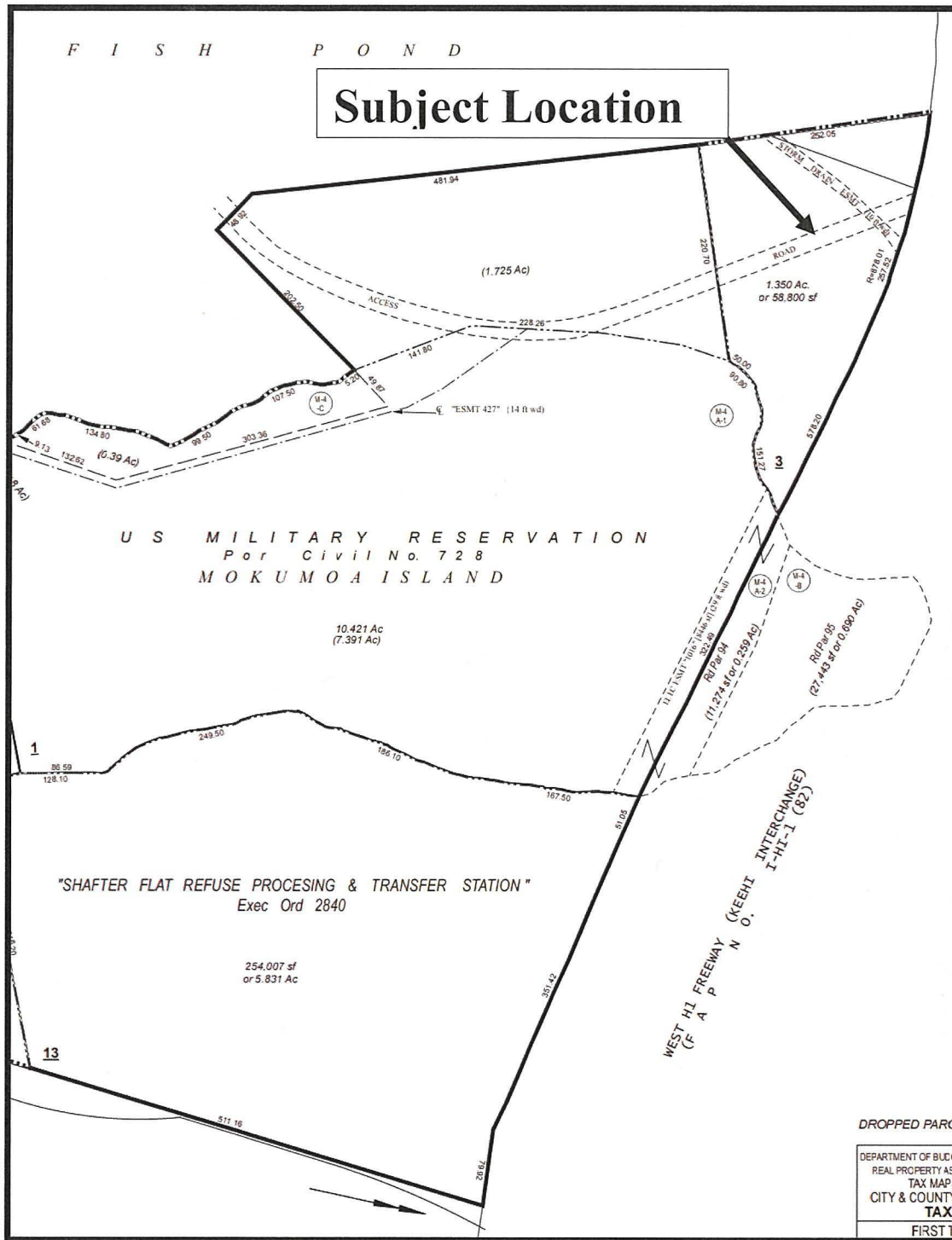

TMK (1) 1-1-006:003

EXHIBIT A

DEPARTMENT OF COMMUNITY SERVICES
CITY AND COUNTY OF HONOLULU
925 DILLINGHAM BOULEVARD, SUITE 200 * HONOLULU, HAWAII 96817
PHONE: (808) 768-7762 * FAX: (808) 768-7792
www.honolulu.gov/dcs

RICK BLANGIARDI
MAYOR



ANTON C. KRUCKY
DIRECTOR

AEDWARD LOS BANOS
DEPUTY DIRECTOR

June 3, 2022

Ms. Suzanne D. Case, Chairperson
Board of Land and Natural Resources
State of Hawaii
P.O. Box 621
Honolulu, Hawaii 96809

RECEIVED
LAND DIVISION
2022 JUN -6 AM 11:14
ANTON C. KRUCKY
DIRECTOR

Dear Ms. Case:

SUBJECT: Issuance of a Right-of-Entry to the City and County of Honolulu to Open and Operate a Homeless Outreach and Navigation for Unsheltered Persons (HONU) Center in a portion of the Department of Land and Natural Resources remnant parcel, 604 Middle Street, Honolulu, Hawaii, 96813 Tax Map Key No. (1) 1-1-006:003

The City and County of Honolulu ("City") respectfully requests approval by the Board of Land and Natural Resources (BLNR) of the above referenced request to allow the use of a remnant parcel of the Department of Land and Natural Resources be used in a temporary basis to site and operate a Homeless Outreach and Navigation for Unsheltered Persons facility for the period of July 1, 2022 through September 30, 2022.

The Homeless Outreach and Navigation for Unsheltered Persons (HONU) Project was established pursuant to the Governor's Proclamation dated December 14, 2018, as extended by his Supplementary Proclamation of February 12, 2019, his Second Supplementary Proclamation of April 12, 2019, his Third Supplementary Proclamation of June 7, 2019, his Fourth Supplementary Proclamation of August 6, 2019, his Fifth Supplementary Proclamation of August 23, 2019, his Sixth Supplementary Proclamation of October 21, 2019, and his Seventh Supplementary Proclamation of December 16, 2019, relating to the homeless emergency in the State of Hawaii (collectively, the "Proclamations").

We greatly appreciate BLNR's strong support of this, and other endeavors, to address homelessness on O'ahu, without which our combined efforts would not have garnered the success that we have had.

EXHIBIT B

Ms. Suzanne D. Case, Chairperson
Board of Land and Natural Resources
June 3, 2022
Page 2

The use of this temporary tent based program will allow the City to assess the suitability of this site as to whether a more permanent "kauhale" type communal managed mini home project could feasibly be situated at a later date on this property.

If it is determined to be suitable, following the exit of the HONU operations, the City will then proceed to contract for an Environmental Assessment for the use of the property for more permanent shelter structures, whether shipping container type like its existing Hale Mauiola operation, wooden mini-homes like the Kamaoku Kauhale operation in Kalaeloa, or pre-fab units like the igloo structures at The Shelter in Kaneohe or another suitable building material. The City will also engage community groups like Hui Aloha or others to help build operational and financial capacity to undertake such an operation on a longer term basis, or seek other partners. Once the environmental and organizational capacity components are addressed, the City will then come back to the Board to request a longer term property disposition such as a revocable permit or lease.

Thank you very much for your consideration of this request. We look forward to your reply and when we may be able to present this request to the BLNR.

Should you have any questions, please call me at (808) 768-7760 or email at anton.krucky@honolulu.gov.

Sincerely,

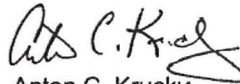

Anton C. Krucky
Director

Attachment:
Draft Board Action