

DAVID Y. IGE
GOVERNOR



STATE OF HAWAII
DEPARTMENT OF TRANSPORTATION
869 PUNCHBOWL STREET
HONOLULU, HAWAII 96813-5097

JADE T. BUTAY
DIRECTOR

Deputy Directors
ROSS M. HIGASHI
EDUARDO P. MANCLALLAN
EDWIN H. SNIFFEN

IN REPLY REFER TO:

Board of Land and
Natural Resources
State of Hawai'i
Honolulu, Hawai'i

ISSUANCE OF A REVOCABLE PERMIT FOR A TOUR SERVICE COUNTER
DH HAWAII TOUR INC.
DANIEL K. INOUE INTERNATIONAL AIRPORT
TAX MAP KEY: (1) 1-1-003: 195 (PORTION)

O'AHU

APPLICANT:

DH Hawaii Tour Inc. (DH Hawaii Tour), whose business address is 1750 Kalakaua Avenue, #204-C, Honolulu, Hawai'i 96826.

LEGAL REFERENCE:

Section 171-55, Hawai'i Revised Statutes.

LOCATION AND TAX MAP KEY:

Portion of Building 352, Ewa International Arrivals Building, Ground Level at Daniel K. Inouye International Airport (Airport), Island of O'ahu, State of Hawai'i, identified by Tax Map Key: 1st Division, 1-1-003: 195 (Portion).

AREA:

Bldg/Room No. 352-105F, containing an area of approximately 37 square feet, as shown and delineated on the attached map labeled Exhibit "A".

ZONING:

State Land Use District: Urban
City and County of Honolulu LUO: Industrial (I-2)

ITEM M-1

BLNR – ISSUANCE OF A REVOCABLE PERMIT FOR A TOUR SERVICE COUNTER
DH HAWAII TOUR INC.

Page 2

LAND TITLE STATUS:

Non-Ceded - Section 5(a) lands of the Hawai'i Admission Act
DHHL 30% entitlement lands pursuant to Hawai'i Admission Act YES ___ NO X

CURRENT USE STATUS:

Land presently encumbered by Governor's Executive Order No. 3201, dated June 8, 1983, setting aside 3,152.177 acres designated as the Airport under the control and management of the State of Hawai'i, Department of Transportation, Airports Division (DOTA) for Airport Purposes.

CHARACTER OF USE:

DH Hawaii Tour will use the space as a tour service counter to greet and direct customers to the tour group loading zone.

COMMENCEMENT DATE:

Upon execution of the revocable permit.

MONTHLY RENTAL:

\$360.75 (as determined from the DOTA schedule of rates and charges established by appraisal of Airports property statewide plus \$9.25 for electricity).

SECURITY DEPOSIT:

\$1,082.25, or three times the monthly rental in effect.

DCCA VERIFICATION:

Place of business registration confirmed:	YES <u>X</u>	NO ___
Registered business name confirmed:	YES <u>X</u>	NO ___
Good standing confirmed:	YES <u>X</u>	NO ___

CHAPTER 343, HRS - ENVIRONMENTAL ASSESSMENT:

The environmental impacts of the proposed action to the subject land area are covered by the Honolulu International airport Master Plan Update and Noise Compatibility Program Environmental Assessment (EA), State Project No. AO1011-033. The EA is a joint State and Federal document, dated September 1989 and published in the October 23, 1989 issue of the OEQC Bulletin. Accordingly, relevant mitigation from the EA and DOTA environmental best management practice will address minimal impacts from this action.

BLNR – ISSUANCE OF A REVOCABLE PERMIT FOR A TOUR SERVICE COUNTER
DH HAWAII TOUR INC.

Page 3

REMARKS:

In accordance with Section 171-55 HRS, relating to Permits, the Department of Transportation proposes to issue a month-to-month revocable permit to DH Hawaii Tour for a tour service counter to greet and direct customers to the tour group loading zone at Daniel K. Inouye International Airport.

RECOMMENDATION:

That the Board authorize the Department of Transportation to issue a month-to-month revocable permit to DH Hawaii Tour, subject to: (1) terms and conditions herein outlined, which are by reference incorporated herein; and (2) such additional terms and conditions as may be prescribed by the Director of Transportation to best serve the interests of the State.

Respectfully submitted,



JADE T. BUTAY
Director of Transportation

APPROVED FOR SUBMITTAL:

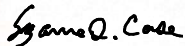

SUZANNE D. CASE
Chairperson and Member

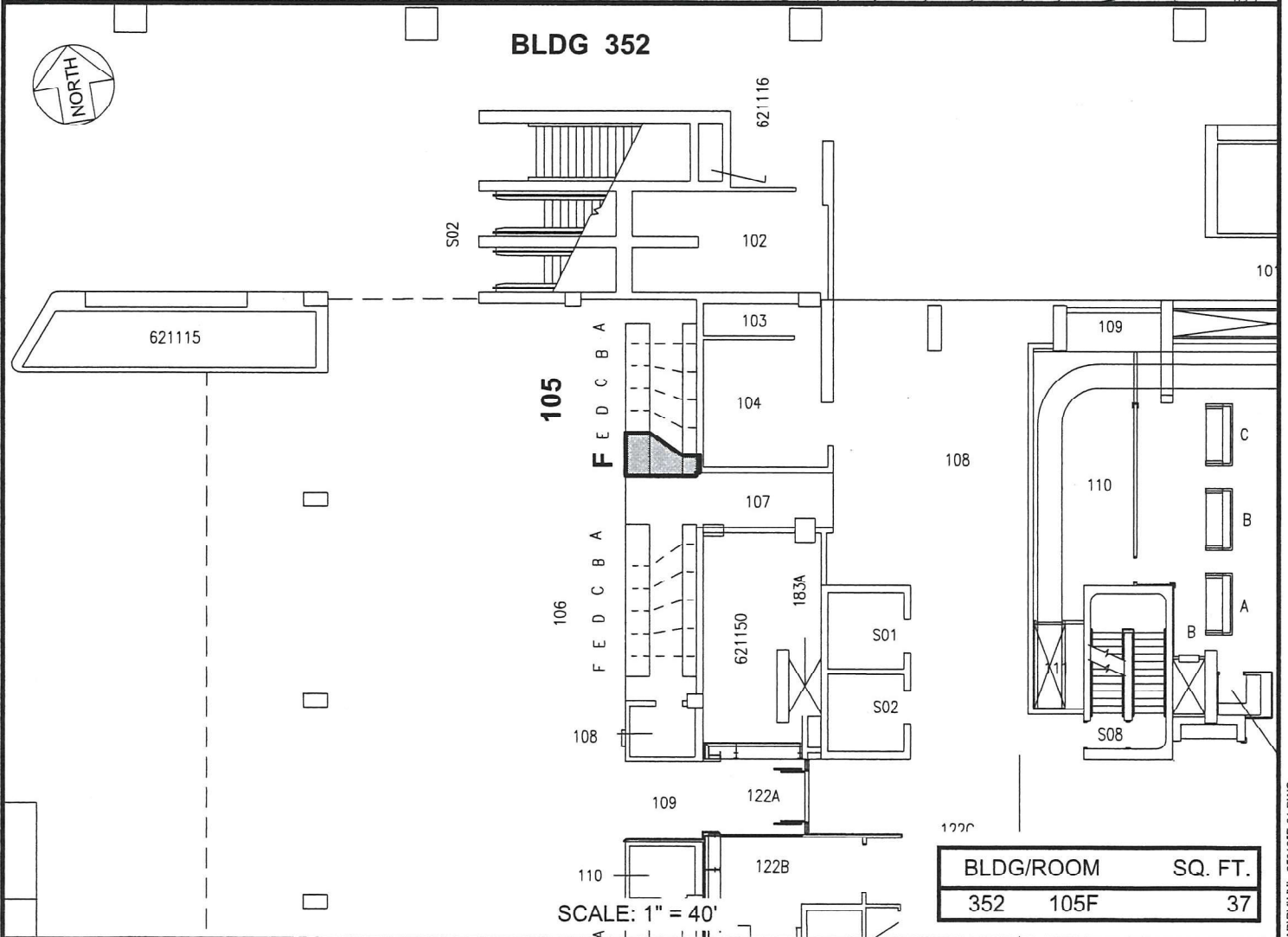
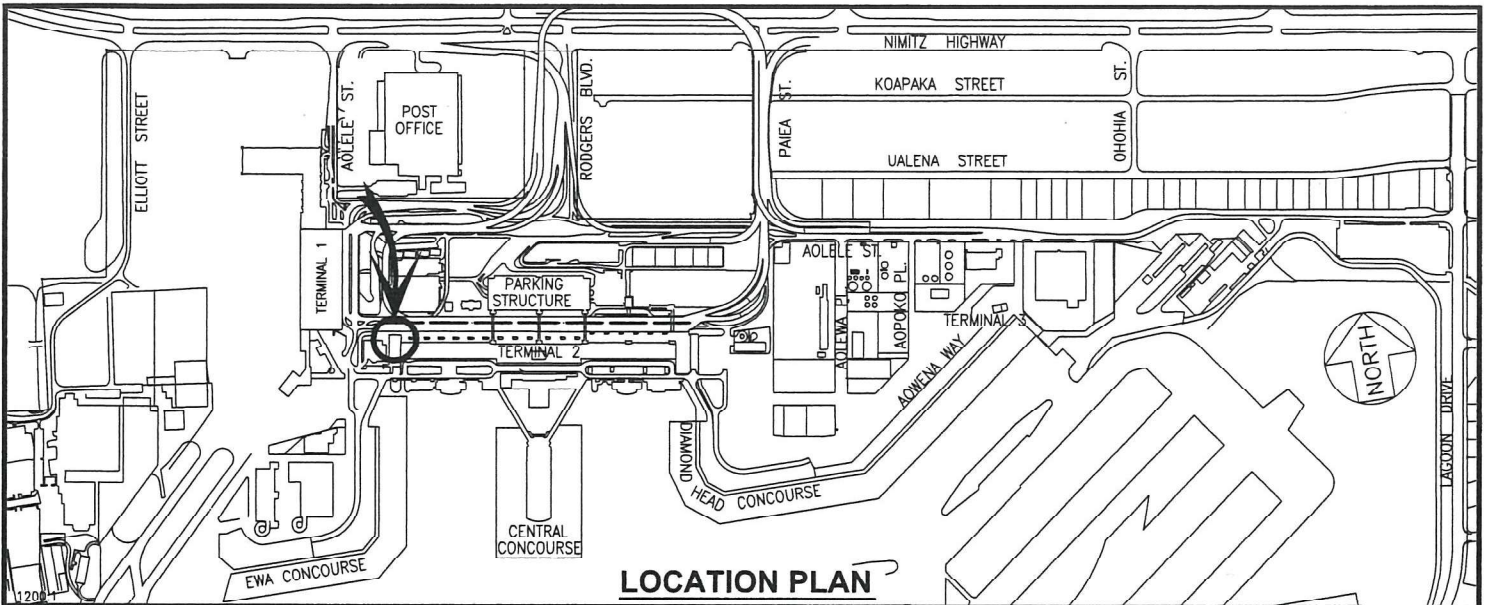

RP-9259

DATE : MAY 2022

EXHIBIT: **A**



Airports Division

DH HAWAII TOUR, INC.

**BUILDING 352
EWA INT'L ARRIVALS
GROUND LEVEL**

**352105F
PLAT A1,25**

DANIEL K. INOUE INTERNATIONAL AIRPORT