

DAVID Y. IGE
GOVERNOR



JADE T. BUTAY
DIRECTOR

Deputy Directors
ROSS M. HIGASHI
EDUARDO P. MANGLALLAN
EDWIN H. SNIFFEN

IN REPLY REFER TO:

STATE OF HAWAII
DEPARTMENT OF TRANSPORTATION
869 PUNCHBOWL STREET
HONOLULU, HAWAII 96813-5097

Board of Land and
Natural Resources
State of Hawai'i
Honolulu, Hawai'i

ISSUANCE OF A REVOCABLE PERMIT FOR A CARGO WAREHOUSE,
OFFICES AND PARKING FOR THE PROVISIONING FUNCTIONS OF ITS
AIRLINE OPERATIONS
SOUTHWEST AIRLINES CO.
DANIEL K. INOUYE INTERNATIONAL AIRPORT
TAX MAP KEY: (1) 1-1-003: 085 (PORTION)

O'AHU

APPLICANT:

Southwest Airlines Co. (Southwest Airlines), whose business address is 2702 Love Field Drive, Dallas, Texas 75235.

LEGAL REFERENCE:

Section 171-55, Hawai'i Revised Statutes.

LOCATION AND TAX MAP KEY:

Portions of Building 152, Ewa Concourse, Ground Level at Daniel K. Inouye International Airport (Airport), Island of O'ahu, State of Hawai'i, identified by Tax Map Key: 1st Division, 1-1-003: 085 (Portion).

AREA:

Bldg/Room No. 152-101, containing an area of approximately 638 square feet;
Bldg/Room No. 152-102, containing an area of approximately 1,973 square feet;
Bldg/Room No. 152-103, containing an area of approximately 766 square feet;
Bldg/Room No. 152-104A, containing an area of approximately 14,826 square feet;
Bldg/Room No. 152-104B, containing an area of approximately 940 square feet;
Area/Space No. 004-106B, containing an area of approximately 5,386 square feet;
Area/Space No. 611-113A-F, each containing an area of approximately 190 square feet;
Area/Space No. 611-113G-M, each containing an area of approximately 420 square feet; and
Area/Space No. 641-126, containing an area of approximately 821 square feet,
as shown and delineated on the attached map labeled Exhibit "A".

ITEM M-3

BLNR – ISSUANCE OF A REVOCABLE PERMIT FOR A CARGO WAREHOUSE,
OFFICES AND PARKING FOR THE PROVISIONING FUNCTIONS OF ITS AIRLINE
OPERATIONS, SOUTHWEST AIRLINES CO.

Page 2

Area/Space No. 611-114E-P, each containing an area of approximately 162 square feet;
Area/Space No. 611-116A-T, each containing an area of approximately 162 square feet;
Area/Space No. 611-116Y-Z, each containing an area of approximately 162 square feet;
Area/Space No. 611-117A-F, each containing an area of approximately 162 square feet; and
as shown and delineated on the attached map labeled Exhibit “B”.

ZONING:

State Land Use District: Urban
City and County of Honolulu LUO: Industrial (I-2)

LAND TITLE STATUS:

Non-Ceded - Section 5(a) lands of the Hawai‘i Admission Act
DHHL 30% entitlement lands pursuant to Hawai‘i Admission Act YES ___ NO X

CURRENT USE STATUS:

Land presently encumbered by Governor’s Executive Order No. 3201, dated June 8,
1983, setting aside 3,152.177 acres designated as the Airport under the control and
management of the State of Hawai‘i, Department of Transportation, Airports Division
(DOTA) for Airport Purposes.

CHARACTER OF USE:

Southwest Airlines will use the space for a cargo warehouse, offices and parking for the
provisioning functions of its airline operations at the Airport.

COMMENCEMENT DATE:

Upon execution of the revocable permit.

MONTHLY RENTAL:

\$37,743.62 (as determined from the DOTA schedule of rates and charges, established by
appraisal of Airports property statewide).

SECURITY DEPOSIT:

\$113,230.86, or three (3) times the monthly rental in effect.

BLNR – ISSUANCE OF A REVOCABLE PERMIT FOR A CARGO WAREHOUSE,
OFFICES AND PARKING FOR THE PROVISIONING FUNCTIONS OF ITS AIRLINE
OPERATIONS, SOUTHWEST AIRLINES CO.

Page 3

DCCA VERIFICATION:

Place of business registration confirmed:	YES <u>X</u>	NO _____
Registered business name confirmed:	YES <u>X</u>	NO _____
Good standing confirmed:	YES <u>X</u>	NO _____

CHAPTER 343, HRS - ENVIRONMENTAL ASSESSMENT:

The environmental impacts of the proposed action to the subject land area are covered by the Honolulu International airport Master Plan Update and Noise Compatibility Program Environmental Assessment (EA), State Project No. AO1011-033. The EA is a joint State and Federal document, dated September 1989 and published in the October 23, 1989 issue of the OEQC Bulletin. Accordingly, relevant mitigation from the EA and DOTA environmental best management practice will address minimal impacts from this action.

REMARKS:

In accordance with Section 171-55 HRS, relating to Permits, the Department of Transportation proposes to issue a month-to-month revocable permit to Southwest Airlines for a cargo warehouse, offices and parking for the provisioning functions of its airline operations at the Airport. Southwest Airlines is a signatory airline carrier with airline operations located mainly within the Overseas Terminal.

RECOMMENDATION:

That the Board authorize the Department of Transportation to issue a month-to-month revocable permit to Southwest Airlines, subject to: (1) terms and conditions herein outlined, which are by reference incorporated herein; and (2) such additional terms and conditions as may be prescribed by the Director of Transportation to best serve the interests of the State.

Respectfully submitted,

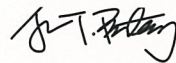

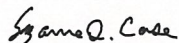

JADE T. BUTAY
Director of Transportation

APPROVED FOR SUBMITTAL:

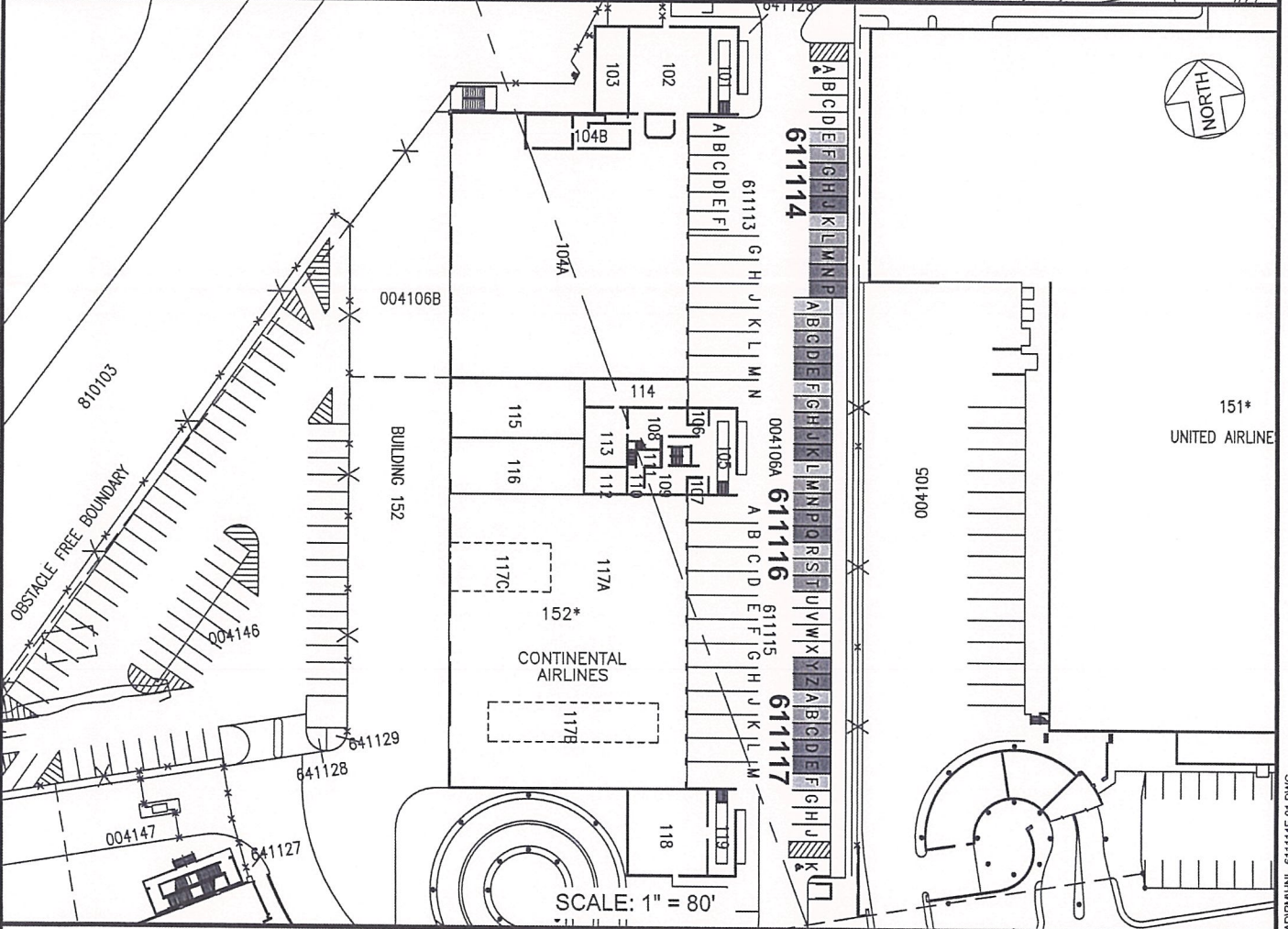
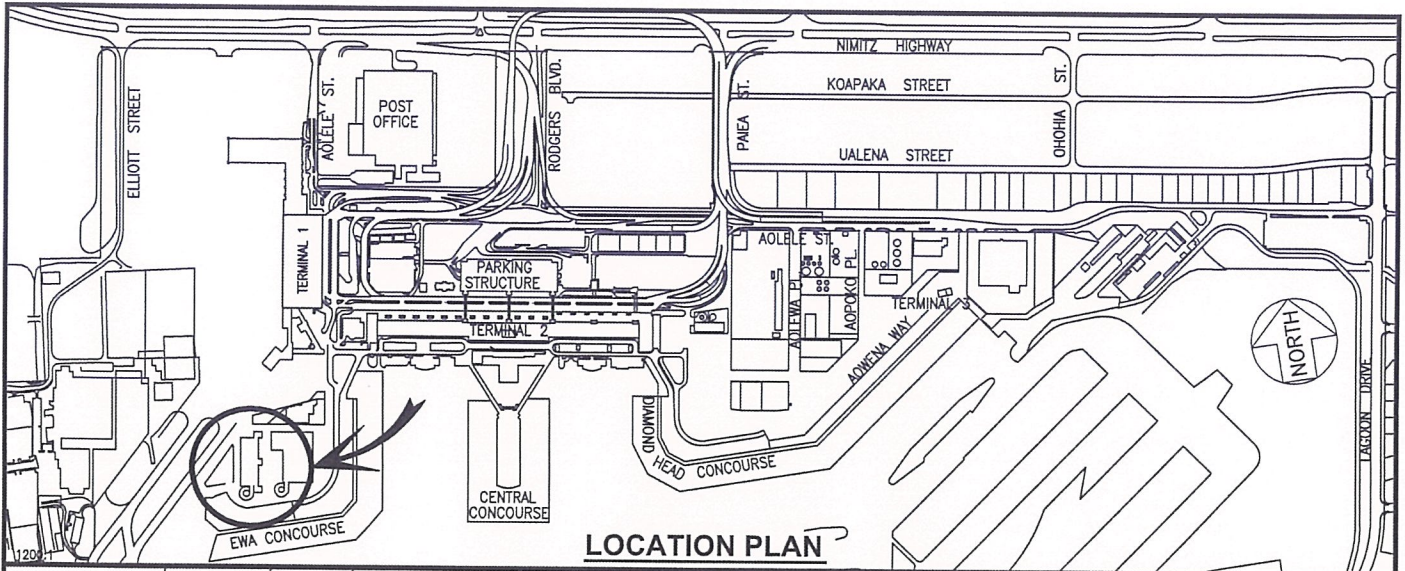

SUZANNE D. CASE
Chairperson and Member



RP-9227	DATE: MAY 2022	EXHIBIT: B
 Airports Division	SOUTHWEST AIRLINES CO.	PARKING STALLS EWA CONCOURSE GROUND LEVEL
		611114E-P 611116A-T 611116Y-Z 611117A-F PLAT F1,24

DANIEL K. INOUE INTERNATIONAL AIRPORT