



STATE OF HAWAII
DEPARTMENT OF TRANSPORTATION
869 PUNCHBOWL STREET
HONOLULU, HAWAII 96813-5097

JADE T. BUTAY
DIRECTOR

Deputy Directors
ROSS M. HIGASHI
EDUARDO P. MANGLALLAN
EDWIN H. SNIFFEN

IN REPLY REFER TO:

Board of Land and
Natural Resources
State of Hawai'i
Honolulu, Hawai'i

ISSUANCE OF A REVOCABLE PERMIT FOR TWO AIRCRAFT PARKING
KAMAKA AIR LLC
DANIEL K. INOUE INTERNATIONAL AIRPORT O'AHU
TAX MAP KEY: (1) 1-1-76: PORTION OF 23

REQUEST:

Issuance of a Revocable Permit for Aircraft Parking (Parking Permit) to Kamaka Air LLC, situated at Daniel K. Inouye International Airport.

LEGAL REFERENCE:

Section 171-55, Hawai'i Revised Statutes.

APPLICANT:

Kamaka Air LLC, whose mailing address is 144 Palekona Street, Honolulu, Hawai'i 96819.

LOCATION:

A portion of Daniel K. Inouye International Airport, South Ramp, identified by Tax Map Key: 1st Division, 1-1-76: portion of 23.

AREA:

Area/Space Nos. 423-185B and 423-185C, containing an area of approximately 2,413 square feet and 2,412 square feet, as shown and delineated on the attached map labeled Exhibit A.

ZONING:

State Land Use District: Urban
City and County of Honolulu LUO: Industrial (I-2)

ITEM M-3

BLNR – ISSUANCE OF A REVOCABLE PERMIT FOR TWO AIRCRAFT PARKING,
KAMAKA AIR LLC
PAGE 2

LAND TITLE STATUS:

Non-ceded - Section 5(a) lands of the Hawai'i Admission Act
DHHL 30% entitlement lands pursuant to Hawai'i Admission Act YES ___ NO X

CURRENT USE STATUS:

Land presently encumbered by Governor's Executive Order No. 3201, dated June 8, 1983, setting aside 3,152.177 acres designated as Daniel K. Inouye International Airport under the control and management of the State of Hawai'i, Department of Transportation, Airports Division (DOTA) for Airport Purposes.

CHARACTER OF USE:

Two Aircraft Tie-downs (2008 Cessna 208B, Tail No. N-8CA and 2008 Cessna Caravan, Tail No. N-145KA).

COMMENCEMENT DATE:

To be determined by the Director of Transportation at a later date.

MONTHLY RENTAL:

\$352.00 (as determined from the DOTA schedule of rates and charges established by appraisal of Airports property statewide).

SECURITY DEPOSIT:

\$1,056.00, or three (3) times the monthly rental in effect

CHAPTER 343, HRS - ENVIRONMENTAL ASSESSMENT:

The environmental impacts of the proposed action to the subject land area are covered by the Honolulu International Airport Master Plan Update and Noise Compatibility Program Environmental Assessment (EA), State Project No. AO1011-03. The EA is a joint State and Federal document, dated September 1989 and published in the October 23, 1989, issue of the OEQC Bulletin. Accordingly, relevant mitigation from the EA and DOT-A environmental best management practice will address minimal impacts from this action.

BLNR – ISSUANCE OF A REVOCABLE PERMIT FOR TWO AIRCRAFT PARKING,
KAMAKA AIR LLC
PAGE 3

REMARKS:

The issuance of a Parking Permit to Kamaka Air LLC for two aircraft parking at Daniel K. Inouye International Airport complies with Chapter 343, Exemption Class 1.D.10 as a continuing aeronautical use, and is in accordance with Section 171-55 HRS, relating to Permits.

RECOMMENDATION:

That the Board authorize the Department of Transportation to issue a month-to-month Parking Permit to Kamaka Air LLC, subject to: (1) terms and conditions herein outlined, which are by reference incorporated herein, and (2) such additional terms and conditions as may be prescribed by the Director of Transportation to best serve the interests of the State.

Respectfully submitted,



JADE T. BUTAY
Director of Transportation

APPROVED FOR SUBMITTAL:

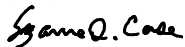

SUZANNE D. CASE
Chairperson and Member

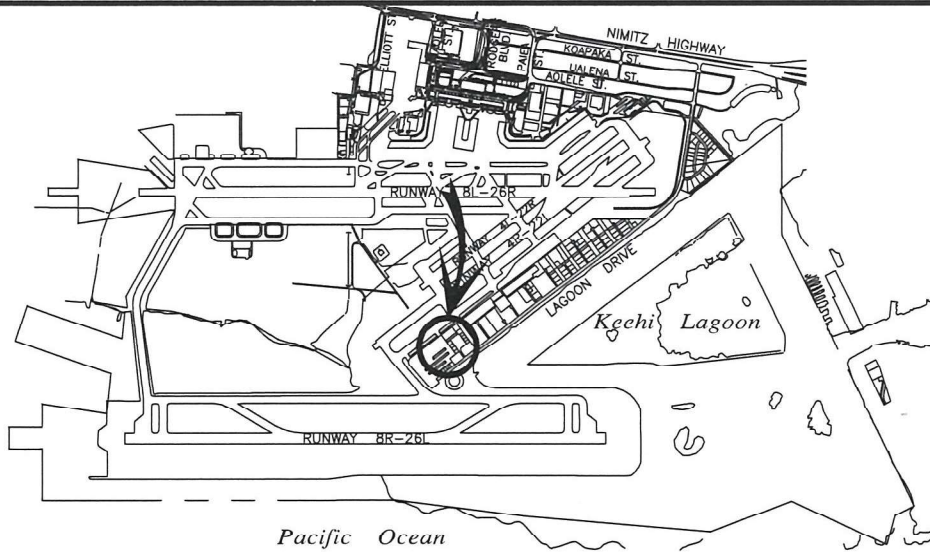

LOCATION PLAN

5000:1



TAXIWAY "C"
508101

810141

TAXIWAY

185L 185K 185J 185H 185G 185F 185E 185D **185C 185B** 185A

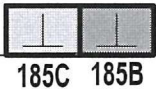

167 168 169 170 171 172 173 174 175 176 177 178 179 180 181
6 155 154 153 152 151 150 149 148 147 146 145 144 143 142 141
423-000

126 127 128 129 130 131 132 133 134 135 136 137 138 139 140
6 115 114 113 112 111 110 109 108 107 106 105 104 103 102 101
423-000

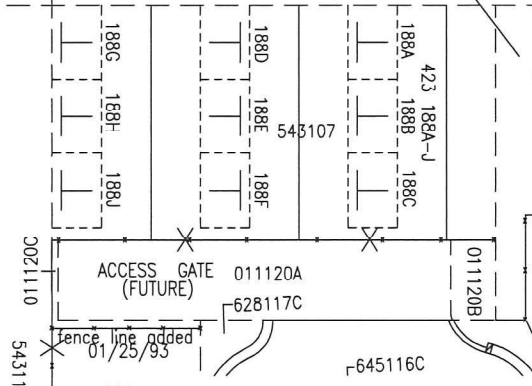
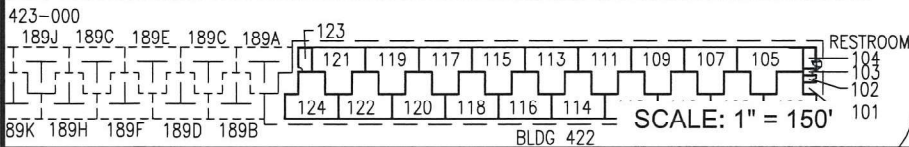

AREA/SPACE	SQ. FT.
423 185B	2,413
423 185C	2,412

PP-22-0004

DATE : MAY 2022

EXHIBIT: **A**



Airports Division

KAMAKA AIR, LLC

TIE-DOWNS

423185B-C
PLAT 45

DANIEL K. INOUE INTERNATIONAL AIRPORT