

DAVID Y. IGE
GOVERNOR



STATE OF HAWAII
DEPARTMENT OF TRANSPORTATION
869 PUNCHBOWL STREET
HONOLULU, HAWAII 96813-5097

JADE T. BUTAY
DIRECTOR

Deputy Directors
ROSS M. HIGASHI
EDUARDO P. MANGLALLAN
EDWIN H. SNIFFEN

IN REPLY REFER TO:

Board of Land and
Natural Resources
State of Hawai'i
Honolulu, Hawai'i

ISSUANCE OF A REVOCABLE PERMIT FOR STORAGE OF
TOOLS AND EQUIPMENT FOR AIRLINE CARRIER OPERATIONS
SOUTHERN AIRWAYS EXPRESS, LLC
DANIEL K. INOUE INTERNATIONAL AIRPORT
TAX MAP KEY: (1) 1-1-003: 001 (PORTION)

O'AHU

APPLICANT:

Southern Airways Express, LLC, whose business address is 2875 South Ocean Boulevard,
Palm Beach, Florida 33480.

LEGAL REFERENCE:

Section 171-55, Hawai'i Revised Statutes.

LOCATION AND TAX MAP KEY:

Overseas Maintenance Area, Daniel K. Inouye International Airport (Airport), Island of
O'ahu, State of Hawai'i, identified by Tax Map Key: 1st Division, 1-1-003: 001 (Portion).

AREA:

Area/Space No. 001-155, containing an area of approximately 800 square feet, as shown
and delineated on the attached map labeled Exhibit "A".

ZONING:

State Land Use District: Urban
City and County of Honolulu LUO: Industrial (I-2)

ITEM M-4

BLNR – ISSUANCE OF A REVOCABLE PERMIT FOR STORAGE OF TOOLS AND EQUIPMENT FOR AIRLINE CARRIER OPERATIONS
SOUTHERN AIRWAYS EXPRESS, LLC
Page 2

LAND TITLE STATUS:

Non-Ceded - Section 5(b) lands of the Hawai'i Admission Act
DHHL 30% entitlement lands pursuant to Hawai'i Admission Act YES ___ NO X

CURRENT USE STATUS:

Land presently encumbered by Governor's Executive Order No. 3201, dated June 8, 1983, setting aside 3,152.177 acres designated as the Airport under the control and management of the State of Hawai'i, Department of Transportation, Airports Division (DOTA) for Airport Purposes.

CHARACTER OF USE:

Southern Airways Express, LLC will use the space to stage two connex containers for the storage of tools and equipment for their maintenance department, in support of commercial airline carrier operations at the Airport.

COMMENCEMENT DATE:

Upon execution of the revocable permit.

MONTHLY RENTAL:

\$413.33 (as determined from the DOTA schedule of rates and charges established by appraisal of Airport property statewide).

SECURITY DEPOSIT:

\$1240.00, or three (3) times the monthly rental in effect.

DCCA VERIFICATION:

Place of business registration confirmed:	YES <u>X</u>	NO ___
Registered business name confirmed:	YES <u>X</u>	NO ___
Good standing confirmed:	YES <u>X</u>	NO ___

CHAPTER 343, HRS - ENVIRONMENTAL ASSESSMENT:

The environmental impacts of the proposed action to the subject land area are covered by the Honolulu International Airport Master Plan Update and Noise Compatibility Program Environmental Assessment (EA), State Project No. AO1011-033. The EA is a joint State

BLNR – ISSUANCE OF A REVOCABLE PERMIT FOR STORAGE OF TOOLS AND
EQUIPMENT FOR AIRLINE CARRIER OPERATIONS
SOUTHERN AIRWAYS EXPRESS, LLC
Page 3

and Federal document, dated September 1989 and published in the October 23, 1989, issue of the OEQC Bulletin. Accordingly, relevant mitigation from the EA and DOT-A environmental best management practice will address minimal impacts from this action.

REMARKS:

In accordance with Section 171-55 HRS, relating to Permits, the Department of Transportation proposes to issue a month-to-month revocable permit to Southern Airways Express, LLC, for space to stage two connex containers for the storage of tools and equipment for commercial airline carrier operations at the Airport.

RECOMMENDATION:

That the Board authorize the Department of Transportation to issue a month-to-month revocable permit to Southern Airways Express, LLC, subject to: (1) terms and conditions herein outlined, which are by reference incorporated herein; and (2) such additional terms and conditions as may be prescribed by the Director of Transportation to best serve the interests of the State.

Respectfully submitted,



JADE T. BUTAY
Director of Transportation

APPROVED FOR SUBMITTAL:

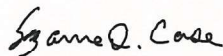

SUZANNE D. CASE
Chairperson and Member

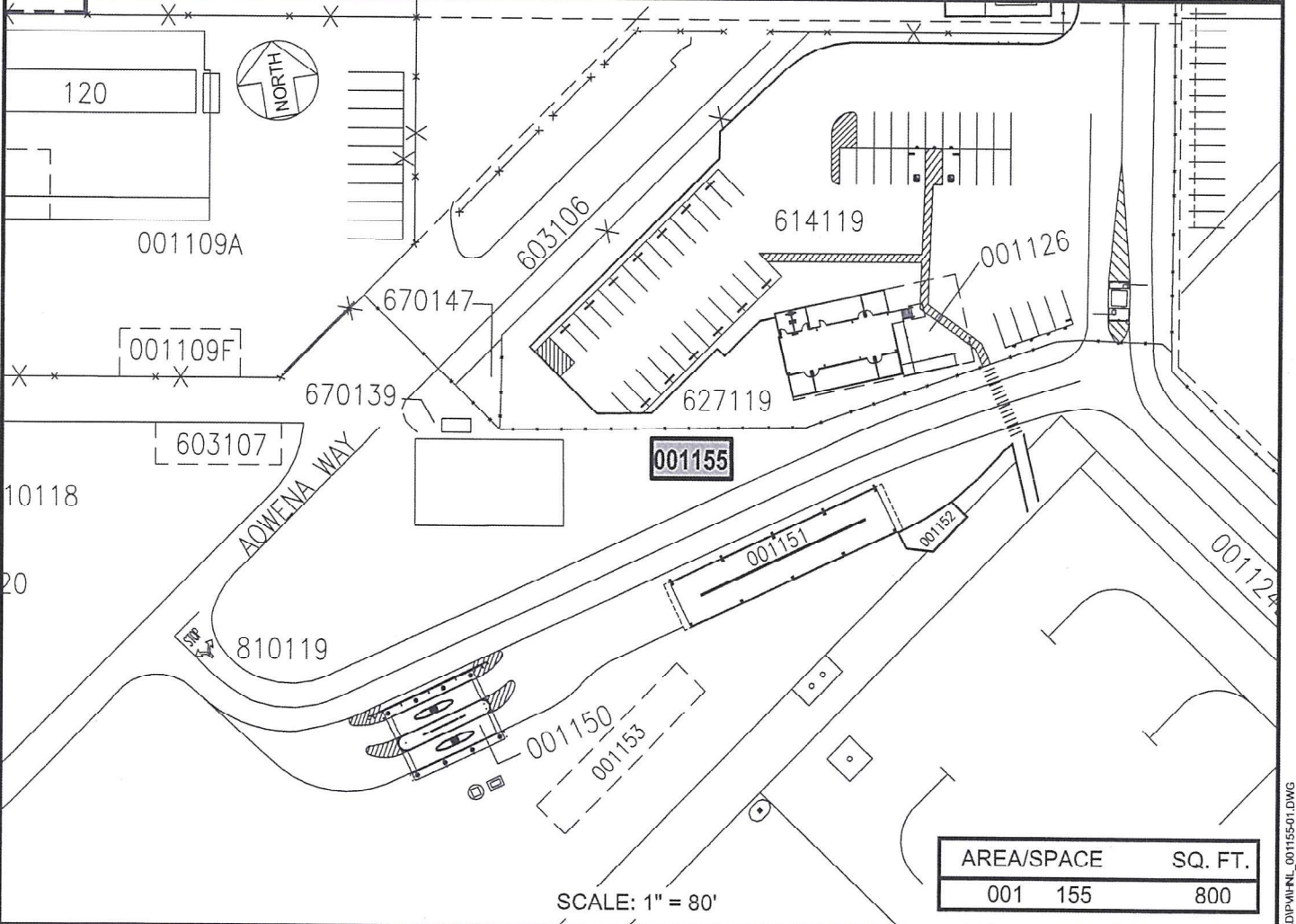
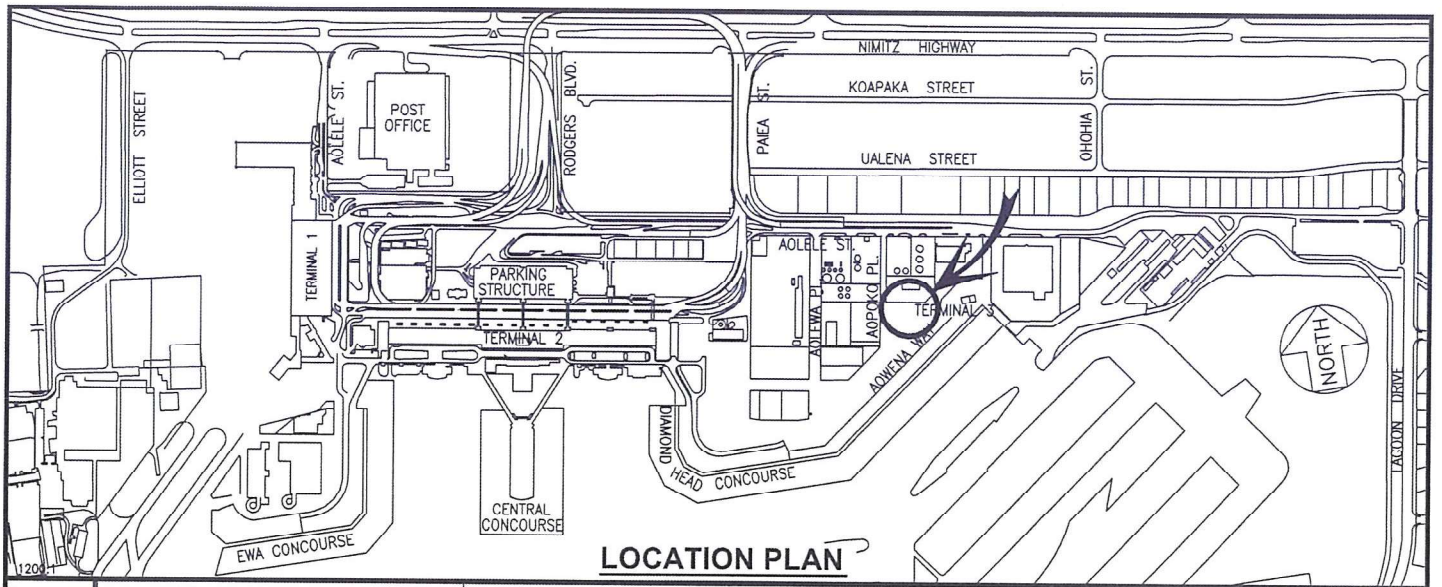

AREA/SPACE	SQ. FT.
001 155	800

SCALE: 1" = 80'

DATE : MAY 2022

EXHIBIT: **A**

DEPARTMENT OF TRANSPORTATION
STATE OF HAWAII
Airports Division

SOUTHERN AIRWAYS
EXPRESS, LLC DBA
MOKULELE AIRLINES

OVERSEAS
MAINTENANCE AREA

001155
PLAT 26

DANIEL K. INOUE INTERNATIONAL AIRPORT

N:\AIRPORT\SHLN_HONOLULUCAD\PI\PHL_001155-01.DWG