

DAVID Y. IGE
GOVERNOR



STATE OF HAWAII
DEPARTMENT OF TRANSPORTATION
869 PUNCHBOWL STREET
HONOLULU, HAWAII 96813-5097

JADE T. BUTAY
DIRECTOR

Deputy Directors
ROSS M. HIGASHI
EDUARDO P. MANGLALLAN
EDWIN H. SNIFFEN

IN REPLY REFER TO:

Board of Land and
Natural Resources
State of Hawai'i
Honolulu, Hawai'i

ISSUANCE OF A REVOCABLE PERMIT FOR A T-HANGAR FOR
STORAGE AND MAINTENANCE OF A PRIVATE AIRCRAFT
JAMES V. PARRAN
ELLISON ONIZUKA KONA INTERNATIONAL AIRPORT AT KEĀHOLE
TAX MAP KEY: (3) 7-3-43: PORTION OF 03 HAWAI'I

LEGAL REFERENCE:

Section 171-55, Hawai'i Revised Statutes (HRS).

APPLICANT:

James V. Parran, whose mailing address is 68-1025 N Kaniku Drive #411,
Kamuela, Hawai'i 96743.

LOCATION AND TAX MAP KEY:

Portion of Ellison Onizuka Kona International Airport at Keāhole (KOA), Kailua-Kona,
Island of Hawai'i, identified by Tax Map Key: 3rd Division, 7-3-43: Portion of 03.

AREA:

Building/Room No. 421-110, containing an area of approximately 1,464 square feet,
as shown and delineated on the attached Exhibit A.

ZONING:

State Land Use District:	Urban & Conservation
County of Hawai'i:	Industrial (MG-1a) and Open

ITEM M-5

BLNR – ISSUANCE OF A REVOCABLE PERMIT FOR A T-HANGAR FOR
STORAGE AND MAINTENANCE OF A PRIVATE AIRCRAFT

JAMES V. PARRAN

Page 2

LAND TITLE STATUS:

Section 5(a) lands of the Hawai‘i Admission Act: Ceded

DHHL 30% entitlement lands pursuant to Hawai‘i Admission Act YES ___ NO X

CURRENT USE STATUS:

Land presently encumbered by Governor’s Executive Order No. 3074, dated August 20, 1981, setting aside 4,204.10 acres designated as KOA under the control and management of the State of Hawai‘i, Department of Transportation, Airports Division for Airport Purposes.

CHARACTER OF USE:

T-Hangar for the storage and maintenance of a private aircraft (1970 American AA-1, Tail No. N-6109L)

COMMENCEMENT DATE:

Upon complete execution of the revocable permit.

MONTHLY RENTAL:

\$778.00 (as determined from the Appraisal Report for the Estimate of Annual, Fair Market Lease Rental Values of T-Hangars and Sprung Structures, Ellison Onizuka Kona International Airport at Keāhole, prepared by ACM Consultants, Inc., dated 3/15/21).

SECURITY DEPOSIT:

\$2,334.00, or three (3) times the monthly rental in effect.

CHAPTER 343, HRS - ENVIRONMENTAL ASSESSMENT:

The State of Hawai‘i, Department of Transportation, Airports Division, has determined the subject land areas are covered by the Final Environmental Assessment (EA)/Finding of No Significant Impact (FONSI), Airfield, Terminal, and Facility Improvements for the Kona International Airport at Keāhole, published by the Office of Environmental Quality Control (OEQC) in the March 23, 2013, issue of The Environmental Notice.

Accordingly, all relevant mitigation from the EA and best management practices will be implemented to address the minimum impacts of this action.

BLNR – ISSUANCE OF A REVOCABLE PERMIT FOR A T-HANGAR FOR
STORAGE AND MAINTENANCE OF A PRIVATE AIRCRAFT

JAMES V. PARRAN

Page 3

REMARKS:

In accordance with Section 171-55, HRS, relating to Permits, the Department of Transportation proposes to issue a month-to-month revocable permit to James V. Parran for a T-hangar for the storage and maintenance of a private aircraft at KOA.

RECOMMENDATION:

That the Board authorize the Department of Transportation to issue a month-to-month revocable permit to James V. Parran, subject to: (1) terms and conditions herein outlined, which are by reference incorporated herein; and (2) such additional terms and conditions as may be prescribed by the Director of Transportation to best serve the interests of the State.

Respectfully submitted,



JADE T. BUTAY
Director of Transportation

APPROVED FOR SUBMITTAL:

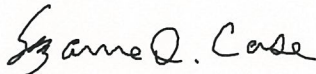

SUZANNE D. CASE
Chairperson and Member

Pacific Ocean

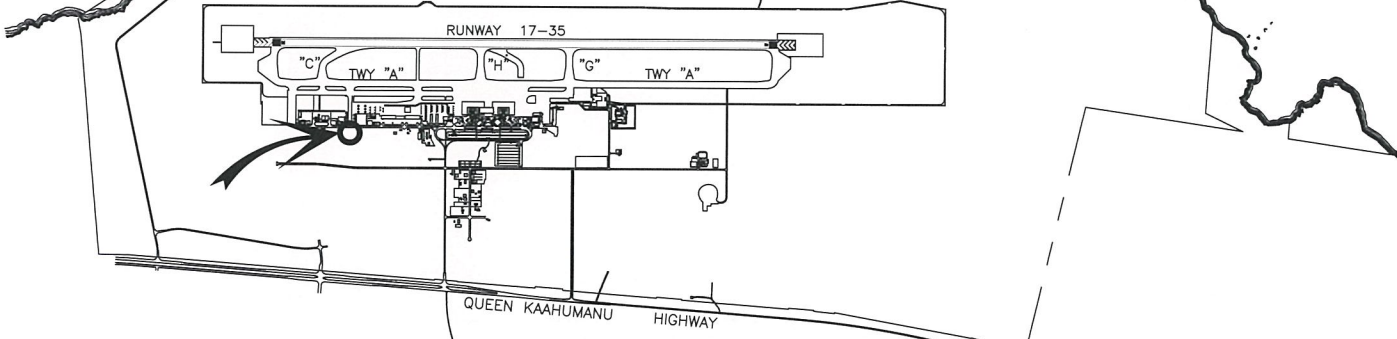

LOCATION PLAN

4000:1

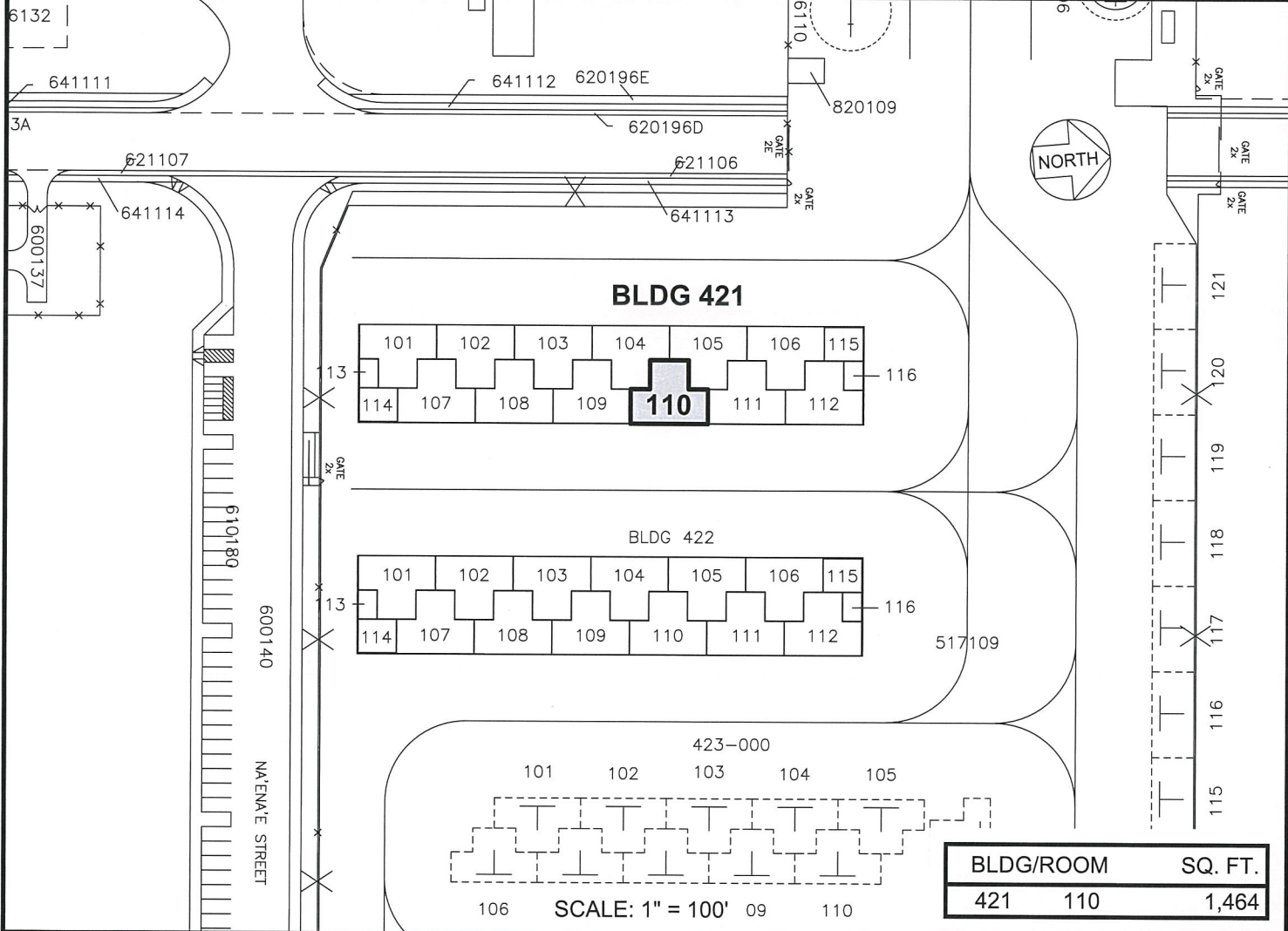

BLDG 421

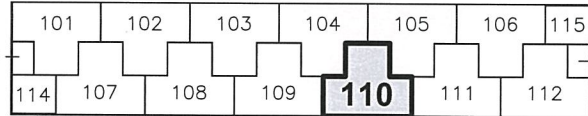

BLDG 422

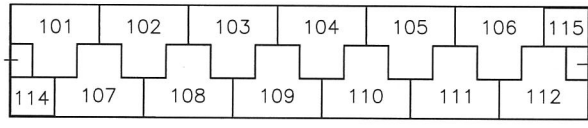

BLDG/ROOM	SQ. FT.
421 110	1,464

SCALE: 1" = 100'

RP-9262

DATE : MAY 2022

EXHIBIT: **A**



JAMES V. PARRAN

T-HANGAR

421110
PLAT 60

Adobe Acrobat Sign Transaction Number: CB1CHBCAABAACnKGUWXBISxioVieKflUEUJN_20kH1E