

DAVID Y. IGE  
GOVERNOR



STATE OF HAWAII  
DEPARTMENT OF TRANSPORTATION  
869 PUNCHBOWL STREET  
HONOLULU, HAWAII 96813-5097

JADE T. BUTAY  
DIRECTOR

Deputy Directors  
ROSS M. HIGASHI  
EDUARDO P. MANGLALLAN  
EDWIN H. SNIFFEN

IN REPLY REFER TO:

Board of Land and  
Natural Resources  
State of Hawai'i  
Honolulu, Hawai'i

ISSUANCE OF A REVOCABLE PERMIT FOR THE PURPOSE OF INSTALLING  
A NEW IRRIGATION SYSTEM, AND TO PROVIDE LANDSCAPING AND  
MAINTENANCE OF AIRPORT PREMISES  
AIPORT HOSPITALITY, LLC  
DANIEL K. INOUE INTERNATIONAL AIRPORT  
TAX MAP KEY: (1) 1-1-003: 001 (PORTION)

O'AHU

APPLICANT:

Airport Hospitality, LLC (Airport Hospitality), whose business address is 3375 Koapaka Street, Suite C-300, Honolulu, Hawai'i 96819.

LEGAL REFERENCE:

Section 171-55, Hawai'i Revised Statutes.

LOCATION AND TAX MAP KEY:

Portion of State Properties along Paiea Street and Aolele Street, Daniel K. Inouye International Airport (Airport), Island of O'ahu, State of Hawai'i, identified by Tax Map Key: 1<sup>st</sup> Division, 1-1-003: 001 (Portion).

AREA:

Area/Space No. 620-180, containing an area of approximately 12,832 square feet; and Area/Space No. 620-181, containing an area of approximately 486 square feet of improved, unpaved land, as shown and delineated on the attached map labeled Exhibit "A".

ZONING:

State Land Use District: Urban  
City and County of Honolulu LUO: Industrial (I-2)

**ITEM M-1**

BLNR – ISSUANCE OF A REVOCABLE PERMIT FOR THE PURPOSE OF INSTALLING A  
NEW IRRIGATION SYSTEM, AND TO PROVIDE LANDSCAPING AND MAINTENANCE  
TO AIRPORT PREMISES, AIRPORT HOSPITALITY, LLC

Page 2

LAND TITLE STATUS:

Non-Ceded - Section 5(a) lands of the Hawai'i Admission Act

DHHL 30% entitlement lands pursuant to Hawai'i Admission Act YES \_\_\_\_ NO X

CURRENT USE STATUS:

Land presently encumbered by Governor's Executive Order No. 3201, dated June 8, 1983, setting aside 3,152.177 acres designated as the Airport under the control and management of the State of Hawai'i, Department of Transportation, Airports Division (DOTA) for Airport Purposes.

CHARACTER OF USE:

Installation and maintenance of a new irrigation system; and to provide landscaping and maintenance of Airport premises.

COMMENCEMENT DATE:

Upon execution of the revocable permit.

MONTHLY RENTAL:

N/A

DCCA VERIFICATION:

Place of business registration confirmed:	YES <u>X</u>	NO ____
Registered business name confirmed:	YES <u>X</u>	NO ____
Good standing confirmed:	YES <u>X</u>	NO ____

CHAPTER 343, HRS - ENVIRONMENTAL ASSESSMENT:

The environmental impacts of the proposed action to the subject land area are covered by the Honolulu International airport Master Plan Update and Noise Compatibility Program Environmental Assessment (EA), State Project No. AO1011-033. The EA is a joint State and Federal document, dated September 1989 and published in the October 23, 1989, issue of the OEQC Bulletin. Accordingly, relevant mitigation from the EA and DOTA environmental best management practice will address minimal impacts from this action.

REMARKS:

In accordance with Section 171-55 HRS, relating to Permits, the Department of Transportation proposes to issue a month-to-month revocable permit to Airport Hospitality.

BLNR – ISSUANCE OF A REVOCABLE PERMIT FOR THE PURPOSE OF INSTALLING A  
NEW IRRIGATION SYSTEM, AND TO PROVIDE LANDSCAPING AND MAINTENANCE  
TO AIRPORT PREMISES, AIRPORT HOSPITALITY, LLC

Page 3

The DOTA is the owner of certain premises, and Airport Hospitality is the adjacent property owner. The DOTA and Airport Hospitality is in the process of entering into a Landscape Maintenance Agreement, where Airport Hospitality will install and maintain a new irrigation system, at its sole cost and expense. Upon completion of the installation, Airport Hospitality will create visually consistent landscaping for DOTA and Airport Hospitality premises to create visually consistent landscaping that would enhance both properties. Airport Hospitality shall furnish, at its sole cost and expense, the equipment, supplies, plants, and other materials to perform the agreed upon services.

RECOMMENDATION:

That the Board authorize the Department of Transportation to issue a month-to-month revocable permit to Airport Hospitality, subject to: (1) terms and conditions herein outlined, which are by reference incorporated herein; and (2) such additional terms and conditions as may be prescribed by the Director of Transportation to best serve the interests of the State.

Respectfully submitted,



JADE T. BUTAY  
Director of Transportation

APPROVED FOR SUBMITTAL:

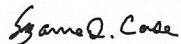

SUZANNE D. CASE  
Chairperson and Member

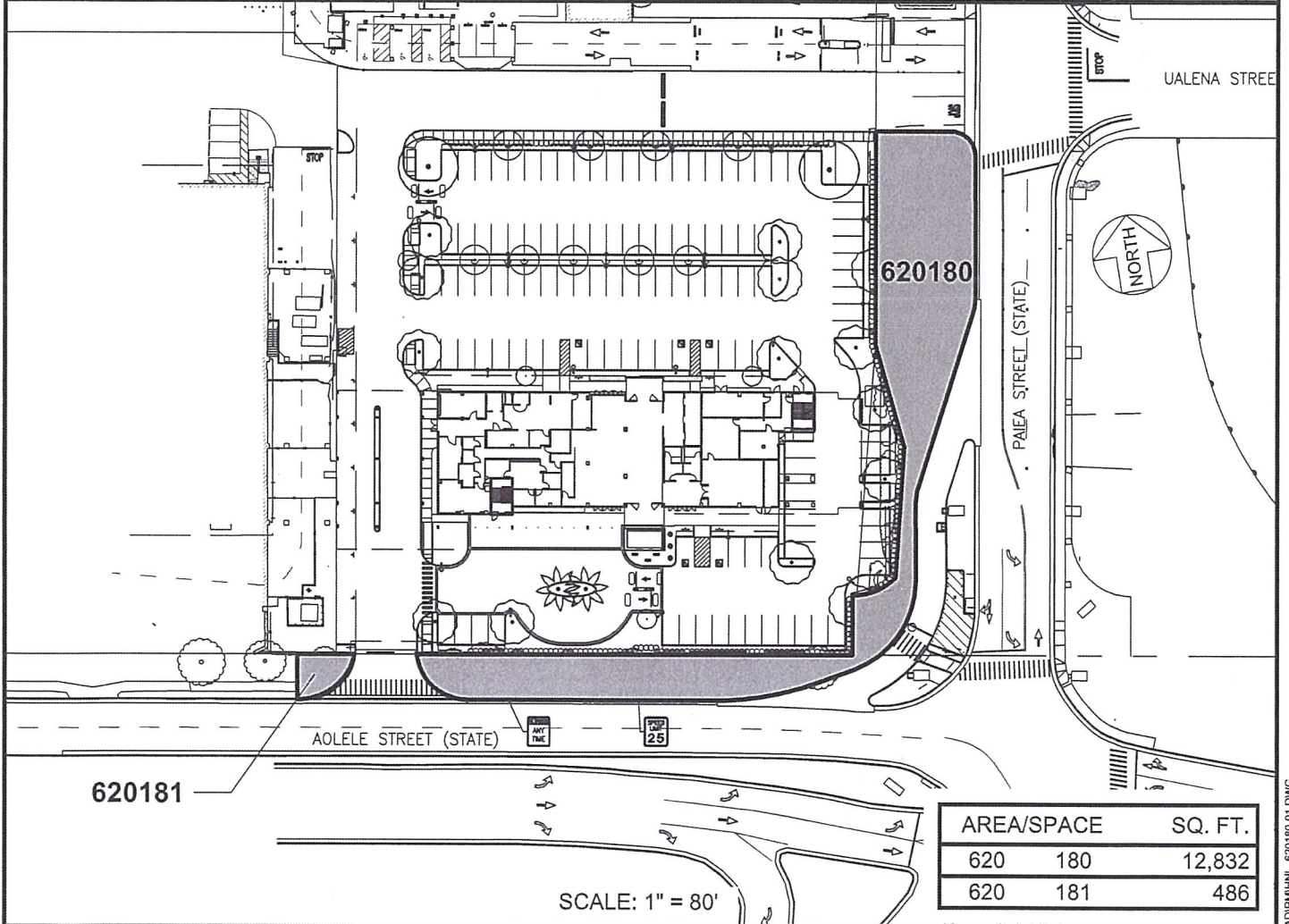
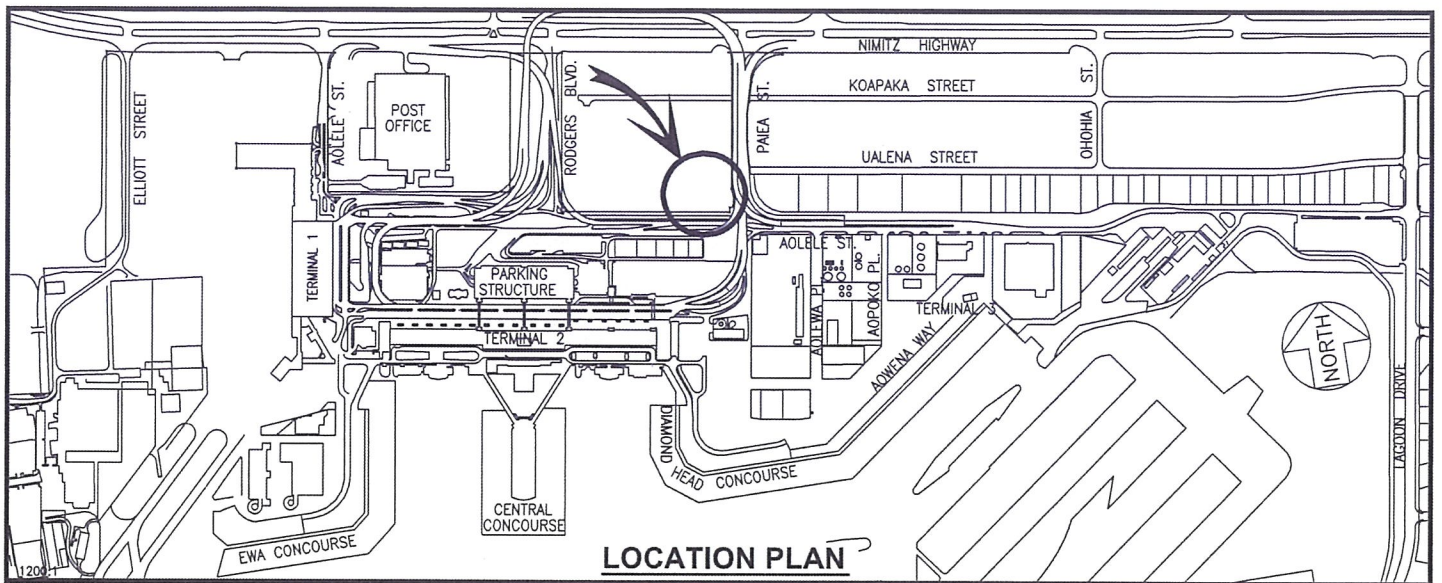

DATE : MARCH 2022

EXHIBIT: **A**



Airports Division

AIRPORT HOSPITALITY LLC

UALENA STREET /  
AOLELE STREE

620180  
620181

# DANIEL K. INOUE INTERNATIONAL AIRPORT