

DAVID Y. IGE
GOVERNOR



STATE OF HAWAII
DEPARTMENT OF TRANSPORTATION
869 PUNCHBOWL STREET
HONOLULU, HAWAII 96813-5097

JADE T. BUTAY
DIRECTOR

Deputy Directors
ROSS M. HIGASHI
EDUARDO P. MANGLALLAN
EDWIN H. SNIFFEN

IN REPLY REFER TO:

Board of Land and
Natural Resources
State of Hawai'i
Honolulu, Hawai'i

ISSUANCE OF A REVOCABLE PERMIT FOR COMMERCIAL USE OF A
T-HANGAR FOR STORAGE OF AIRCRAFT AND A MAINTENANCE HANGAR
BRUCE A. COULOMBE DBA WINGS OVER KAUAI LLC
LĪHU'E AIRPORT
TAX MAP KEY: (4) 3-5-01: PORTION OF 08

KAUA'I

LEGAL REFERENCE:

Section 171-55, Hawai'i Revised Statutes (HRS).

APPLICANT:

Bruce A. Coulombe dba Wings Over Kauai LLC (Mr. Coulombe) whose address is
3764 Kikee Road, Kalaheo, Hawai'i 96741.

LOCATION AND TAX MAP KEY:

Portion of Līhu'e Airport (LIH), Līhu'e, Island of Kaua'i, identified by
Tax Map Key: 4th Division, 3-5-01: Portion of 08.

AREA:

Building/Room No. 411-101, containing an area of approximately 1,092 square feet, as
shown and delineated on the attached Exhibit A.

ZONING:

State Land Use District:	Urban
County of Kaua'i:	Industrial General/Special Treatment-Public Use (IG/ST-P)

ITEM M-13

BLNR – ISSUANCE OF A REVOCABLE PERMIT FOR COMMERCIAL USE OF A
T-HANGAR FOR STORAGE OF AIRCRAFT AND A MAINTENANCE HANGAR
BRUCE A. COULOMBE DBA WINGS OVER KAUAI LLC

Page 2

LAND TITLE STATUS:

Section 5(a) lands of the Hawai'i Admission Act:

DHHL 30% entitlement lands pursuant to Hawai'i Admission Act

Non-Ceded

YES_ NO X

CURRENT USE STATUS:

Land presently encumbered by Governor's Executive Order No. 4614, dated October 28, 2019, setting aside 883.583 acres designated as Lihu'e Airport to be under the control and management of the State of Hawai'i, Department of Transportation for Airport Purposes.

CHARACTER OF USE:

Mr. Coulombe will use the T-hangar for storage of aircraft (2001 Cessna 172S, Tail No. N-492ER) and a maintenance hangar to be used as part of his Commercial Air Tour and Flight School Operations at LIH.

In addition, Mr. Coulombe has an aircraft (2005 Gippsland GA-8, Tail No. N-7508M) parked in a tie-down at LIH that may be stored in the T-Hangar as needed for maintenance or operational support as part of his Commercial Air Tour and Flight School Operations.

No fixed-wing tour operations will be allowed from the T-hangar.

COMMENCEMENT DATE:

Upon execution of the revocable permit.

MONTHLY RENTAL:

\$1,212.12 (\$1,092.00 as determined from the DOTA schedule of rates and charges established by appraisal of Airports property statewide plus \$120.12 for utilities).

SECURITY DEPOSIT:

\$3,636.36, or three (3) times the monthly rental in effect.

DCCA VERIFICATION:

Place of business registration confirmed:	YES <u>X</u>	NO <u> </u>
Registered business name confirmed:	YES <u>X</u>	NO <u> </u>
Good standing confirmed:	YES <u>X</u>	NO <u> </u>

BLNR – ISSUANCE OF A REVOCABLE PERMIT FOR COMMERCIAL USE OF A
T-HANGAR FOR STORAGE OF AIRCRAFT AND A MAINTENANCE HANGAR
BRUCE A. COULOMBE DBA WINGS OVER KAUAI LLC

Page 3

CHAPTER 343, HRS - ENVIRONMENTAL ASSESSMENT:

The State of Hawai'i, Department of Transportation, Airports Division (DOTA), has determined that the environmental impacts for the subject land use is covered by the Lihue Airport Ahukini Road Realignment and General Aviation Subdivision Final Environmental Assessment (FEA), published by the Office of Environmental Quality Control (OEQC) in the April 23, 1997, issue of The Environmental Notice. Accordingly, all relevant mitigation from the FEA and best management practices will be implemented to address the minimum impacts of this action.

REMARKS:

In accordance with Section 171-55, HRS, relating to Permits, the Department of Transportation proposes to issue a month-to-month revocable permit to Mr. Coulombe for the storage of aircraft and a maintenance hangar to be used as part of his Commercial Air Tour and Flight School Operations at LIH.

RECOMMENDATION:

That the Board authorize the Department of Transportation to issue a month-to-month revocable permit to Mr. Coulombe, subject to: (1) terms and conditions herein outlined, which are by reference incorporated herein; and (2) such additional terms and conditions as may be prescribed by the Director of Transportation to best serve the interests of the State.

Respectfully submitted,

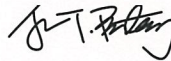

JADE T. BUTAY
Director of Transportation

APPROVED FOR SUBMITTAL:

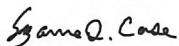

SUZANNE D. CASE
Chairperson and Member

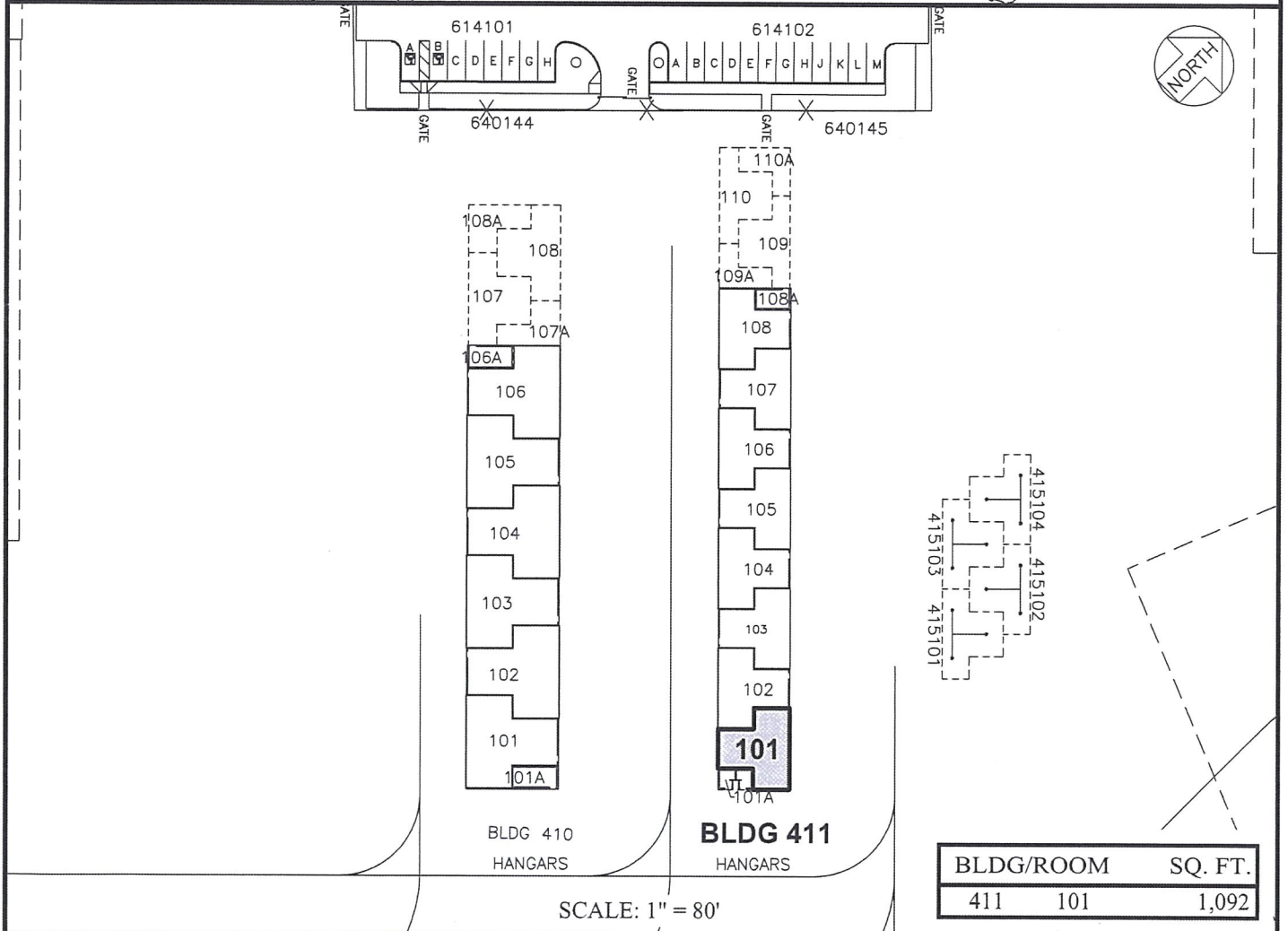
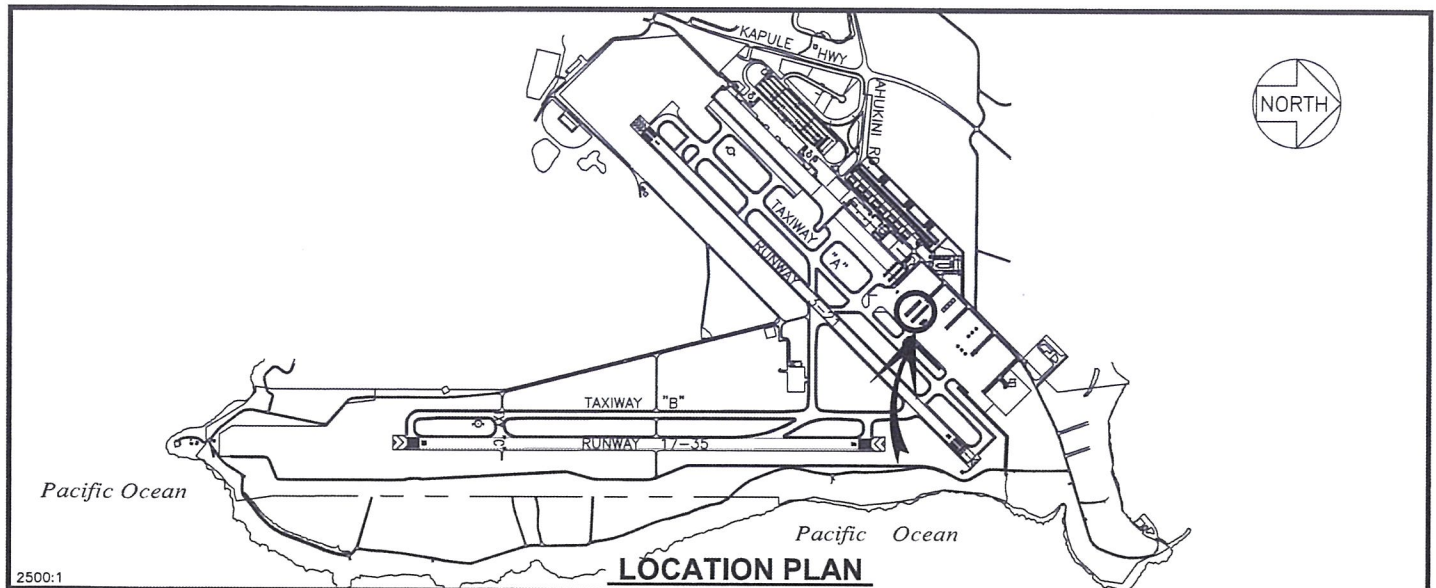

RP-9228

DATE : FEBRUARY 2022

EXHIBIT: **A**



Airports Division

BRUCE A. COULOMBE DBA
WINGS OVER KAUAI LLC

BUILDING 411
HANGAR
GROUND LEVEL

411101
PLAT E1, 35

LIHUE AIRPORT

N:\AIRPORTS\LIH_Lihue\CAD\PM\lih_411101-01.dwg