

DAVID Y. IGE  
GOVERNOR



STATE OF HAWAII  
DEPARTMENT OF TRANSPORTATION  
869 PUNCHBOWL STREET  
HONOLULU, HAWAII 96813-5097

JADE T. BUTAY  
DIRECTOR

Deputy Directors  
ROSS M. HIGASHI  
EDUARDO P. MANGLALLAN  
EDWIN H. SNIFFEN

IN REPLY REFER TO:

Board of Land and  
Natural Resources  
State of Hawai'i  
Honolulu, Hawai'i

ISSUANCE OF A REVOCABLE PERMIT FOR RAMP SPACE TO  
STORE AIRCRAFT PARTS, CONSUMABLES AND EQUIPMENT  
HKA PACIFIC LLC  
ELLISON ONIZUKA KONA INTERNATIONAL AIRPORT AT KEĀHOLE  
TAX MAP KEY: (3) 7-3-43: PORTION OF 03

HAWAII

LEGAL REFERENCE:

Section 171-55, Hawai'i Revised Statutes (HRS).

APPLICANT:

HKA Pacific LLC (HKA), whose mailing address is 109 Mokuia Place, Honolulu,  
Hawai'i 96819.

LOCATION AND TAX MAP KEY:

Portion of Ellison Onizuka Kona International Airport at Keāhole (KOA), Kailua-Kona,  
Island of Hawai'i, identified by Tax Map Key: 3rd Division, 7-3-43: Portion of 03.

AREA:

Area/Space No. 630-173, containing an area of approximately 525 square feet of  
improved, paved land, as shown and delineated on the attached Exhibit A.

ZONING:

State Land Use District:	Urban & Conservation
County of Hawai'i:	Industrial (MG-1a) and Open

**ITEM M-15**

BLNR – ISSUANCE OF A REVOCABLE PERMIT FOR RAMP SPACE TO STORE  
AIRCRAFT PARTS, CONSUMABLES AND EQUIPMENT, HKA PACIFIC LLC

Page 2

LAND TITLE STATUS:

Section 5(a) lands of the Hawai'i Admission Act: Ceded

DHHL 30% entitlement lands pursuant to Hawai'i Admission Act YES\_\_\_ NO X

CURRENT USE STATUS:

Land presently encumbered by Governor's Executive Order No. 3074, dated August 20, 1981, setting aside 4,204.10 acres designated as KOA under the control and management of the State of Hawai'i, Department of Transportation, Airports Division for Airport Purposes.

CHARACTER OF USE:

HKA will use the ramp space to store parts, consumables, and equipment, in support of its aviation aircraft maintenance operation at KOA.

COMMENCEMENT DATE:

Upon execution of the revocable permit.

MONTHLY RENTAL:

\$90.13 (based on a rate of \$2.06 per square foot per annum for improved, paved land, as determined from the DOTA schedule of rates and charges established by appraisal of Airports property statewide).

SECURITY DEPOSIT:

\$270.39, or three (3) times the monthly rental in effect.

DCCA VERIFICATION:

Place of business registration confirmed:	YES <u>X</u>	NO ___
Registered business name confirmed:	YES <u>X</u>	NO ___
Good standing confirmed:	YES <u>X</u>	NO ___

CHAPTER 343, HRS - ENVIRONMENTAL ASSESSMENT:

The State of Hawai'i, Department of Transportation, Airports Division, has determined that the subject land area and use is covered by the Keahole Airport General Aviation and Maintenance Baseyard Facilities Negative Declaration, published by the Environmental Quality Commission (EQC) in the December 23, 1980, issue of the EQC Bulletin. Accordingly, all relevant mitigation from the Negative Declaration and best management practices will be implemented to address the minimum impacts of this action.

BLNR – ISSUANCE OF A REVOCABLE PERMIT FOR RAMP SPACE TO STORE  
AIRCRAFT PARTS, CONSUMABLES AND EQUIPMENT, HKA PACIFIC LLC

Page 3

REMARKS:

In accordance with Section 171-55, HRS, relating to Permits, the Department of Transportation proposes to issue a month-to-month revocable permit to HKA for ramp space to store parts, consumables, and equipment, in support of its aviation aircraft maintenance operation at KOA.

RECOMMENDATION:

That the Board authorize the Department of Transportation to issue a month-to-month revocable permit to HKA, subject to: (1) terms and conditions herein outlined, which are by reference incorporated herein; and (2) such additional terms and conditions as may be prescribed by the Director of Transportation to best serve the interests of the State.

Respectfully submitted,

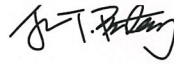

JADE T. BUTAY  
Director of Transportation

APPROVED FOR SUBMITTAL:

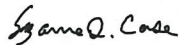

SUZANNE D. CASE  
Chairperson and Member



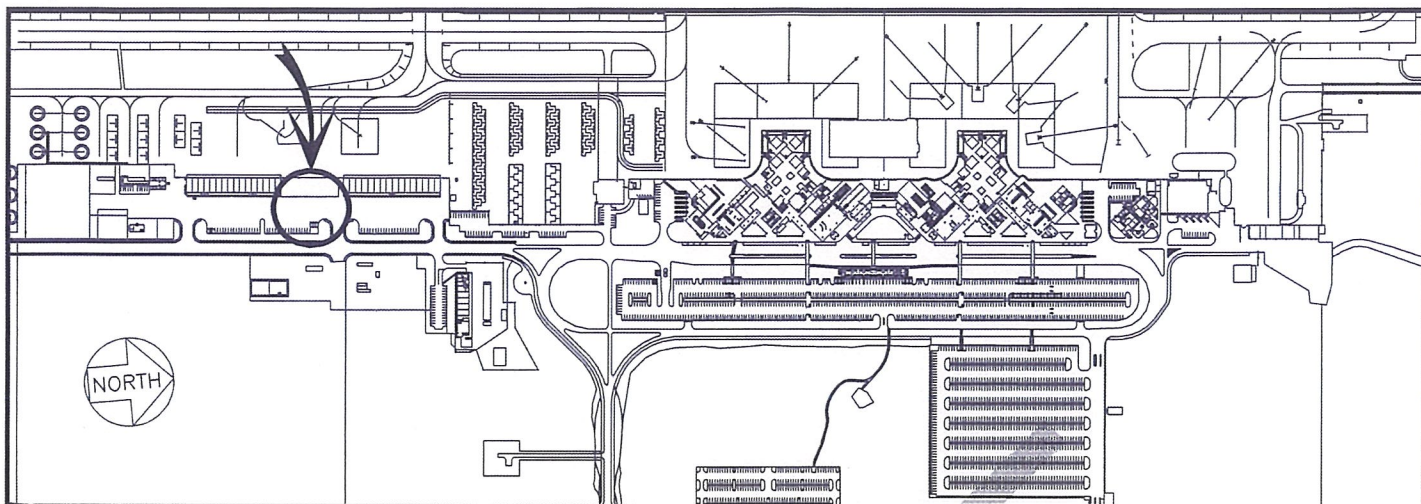

600:1

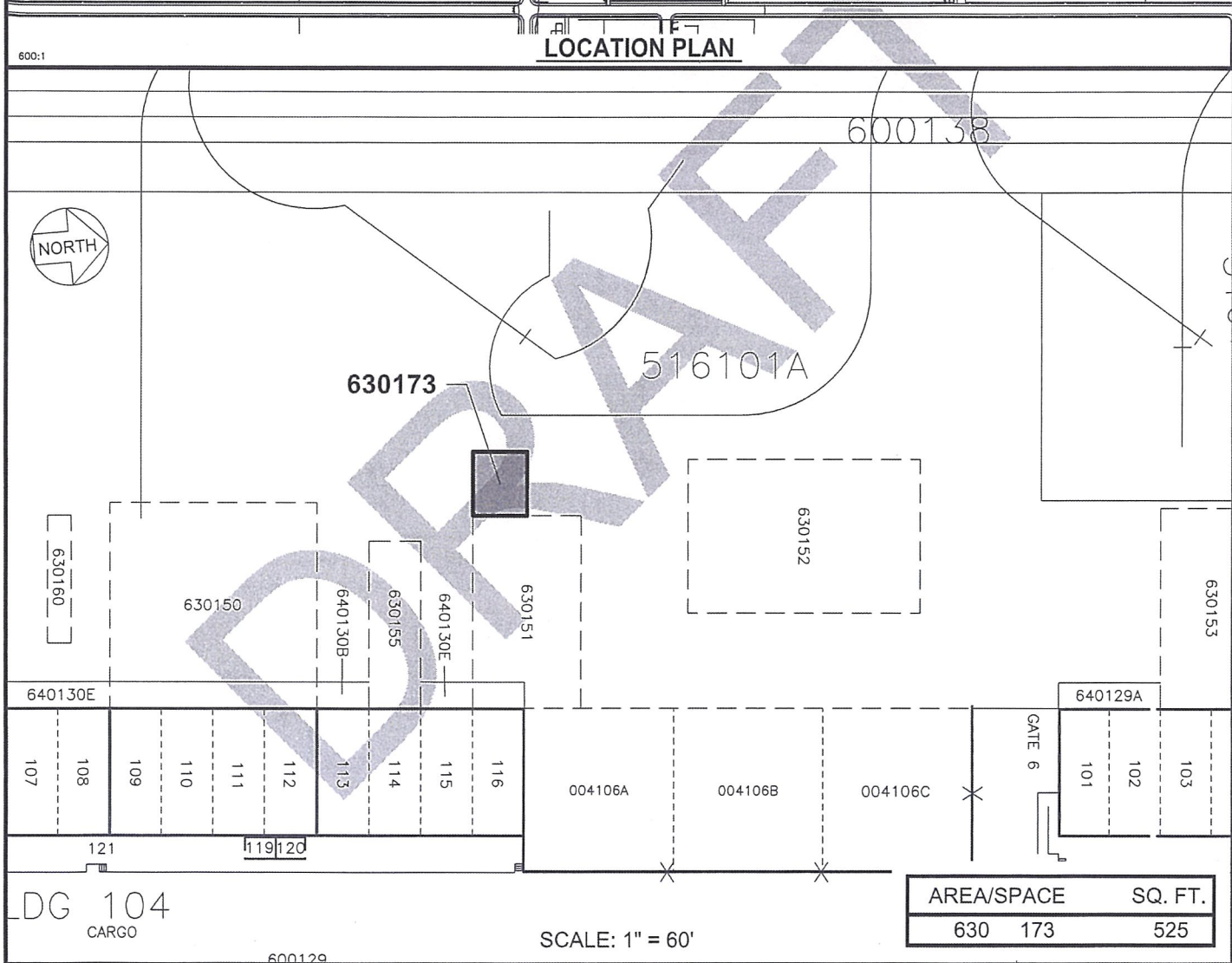

DRAFT

DATE : JUNE 2022

EXHIBIT: A



Airports Division

HKA PACIFIC LLC

LOTS

630173  
PLAT C1,39

# ELLISON ONIZUKA KONA INTERNATIONAL AIRPORT AT KEAHOLE