

DAVID Y. IGE  
GOVERNOR



STATE OF HAWAII  
DEPARTMENT OF TRANSPORTATION  
869 PUNCHBOWL STREET  
HONOLULU, HAWAII 96813-5097

JADE T. BUTAY  
DIRECTOR

Deputy Directors  
ROSS M. HIGASHI  
EDUARDO P. MANGLALLAN  
EDWIN H. SNIFFEN

IN REPLY REFER TO:

Board of Land and  
Natural Resources  
State of Hawai'i  
Honolulu, Hawai'i

ISSUANCE OF A REVOCABLE PERMIT FOR RAMP SPACE FOR A MOBILE  
OFFICE TRAILER AND TO PARK GROUND SERVICE EQUIPMENT  
SWISSPORT USA, INC.  
LĪHU'E AIRPORT  
TAX MAP KEY: (4) 3-5-001: PORTION OF 008

KAUA'I

LEGAL REFERENCE:

Section 171-55, Hawai'i Revised Statutes (HRS).

APPLICANT:

Swissport USA, Inc. (Swissport), whose mailing address is 300 Rodgers Boulevard #63,  
Honolulu, Hawai'i 96819.

LOCATION AND TAX MAP KEY:

Portion of Līhu'e Airport (LIH), Līhu'e, Island of Kaua'i, identified by  
Tax Map Key: 4th Division, 3-5-001: Portion of 008.

AREA:

Area/Space No. 514-101G, containing an area of approximately 600 square feet of  
improved, paved land, as shown and delineated on the attached Exhibit A.

ZONING:

State Land Use District: Urban  
County of Kaua'i: Industrial General/Special Treatment-Public Use (IG/ST-P)

**ITEM M-3**

BLNR – ISSUANCE OF A REVOCABLE PERMIT FOR RAMP SPACE FOR A MOBILE OFFICE TRAILER AND TO PARK GROUND SERVICE EQUIPMENT  
SWISSPORT USA, INC.  
Page 2

LAND TITLE STATUS:

Section 5(a) lands of the Hawai‘i Admission Act: Non-Ceded  
DHHL 30% entitlement lands pursuant to Hawai‘i Admission Act: YES \_\_\_ NO X

CURRENT USE STATUS:

Land presently encumbered by Governor’s Executive Order No. 4614, dated October 28, 2019, setting aside 883.583 acres designated as Līhu‘e Airport to be under the control and management of the State of Hawai‘i, Department of Transportation for Airport Purposes.

CHARACTER OF USE:

Swissport will use the ramp space for a mobile office trailer and to park ground service equipment, in support of its ground handling operations at LIH.

COMMENCEMENT DATE:

Upon execution of the revocable permit.

MONTHLY RENTAL:

\$384.00 (\$150.00 as determined from the DOTA schedule of rates and charges established by appraisal of Airports property statewide plus \$234.00 for utilities).

SECURITY DEPOSIT:

\$1,152.00, or three (3) times the monthly rental in effect.

DCCA VERIFICATION:

Place of business registration confirmed: YES X NO \_\_\_  
Registered business name confirmed: YES X NO \_\_\_  
Good standing confirmed: YES X NO \_\_\_

CHAPTER 343, HRS - ENVIRONMENTAL ASSESSMENT:

The State of Hawaii, Department of Transportation, Airports Division, has determined that the environmental impacts of the proposed tenant lease for the subject land use is covered by the Lihue Airport Master Plan Environmental Impact Statement (EIS), published by the Environmental Quality Commission (EQC) in the August 8, 1976, and

BLNR – ISSUANCE OF A REVOCABLE PERMIT FOR RAMP SPACE FOR A MOBILE OFFICE TRAILER AND TO PARK GROUND SERVICE EQUIPMENT  
SWISSPORT USA, INC.

Page 3

August 23, 1976, issues of EQC Bulletin and accepted by the Governor on April 26, 1977. Accordingly, all relevant mitigation from the EIS and best management practices will be implemented to address the minimum impacts of this action.

REMARKS:

In accordance with Section 171-55, HRS, relating to Permits, the Department of Transportation proposes to issue a month-to-month revocable permit to Swissport for ramp space for a mobile office trailer and to park ground service equipment, in support of its ground handling operations at LIH.

RECOMMENDATION:

That the Board authorize the Department of Transportation to issue a month-to-month revocable permit to Swissport, subject to: (1) terms and conditions herein outlined, which are by reference incorporated herein; and (2) such additional terms and conditions as may be prescribed by the Director of Transportation to best serve the interests of the State.

Respectfully submitted,

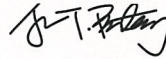

JADE T. BUTAY  
Director of Transportation

APPROVED FOR SUBMITTAL:

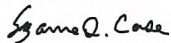

SUZANNE D. CASE  
Chairperson and Member

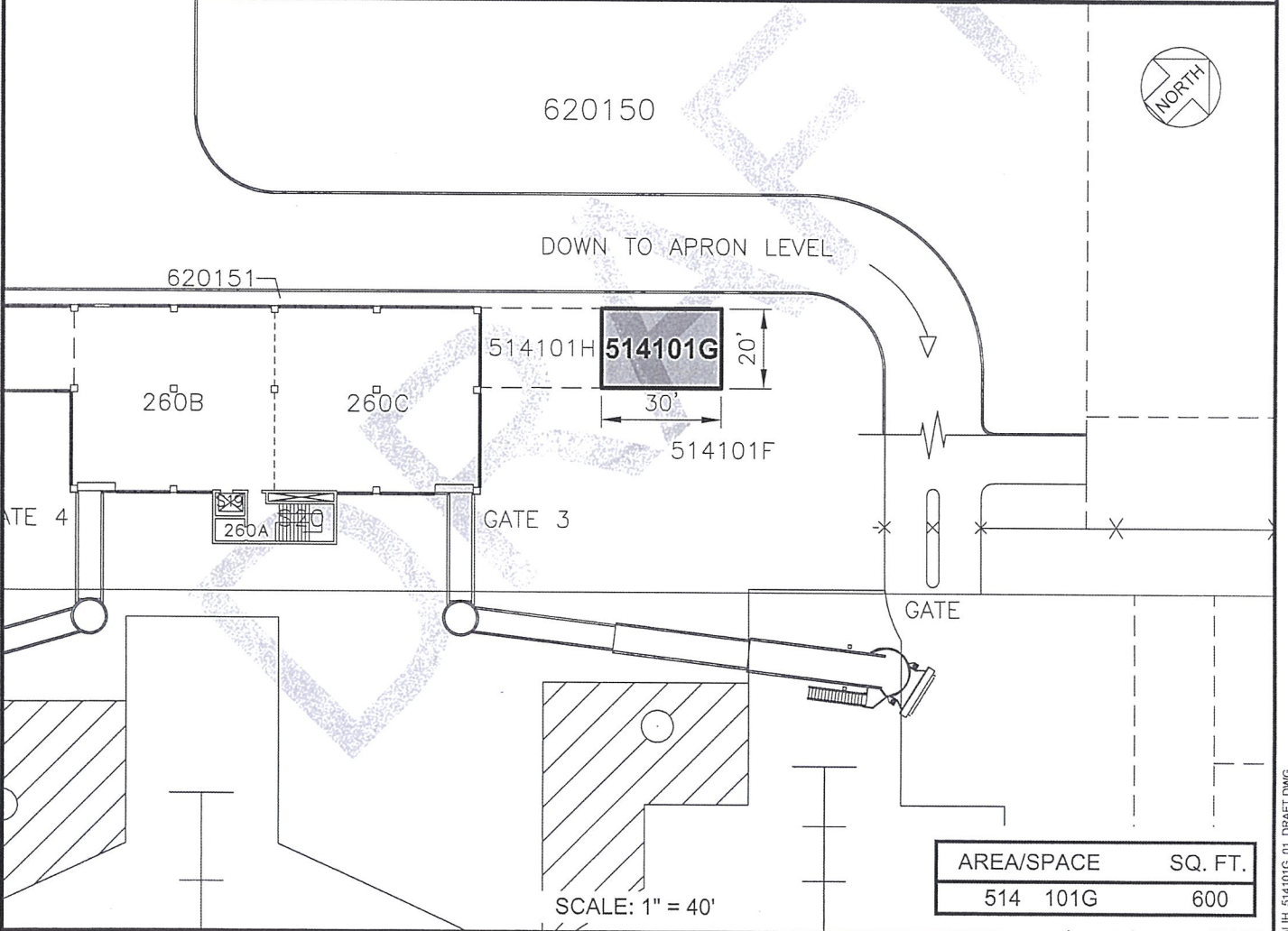
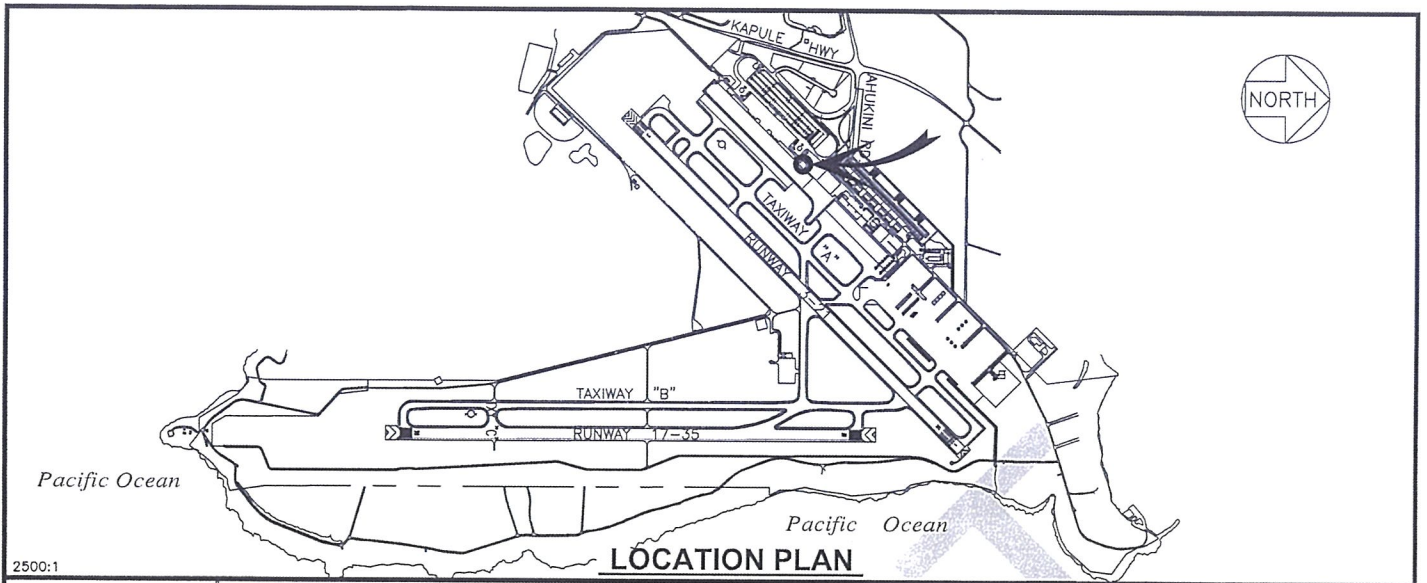

DRAFT

DATE : MAY 2022

EXHIBIT: **A**



SWISSPORT USA, INC.

RAMP APRON

514101G  
PLAT D1,45

**LIHUE AIRPORT**