

DAVID Y. IGE  
GOVERNOR



STATE OF HAWAII  
DEPARTMENT OF TRANSPORTATION  
869 PUNCHBOWL STREET  
HONOLULU, HAWAII 96813-5097

JADE T. BUTAY  
DIRECTOR

Deputy Directors  
ROSS M. HIGASHI  
EDUARDO P. MANGLALLAN  
EDWIN H. SNIFFEN

IN REPLY REFER TO:

Board of Land and  
Natural Resources  
State of Hawai'i  
Honolulu, Hawai'i

ISSUANCE OF A REVOCABLE PERMIT FOR COMMERCIAL USE OF A  
T-HANGAR FOR STORAGE OF AIRCRAFT AND A MAINTENANCE HANGAR  
HAWAII PACIFIC AVIATION INC.

ELLISON ONIZUKA KONA INTERNATIONAL AIRPORT AT KEĀHOLE

TAX MAP KEY: (3) 7-3-43: PORTION OF 003

HAWAI'I

LEGAL REFERENCE:

Section 171-55, Hawai'i Revised Statutes (HRS).

APPLICANT:

Hawaii Pacific Aviation Inc. (HPA) whose business address is 73-310 U'u Street, Kailua-Kona, Hawai'i 96740.

LOCATION AND TAX MAP KEY:

Portion of Ellison Onizuka Kona International Airport at Keāhole (KOA), Kailua-Kona, Island of Hawai'i, identified by Tax Map Key: 3rd Division, 7-3-43: Portion of 003.

AREA:

Building/Room No. 421-102, containing an area of approximately 1,464 square feet, as shown and delineated on the attached Exhibit A.

ZONING:

State Land Use District:  
County of Hawai'i:

Urban & Conservation  
Industrial (MG-1a) and Open

**ITEM M-8**

BLNR – ISSUANCE OF A REVOCABLE PERMIT FOR COMMERCIAL USE OF A  
T-HANGAR FOR STORAGE OF AIRCRAFT AND A MAINTENANCE HANGAR  
HAWAII PACIFIC AVIATION INC.

Page 2

LAND TITLE STATUS:

Section 5(a) lands of the Hawai'i Admission Act: Ceded

DHHL 30% entitlement lands pursuant to Hawai'i Admission Act YES \_\_\_ NO X

CURRENT USE STATUS:

Land presently encumbered by Governor's Executive Order No. 3074, dated August 20, 1981, setting aside 4,204.10 acres designated as KOA under the control and management of the State of Hawai'i, Department of Transportation, Airports Division for Airport Purposes.

CHARACTER OF USE:

HPA will use the T-hangar for storage of aircraft (2005 Robinson R44 II Tail No. N120AB) and a maintenance hangar, in support of its flight school operation at KOA .

COMMENCEMENT DATE:

Upon complete execution of the revocable permit.

MONTHLY RENTAL:

\$1,756.80 (as determined from the Appraisal Report for the Estimate of Annual, Fair Market Lease Rental Values of T-Hangars and Sprung Structures, Ellison Onizuka Kona International Airport at Keāhole, prepared by ACM Consultants, Inc., dated 3/15/21).

SECURITY DEPOSIT:

\$5,270.40, or three (3) times the monthly rental in effect.

DCCA VERIFICATION:

Place of business registration confirmed:	YES <u>X</u>	NO ___
Registered business name confirmed:	YES <u>X</u>	NO ___
Good standing confirmed:	YES <u>X</u>	NO ___

CHAPTER 343, HRS - ENVIRONMENTAL ASSESSMENT:

The State of Hawai'i, Department of Transportation, Airports Division, has determined the subject land areas are covered by the Final Environmental Assessment (EA)/Finding of No Significant Impact (FONSI), Airfield, Terminal, and Facility Improvements for the Kona International Airport at Keāhole, published by the Office of Environmental Quality

BLNR – ISSUANCE OF A REVOCABLE PERMIT FOR COMMERCIAL USE OF A  
T-HANGAR FOR STORAGE OF AIRCRAFT AND A MAINTENANCE HANGAR  
HAWAII PACIFIC AVIATION INC.

Page 3

Control (OEQC) in the March 23, 2013, issue of The Environmental Notice.  
Accordingly, all relevant mitigation from the EA and best management practices will be  
implemented to address the minimum impacts of this action.

REMARKS:

In accordance with Section 171-55 HRS, relating to Permits, the Department of  
Transportation proposes to issue a month-to-month revocable permit to HPA for a  
T-Hangar for storage of aircraft and a maintenance hangar, in support of its flight school  
operation at KOA.

RECOMMENDATION:

That the Board authorize the Department of Transportation to issue a month-to-month  
revocable permit to HPA, subject to: (1) terms and conditions herein outlined, which are  
by reference incorporated herein; and (2) such additional terms and conditions as may be  
prescribed by the Director of Transportation to best serve the interests of the State.

Respectfully submitted,



JADE T. BUTAY  
Director of Transportation

APPROVED FOR SUBMITTAL:

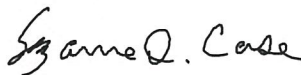

SUZANNE D. CASE  
Chairperson and Member



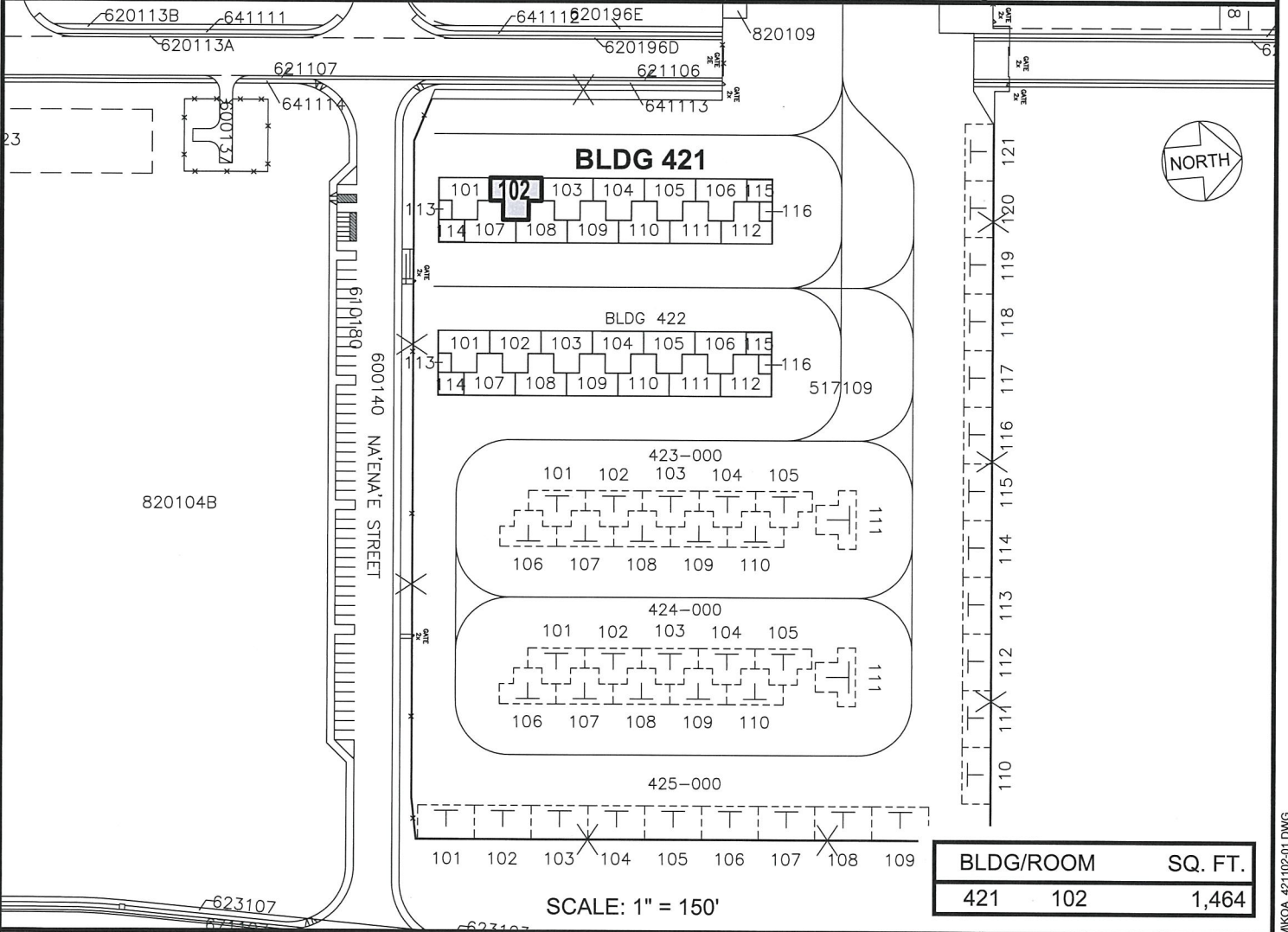
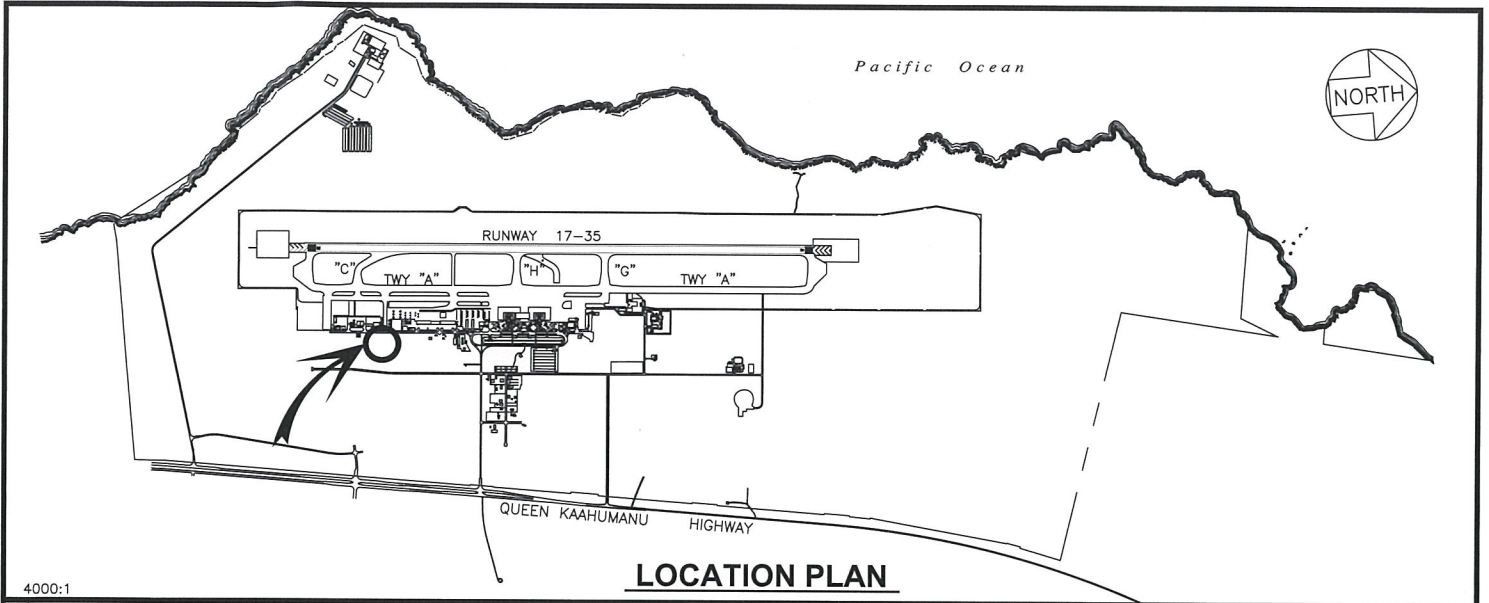

RP-9291	DATE : JUNE 2022	EXHIBIT: <b>A</b>
<p>Airports Division</p>	<p>HAWAII PACIFIC AVIATION INC.</p>	<p>T-HANGAR</p>
		<p>421102</p> <p>PLAT 60</p>

ELLISON ONIZUKA KONA INTERNATIONAL AIRPORT AT KEAHOLE