

DAVID Y. IGE
GOVERNOR



STATE OF HAWAII
DEPARTMENT OF TRANSPORTATION
869 PUNCHBOWL STREET
HONOLULU, HAWAII 96813-5097

JADE T. BUTAY
DIRECTOR

Deputy Directors
ROSS M. HIGASHI
EDUARDO P. MANGLALLAN
EDWIN H. SNIFFEN

IN REPLY REFER TO:

Board of Land and
Natural Resources
State of Hawai'i
Honolulu, Hawai'i

ISSUANCE OF A REVOCABLE PERMIT FOR STAGING AND STORAGE OF
CONSTRUCTION MATERIAL AND EQUIPMENT TO ACCESS THE RAIL PROJECT'S
GUIDEWAY TO CONDUCT ELECTRICAL WORK ON THE ELEVATED TRACKS
MASS. ELECTRIC CONSTRUCTION CO.
DANIEL K. INOUE INTERNATIONAL AIRPORT
TAX MAP KEY: (1) 1-1-004: PORTION OF 07 AND 087

O'AHU

REQUEST:

Issuance of a Revocable Permit for staging and storage of construction material and equipment for the rail project's guideway to conduct electrical work on the elevated tracks, Mass. Electric Construction Co. situated at Daniel K. Inouye International Airport.

LEGAL REFERENCE:

Section 171-55, Hawai'i Revised Statutes.

APPLICANT:

Mass. Electric Construction Co., whose business address is 99-1056 Iwaena St, Aiea, Hawaii 96701.

LOCATION AND TAX MAP KEY:

Daniel K. Inouye International Airport (HNL), Island of O'ahu, State of Hawai'i, identified by Tax Map Key: 1st Division, 1-1-004: 07 and 087.

AREA:

Area/Lot No. 005-125, containing an area of approximately 21,343 square feet; and Area/Lot No. 005-126, containing an area of approximately 22,535 square feet, as shown and delineated on the attached map labeled Exhibit "A".

ITEM M-10

BLNR – ISSUANCE OF A REVOCABLE PERMIT FOR STAGING AND STORAGE OF CONSTRUCTION MATERIAL AND EQUIPMENT TO ACCESS THE RAIL PROJECT'S GUIDEWAY TO CONDUCT ELECTRICAL WORK ON THE ELEVATED TRACKS, MASS. ELECTRIC CONSTRUCTION CO.

Page 2

ZONING:

State Land Use District: Urban
City and County of Honolulu LUO: Industrial (I-2)

LAND TITLE STATUS:

Non-Ceded - Section 5(a) lands of the Hawai'i Admission Act
DHHL 30% entitlement lands pursuant to Hawai'i Admission Act YES ___ NO X

CURRENT USE STATUS:

Land presently encumbered by Governor's Executive Order No. 3201, dated June 8, 1983, setting aside 3,152.177 acres designated as Daniel K. Inouye International Airport under the control and management of the State of Hawai'i, Department of Transportation, Airports Division (DOTA) for Airport Purposes.

CHARACTER OF USE:

Mass. Electric Construction Co. will use the spaces for staging and storage of construction material and equipment for the rail project's guideway and to conduct electrical work on the elevated tracks.

COMMENCEMENT DATE:

Upon execution of the revocable permit.

MONTHLY RENTAL:

\$20,732.36 (as determined from the DOTA schedule of rates and charges established by appraisal of Airports property statewide).

SECURITY DEPOSIT:

\$62,197.08, or three (3) times the monthly rental in effect.

DCCA VERIFICATION:

Place of business registration confirmed: YES X NO ___
Registered business name confirmed: YES X NO ___
Good standing confirmed: YES X NO ___

BLNR – ISSUANCE OF A REVOCABLE PERMIT FOR STAGING AND STORAGE OF CONSTRUCTION MATERIAL AND EQUIPMENT TO ACCESS THE RAIL PROJECT’S GUIDEWAY TO CONDUCT ELECTRICAL WORK ON THE ELEVATED TRACKS, MASS. ELECTRIC CONSTRUCTION CO.

Page 3

CHAPTER 343, HRS - ENVIRONMENTAL ASSESSMENT:

The environmental impacts of the proposed action to the subject land area are covered by the Honolulu International airport Master Plan Update and Noise Compatibility Program Environmental Assessment (EA), State Project No. AO1011-033. The EA is a joint State and Federal document, dated September 1989 and published in the October 23, 1989 issue of the OEQC Bulletin. Accordingly, relevant mitigation from the EA and DOTA environmental best management practice will address minimal impacts from this action.

REMARKS:

In accordance with Section 171-55 HRS, relating to Permits, the Department of Transportation proposes to issue a month-to-month revocable permit to Mass. Electric Construction Co., for staging and storing of construction material and equipment for the rail project’s guideway and to access the guideway and conduct electrical work on the elevated tracks.

RECOMMENDATION:

That the Board authorize the Department of Transportation to issue a month-to-month revocable permit to Mass. Electric Construction Co., subject to: (1) terms and conditions herein outlined, which are by reference incorporated herein; and (2) such additional terms and conditions as may be prescribed by the Director of Transportation to best serve the interests of the State.

Respectfully submitted,

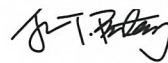

JADE T. BUTAY
Director of Transportation

APPROVED FOR SUBMITTAL:

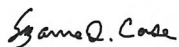

SUZANNE D. CASE
Chairperson
Board of Land and Natural Resources

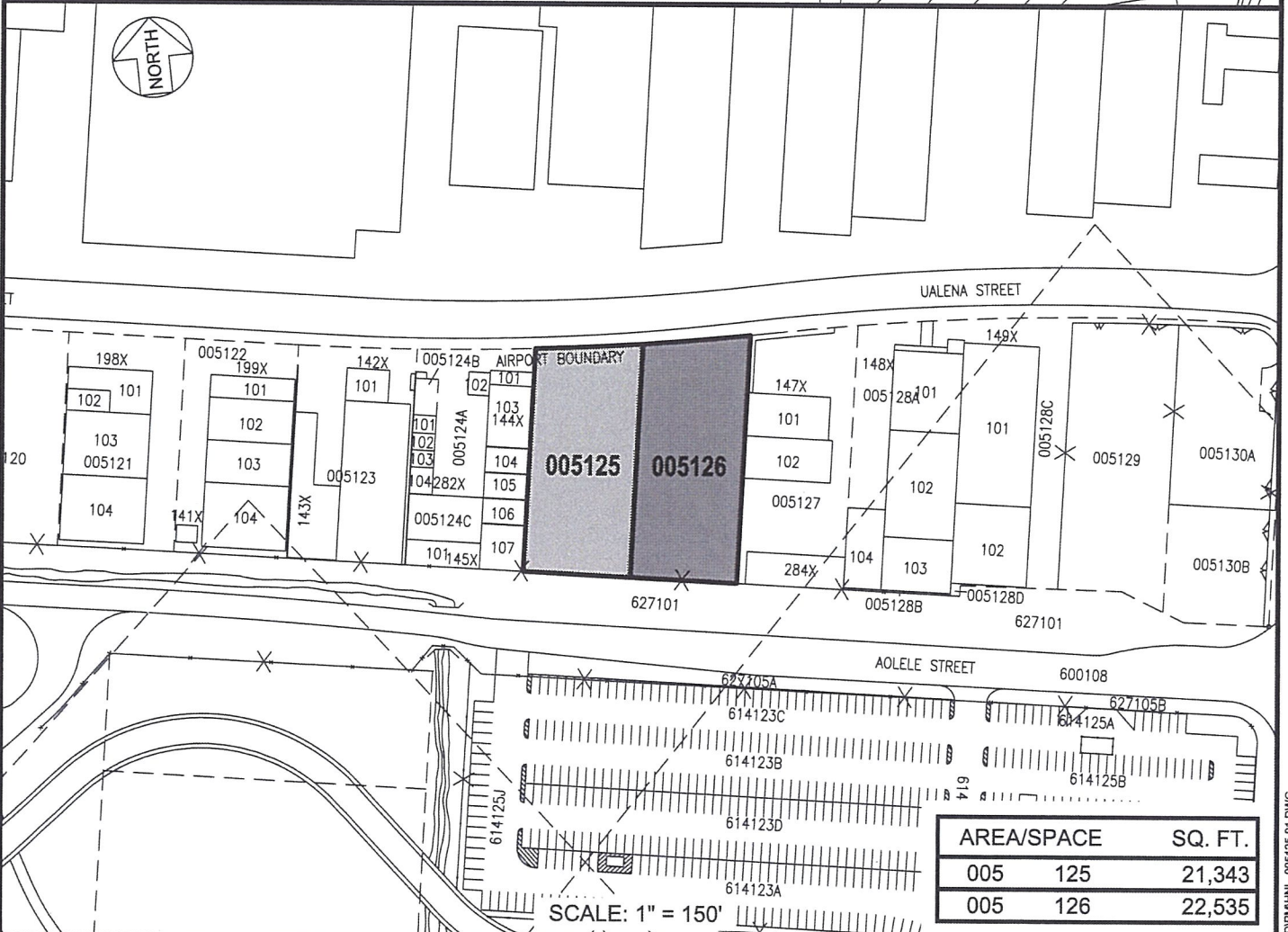
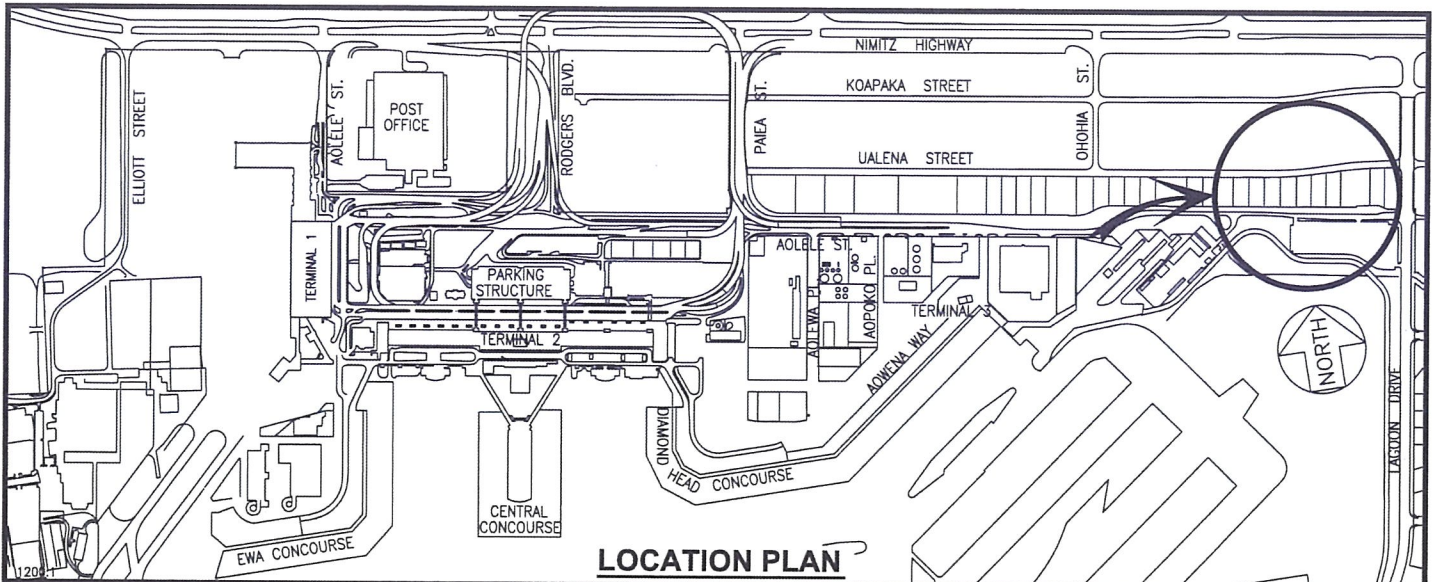

AREA/SPACE	SQ. FT.
005 125	21,343
005 126	22,535

RP-9316	DATE : SEPTEMBER 2022	EXHIBIT: A	
Airports Division	MASS. ELECTRIC CONSTRUCTION CO.	LOTS	005125 005126
			PLAT 26

DANIEL K. INOUE INTERNATIONAL AIRPORT

N:\AIRPORTS\HNL_HONOLULU\CAD\PM\HNL_005125-01.DWG