

DAVID Y. IGE
GOVERNOR



STATE OF HAWAII
DEPARTMENT OF TRANSPORTATION
869 PUNCHBOWL STREET
HONOLULU, HAWAII 96813-5097

JADE T. BUTAY
DIRECTOR

Deputy Directors
ROSS M. HIGASHI
EDUARDO P. MANGLALLAN
EDWIN H. SNIFFEN

IN REPLY REFER TO:

Board of Land and
Natural Resources
State of Hawai'i
Honolulu, Hawai'i

ISSUANCE OF A REVOCABLE PERMIT FOR COUNTER SPACE
IN THE COMMUTER TERMINAL FOR AIR CHARTER OPERATIONS
K & S HELICOPTERS, INC.
KAHULUI AIRPORT
TAX MAP KEY: (2) 3-8-01: PORTION OF 217

MAUI

APPLICANT:

K & S Helicopters, Inc., a Hawai'i corporation, whose mailing address is
P.O. Box 5371, Kailua-Kona, Hawai'i 96745.

LEGAL REFERENCE:

Section 171-55, Hawai'i Revised Statutes.

LOCATION AND TAX MAP KEY:

Portion of Building No. 225, Air Commuter Terminal, Ground Level of Kahului Airport,
Kahului, Island of Maui, identified by Tax Map Key: 2nd Division, 3-8-01: Portion of
217.

AREAS:

Building/Room No. 225-104, containing an area of approximately 42 square feet,
as shown and delineated on the attached Exhibit A.

ZONING:

State Land Use District: Urban
County of Maui: Airport

ITEM M-2

BLNR – ISSUANCE OF A REVOCABLE PERMIT FOR COUNTER SPACE IN THE
COMMUTER TERMINAL FOR AIR CHARTER OPERATIONS
K & S HELICOPTERS, INC.

Page 2

LAND TITLE STATUS:

Section 5(a) lands of the Hawai'i Admission Act: Non-Ceded
DHHL 30% entitlement lands pursuant to Hawai'i Admission Act YES ___ NO X

CURRENT USE STATUS:

Land presently encumbered by Governor's Executive Order No. 2427, dated February 12, 1969, setting aside 1,268.938 acres designated as Kahului Airport to be under the control and management of the State of Hawai'i, Department of Transportation for public purposes.

CHARACTER OF USE:

K & S Helicopters, Inc. will use the space as a counter in the Commuter Terminal, as part of its air charter operations at Kahului Airport

COMMENCEMENT DATE:

Upon complete execution of the revocable permit.

MONTHLY RENTAL:

\$122.78 (\$100.10, as determined from the Department of Transportation, Airports Division schedule of rates and charges established by appraisal of Airports property statewide, plus \$16.38 for utilities and \$6.30 for maintenance).

SECURITY DEPOSIT:

\$368.34, or three (3) times the monthly rental in effect.

DCCA VERIFICATION:

Place of business registration confirmed:	YES <u>X</u>	NO ___
Registered business name confirmed:	YES <u>X</u>	NO ___
Good standing confirmed:	YES <u>X</u>	NO ___

BLNR – ISSUANCE OF A REVOCABLE PERMIT FOR COUNTER SPACE IN THE
COMMUTER TERMINAL FOR AIR CHARTER OPERATIONS
K & S HELICOPTERS, INC.

Page 3

CHAPTER 343, HRS - ENVIRONMENTAL ASSESSMENT:

The State of Hawaii, Department of Transportation, Airports Division (HDOT-A), has determined that the subject land area and use is covered by the Kahului Airport Terminal Complex Expansion Negative Declaration, published by the Environmental Quality Commission (EQC) in the September 8, 1981, issue of the EQC Bulletin. Accordingly, all relevant mitigation from the Negative Declaration and best management practices will be implemented to address the minimum impacts of this action.

REMARKS:

In accordance with Section 171-55, HRS, relating to Permits, the Department of Transportation proposes to issue a month-to-month revocable permit to K & S Helicopters, Inc. for counter space in the Commuter Terminal, as part of its air charter operations at Kahului Airport.

RECOMMENDATION:

That the Board authorize the Department of Transportation to issue a month-to-month revocable permit to K & S Helicopters, Inc., subject to: (1) terms and conditions herein outlined, which are by reference incorporated herein; and (2) such additional terms and conditions as may be prescribed by the Director of Transportation to best serve the interests of the State.

Respectfully submitted,



JADE T. BUTAY
Director of Transportation

APPROVED FOR SUBMITTAL:

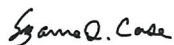

SUZANNE D. CASE
Chairperson
Board of Land and Natural Resources

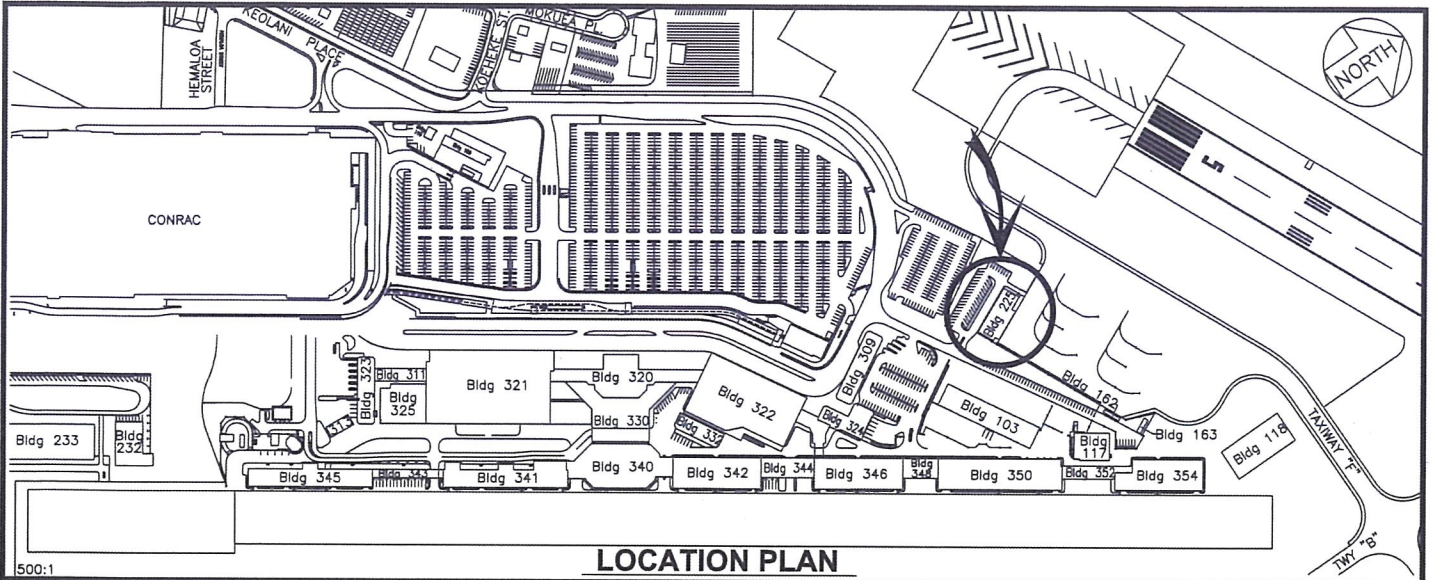

LOCATION PLAN

500:1

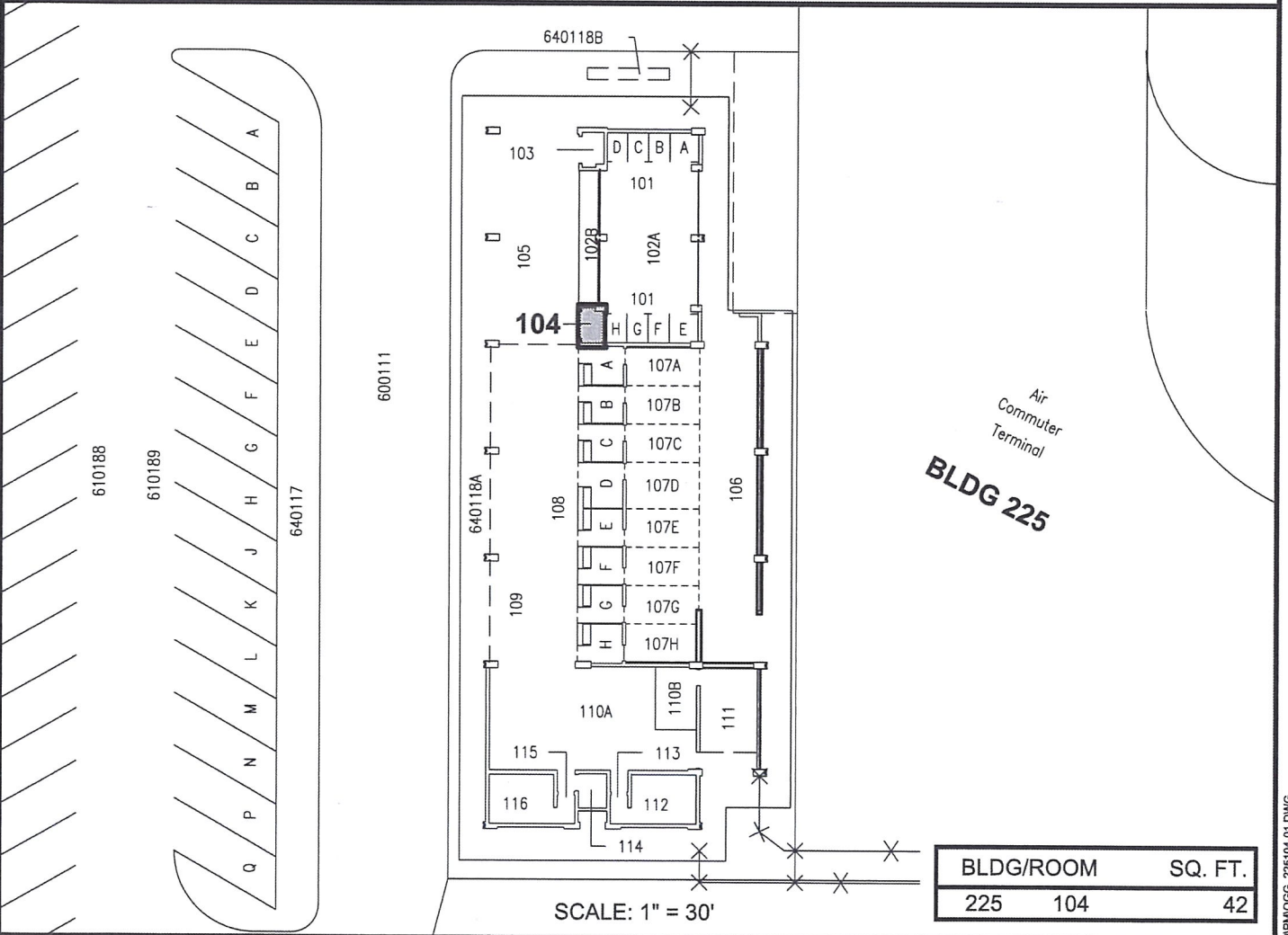

SCALE: 1" = 30'

DATE : MAY 2022

EXHIBIT: **A**



Airports Division

K & S HELICOPTER, INC.

**BUILDING 225
AIR COMMUTER TERMINAL
GROUND LEVEL**

**225104
PLAT B1,35**

KAHULUI AIRPORT