

DAVID Y. IGE
GOVERNOR



JADE T. BUTAY
DIRECTOR

Deputy Directors
ROSS M. HIGASHI
EDUARDO P. MANGLALLAN
EDWIN H. SNIFFEN

IN REPLY REFER TO:

STATE OF HAWAII
DEPARTMENT OF TRANSPORTATION
869 PUNCHBOWL STREET
HONOLULU, HAWAII 96813-5097

Board of Land and
Natural Resources
State of Hawai'i
Honolulu, Hawai'i

ISSUANCE OF A REVOCABLE PERMIT FOR COMMERCIAL
USE OF A T-HANGAR FOR STORAGE OF AIRCRAFT AND A MAINTENANCE
HANGAR AND AN END-ROOM FOR AN OFFICE
HELICOPTER CONSULTANTS OF MAUI, LLC
DBA BLUE HAWAIIAN HELICOPTERS
ELLISON ONIZUKA KONA INTERNATIONAL AIRPORT AT KEĀHOLE
TAX MAP KEY: (3) 7-3-43: PORTION OF 003 HAWAI'I

LEGAL REFERENCE:

Section 171-55, Hawai'i Revised Statutes (HRS).

APPLICANT:

Helicopter Consultants of Maui, LLC DBA Blue Hawaiian Helicopters (Blue Hawaiian)
whose business address is 1 Kahului Airport Road, Kahului, Hawai'i 96732.

LOCATION AND TAX MAP KEY:

Portion of Ellison Onizuka Kona International Airport at Keāhole (KOA), Kailua-Kona,
Island of Hawai'i, identified by Tax Map Key: 3rd Division, 7-3-43: Portion of 003.

AREAS:

Building/Room No. 422-107, containing an area of approximately 1,464 square feet, and
Building/Room No. 422-114, containing an area of approximately 515 square feet, as
shown and delineated on the attached Exhibit A.

ZONING:

State Land Use District: Urban & Conservation
County of Hawai'i: Industrial (MG-1a) and Open

ITEM M-5

BLNR – ISSUANCE OF A REVOCABLE PERMIT FOR COMMERCIAL USE OF A
T-HANGAR FOR STORAGE OF AIRCRAFT AND A MAINTENANCE HANGAR
AND AN END-ROOM FOR AN OFFICE
HELICOPTER CONSULTANTS OF MAUI, LLC DBA BLUE HAWAIIAN HELICOPTERS
Page 2

LAND TITLE STATUS:

Section 5(a) lands of the Hawai'i Admission Act: Ceded
DHHL 30% entitlement lands pursuant to Hawai'i Admission Act YES ___ NO X

CURRENT USE STATUS:

Land presently encumbered by Governor's Executive Order No. 3074, dated August 20, 1981, setting aside 4,204.10 acres designated as KOA under the control and management of the State of Hawai'i, Department of Transportation, Airports Division for Airport Purposes.

CHARACTER OF USE:

Blue Hawaiian will use the T-hangar for storage of aircraft (2014 Airbus EC130 T2, Tail No. N11NQ) and a maintenance hangar in support of its commercial helicopter tour operation at KOA.

Blue Hawaiian will use the end-room as an office in support of its commercial helicopter tour operation at KOA.

COMMENCEMENT DATE:

Upon complete execution of the revocable permit.

MONTHLY RENTAL:

\$2,028.80 (as determined from the Appraisal Report for the Estimate of Annual, Fair Market Lease Rental Values of T-Hangars and Sprung Structures, Ellison Onizuka Kona International Airport at Keāhole, prepared by ACM Consultants, Inc., dated 3/15/21).

SECURITY DEPOSIT:

\$6,086.40, or three (3) times the monthly rental in effect.

DCCA VERIFICATION:

Place of business registration confirmed:	YES <u>X</u>	NO _____
Registered business name confirmed:	YES <u>X</u>	NO _____
Good standing confirmed:	YES <u>X</u>	NO _____

CHAPTER 343, HRS - ENVIRONMENTAL ASSESSMENT:

The State of Hawai'i, Department of Transportation, Airports Division, has determined the subject land areas are covered by the Final Environmental Assessment (EA)/Finding of No Significant Impact (FONSI), Airfield, Terminal, and Facility Improvements for the Kona International Airport at Keāhole, published by the Office of Environmental Quality Control (OEQC) in the March 23, 2013, issue of The Environmental Notice. Accordingly, all relevant mitigation from the EA and best management practices will be implemented to address the minimum impacts of this action.

REMARKS:

In accordance with Section 171-55 HRS, relating to Permits, the Department of Transportation proposes to issue a month-to-month revocable permit to Blue Hawaiian for a T-Hangar for storage of aircraft and a maintenance hangar, and an end-room for an office, in support of its commercial helicopter tour operation at KOA.

RECOMMENDATION:

That the Board authorize the Department of Transportation to issue a month-to-month revocable permit to Blue Hawaiian, subject to: (1) terms and conditions herein outlined, which are by reference incorporated herein; and (2) such additional terms and conditions as may be prescribed by the Director of Transportation to best serve the interests of the State.

Respectfully submitted,

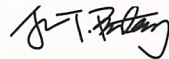

JADE T. BUTAY
Director of Transportation

APPROVED FOR SUBMITTAL:

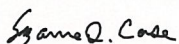

SUZANNE D. CASE
Chairperson
Board of Land and Natural Resources

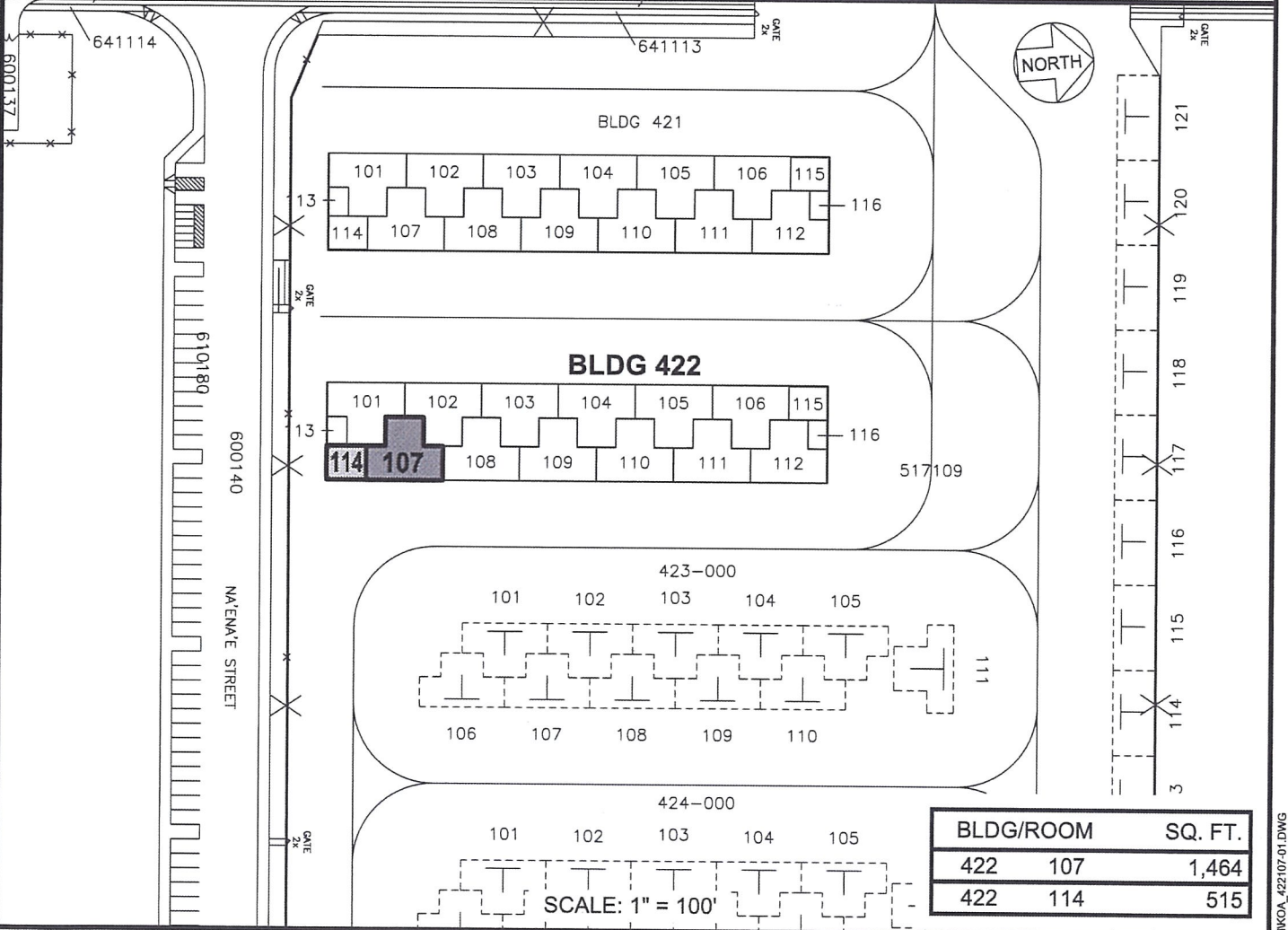
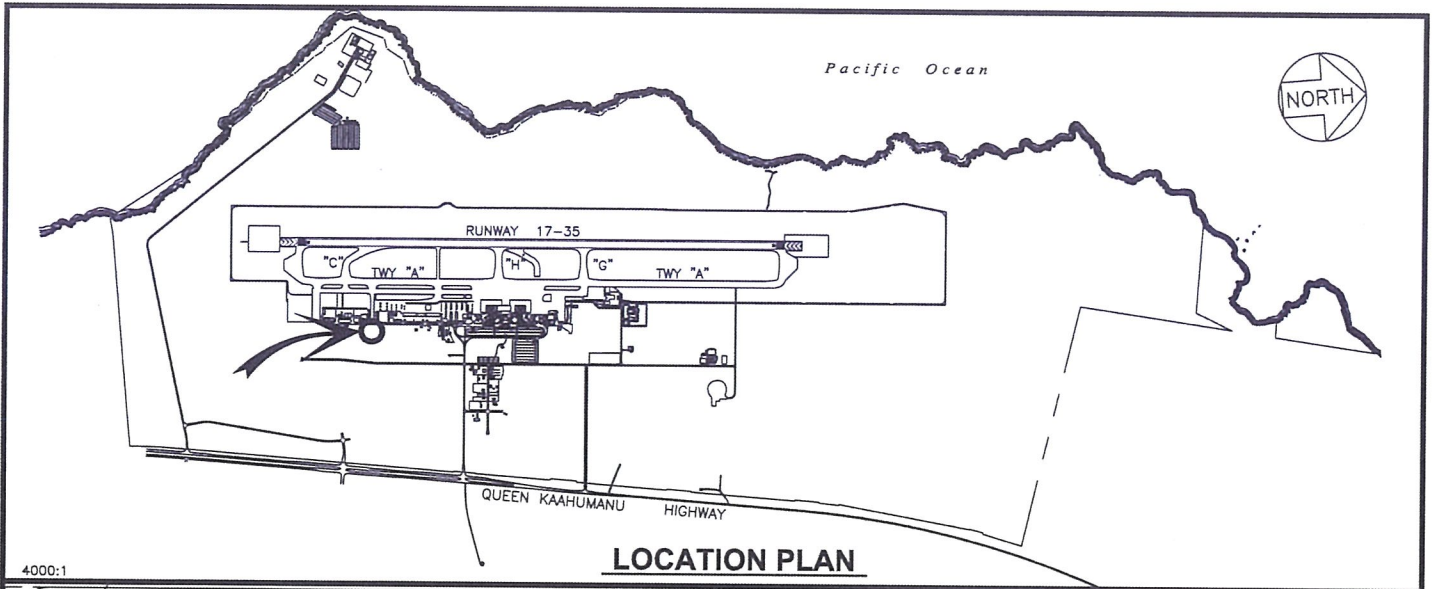

RP-9302	DATE : MAY 2022	EXHIBIT: A
<p>DEPARTMENT OF TRANSPORTATION STATE OF HAWAII Airports Division</p>	HELICOPTER CONSULTANTS OF MAUI LLC DBA BLUE HAWAIIAN HELICOPTERS	TIE-DOWNS
		422107 422414
		PLAT 60

ELLISON ONIZUKA KONA INTERNATIONAL AIRPORT AT KEAHOLE