

DAVID Y. IGE
GOVERNOR



STATE OF HAWAII
DEPARTMENT OF TRANSPORTATION
869 PUNCHBOWL STREET
HONOLULU, HAWAII 96813-5097

JADE T. BUTAY
DIRECTOR

Deputy Directors
ROSS M. HIGASHI
EDUARDO P. MANGALLAN
DAVID J. RODRIGUEZ
EDWIN H. SNIFFEN

IN REPLY REFER TO:

Board of Land and
Natural Resources
State of Hawai'i
Honolulu, Hawai'i

ISSUANCE OF A REVOCABLE PERMIT FOR BOOTH SPACE
MOLOKAI ARTS CENTER, INC.
MOLOKA'I AIRPORT
TAX MAP KEY: (2) 5-2-004: PORTION OF 106

MAUI

LEGAL REFERENCE:

Section 171-55, Hawai'i Revised Statutes (HRS).

APPLICANT:

Molokai Arts Center, Inc. (MAC), whose mailing address is P. O. Box 116, Kualapuu,
Hawai'i 96757-0116.

LOCATION AND TAX MAP KEY:

Portion of Moloka'i Airport (MKK), Hoolehua, Island of Moloka'i, County of Maui,
identified by Tax Map Key: 2nd Division, 5-2-004: Portion of 106.

AREA:

Building/Room No. 301-133A, containing an area of approximately 42 square feet,
as shown and delineated on the attached Exhibit A.

ZONING:

State Land Use District: Agricultural
County of Maui: Interim Zoning Provisions of the Maui County Zoning Code

BLNR – ISSUANCE OF A REVOCABLE PERMIT FOR BOOTH SPACE
MOLOKAI ARTS CENTER, INC.

Page 2

LAND TITLE STATUS:

Section 5(a) lands of the Hawai'i Admission Act: Ceded
DHHL 30% entitlement lands pursuant to Hawai'i Admission Act YES ___ NO X

CURRENT USE STATUS:

Land presently encumbered by Governor's Executive Order No. 1611, dated February 1, 1954, setting aside 10.321 acres, being a portion of Moloka'i Airport under the control and management of the Hawaii Aeronautics Commission (subsequently transferred to the Department of Transportation) for Public Purposes.

CHARACTER OF USE:

MAC will use the booth to inform residents and visitors about their organization by providing brochures and posting class schedules/workshops, to support their non-profit arts education organization on Moloka'i.

COMMENCEMENT DATE:

Upon execution of the revocable permit.

MONTHLY RENTAL:

\$88.20 (as determined from the Airports Division Schedule of Rates and Charges for Airport properties statewide).

SECURITY DEPOSIT:

\$264.60, or three (3) times the monthly rental in effect.

DCCA VERIFICATION:

Place of business registration confirmed:	YES <u>X</u>	NO _____
Registered business name confirmed:	YES <u>X</u>	NO _____
Good standing confirmed:	YES <u>X</u>	NO _____

CHAPTER 343, HRS - ENVIRONMENTAL ASSESSMENT:

The State of Hawaii, Department of Transportation, Airports Division (HDOT-A), has determined that the subject areas are covered by the Moloka'i Airport Improvements Environmental Assessment (EA), published by the Environmental Quality Commission (EQC) in the December 23, 1981 issue of the EQC Bulletin. Accordingly, all relevant

BLNR – ISSUANCE OF A REVOCABLE PERMIT FOR BOOTH SPACE
MOLOKAI ARTS CENTER, INC.

Page 3

mitigation from the EA and best management practices will be implemented to address the minimum impacts of this action.

REMARKS:

In accordance with Section 171-55, HRS, relating to Permits, the Department of Transportation proposes to issue a month-to-month revocable permit to MAC for booth space, which will be used to inform residents and visitors about their organization by providing brochures and posting class schedules/workshops, to support their non-profit arts education organization on Moloka'i.

RECOMMENDATION:

Based on this submittal, and testimony and facts presented, the Department of Transportation recommends the Board finds that approving the issuance of a month-to-month Revocable Permit to MAC, including its conditions and rent, will serve the best interests of the State.

Respectfully submitted,

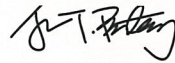

JADE T. BUTAY
Director of Transportation

APPROVED FOR SUBMITTAL:

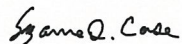

SUZANNE D. CASE
Chairperson
Board of Land and Natural Resources

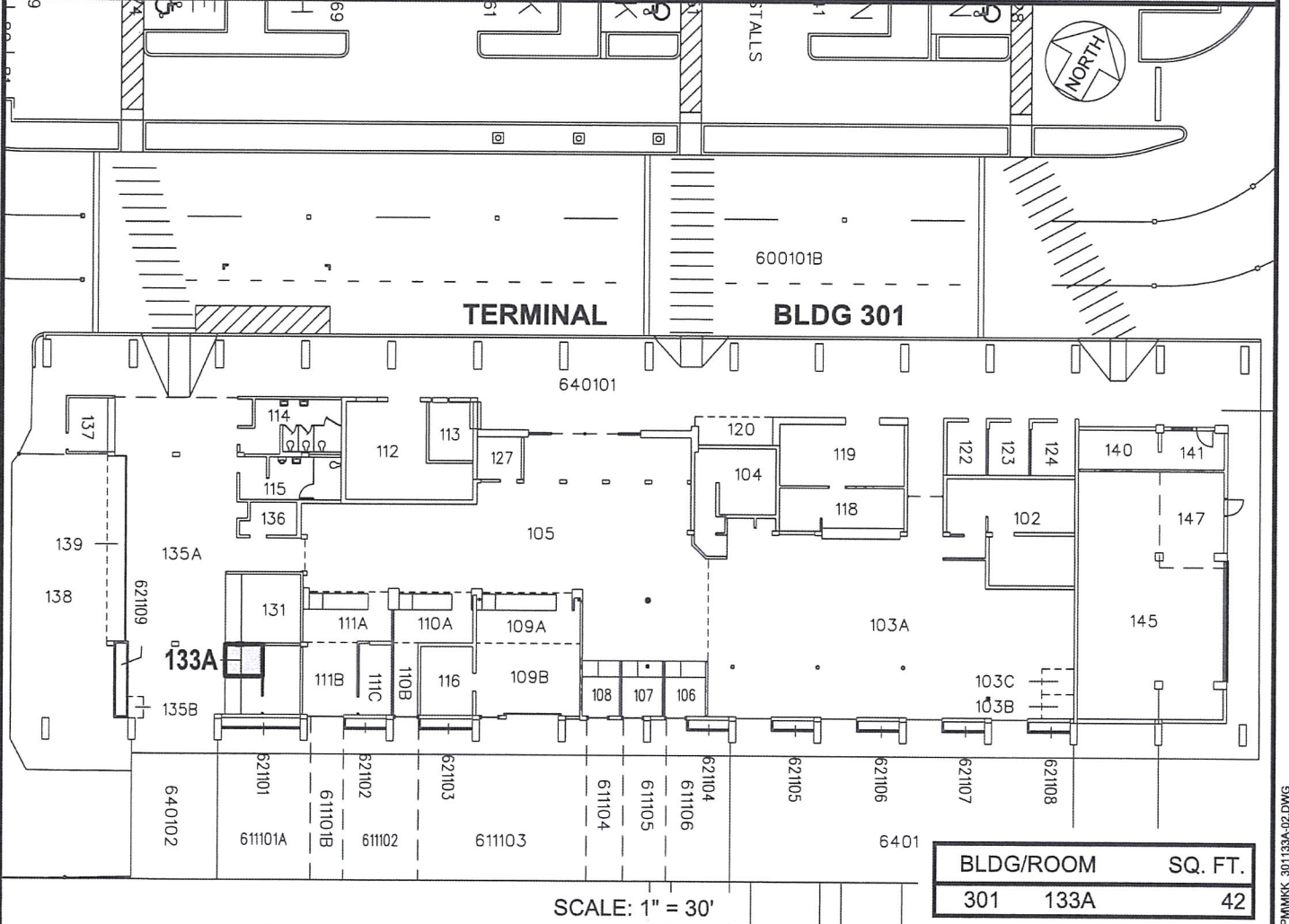
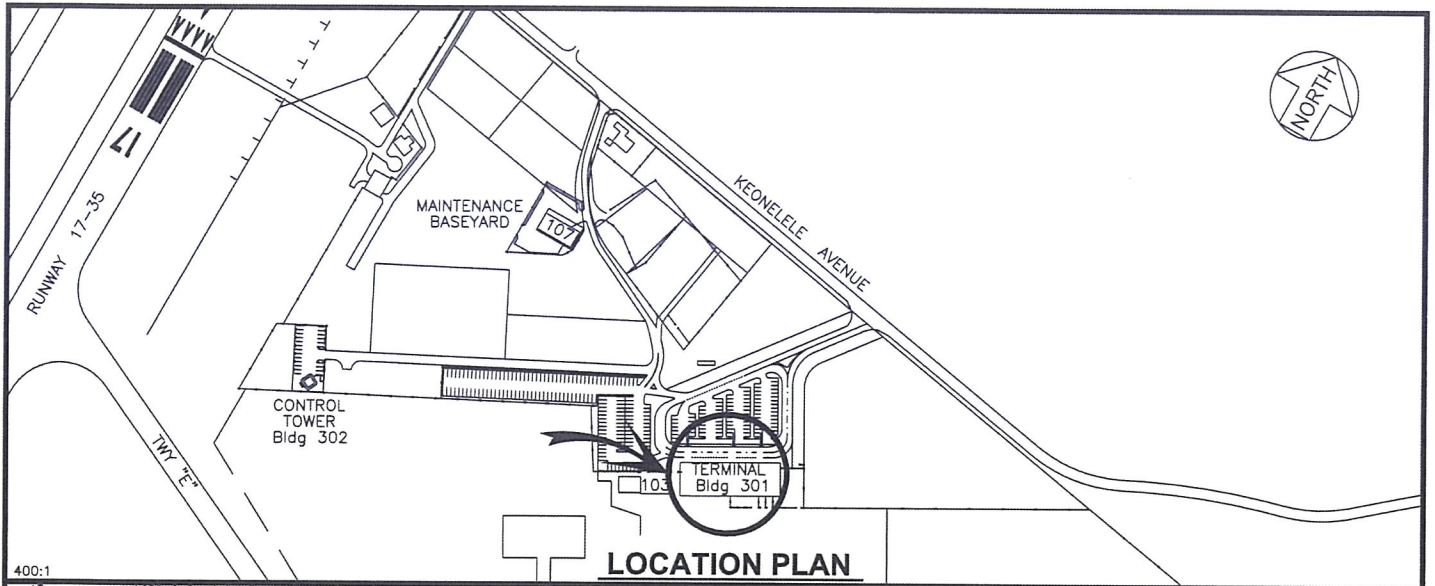

BLDG/ROOM	SQ. FT.
301 133A	42

SCALE: 1" = 30'

RP-9325	DATE : AUGUST 2022	EXHIBIT: A
 Airports Division	MOLOKAI ARTS CENTER, INC.	BUILDING 301 TERMINAL BLDG GROUND FLOOR
		301133A PLAT A1,33

MOLOKAI AIRPORT

N:\AIRPORTS\MK\MOLOKAI\CADD\PM\MKK_301133A-02.DWG