

DAVID Y. IGE  
GOVERNOR



STATE OF HAWAII  
DEPARTMENT OF TRANSPORTATION  
869 PUNCHBOWL STREET  
HONOLULU, HAWAII 96813-5097

JADE T. BUTAY  
DIRECTOR

Deputy Directors  
ROSS M. HIGASHI  
EDUARDO P. MANGLALLAN  
DAVID J. RODRIGUEZ  
EDWIN H. SNIFFEN

IN REPLY REFER TO:

Board of Land and  
Natural Resources  
State of Hawai'i  
Honolulu, Hawai'i

ISSUANCE OF A REVOCABLE PERMIT FOR MAIN TERMINAL  
OFFICE AND EQUIPMENT, PARTS AND SUPPLY STORAGE  
PEGASUS AVIATION SERVICES, LLC  
KAHULUI AIRPORT  
TAX MAP KEY: (2) 3-8-01: PORTION OF 236

MAUI

LEGAL REFERENCE:

Section 171-55, Hawai'i Revised Statutes (HRS).

APPLICANT:

Pegasus Aviation Services, LLC (Pegasus), whose mailing address is  
3901 Old International Airport Road, Anchorage, Alaska 99502.

LOCATION AND TAX MAP KEY:

Portion of Kahului Airport (OGG), Kahului, Island of Maui, identified by  
Tax Map Key: 2nd Division, 3-8-01: Portion of 236.

AREA:

Building/Room No. 346-121A, containing an area of approximately 694 square feet, as  
shown and delineated on the attached Exhibit A.

ZONING:

State Land Use District: Urban  
County of Maui: Airport

**ITEM M-17**

BLNR – ISSUANCE OF A REVOCABLE PERMIT FOR MAIN TERMINAL OFFICE AND EQUIPMENT, PARTS AND SUPPLY STORAGE  
PEGASUS AVIATION SERVICES, LLC

Page 2

LAND TITLE STATUS:

Section 5(a) lands of the Hawai‘i Admission Act: Non-Ceded  
DHHL 30% entitlement lands pursuant to Hawai‘i Admission Act YES \_\_\_ NO X

CURRENT USE STATUS:

Land presently encumbered by Governor’s Executive Order No. 2427, dated February 12, 1969, setting aside 1,268.938 acres designated as Kahului Airport to be under the control and management of the State of Hawai‘i, Department of Transportation for public purposes.

CHARACTER OF USE:

Pegasus will use the space for an office and equipment, parts and supply storage as part of its aviation services operation at OGG.

COMMENCEMENT DATE:

Upon execution of the revocable permit.

MONTHLY RENTAL:

\$2,387.36 (\$1,839.10 as determined from the DOTA schedule of rates and charges established by appraisal of Airports property statewide plus \$173.50 for air conditioning, \$270.66 for utilities and \$104.10 for maintenance).

SECURITY DEPOSIT:

\$7,162.08, or three (3) times the monthly rental in effect.

DCCA VERIFICATION:

Place of business registration confirmed:	YES <u>X</u>	NO ___
Registered business name confirmed:	YES <u>X</u>	NO ___
Good standing confirmed:	YES <u>X</u>	NO ___

CHAPTER 343, HRS - ENVIRONMENTAL ASSESSMENT:

The State of Hawai‘i, Department of Transportation, Airports Division, has determined that the subject land area and use is covered by the Kahului Airport Terminal Complex

BLNR – ISSUANCE OF A REVOCABLE PERMIT FOR MAIN TERMINAL OFFICE AND  
EQUIPMENT, PARTS AND SUPPLY STORAGE  
PEGASUS AVIATION SERVICES, LLC  
Page 3

Expansion Negative Declaration, published by the Environmental Quality Commission (EQC) in the September 8, 1981, issue of the EQC Bulletin. Accordingly, all relevant mitigation from the Negative Declaration and best management practices will be implemented to address the minimum impacts of this action.

REMARKS:

In accordance with Section 171-55, HRS, relating to Permits, the Department of Transportation proposes to issue a month-to-month revocable permit to Pegasus for an office and equipment, parts and supply storage as part of its aviation services operation at OGG.

RECOMMENDATION:

Based on this submittal, and testimony and facts presented, the Department of Transportation recommends the Board finds that approving the issuance of a month-to-month Revocable Permit to Pegasus, including its conditions and rent, will serve the best interests of the State.

Respectfully submitted,

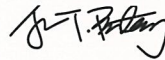

JADE T. BUTAY  
Director of Transportation

APPROVED FOR SUBMITTAL:

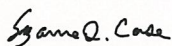

SUZANNE D. CASE  
Chairperson  
Board of Land and Natural Resources

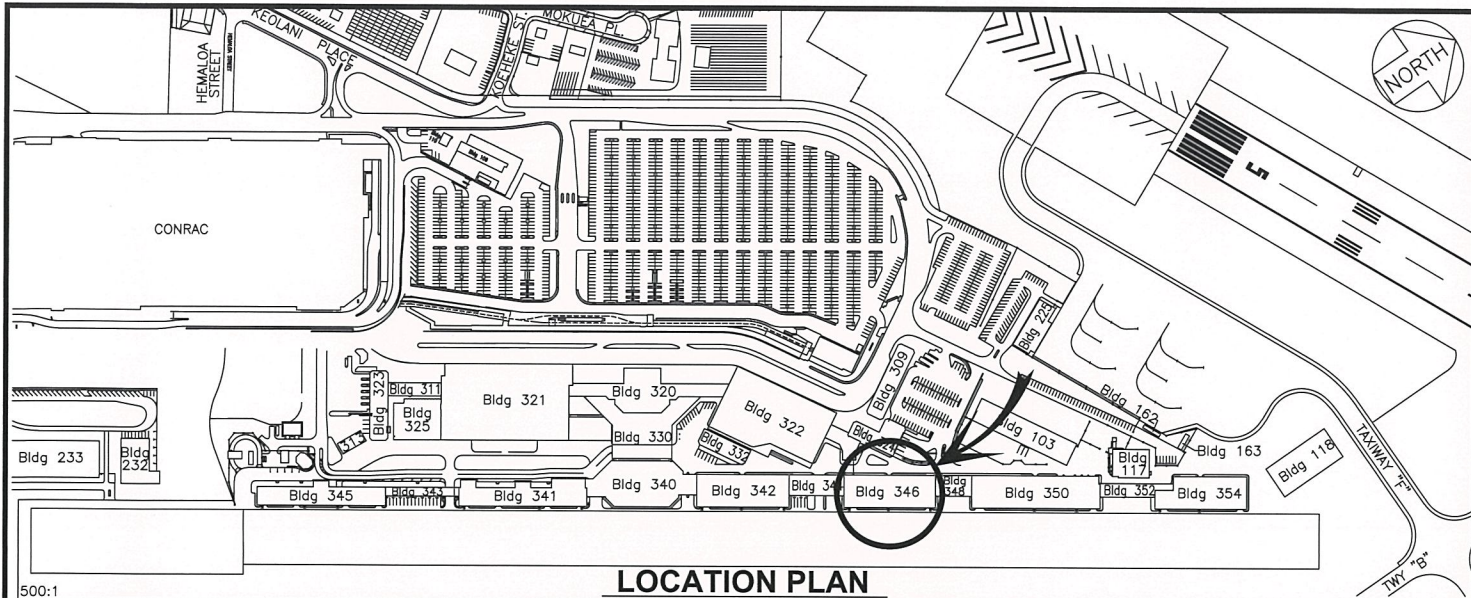

**LOCATION PLAN**

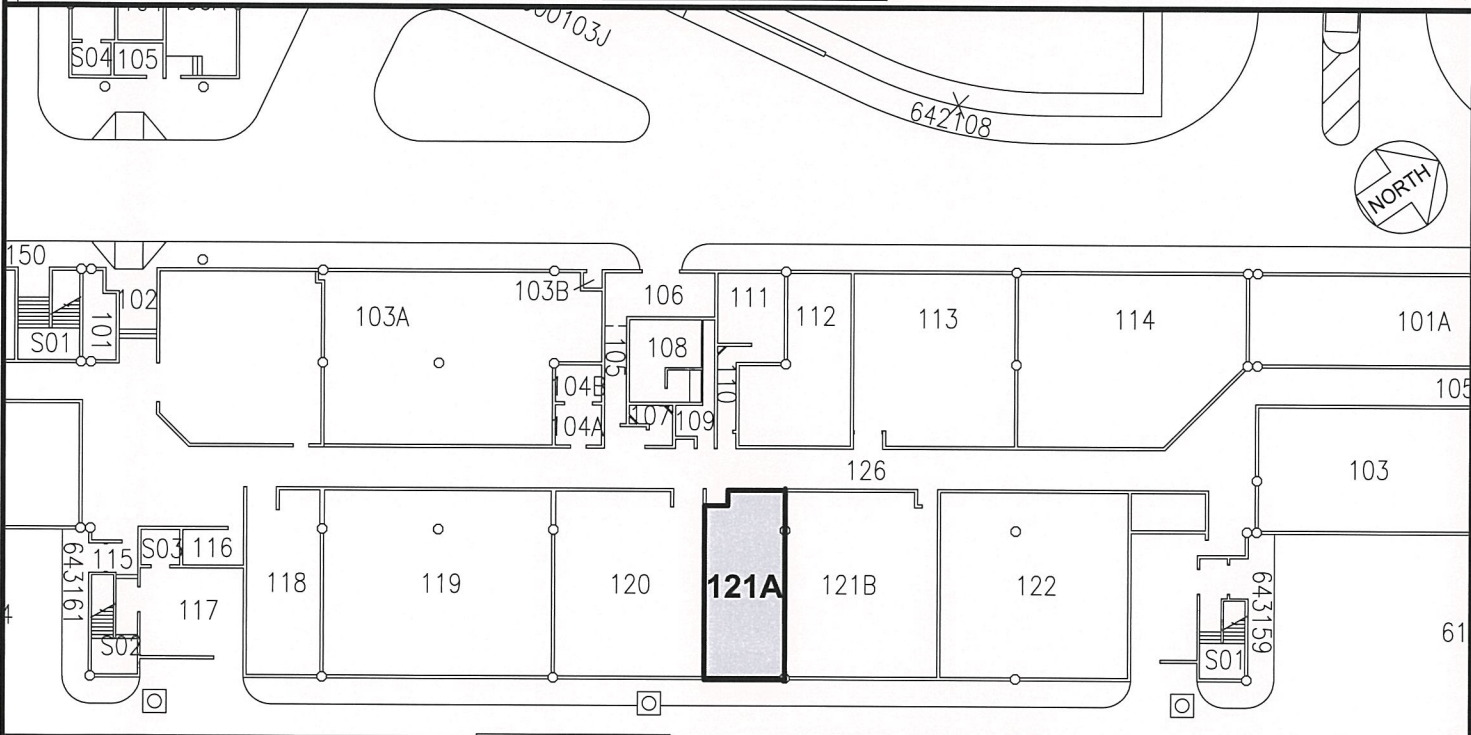

**BUILDING 346  
HOLDING ROOM D**

SCALE: 1" = 40'

BLDG/ROOM	SQ. FT.
346 121A	694

RP-9318 Airports Division	PEGASUS AVIATION SERVICES, LLC	DATE : SEPT 2022  BLDG 346 HOLDING ROOM D SECOND LEVEL	EXHIBIT: <b>A</b>  346121A PLAT A1
------------------------------	-----------------------------------	--	---

**KAHULUI AIRPORT**

N:\AIRPORTS\IOGG\_KAHULUI\CAD\PMO\GG\_346121A-01.DWG