

DAVID Y. IGE
GOVERNOR



JADE T. BUTAY
DIRECTOR

Deputy Directors
ROSS M. HIGASHI
EDUARDO P. MANGLALLAN
DAVID J. RODRIGUEZ
EDWIN H. SNIFFEN

STATE OF HAWAII
DEPARTMENT OF TRANSPORTATION
869 PUNCHBOWL STREET
Honolulu, Hawaii 96813-5097

IN REPLY REFER TO:

Board of Land and
Natural Resources
State of Hawai'i
Honolulu, Hawai'i

ISSUANCE OF A REVOCABLE PERMIT FOR TERMINAL
SPACE FOR CUSTOMER CHECK-IN AND CHECK-OUT DESK
MAUI SKYDIVING LLC
HĀNA AIRPORT
TAX MAP KEY: (2) 1-3-03: PORTION OF 32

MAUI

LEGAL REFERENCE:

Section 171-55, Hawai'i Revised Statutes (HRS).

APPLICANT:

Maui Skydiving LLC (MSL) whose business address is 1727 Haiku Road, Haiku,
Hawai'i 96708.

LOCATION AND TAX MAP KEY:

Portion of Hāna Airport (HNM), Island of Maui, identified by
Tax Map Key: 2nd Division, 1-3-03: Portion of 32.

AREA:

Building/Room No. 201-101A, containing an area of approximately 34 square feet, as
shown and delineated on the attached Exhibit A.

ZONING:

State Land Use District: Agricultural
County of Maui: Airport

ITEM M-18

BLNR – ISSUANCE OF A REVOCABLE PERMIT FOR TERMINAL SPACE FOR CUSTOMER CHECK-IN AND CHECK-OUT DESK, MAUI SKYDIVING LLC

Page 2

LAND TITLE STATUS:

Section 5(a) lands of the Hawai‘i Admission Act: Ceded
DHHL 30% entitlement lands pursuant to Hawai‘i Admission Act YES___ NO X

CURRENT USE STATUS:

Land presently encumbered by Governor’s Executive Order No. 2992, dated December 12, 1979, setting aside 144.345 acres designated as Hāna Airport to be under the control and management of the State of Hawai‘i, Department of Transportation, Airports Division for Airport Purposes.

CHARACTER OF USE:

MSL will use the space for customer check-in and check-out desk to support its skydiving operation at HNM.

COMMENCEMENT DATE:

Upon execution of the revocable permit.

MONTHLY RENTAL:

\$48.11 (\$29.75, as determined from the Department of Transportation, Airports Division schedule of rates and charges established by appraisal of Airports property statewide plus \$13.26 for utilities and \$5.10 for maintenance).

SECURITY DEPOSIT:

\$144.33, or three (3) times the monthly rental in effect.

DCCA VERIFICATION:

Place of business registration confirmed: YES X NO _____
Registered business name confirmed: YES X NO _____
Good standing confirmed: YES X NO _____

CHAPTER 343, HRS - ENVIRONMENTAL ASSESSMENT:

The State of Hawai‘i, Department of Transportation, Airports Division has determined that the impacts of this action are de minimis and exempt, pursuant to Department of Transportation, Comprehensive Exemption List, Type 8, Part 1, 8(h), concurred to by the Environmental Advisory Council on February 1, 2022.

BLNR – ISSUANCE OF A REVOCABLE PERMIT FOR TERMINAL SPACE FOR
CUSTOMER CHECK-IN AND CHECK-OUT DESK, MAUI SKYDIVING LLC

Page 3

REMARKS:

In accordance with Section 171-55, HRS, relating to Permits, the Department of Transportation proposes to issue a month-to-month revocable permit to MSL for terminal space for customer check-in and check-out desk to support its skydiving operation at HNM.

RECOMMENDATION:

Based on this submittal, and testimony and facts presented, the Department of Transportation recommends the Board finds that approving the issuance of a month-to-month Parking Permit to MSL, including its conditions and rent, will serve the best interests of the State.

Respectfully submitted,



JADE T. BUTAY
Director of Transportation

APPROVED FOR SUBMITTAL:

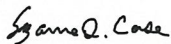

SUZANNE D. CASE
Chairperson
Board of Land and Natural Resources

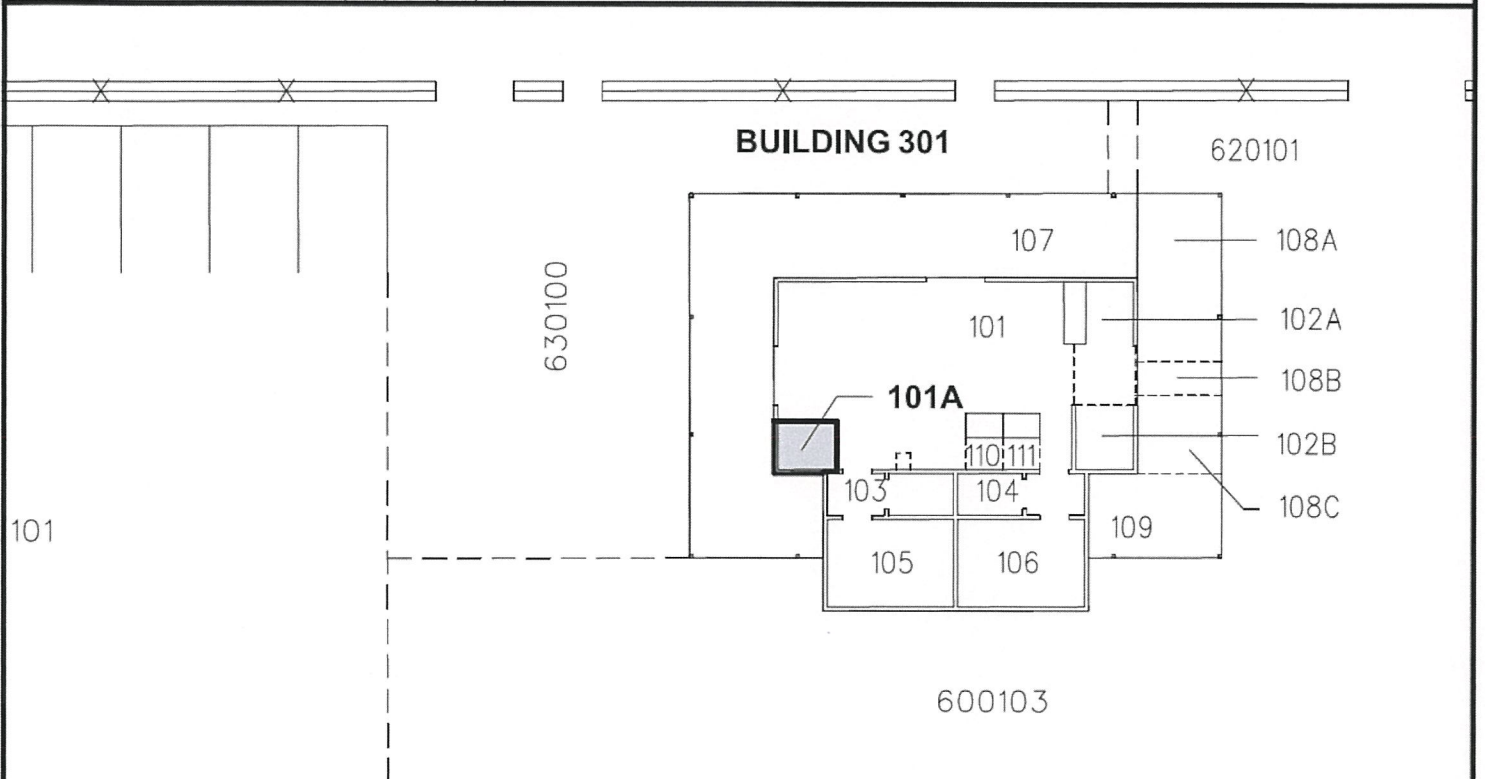
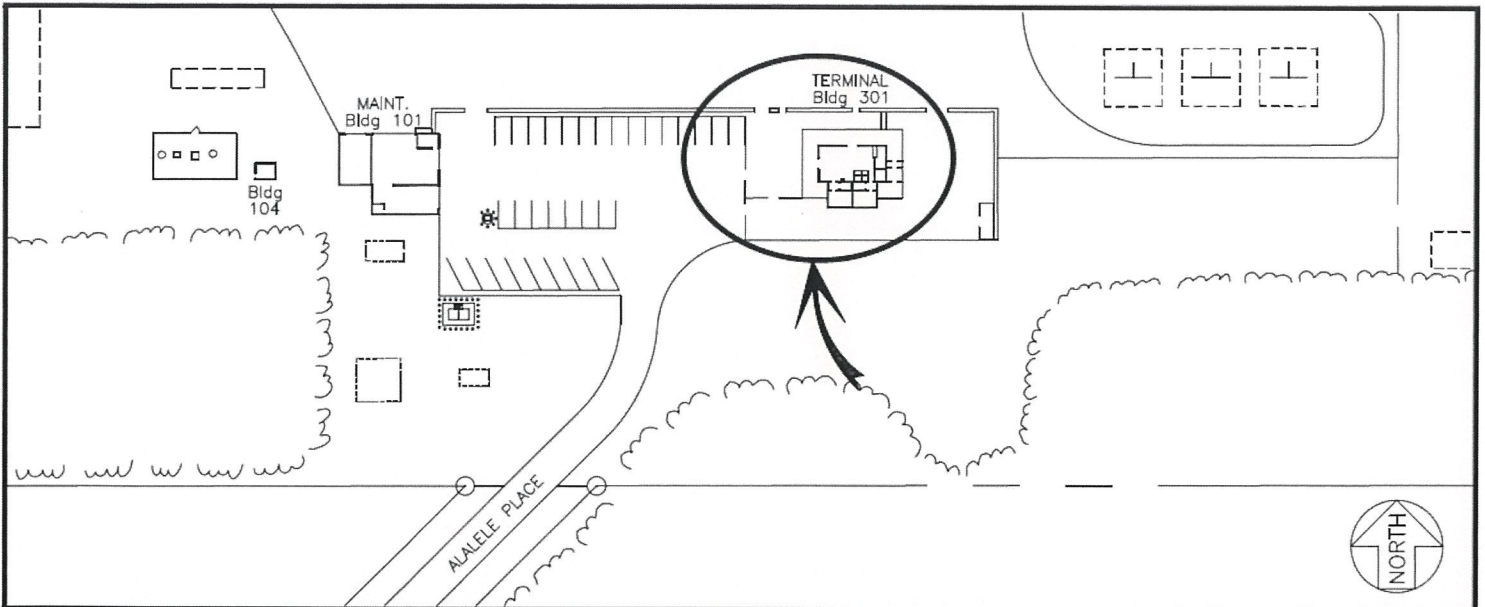

BLDG/ROOM	SQ. FT.
301 101A	34

SCALE: 1" = 30'

DATE : NOVEMBER 2019

EXHIBIT: **A**



MAUI SKYDIVING, LLC

BUILDING 301
TERMINAL BUILDING
GROUND LEVEL

301101A
PLAT A1, 33

HANA AIRPORT

N:\AIRPORTS\HNM_Hana\CAD\PM\hnm_301101A_draft.dwg