

DAVID Y. IGE
GOVERNOR



STATE OF HAWAII
DEPARTMENT OF TRANSPORTATION
869 PUNCHBOWL STREET
HONOLULU, HAWAII 96813-5097

JADE T. BUTAY
DIRECTOR

Deputy Directors
ROSS M. HIGASHI
EDUARDO P. MANGLALLAN
EDWIN H. SNIFFEN

IN REPLY REFER TO:

Board of Land and
Natural Resources
State of Hawai'i
Honolulu, Hawai'i

ISSUANCE OF A REVOCABLE PERMIT FOR
GROUND SERVICE EQUIPMENT STORAGE
SOUTHWEST AIRLINES CO.
LĪHU'E AIRPORT
TAX MAP KEY: (4) 3-5-001: PORTION OF 008

KAUA'I

LEGAL REFERENCE:

Section 171-55, Hawai'i Revised Statutes (HRS).

APPLICANT:

Southwest Airlines Co. (SWA), whose business address is 2702 Love Field Drive, Dallas, Texas 75235.

LOCATION AND TAX MAP KEY:

Portion of Līhu'e Airport (LIH), Līhu'e, Island of Kaua'i, State of Hawai'i, identified by Tax Map Key: 4th Division, 3-5-001: Portion of 008.

AREA:

Area/Space No. 630-104, containing an area of approximately 8,000 square feet of improved, unpaved land, as shown and delineated on the attached Exhibit A.

ZONING:

State Land Use District: Urban
County of Kaua'i: Industrial General/Special Treatment-Public Use (IG/ST-P)

ITEM M-8

BLNR – ISSUANCE OF A REVOCABLE PERMIT FOR GROUND SERVICE EQUIPMENT STORAGE, SOUTHWEST AIRLINES CO.

Page 2

LAND TITLE STATUS:

Section 5(a) lands of the Hawai'i Admission Act: Non-Ceded
DHHL 30% entitlement lands pursuant to Hawai'i Admission Act YES ___ NO X

CURRENT USE STATUS:

Land presently encumbered by Governor's Executive Order No. 4614, dated October 28, 2019, setting aside 883.583 acres designated as Līhu'e Airport to be under the control and management of the State of Hawai'i, Department of Transportation for Airport Purposes.

CHARACTER OF USE:

SWA will use the improved, paved land for ground service equipment storage, in support of its Signatory Airline Carrier Operation at LIH.

COMMENCEMENT DATE:

Upon execution of the revocable permit.

MONTHLY RENTAL:

\$1,546.67 (based on a rate of \$2.32 per square foot per annum for improved, unpaved land, as determined from the DOTA schedule of rates and charges established by appraisal of Airports property statewide).

SECURITY DEPOSIT:

\$4,640.01, or three (3) times the monthly rental in effect.

DCCA VERIFICATION:

Place of business registration confirmed: YES X NO ___
Registered business name confirmed: YES X NO ___
Good standing confirmed: YES X NO ___

CHAPTER 343, HRS - ENVIRONMENTAL ASSESSMENT:

The State of Hawai'i, Department of Transportation, Airports Division, has determined that the environmental impacts of the proposed tenant use for the subject areas are covered by the Līhu'e Airport Master Plan Environmental Impact Statement (EIS), published by the Environmental Quality Commission (EQC) in the August 8, 1976 and August 23, 1976, issues of EQC Bulletin and accepted by the Governor on April 26, 1977.

BLNR – ISSUANCE OF A REVOCABLE PERMIT FOR GROUND SERVICE EQUIPMENT STORAGE, SOUTHWEST AIRLINES CO.

Page 3

REMARKS:

In accordance with Section 171-55, HRS, relating to Permits, the Department of Transportation proposes to issue a month-to-month revocable permit to SWA for ground service equipment storage, in support of its Signatory Airline Carrier Operation at LIH.

RECOMMENDATION:

That the Board authorize the Department of Transportation to issue a month-to-month revocable permit to SWA, subject to: (1) terms and conditions herein outlined, which are by reference incorporated herein; and (2) such additional terms and conditions as may be prescribed by the Director of Transportation to best serve the interests of the State.

Respectfully submitted,



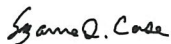

JADE T. BUTAY
Director of Transportation

APPROVED FOR SUBMITTAL:

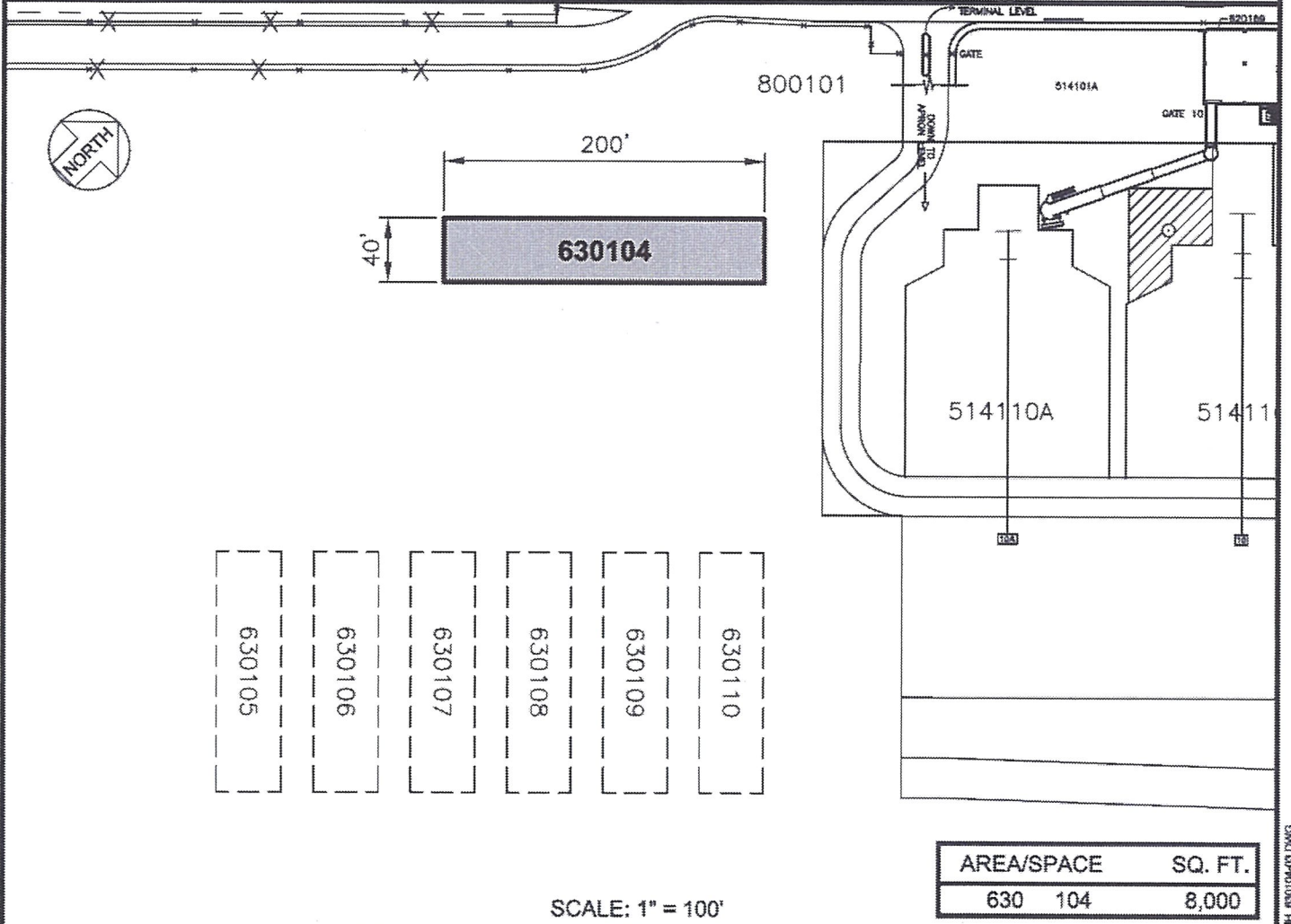
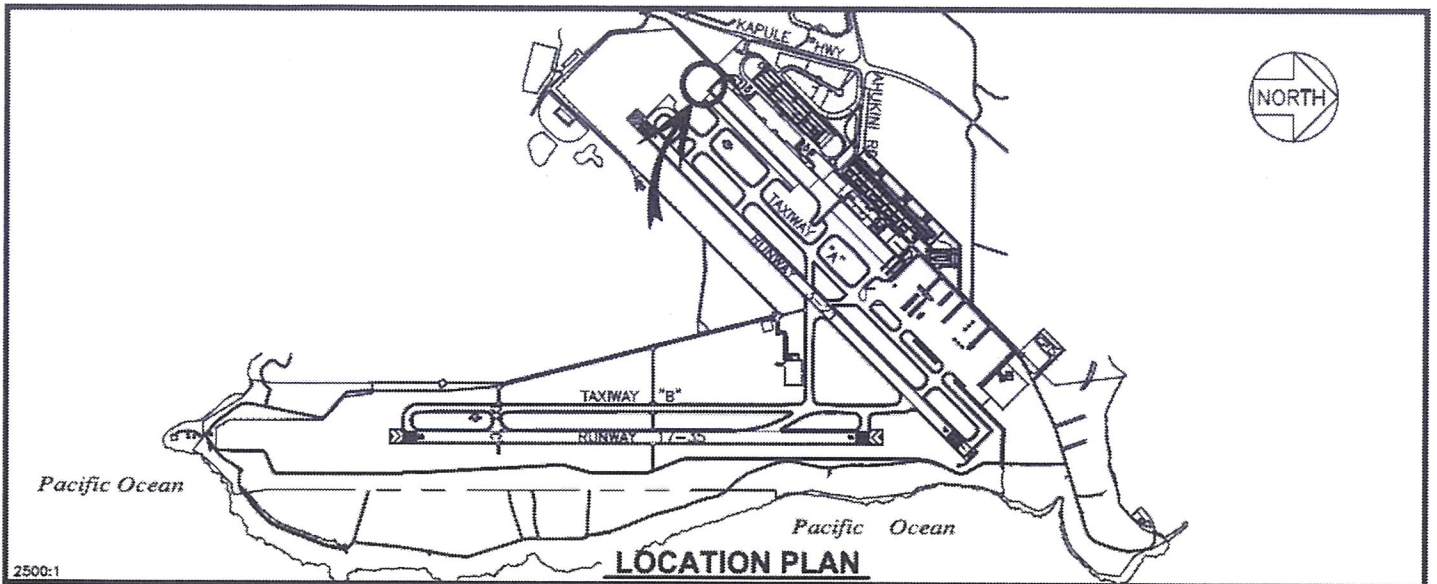

SUZANNE D. CASE
Chairperson
Board of Land and Natural Resources



RP-9308	DATE : AUGUST 2022	EXHIBIT: A
 Airports Division	SOUTHWEST AIRLINES CO.	GSE PARKING
		630104 PLAT C1,44

LIHUE AIRPORT

N:\AIRPORTS\LIHUE\CAD\PP\W\11_050104-03.DWG