

DAVID Y. IGE  
GOVERNOR



STATE OF HAWAII  
DEPARTMENT OF TRANSPORTATION  
869 PUNCHBOWL STREET  
HONOLULU, HAWAII 96813-5097

JADE T. BUTAY  
DIRECTOR

Deputy Directors  
ROSS M. HIGASHI  
EDUARDO P. MANGLALLAN  
DAVID J. RODRIGUEZ  
EDWIN H. SNIFFEN

IN REPLY REFER TO:

Board of Land and  
Natural Resources  
State of Hawai'i  
Honolulu, Hawai'i

ISSUANCE OF A REVOCABLE PERMIT FOR STORAGE SPACE FOR AIRCRAFT  
CABIN SUPPLIES AND A TRUCK LOADING DOCK  
SOUTHWEST AIRLINES CO.  
KAHULUI AIRPORT  
TAX MAP KEY: (2) 3-8-01: PORTION OF 263

MAUI

LEGAL REFERENCE:

Section 171-55, Hawai'i Revised Statutes (HRS).

APPLICANT:

Southwest Airlines Co. (SWA), whose business address is 2702 Love Field Drive, Dallas,  
Texas 75235.

LOCATION AND TAX MAP KEY:

Portion of Kahului Airport (OGG), Kahului, Island of Maui, identified by  
Tax Map Key: 2nd Division, 3-8-01: Portion of 263.

AREA:

Building/Room No. 354-101B, containing an area of approximately 780 square feet, and  
Area/Space No. 354-101C, containing an area of approximately 198 square feet of  
improved, paved land, as shown, and delineated on the attached Exhibit A.

ZONING:

State Land Use District: Urban  
County of Maui: Airport

**ITEM M-10**

BLNR – ISSUANCE OF A REVOCABLE PERMIT FOR STORAGE SPACE FOR  
AIRCRAFT CABIN SUPPLIES AND A TRUCK LOADING DOCK  
SOUTHWEST AIRLINES CO.

Page 2

LAND TITLE STATUS:

Section 5(a) lands of the Hawai'i Admission Act: Non-Ceded  
DHHL 30% entitlement lands pursuant to Hawai'i Admission Act YES \_\_\_ NO X

CURRENT USE STATUS:

Land presently encumbered by Governor's Executive Order No. 2427, dated February 12, 1969, setting aside 1,268.938 acres designated as Kahului Airport to be under the control and management of the State of Hawai'i, Department of Transportation for public purposes.

CHARACTER OF USE:

SWA will use the space to store aircraft cabin supplies and a truck loading dock in support of its Signatory Airline Carrier Operation at OGG.

COMMENCEMENT DATE:

Upon execution of the revocable permit.

MONTHLY RENTAL:

\$5,817.65 (\$5,743.40 based on a rate of \$88.36 per square foot, per annum, as determined from the Airports Division Signatory Rates and Charges, Hawai'i Airports System, effective July 1, 2022, and \$74.25 based on a rate of \$4.50 per square foot per annum for improved, paved land, as determined from the DOTA schedule of rates and charges established by appraisal of Airports property statewide).

SECURITY DEPOSIT:

\$17,452.95, or three (3) times the monthly rental in effect.

DCCA VERIFICATION:

Place of business registration confirmed: YES X NO \_\_\_  
Registered business name confirmed: YES X NO \_\_\_  
Good standing confirmed: YES X NO \_\_\_

BLNR – ISSUANCE OF A REVOCABLE PERMIT FOR STORAGE SPACE FOR  
AIRCRAFT CABIN SUPPLIES AND A TRUCK LOADING DOCK  
SOUTHWEST AIRLINES CO.

Page 3

CHAPTER 343, HRS - ENVIRONMENTAL ASSESSMENT:

The State of Hawai'i, Department of Transportation, Airports Division, has determined that the subject land area and use is covered by the Kahului Airport Terminal Complex Expansion Negative Declaration, published by the Environmental Quality Commission (EQC) in the September 8, 1981, issue of the EQC Bulletin. Accordingly, all relevant mitigation from the Negative Declaration and best management practices will be implemented to address the minimum impacts of this action.

REMARKS:

In accordance with Section 171-55, HRS, relating to Permits, the Department of Transportation proposes to issue a month-to-month revocable permit to SWA for storage of aircraft cabin supplies and a truck loading dock in support of its Signatory Airline Carrier Operation at OGG.

RECOMMENDATION:

Based on this submittal, and testimony and facts presented, the Department of Transportation recommends the Board finds that approving the issuance of a month-to-month Revocable Permit to SWA, including its conditions and rent, will serve in the best interests of the State.

Respectfully submitted,



JADE T. BUTAY  
Director of Transportation

APPROVED FOR SUBMITTAL:



SUZANNE D. CASE  
Chairperson  
Board of Land and Natural Resources



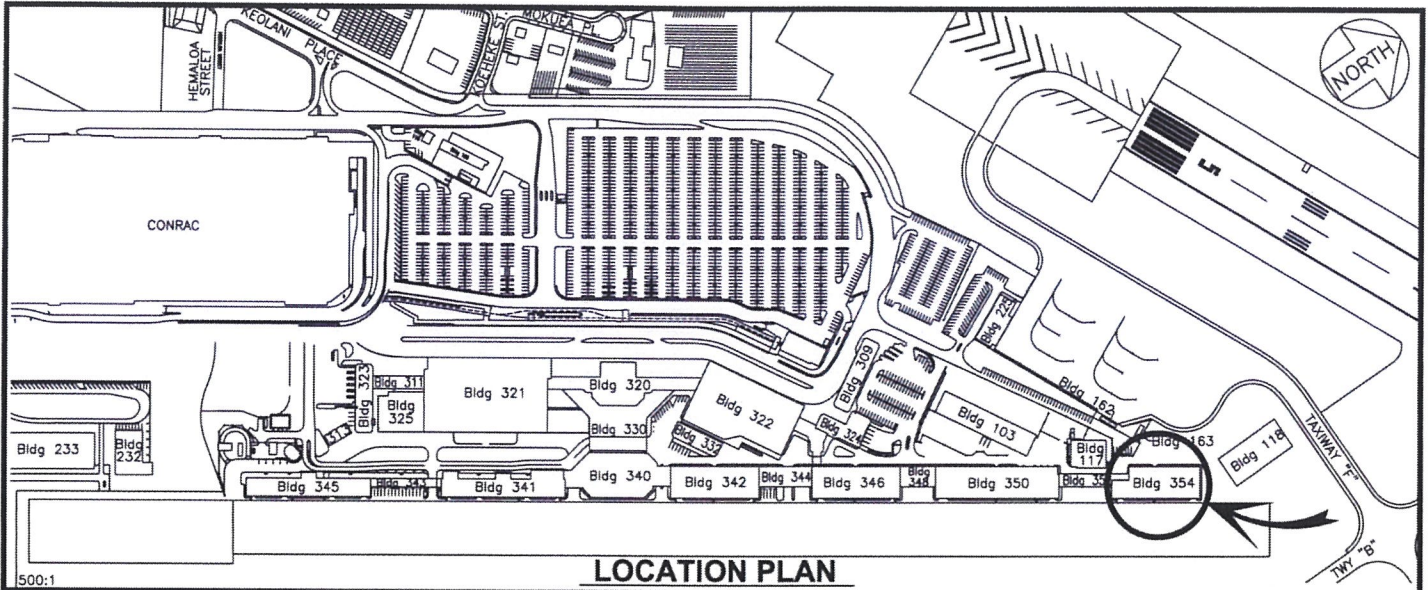

**LOCATION PLAN**

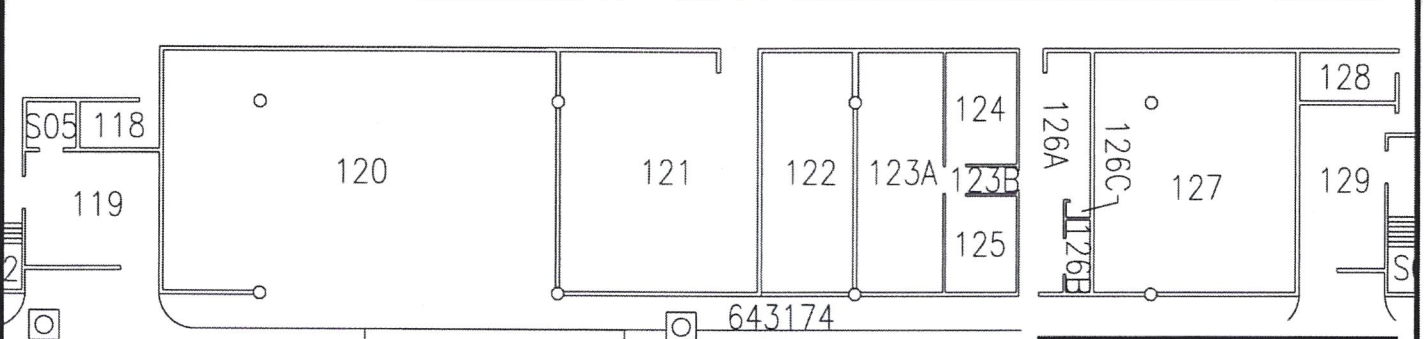
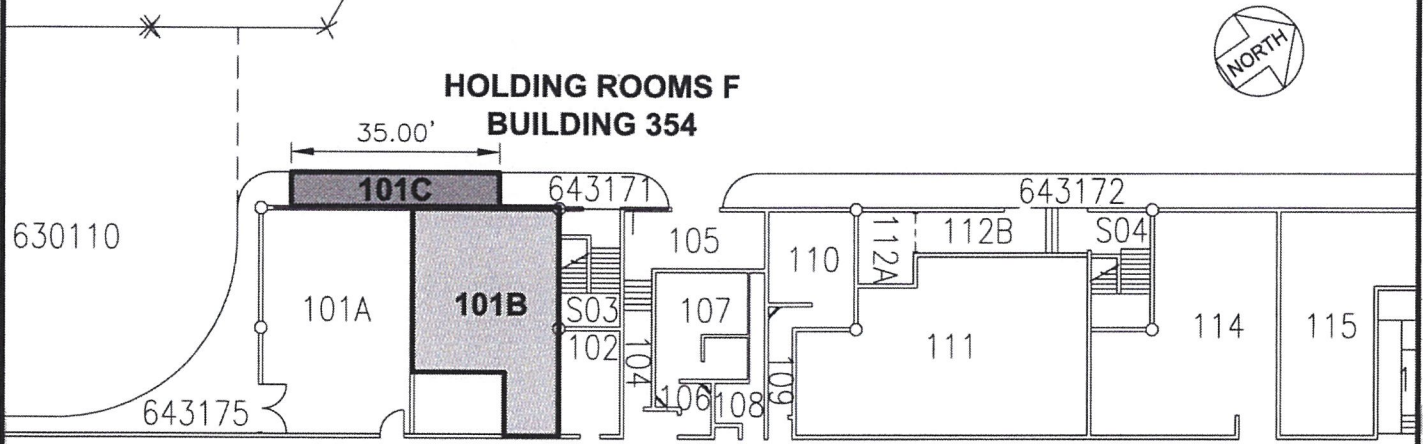

BLDG/ROOM	SQ. FT.
354 101B	780
AREA/SPACE	SQ. FT.
354 101C	198

SCALE: 1" = 30'

DATE : SEPT 2022

EXHIBIT: **A**



**SOUTHWEST AIRLINES CO.**

**BUILDING 354  
HOLDING ROOMS F  
GROUND LEVEL**

**345101B  
354101C  
PLAT B1**

**KAHULUI AIRPORT**

AIRPORTS\SIGG\CAD\PM\OGG\_354101C-01.DWG