

DAVID Y. IGE
GOVERNOR



JADE T. BUTAY
DIRECTOR

Deputy Directors
ROSS M. HIGASHI
EDUARDO P. MANGLALLAN
DAVID J. RODRIGUEZ
EDWIN H. SNIFFEN

STATE OF HAWAII
DEPARTMENT OF TRANSPORTATION
869 PUNCHBOWL STREET
HONOLULU, HAWAII 96813-5097

IN REPLY REFER TO:

Board of Land and
Natural Resources
State of Hawai'i
Honolulu, Hawai'i

ISSUANCE OF A REVOCABLE PERMIT FOR AN OFFICE
FOR AIRLINE CARRIER OPERATIONS
SOUTHERN AIRWAYS EXPRESS, LLC
LĀNA'I AIRPORT
TAX MAP KEY: (2) 4-9-02: PORTION OF 55

MAUI

APPLICANT:

Southern Airways Express, LLC, whose business address is 101 N. Riverside Drive,
Suite 211, Pompano Beach, Florida 33062.

LEGAL REFERENCE:

Section 171-55, Hawai'i Revised Statutes (HRS), as amended.

LOCATION AND TAX MAP KEY:

Portion of Lāna'i Airport (LNY), Lāna'i, County of Maui, identified by
Tax Map Key: 2nd Division, 4-9-02: Portion of 55.

AREAS:

Building/Room No. 302-106A, containing an area of approximately 159 square feet, as
shown and delineated on the attached Exhibit A.

ZONING:

State Land Use District: Urban
County of Maui: Airport

LAND TITLE STATUS:

Section 5(a) lands of the Hawai'i Admission Act: Non-Ceded
DHHL 30% entitlement lands pursuant to Hawai'i Admission Act YES ___ NO X

ITEM M-12

BLNR – ISSUANCE OF A REVOCABLE PERMIT FOR AN OFFICE
FOR AIRLINE CARRIER OPERATIONS
SOUTHERN AIRWAYS EXPRESS, LLC

Page 2

CURRENT USE STATUS:

Land presently encumbered by Governor’s Executive Order No. 4568, dated November 30, 2018, setting aside 507.795 acres designated as Lāna‘i Airport to be under the control and management of the State of Hawai‘i, Department of Transportation for Airport Purposes.

CHARACTER OF USE:

Southern Airways Express, LLC will use the space for an office, in support of its Commercial Airline Carrier Operations at Lāna‘i Airport.

COMMENCEMENT DATE:

Upon complete execution of the revocable permit.

MONTHLY RENTAL:

\$378.69 (\$253.08, as determined from the Department of Transportation, Airports Division schedule of rates and charges established by appraisal of Airports property statewide, plus \$39.75 for air conditioning, \$62.01 for utilities and \$23.85 for maintenance).

SECURITY DEPOSIT:

\$1,136.07, or three (3) times the monthly rental in effect.

DCCA VERIFICATION:

Place of business registration confirmed:	YES <u>X</u>	NO _____
Registered business name confirmed:	YES <u>X</u>	NO _____
Good standing confirmed:	YES <u>X</u>	NO _____

CHAPTER 343, HRS - ENVIRONMENTAL ASSESSMENT:

The State of Hawai‘i, Department of Transportation, Airports Division (HDOT-A), has determined that the subject areas are covered by the Lāna‘i Airport Master Plan Improvements Final Environmental Impact Statement (EIS), published by the Office of Environmental Quality Control (OEQC) in the January 23, 1991, issue of the OEQC Bulletin and accepted by the Governor on May 7, 1991. Accordingly, all relevant mitigation from the EIS and best management practices will be implemented to address the minimum impacts of this action.

BLNR – ISSUANCE OF A REVOCABLE PERMIT FOR AN OFFICE
FOR AIRLINE CARRIER OPERATIONS
SOUTHERN AIRWAYS EXPRESS, LLC

Page 3

REMARKS:

In accordance with Section 171-55, HRS, relating to Permits, the Department of Transportation proposes to issue a month-to-month revocable permit to Southern Airways Express, LLC for an office, in support of its Commercial Airline Carrier Operations at Lāna‘i Airport.

RECOMMENDATION:

Based on this submittal, and testimony and facts presented, the Department of Transportation recommends the Board finds that approving the issuance of a month-to-month Revocable Permit to Southern Airways Express, LLC, including its conditions and rent, will best serve the interests of the State.

Respectfully submitted,



JADE T. BUTAY
Director of Transportation

APPROVED FOR SUBMITTAL:

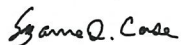

SUZANNE D. CASE
Chairperson
Board of Land and Natural Resources

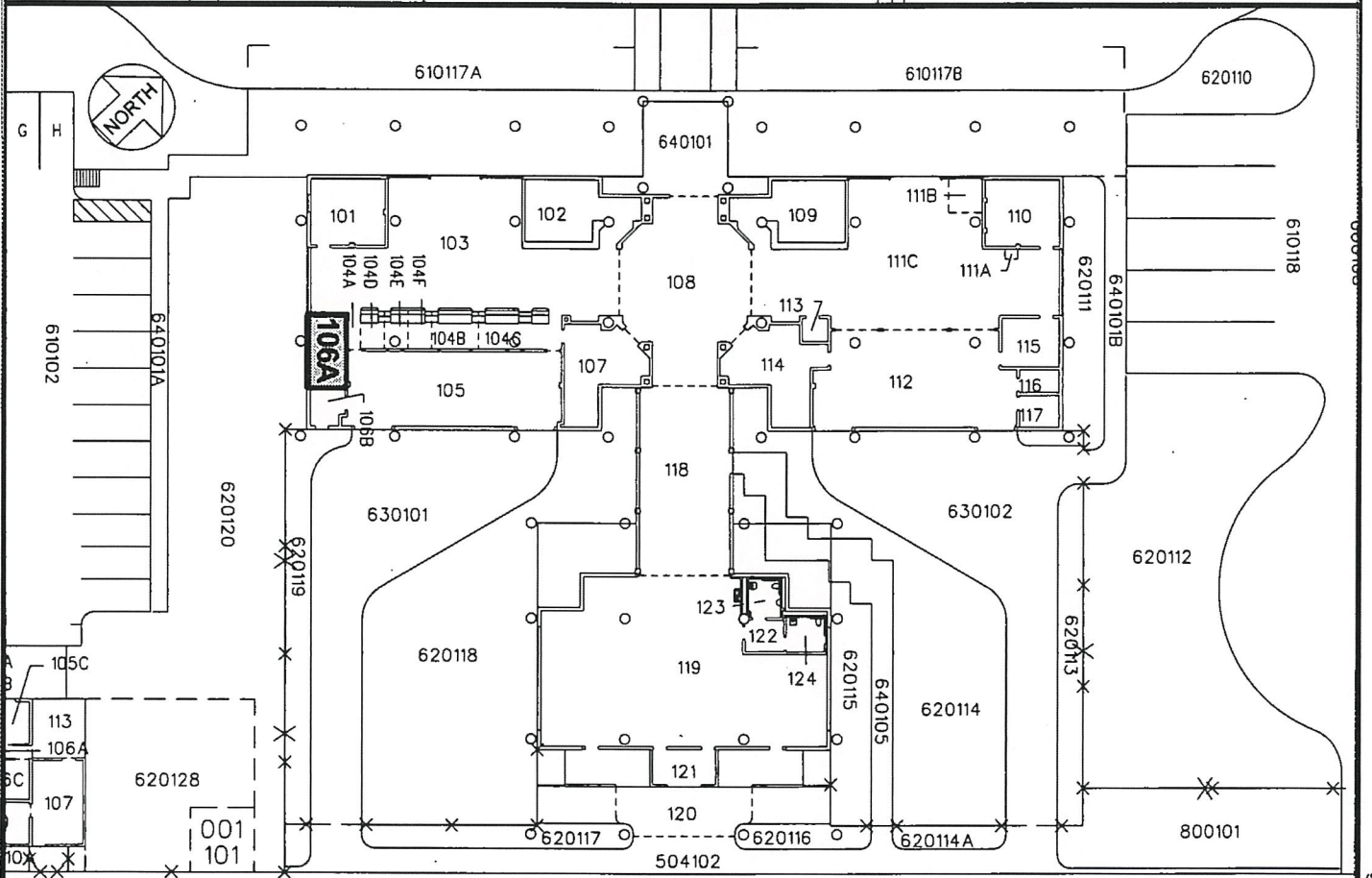
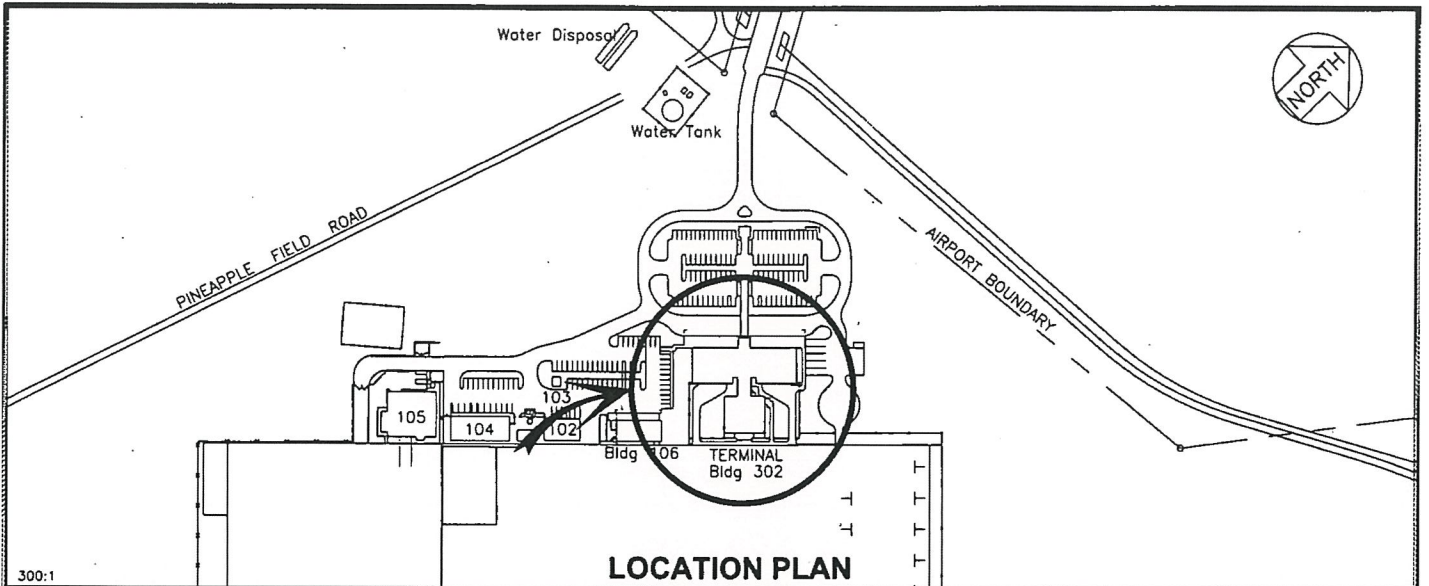

New Terminal
BLDG 302
SCALE: 1" = 40'

BLDG/ROOM	SQ. FT.
302 106A	159

RP-9340

DATE : OCTOBER 2022

EXHIBIT: **A**



**SOUTHERN AIRWAYS
EXPRESS, LLC**

**BUILDING 302
NEW TERMINAL
GROUND LEVEL**

**302106A
PLAT A1,45**

LANAI AIRPORT