

DAVID Y. IGE
GOVERNOR



JADE T. BUTAY
DIRECTOR

Deputy Directors
ROSS M. HIGASHI
EDUARDO P. MANGLALLAN
DAVID J. RODRIGUEZ
EDWIN H. SNIFFEN

STATE OF HAWAII
DEPARTMENT OF TRANSPORTATION
869 PUNCHBOWL STREET
HONOLULU, HAWAII 96813-5097

IN REPLY REFER TO:

Board of Land and
Natural Resources
State of Hawai'i
Honolulu, Hawai'i

ISSUANCE OF A REVOCABLE PERMIT FOR A T-HANGAR FOR STORAGE
AND MAINTENANCE OF AN AIRCRAFT
PHILLIP WILSON JR.
DANIEL K. INOUE INTERNATIONAL AIRPORT
TAX MAP KEY: (1) 1-1-076: 020

O'AHU

REQUEST:

Issuance of a Revocable Permit for a T-Hangar for the storage and maintenance of an aircraft to Phillip Wilson Jr., situated at Daniel K. Inouye International Airport.

LEGAL REFERENCE:

Section 171-55, Hawai'i Revised Statutes.

APPLICANT:

Phillip Wilson Jr., whose mailing address is 3126 Kahako Place, Kailua, Hawai'i 96734.

LOCATION AND TAX MAP KEY:

Daniel K. Inouye International Airport (HNL), Island of O'ahu, State of Hawai'i, identified by Tax Map Key: 1st Division, 1-1-076: 020.

AREA:

Area/Lot No. 420-107, containing an area of approximately 1,247 square feet, as shown and delineated on the attached map labeled Exhibit "A".

ITEM M-5

BLNR – ISSUANCE OF A REVOCABLE PERMIT FOR T-HANGAR FOR STORAGE AND MAINTENANCE OF AN AIRCRAFT, PHILLIP WILSON JR.

Page 2

ZONING:

State Land Use District: Urban
City and County of Honolulu LUO: Industrial (I-2)

LAND TITLE STATUS:

Non-Ceded - Section 5(a) lands of the Hawai'i Admission Act
DHHL 30% entitlement lands pursuant to Hawai'i Admission Act YES ___ NO X

CURRENT USE STATUS:

Land presently encumbered by Governor's Executive Order No. 3201, dated June 8, 1983, setting aside 3,152.177 acres designated as Daniel K. Inouye International Airport under the control and management of the State of Hawai'i, Department of Transportation, Airports Division (DOTA) for Airport Purposes.

CHARACTER OF USE:

T-Hangar for storage and maintenance of aircraft (1969 Cessna 177A / N30599).

COMMENCEMENT DATE:

To be determined by the Director of Transportation at a later date.

MONTHLY RENTAL:

\$772.00 (as determined from the DOTA schedule of rates and charges established by appraisal of Airports property statewide).

SECURITY DEPOSIT:

\$2,316.00, or three (3) times the monthly rental in effect.

CHAPTER 343, HRS - ENVIRONMENTAL ASSESSMENT:

The environmental impacts of the proposed action to the subject land area are covered by the Honolulu International airport Master Plan Update and Noise Compatibility Program Environmental Assessment (EA), State Project No. AO1011-033. The EA is a joint State and Federal document, dated September 1989 and published in the October 23, 1989 issue of the OEQC Bulletin. Accordingly, relevant mitigation from the EA and DOTA environmental best management practice will address minimal impacts from this action.

BLNR – ISSUANCE OF A REVOCABLE PERMIT FOR T-HANGAR FOR STORAGE AND MAINTENANCE OF AN AIRCRAFT, PHILLIP WILSON JR.

Page 3

REMARKS:

In accordance with Section 171-55 HRS, relating to Permits, the Department of Transportation proposes to issue a month-to-month revocable permit to Phillip Wilson Jr. for a T-Hangar for storage and maintenance of an aircraft.

RECOMMENDATION:

Based on this submittal, and testimony and facts presented, the Department of Transportation recommends the Board finds that approving the issuance of a month-to-month Revocable Permit to Phillip Wilson Jr., including its conditions and rent, will serve the best interests of the State.

Respectfully submitted,



JADE T. BUTAY
Director of Transportation

APPROVED FOR SUBMITTAL:

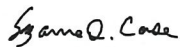

SUZANNE D. CASE
Chairperson
Board of Land and Natural Resources

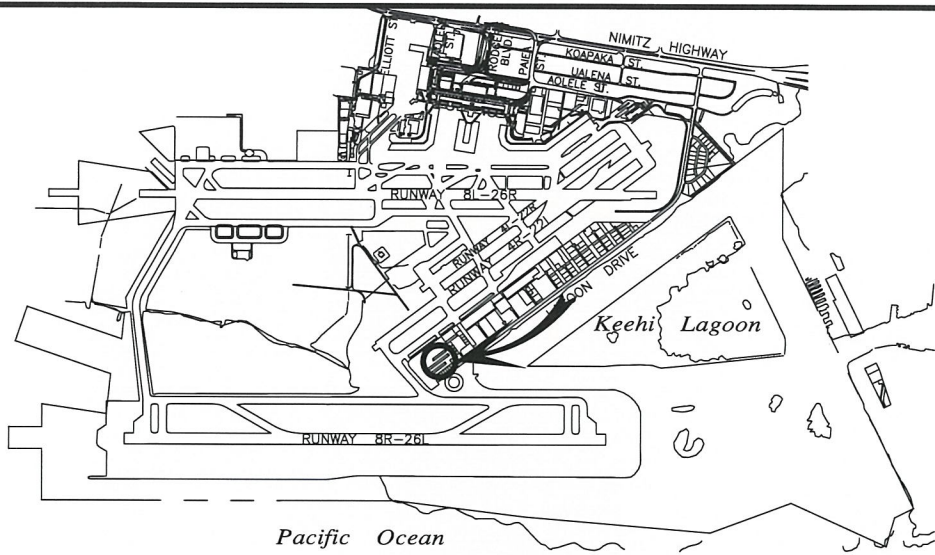

LOCATION PLAN

5000:1

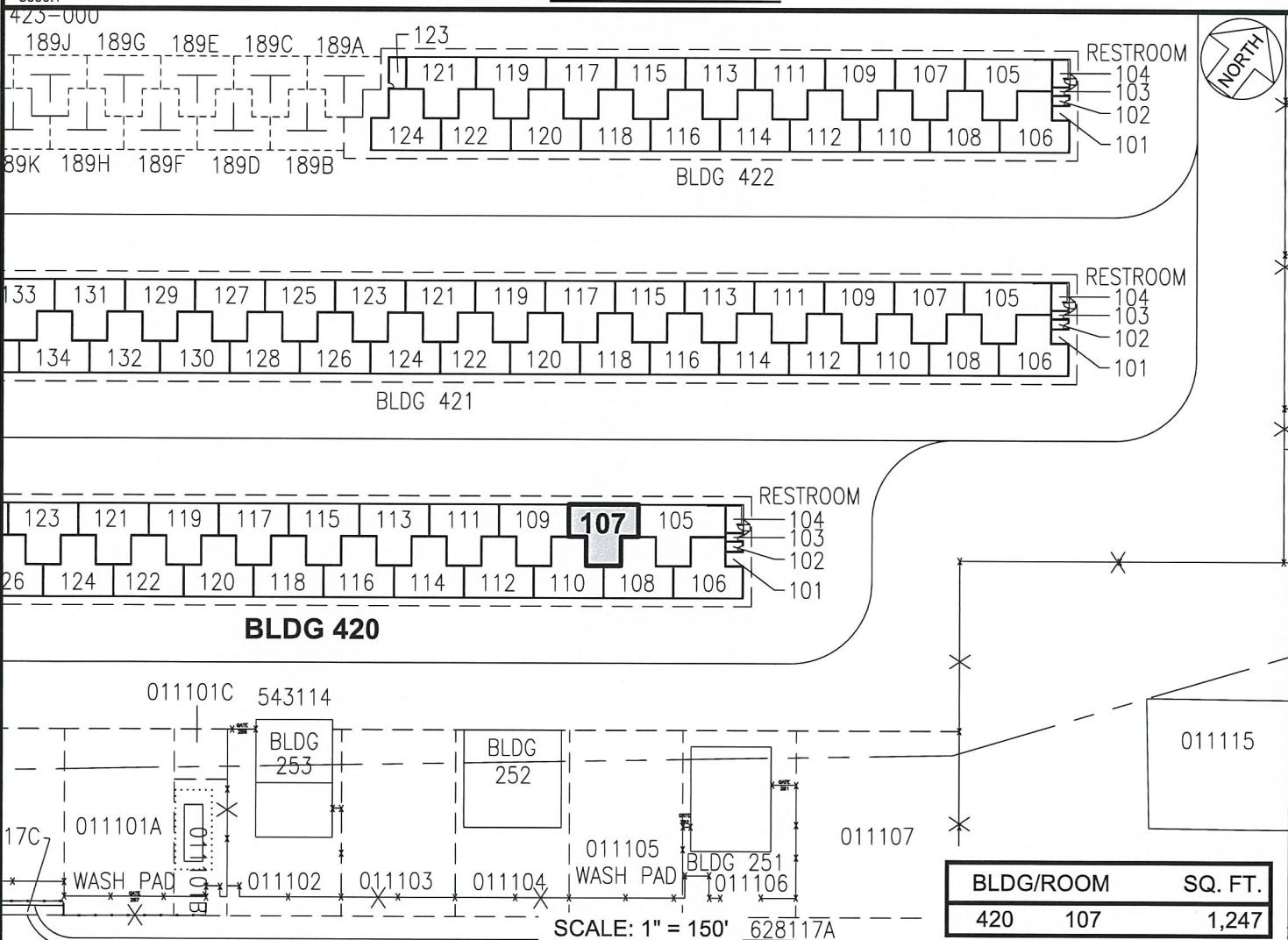

RP-9329

DATE : OCTOBER 2022

EXHIBIT: **A**



Airports Division

WILSON JR., PHILLIP

T-HANGAR

420107

PLAT 45

DANIEL K. INOUE INTERNATIONAL AIRPORT