

DAVID Y. IGE
GOVERNOR



STATE OF HAWAII
DEPARTMENT OF TRANSPORTATION
869 PUNCHBOWL STREET
HONOLULU, HAWAII 96813-5097

JADE BUTAY
DIRECTOR

Deputy Directors
ROSS M. HIGASHI
EDUARDO P. MANGLALLAN
DAVID J. RODRIGUEZ
EDWIN H. SNIFFEN

IN REPLY REFER TO:

Board of Land and
Natural Resources
State of Hawai'i
Honolulu, Hawai'i

ISSUANCE OF A REVOCABLE PERMIT FOR
AN OFFICE, BREAK ROOM AND TRAINING ROOM
UNIFI AVIATION, LLC
LĪHU'E AIRPORT
TAX MAP KEY: (4) 3-5-001: PORTION OF 135

KAUA'I

LEGAL REFERENCE:

Section 171-55, Hawai'i Revised Statutes (HRS), as amended.

APPLICANT:

Unifi Aviation, LLC (Unifi), whose mailing address is 980 Virginia Avenue, 4th Floor,
Atlanta, Georgia 30354.

LOCATION AND TAX MAP KEY:

Portion of Building No. 306, Main Terminal, Ground Level of
Līhu'e Airport (Airport), Līhu'e, Island of Kaua'i, identified by
Tax Map Key: 4th Division, 3-5-001: Portion of 135.

AREAS:

Bldg/Room No. 306-114B, containing an area of approximately 616 square feet,
as shown and delineated on the attached Exhibit "A".

Bldg/Room No. 306-243C, containing an area of approximately 756 square feet,
as shown and delineated on the attached Exhibit "B".

ITEM M-13

BLNR – ISSUANCE OF A REVOCABLE PERMIT FOR AN OFFICE, BREAK ROOM AND
TRAINING ROOM, UNIFI AVIATION, LLC

Page 2

ZONING:

State Land Use District: Urban
County of Kaua‘i: Industrial General/Special Treatment-Public Use (IG/ST-P)

LAND TITLE STATUS:

Section 5(a) lands of the Hawai‘i Admission Act: Non-Ceded
DHHL 30% entitlement lands pursuant to Hawai‘i Admission Act: YES ___ NO X

CURRENT USE STATUS:

Land presently encumbered by Governor’s Executive Order No. 4614, dated October 28, 2019, setting aside 883.583 acres designated as Līhu‘e Airport to be under the control and management of the State of Hawai‘i, Department of Transportation for Airport Purposes.

CHARACTER OF USE:

Unifi will use the spaces for an office, break room and training room to support their ground handling operations at the Airport.

COMMENCEMENT DATE:

Upon execution of the revocable permit.

MONTHLY RENTAL:

\$3,416.28 (\$2,538.20, as determined from the DOTA schedule of rates and charges established by appraisal of Airports property statewide, plus \$535.08 for utilities and \$343.00 for air conditioning).

SECURITY DEPOSIT:

\$10,248.84, or three (3) times the monthly rental in effect.

DCCA VERIFICATION:

Place of business registration confirmed:	YES <u>X</u>	NO ___
Registered business name confirmed:	YES <u>X</u>	NO ___
Good standing confirmed:	YES <u>X</u>	NO ___

CHAPTER 343, HRS - ENVIRONMENTAL ASSESSMENT:

The State of Hawai‘i, Department of Transportation, Airports Division, has determined that the environmental impacts of the proposed tenant use for the subject land use is covered by the Līhu‘e Airport Master Plan Environmental Impact Statement, published by the Environmental Quality Commission (EQC) in the August 8, 1976 and August 23, 1976, issues of EQC Bulletin and accepted by the Governor on April 26, 1977. Accordingly, all relevant mitigation from the EIS and best management practices will be implemented to address the minimum impacts of this action.

REMARKS:

In accordance with Section 171-55, HRS, relating to Permits, the Department of Transportation proposes to issue a month-to-month revocable permit to Unifi for an office, break room and training room spaces in the terminal to support their ground handling operations at the Airport.

RECOMMENDATION:

Based on this submittal, and testimony and facts presented, the Department of Transportation recommends the Board finds that approving the issuance of a month-to-month Revocable Permit to Unifi, including its conditions and rent, will serve the best interests of the State.

Respectfully submitted,



JADE T. BUTAY
Director of Transportation

APPROVED FOR SUBMITTAL:

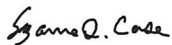

SUZANNE D. CASE
Chairperson
Board of Land and Natural Resources

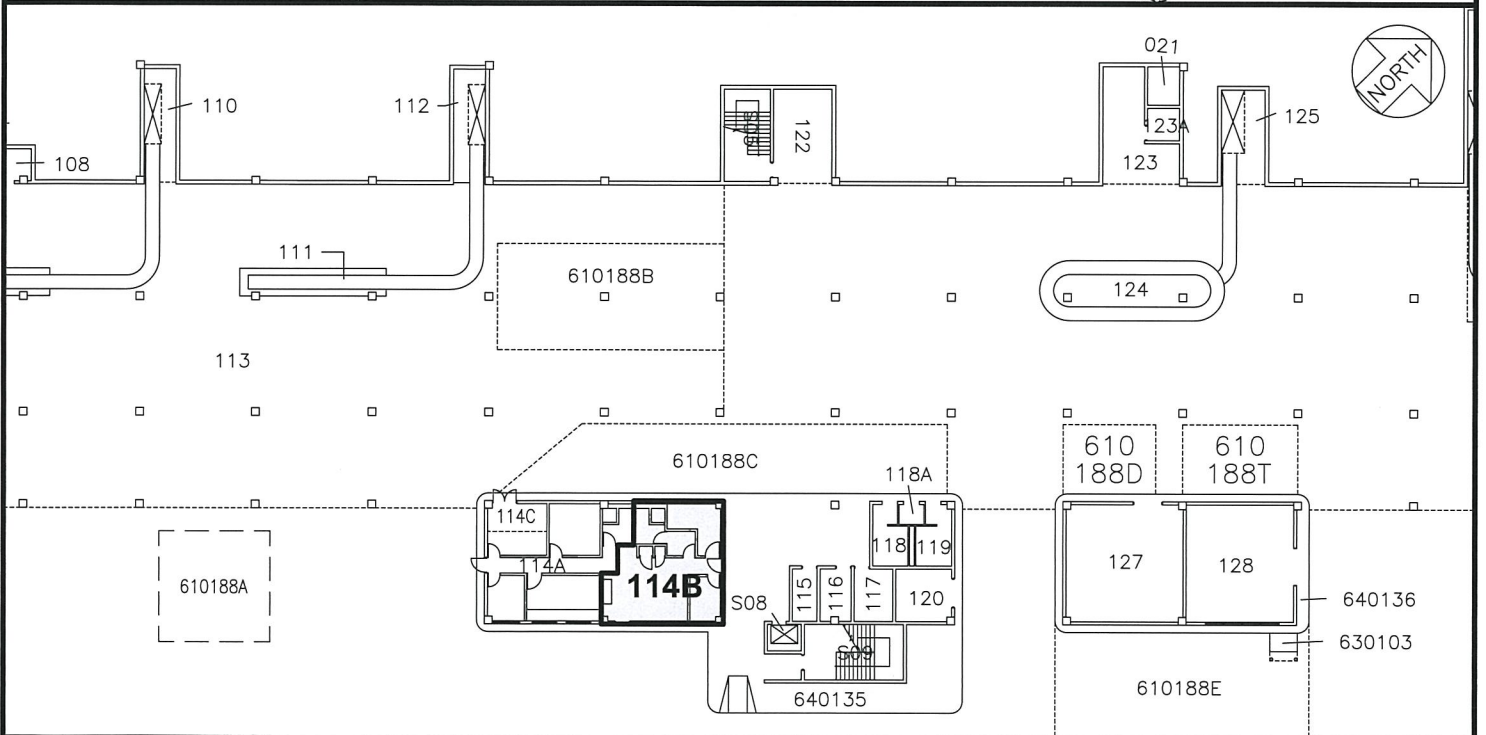
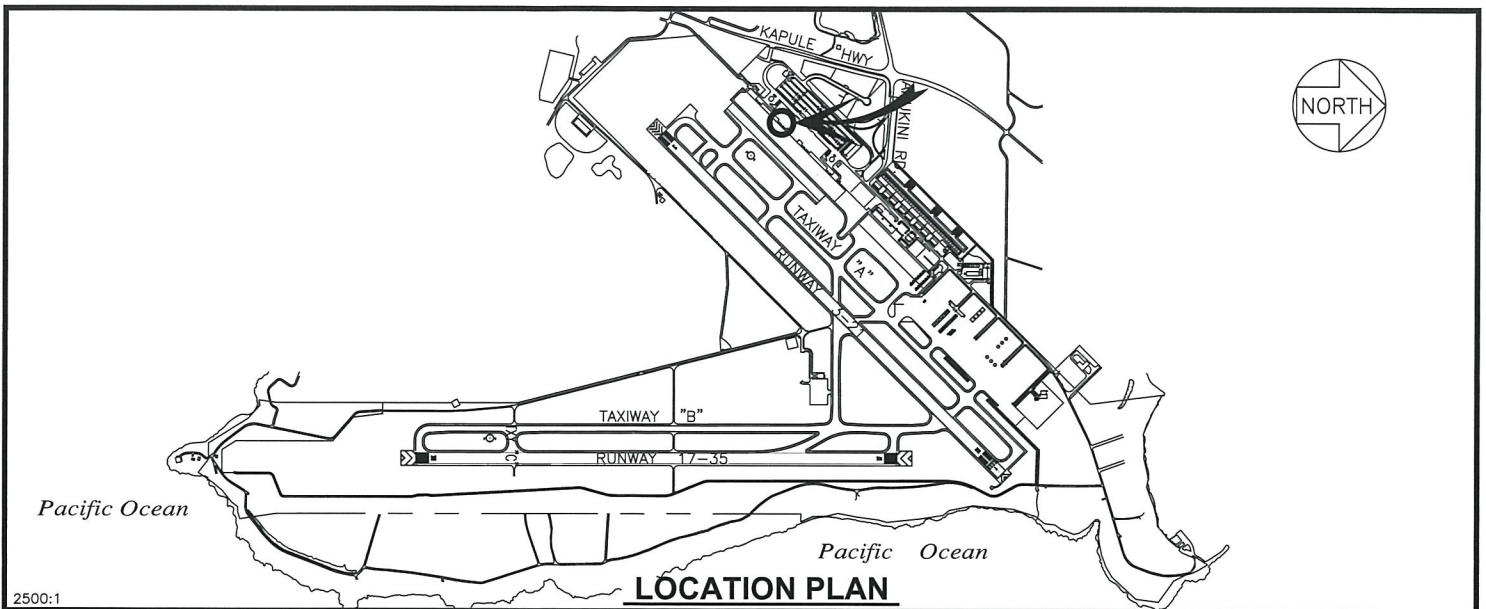

RP-9180	DATE : NOVEMBER 2022	EXHIBIT: A
	UNIFI AVIATION, LLC	BUILDING 306 MAIN TERMINAL GROUND LEVEL
		306114B PLAT C1, 45

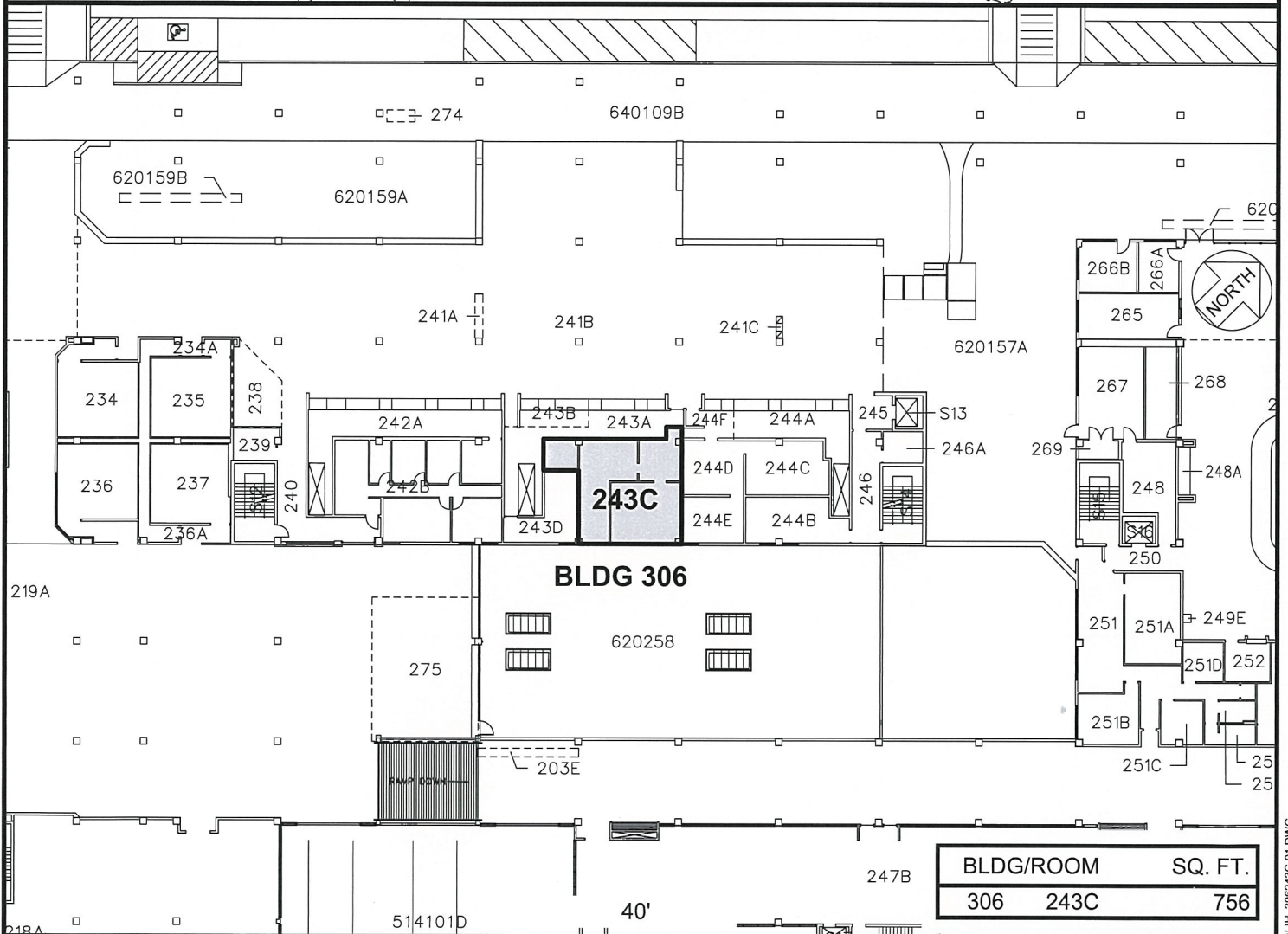
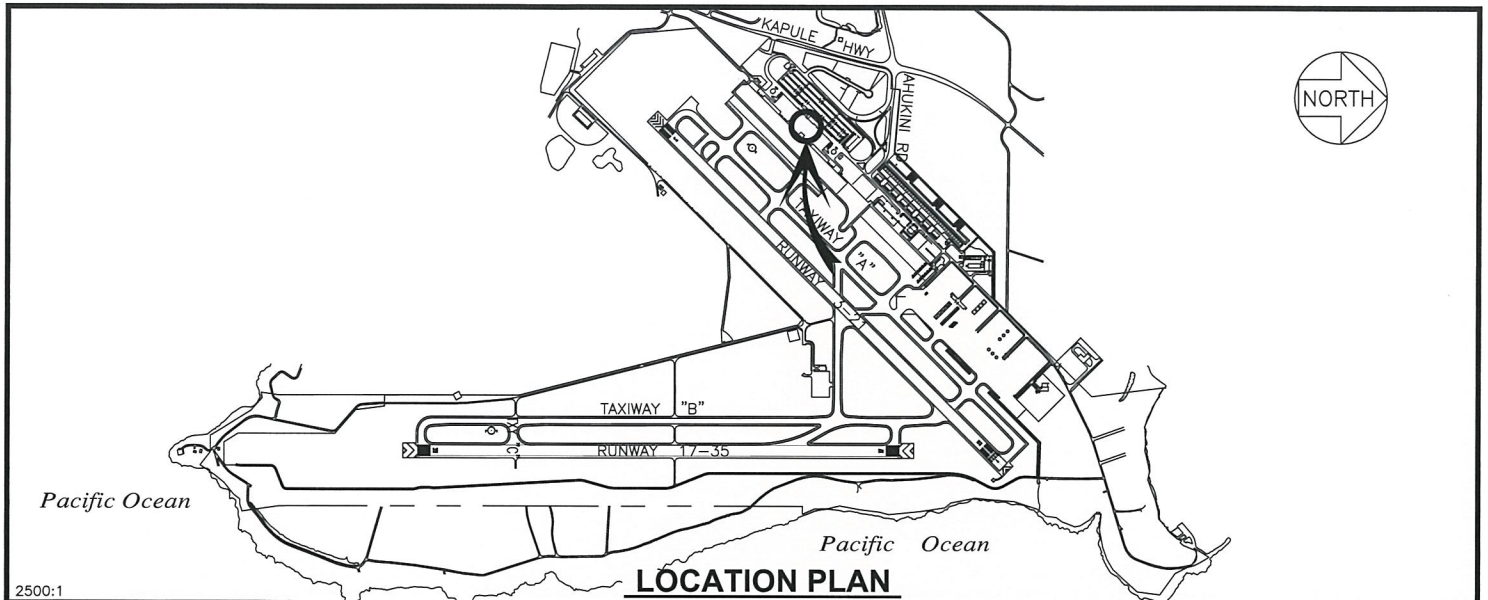

BLDG/ROOM	SQ. FT.
306 243C	756

RP-9180	DATE : NOVEMBER 2022	EXHIBIT: B
Airports Division	UNIFI AVIATION, LLC	BUILDING 306 MAIN TERMINAL GROUND LEVEL 306243C PLAT C2,35

N:\AIRPORTS\LIHUE\CAD\PM\LIH_306243C-01.DWG