



**STATE OF HAWAII  
DEPARTMENT OF TRANSPORTATION  
869 PUNCHBOWL STREET  
HONOLULU, HAWAII 96813-5097**

JADE T. BUTAY  
DIRECTOR

Deputy Directors  
ROSS M. HIGASHI  
EDUARDO P. MANGLALLAN  
DAVID J. RODRIGUEZ  
EDWIN H. SNIFFEN

IN REPLY REFER TO:

Board of Land and  
Natural Resources  
State of Hawai'i  
Honolulu, Hawai'i

ISSUANCE OF A REVOCABLE PERMIT FOR VEHICLE PARKING  
HAWAIIAN AIRLINES, INC.  
ELLISON ONIZUKA KONA INTERNATIONAL AIRPORT AT KEĀHOLE  
TAX MAP KEY: (3) 7-3-43: PORTION OF 003 HAWAI'I

REQUEST:

Issuance of a Revocable Permit for Vehicle Parking (Parking Permit) to Hawaiian Airlines, Inc., for four (4) vehicle parking spaces, situated at Ellison Onizuka Kona International Airport at Keāhole.

LEGAL REFERENCE:

Section 171-55, Hawai'i Revised Statutes (HRS).

APPLICANT:

Hawaiian Airlines, Inc. (Hawaiian) whose address is 3375 Koapaka Street, Suite G350, Honolulu, Hawai'i 96819.

LOCATION AND TAX MAP KEY:

Portion of Ellison Onizuka Kona International Airport at Keāhole (KOA), Kailua-Kona, Island of Hawai'i, identified by Tax Map Key: 3rd Division, 7-3-43: Portion of 003.

AREAS:

IMPROVED, PAVED LAND

Area/Space No. 610-148G, containing an area of approximately 171 square feet,  
Area/Space No. 610-148H, containing an area of approximately 171 square feet,  
Area/Space No. 610-148J, containing an area of approximately 171 square feet, and  
Area/Space No. 610-148K, containing an area of approximately 171 square feet, as  
shown and delineated on the attached Exhibit A.

**ITEM M-8**

BLNR – ISSUANCE OF A REVOCABLE PERMIT FOR VEHICLE PARKING  
HAWAIIAN AIRLINES, INC.  
Page 2

ZONING:

State Land Use District: Urban & Conservation  
County of Hawai'i: Industrial (MG-1a) and Open

LAND TITLE STATUS:

Section 5(a) lands of the Hawai'i Admission Act: Ceded  
DHHL 30% entitlement lands pursuant to Hawai'i Admission Act YES\_\_\_ NO X

CURRENT USE STATUS:

Land presently encumbered by Governor's Executive Order No. 3074, dated August 20, 1981, setting aside 4,204.10 acres designated as KOA under the control and management of the State of Hawai'i, Department of Transportation, Airports Division for Airport Purposes.

CHARACTER OF USE:

Hawaiian will use the four (4) vehicle parking spaces for employee parking in support of its Signatory Airline Carrier Operation at KOA.

COMMENCEMENT DATE:

Upon complete execution of the parking permit.

MONTHLY RENTAL:

\$220.00 (\$55.00 per stall, as determined from the Department of Transportation, Airports Division schedule of rates and charges established by appraisal of Airports property statewide)

SECURITY DEPOSIT:

\$660.00, or three (3) times the monthly rental in effect.

DCCA VERIFICATION:

Place of business registration confirmed:	YES <u>X</u>	NO _____
Registered business name confirmed:	YES <u>X</u>	NO _____
Good standing confirmed:	YES <u>X</u>	NO _____

CHAPTER 343, HRS – ENVIRONMENTAL ASSESSMENT:

The State of Hawaii, Department of Transportation, Airports Division (DOTA), has determined that the subject land areas are covered by the Kona International Airport at

BLNR – ISSUANCE OF A REVOCABLE PERMIT FOR VEHICLE PARKING  
HAWAIIAN AIRLINES, INC.  
Page 3

Keahole Master Plan Update Final Environmental Assessment (EA) and Finding of No Significant Impact (FONSI), dated December 18, 2000, and published by the Office of Environmental Quality Control (OEQC) in the January 8, 2001, issue of The Environmental Notice. Accordingly, all relevant mitigation from the EA and best management practices will be implemented to address the minimum impacts of this action.

REMARKS:

In accordance with Section 171-55, HRS, relating to Permits, the Department of Transportation proposes to issue a month-to-month Parking Permit to Hawaiian for four (4) employee vehicle parking spaces in support of its Signatory Airline Carrier Operation at KOA.

RECOMMENDATION:

Based on this submittal, and testimony and facts presented, the Department of Transportation recommends the Board finds that approving the issuance of a month-to-month Parking Permit to Hawaiian, including its conditions and rent, will serve the best interests of the State.

Respectfully submitted,



JADE T. BUTAY  
Director of Transportation

APPROVED FOR SUBMITTAL:

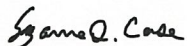

SUZANNE D. CASE  
Chairperson  
Board of Land and Natural Resources



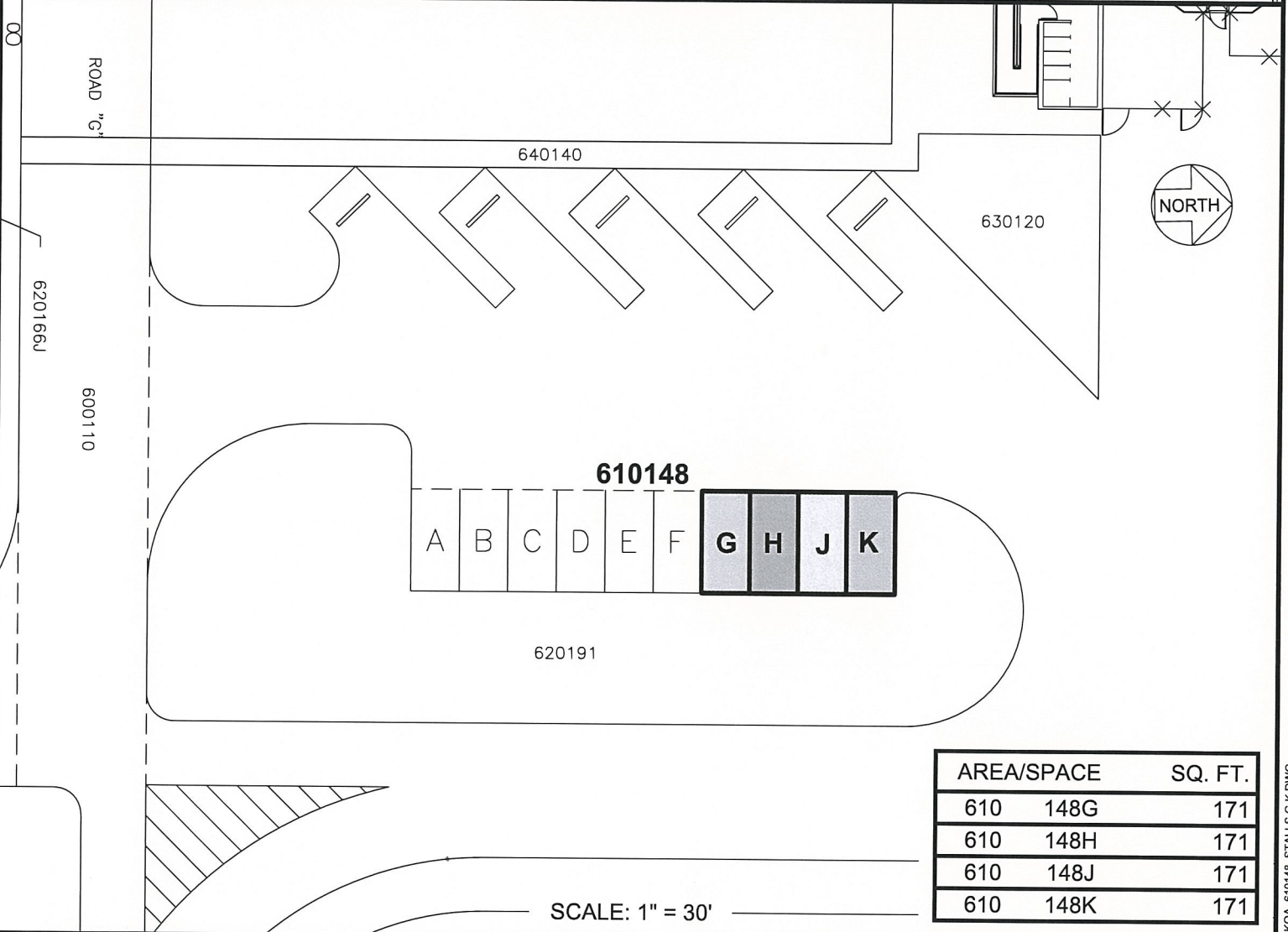
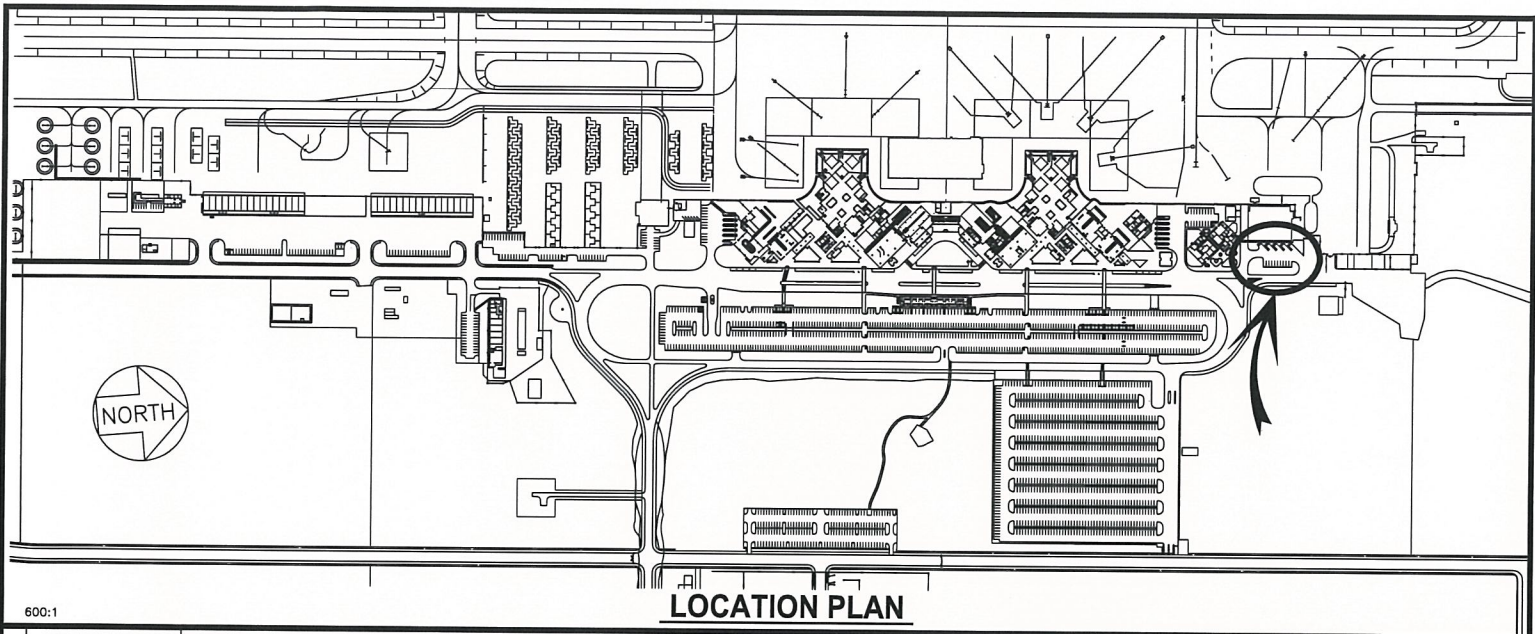

AREA/SPACE	SQ. FT.
610 148G	171
610 148H	171
610 148J	171
610 148K	171

PP-22-N020		DATE : AUGUST 2022		EXHIBIT: <b>A</b>	
 Airports Division	HAWAIIAN AIRLINES, INC.	PARKING STALLS	610148G-K		
			PLAT F1,58		