

DAVID Y. IGE  
GOVERNOR



STATE OF HAWAII  
DEPARTMENT OF TRANSPORTATION  
869 PUNCHBOWL STREET  
HONOLULU, HAWAII 96813-5097

JADE T. BUTAY  
DIRECTOR

Deputy Directors  
ROSS M. HIGASHI  
EDUARDO P. MANGALLAN  
DAVID J. RODRIGUEZ  
EDWIN H. SNIFFEN

IN REPLY REFER TO:

Board of Land and  
Natural Resources  
State of Hawai'i  
Honolulu, Hawai'i

ISSUANCE OF A REVOCABLE PERMIT FOR A T-HANGAR FOR STORAGE  
AND MAINTENANCE OF AN AIRCRAFT  
FLYING DUTCHMAN LLC  
DANIEL K. INOUE INTERNATIONAL AIRPORT  
TAX MAP KEY: (1) 1-1-076: PORTION OF 020

O'AHU

REQUEST:

Issuance of a Revocable Permit for a T-Hangar for the storage and maintenance of an aircraft to Flying Dutchman LLC, situated at Daniel K. Inouye International Airport.

LEGAL REFERENCE:

Section 171-55, Hawai'i Revised Statutes.

APPLICANT:

Flying Dutchman LLC, whose mailing address is 2841 N. Nimitz Highway,  
Honolulu, Hawai'i 96819.

LOCATION AND TAX MAP KEY:

Daniel K. Inouye International Airport (HNL), Island of O'ahu, State of Hawai'i,  
identified by Tax Map Key: 1<sup>st</sup> Division, 1-1-076: portion of 020.

AREA:

Building/Room No. 420-113, containing an area of approximately 1,247 square feet,  
as shown and delineated on the attached map labeled Exhibit "A".

**ITEM M-2**

BLNR – ISSUANCE OF A REVOCABLE PERMIT FOR A T-HANGAR FOR STORAGE AND  
MAINTENANCE OF AN AIRCRAFT, FLYING DUTCHMAN LLC

Page 2

ZONING:

State Land Use District: Urban  
City and County of Honolulu LUO: Industrial (I-2)

LAND TITLE STATUS:

Non-Ceded - Section 5(a) lands of the Hawai'i Admission Act  
DHHL 30% entitlement lands pursuant to Hawai'i Admission Act YES \_\_\_ NO X

CURRENT USE STATUS:

Land presently encumbered by Governor's Executive Order No. 3201, dated June 8, 1983, setting aside 3,152.177 acres designated as Daniel K. Inouye International Airport under the control and management of the State of Hawai'i, Department of Transportation, Airports Division (DOTA) for Airport Purposes.

CHARACTER OF USE:

T-Hangar for storage and maintenance of aircraft (1975 Cessna 421C/N808PM).

COMMENCEMENT DATE:

To be determined by the Director of Transportation at a later date.

MONTHLY RENTAL:

\$772.00 (as determined from the DOTA schedule of rates and charges established by appraisal of Airports property statewide).

SECURITY DEPOSIT:

\$2,316.00, or three (3) times the monthly rental in effect.

CHAPTER 343, HRS - ENVIRONMENTAL ASSESSMENT:

The environmental impacts of the proposed action to the subject land area are covered by the Honolulu International airport Master Plan Update and Noise Compatibility Program Environmental Assessment (EA), State Project No. AO1011-033. The EA is a joint State and Federal document, dated September 1989 and published in the October 23, 1989 issue of the OEQC Bulletin. Accordingly, relevant mitigation from the EA and DOTA environmental best management practice will address minimal impacts from this action.

BLNR – ISSUANCE OF A REVOCABLE PERMIT FOR A T-HANGAR FOR STORAGE AND  
MAINTENANCE OF AN AIRCRAFT, FLYING DUTCHMAN LLC  
Page 3

REMARKS:

In accordance with Section 171-55 HRS, relating to Permits, the Department of Transportation proposes to issue a month-to-month revocable permit to Flying Dutchman LLC for a T-Hangar for storage and maintenance of an aircraft.

RECOMMENDATION:

Based on this submittal, and testimony and facts presented, the Department of Transportation recommends the Board finds that approving the issuance of a month-to-month Revocable Permit to Flying Dutchman LLC, including its conditions and rent, will serve the best interests of the State.

Respectfully submitted,

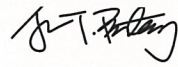

JADE T. BUTAY  
Director of Transportation

APPROVED FOR SUBMITTAL:

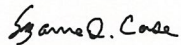

SUZANNE D. CASE  
Chairperson  
Board of Land and Natural Resources



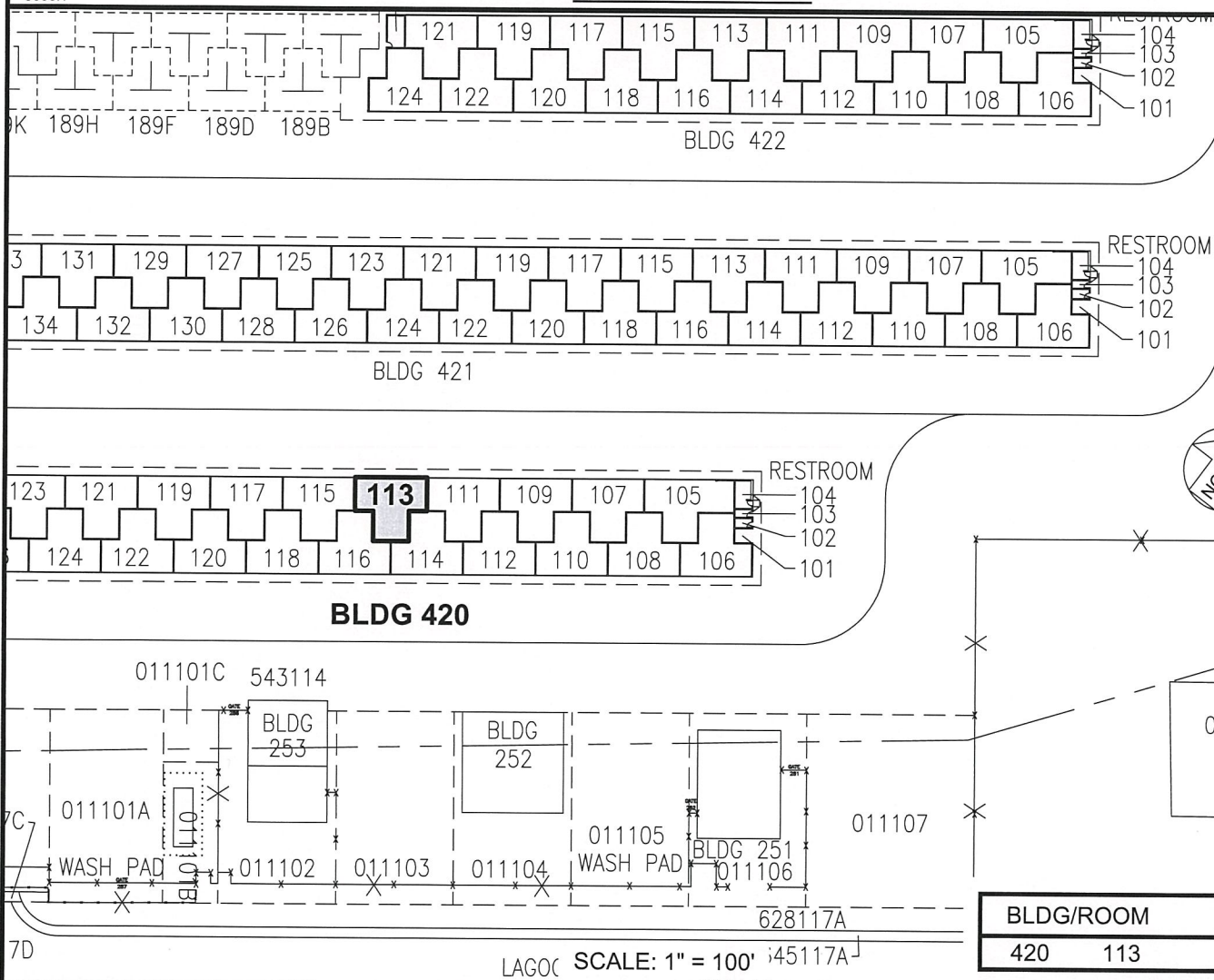
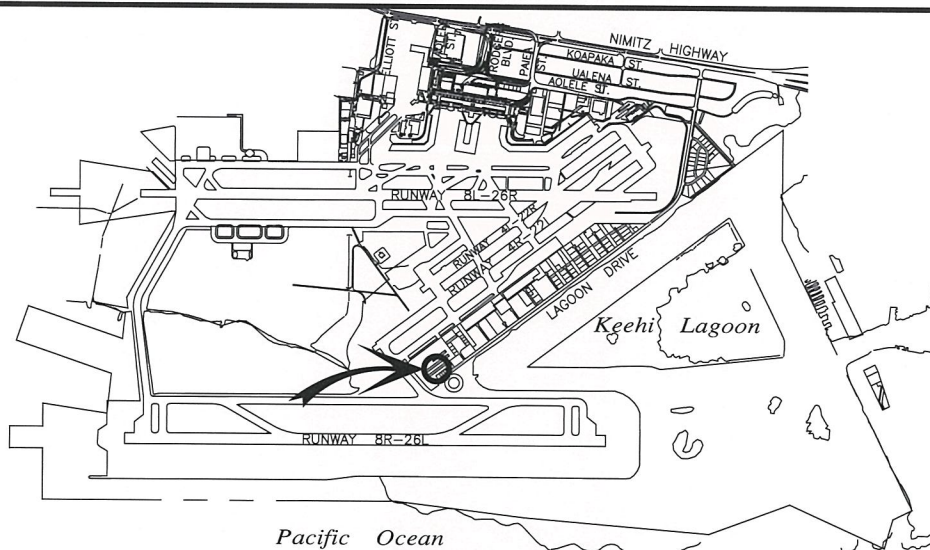

RP-9358

DATE : NOVEMBER 2022

EXHIBIT: **A**



Airports Division

FLYING DUTCHMAN LLC

T-HANGAR

420113  
PLAT 45

DANIEL K. INOUE INTERNATIONAL AIRPORT