

DAVID Y. IGE
GOVERNOR



STATE OF HAWAII
DEPARTMENT OF TRANSPORTATION
869 PUNCHBOWL STREET
HONOLULU, HAWAII 96813-5097

JADE T. BUTAY
DIRECTOR

Deputy Directors
ROSS M. HIGASHI
EDUARDO P. MANGLALLAN
DAVID J. RODRIGUEZ
EDWIN H. SNIFFEN

IN REPLY REFER TO:

Board of Land and
Natural Resources
State of Hawai'i
Honolulu, Hawai'i

ISSUANCE OF A REVOCABLE PERMIT FOR OFFICE AND EMPLOYEE BREAK
ROOM SPACE TO BE USED TO PROVIDE AVIATION CONTRACT SERVICES TO
VARIOUS AIRLINES
PACIFIC AVIATION LLC
DANIEL K. INOUE INTERNATIONAL AIRPORT
TAX MAP KEY: (1) 1-1-003: PORTION OF 058

O'AHU

REQUEST:

Issuance of a Revocable Permit for office and employee break room space to be used to provide aviation contract services to various airlines, Pacific Aviation LLC situated at Daniel K. Inouye International Airport.

LEGAL REFERENCE:

Section 171-55, Hawai'i Revised Statutes.

APPLICANT:

Pacific Aviation LLC, whose business address is 201 Continental Blvd., Suite 220, El Segundo, CA 90501.

LOCATION AND TAX MAP KEY:

Daniel K. Inouye International Airport (HNL), Island of O'ahu, State of Hawai'i, identified by Tax Map Key: 1st Division, 1-1-003: portion of 058.

AREA:

Bldg/Room No. 332-126A, containing an area of approximately 228 square feet; and
Bldg/Room No. 332-127, containing an area of approximately 78 square feet,
as shown and delineated on the attached map labeled Exhibit "A".

ITEM M-4

BLNR – ISSUANCE OF A REVOCABLE PERMIT FOR OFFICE AND EMPLOYEE BREAK
ROOM SPACES TO BE USED TO PROVIDE AVIATION CONTRACT SERVICES
TO VARIOUS AIRLINES, PACIFIC AVIATION LLC

Page 2

ZONING:

State Land Use District: Urban
City and County of Honolulu LUO: Industrial (I-2)

LAND TITLE STATUS:

Non-Ceded - Section 5(a) lands of the Hawai'i Admission Act
DHHL 30% entitlement lands pursuant to Hawai'i Admission Act YES ___ NO X

CURRENT USE STATUS:

Land presently encumbered by Governor's Executive Order No. 3201, dated June 8, 1983, setting aside 3,152.177 acres designated as Daniel K. Inouye International Airport under the control and management of the State of Hawai'i, Department of Transportation, Airports Division (DOTA) for Airport Purposes.

CHARACTER OF USE:

Pacific Aviation LLC will use the spaces for administrative offices and employee break room to be used in support of providing aviation contract services to various airlines at the Airport.

COMMENCEMENT DATE:

Upon execution of the revocable permit.

MONTHLY RENTAL:

\$765.00 (as determined from the DOTA schedule of rates and charges established by appraisal of Airports property statewide).

SECURITY DEPOSIT:

\$2,295.00, or three (3) times the monthly rental in effect.

DCCA VERIFICATION:

Place of business registration confirmed:	YES <u>X</u>	NO ___
Registered business name confirmed:	YES <u>X</u>	NO ___
Good standing confirmed:	YES <u>X</u>	NO ___

BLNR – ISSUANCE OF A REVOCABLE PERMIT FOR OFFICE AND EMPLOYEE BREAK
ROOM SPACES TO BE USED TO PROVIDE AVIATION CONTRACT SERVICES
TO VARIOUS AIRLINES, PACIFIC AVIATION LLC

Page 3

CHAPTER 343, HRS - ENVIRONMENTAL ASSESSMENT:

The environmental impacts of the proposed action to the subject land area are covered by the Honolulu International airport Master Plan Update and Noise Compatibility Program Environmental Assessment (EA), State Project No. AO1011-033. The EA is a joint State and Federal document, dated September 1989 and published in the October 23, 1989 issue of the OEQC Bulletin. Accordingly, relevant mitigation from the EA and DOTA environmental best management practice will address minimal impacts from this action.

REMARKS:

In accordance with Section 171-55 HRS, relating to Permits, the Department of Transportation proposes to issue a month-to-month revocable permit to Pacific Aviation LLC, for office and employee break room spaces to be used while providing aviation contract services to various airlines.

RECOMMENDATION:

Based on this submittal, and testimony and facts presented, the Department of Transportation recommends the Board finds that approving the issuance of a month-to-month Revocable Permit to Pacific Aviation LLC, including its conditions and rent, will serve the best interests of the State.

Respectfully submitted,



JADE T. BUTAY
Director of Transportation

APPROVED FOR SUBMITTAL:

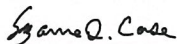

SUZANNE D. CASE
Chairperson
Board of Land and Natural Resources

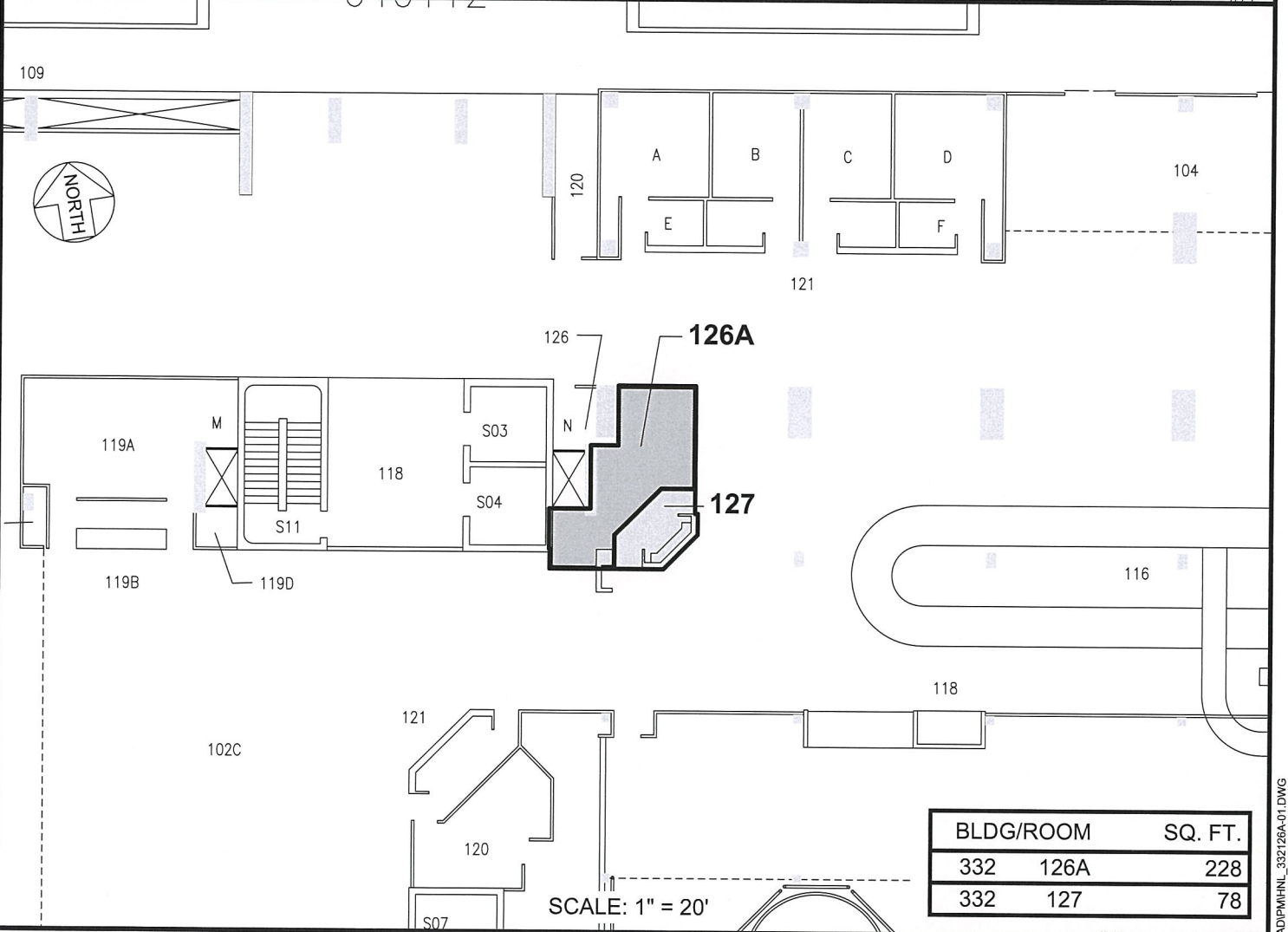
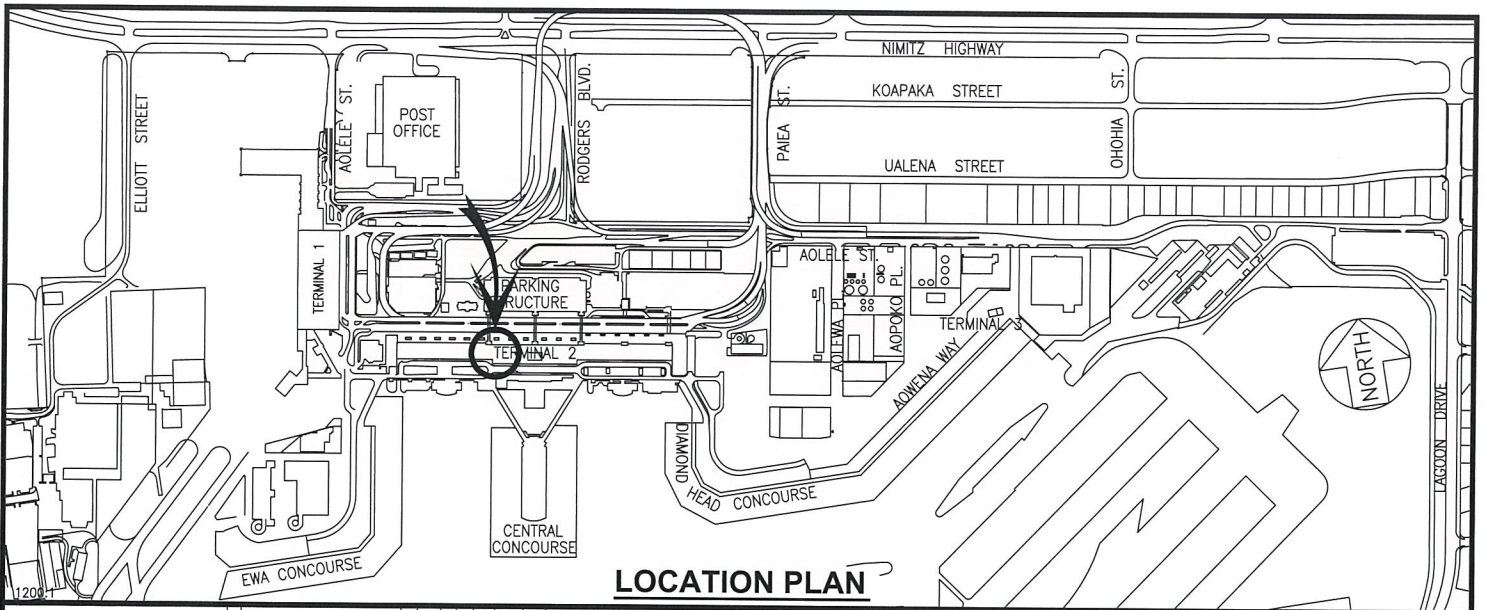

RP-9349

DATE : NOVEMBER 2022

EXHIBIT: **A**



Airports Division

PACIFIC AVIATION LLC

BUILDING 332
EWA DOMESTIC
GROUND LEVEL

332126A,127
PLAT A,25

DANIEL K. INOUE INTERNATIONAL AIRPORT