



STATE OF HAWAII
DEPARTMENT OF TRANSPORTATION
869 PUNCHBOWL STREET
HONOLULU, HAWAII 96813-5097

Board of Land and
Natural Resources
State of Hawaii
Honolulu, Hawaii

ISSUANCE OF A REVOCABLE PERMIT FOR COMMERCIAL USE OF A
T-HANGAR FOR STORAGE AND MAINTENANCE OF AIRCRAFT IN SUPPORT
OF A COMMERCIAL AERONAUTICAL GLIDER TOWING BUSINESS
PFISTER'S FLYING WAHINE LLC
KAWAIHAPAI AIRFIELD, WAIALUA, HAWAII
TAX MAP KEY: (1) 6-8-014:017 (PORTION)

OAHU

REQUEST:

Issuance of a Revocable Permit for commercial use a T-Hangar for storage and maintenance of an aircraft to Pfister's Flying Wahine LLC, situated at Kawaihapai Airfield fka Dillingham Airfield.

LEGAL REFERENCE:

Section 171-55, Hawaii Revised Statutes.

APPLICANT:

Pfister's Flying Wahine LLC, whose mailing address is 68-077D Akule Street, Waialua, Hawaii 96791

LOCATION AND TAX MAP KEY:

A portion of the Airfield, Waialua, Island of Oahu, State of Hawaii, identified by Tax Map Key: 1st Division, 6-8-014:017 (portion).

AREA:

Area/Lot No. 402-102, containing an area of approximately 1,107 square feet, as shown and delineated on the attached map labeled Exhibit "A".

ITEM M-2

BLNR – ISSUANCE OF A REVOCABLE PERMIT FOR COMMERCIAL USE OF
A T-HANGAR FOR STORAGE AND MAINTENANCE OF AIRCRAFT IN SUPPORT OF A
COMMERCIAL AERONAUTICAL GLIDER TOWING BUSINESS
PFISTER’S FLYING WAHINE LLC

Page 2

ZONING:

State Land Use District: Agriculture
City and County of Honolulu LUO: AG-2

LAND TITLE STATUS:

Ceded land, which the State of Hawaii is currently leasing the land from the United States of America.

CHARACTER OF USE:

Commercial use of T-Hangar for storage and maintenance of aircraft,
(1959 Cessna 182N, Tail No. N-7143E).

COMMENCEMENT DATE:

To be determined by the Director of Transportation at a later date.

MONTHLY RENTAL:

\$830.25 (as determined from the DOTA schedule of rates and charges for T-Hangar, established by appraisal of Airports property statewide).

SECURITY DEPOSIT:

\$2,490.75, or three (3) times the monthly rental in effect.

CHAPTER 343, HRS - ENVIRONMENTAL ASSESSMENT:

The subject land area is covered by the revised and updated Environmental Assessment for the Dillingham Airfield Master Plan and FAR Part 150 Noise Compatibility Program project, referenced as State Contract No. 26985, State Project No. AO2011-01. This Environmental Assessment evaluated the environmental effects of the recommended Dillingham Airfield Master Plan to meet existing and forecast general aviation demands and was prepared for the State of Hawaii, Department of Transportation, Airports Division.

REMARKS:

In accordance with Section 171-55, HRS, relating to Permits, the Department of Transportation proposes to issue a month-to-month revocable permit to Pfister’s Flying Wahine LLC situated at Kawaihapai Airfield fka Dillingham Airfield, for commercial use a T-Hangar for the storage and maintenance of aircraft.

BLNR – ISSUANCE OF A REVOCABLE PERMIT FOR COMMERCIAL USE OF
A T-HANGAR FOR STORAGE AND MAINTENANCE OF AIRCRAFT IN SUPPORT OF A
COMMERCIAL AERONAUTICAL GLIDER TOWING BUSINESS
PFISTER’S FLYING WAHINE LLC
Page 3

RECOMMENDATION:

Based on this submittal, and testimony and facts presented, the Department of Transportation recommends the Board finds that approving the issuance of a month-to-month Revocable Permit to Pfister’s Flying Wahine LLC, including its conditions and rent, will serve the best interests of the State.

Respectfully submitted,



EDWIN H. SNIFFEN
Director of Transportation

APPROVED FOR SUBMITTAL:



DAWN N. S. CHANG
Chairperson
Board of Land and Natural Resources

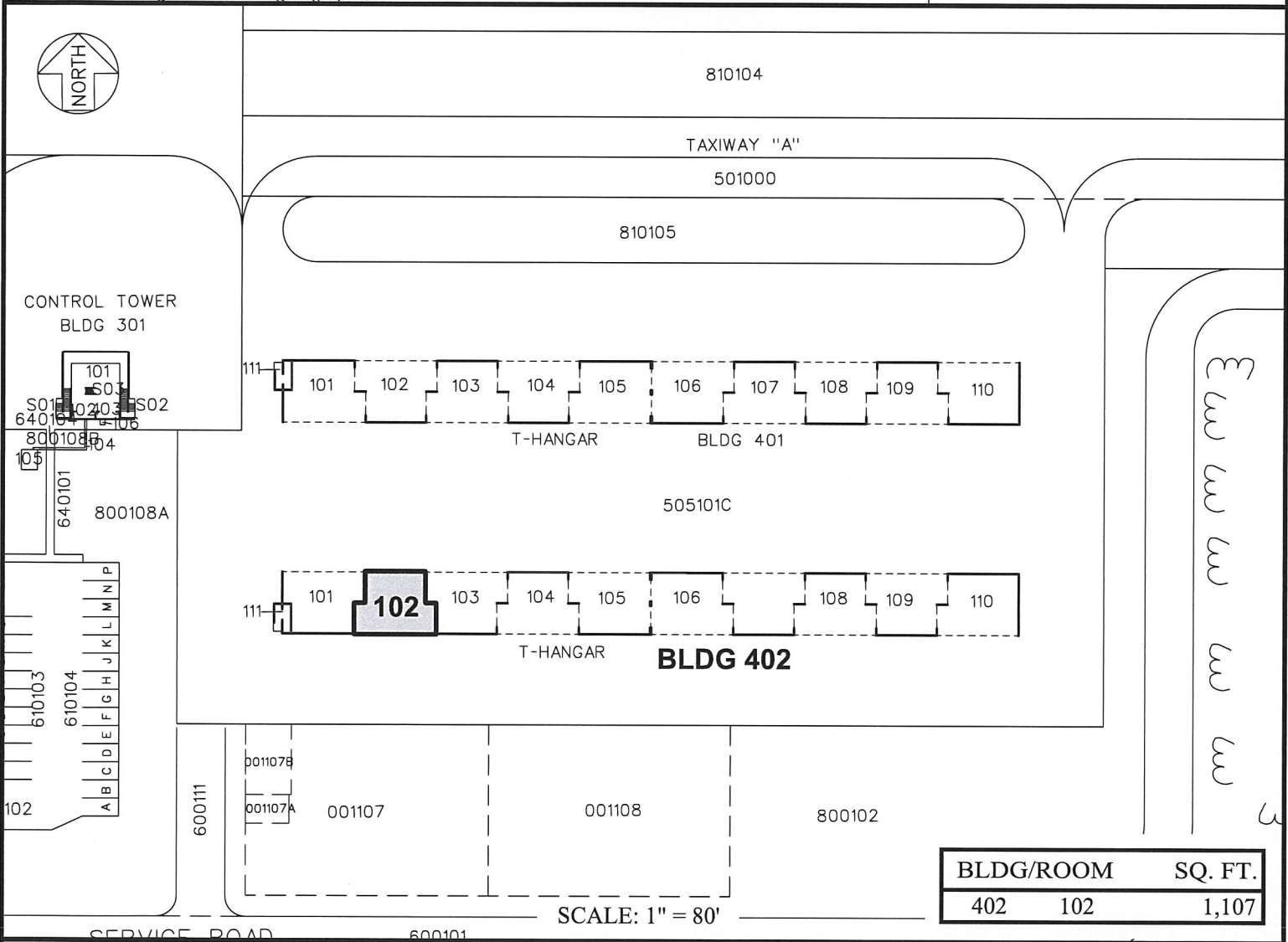
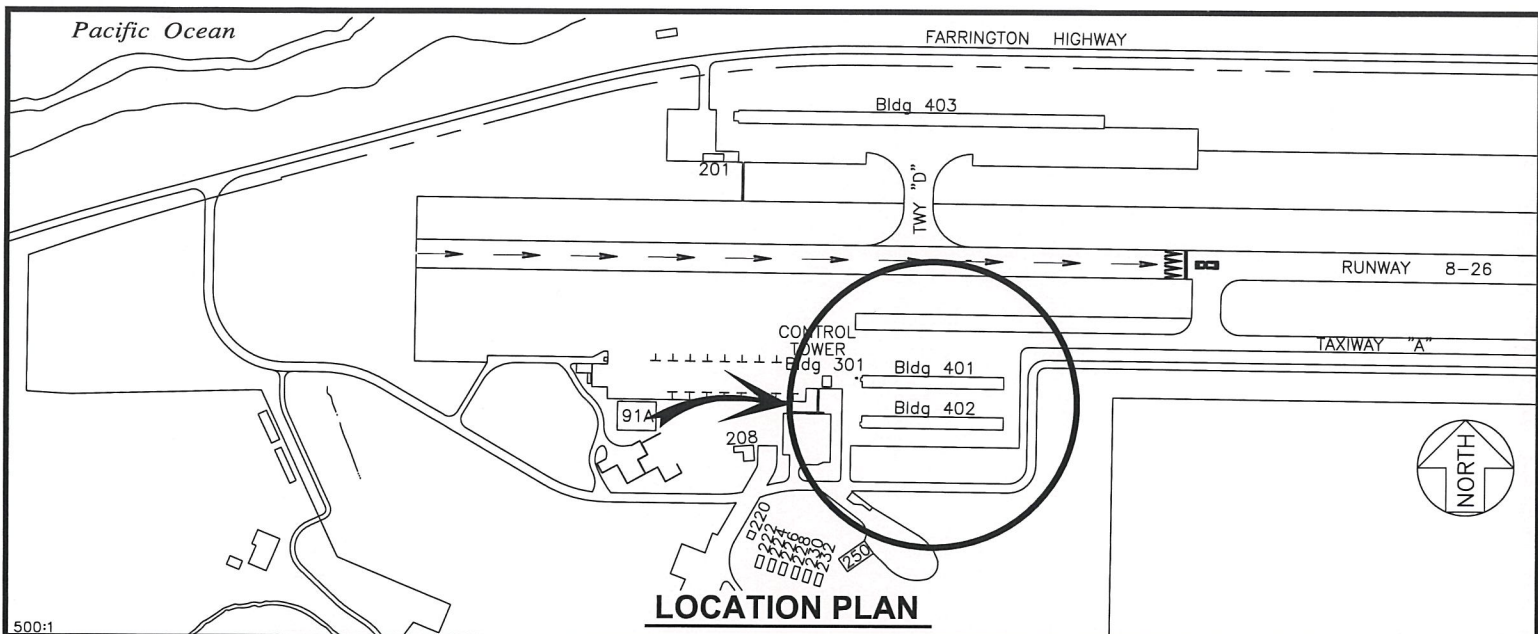

RP-9182

DATE : MARCH 2022

EXHIBIT: **A**



Airports Division

PFISTER'S FLYING WAHINE, LLC

BLDG 402
T-HANGAR
GROUND LEVEL

402102

PLAT B1

DILLINGHAM AIRFIELD